



IKON-XD™

ARIENS®

- (EN)** Operator's Manual
- (CZ)** Návod k obsluze
- (DE)** Betriebsanleitung
- (DK)** Instruktionsbog
- (ES)** Lea el Manual del operador
- (FI)** Käyttäjän käsikirja
- (FR)** Manuel de l'opérateur
- (IT)** Manuale d'uso
- (NL)** Gebruikershandleiding
- (NO)** Brukerhåndbok
- (PL)** Instrukcja obsługi
- (PT)** Manual do Operador
- (RU)** Руководство оператора
- (SK)** Návod na obsluhu
- (SV)** Instruktionsbok
- (TR)** Kullanıcı Kılavuzu

Models

915340 – IKON-XD 42" CE
(SN 000101+)

915341 – IKON-XD 52" CE
(SN 000101 +)

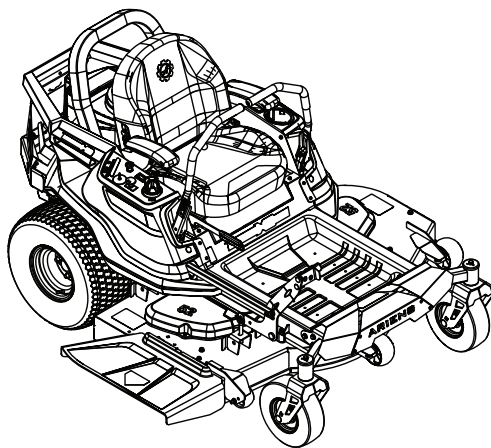

ARIENS|CO



AriensCo
655 West Ryan Street
Brillion, Wisconsin 54110-
1072 USA
Telephone
(920) 756-2141
Facsimile
(920) 756-2407

EC DECLARATION OF CONFORMITY ISSUED BY THE MANUFACTURER – ES PROHLASENÍ O SHODĚ, VYDANÉ VÝROBCEM – VOM HERSTELLER HERAUSGEGEBENE EG-KONFORMITÄTSERKLÄRUNG – OVERENSSTEMMELSESCERTIFIKAT FOR MODELLER, UDDSTEDT AF FABRIKANTEN – DECLARACIÓN DE CONFORMIDAD CE EMITIDA POR EL FABRICANTE – TOOTJA VÄLJASTATUD EC-VASTAVUSDEKLARATSIOON – VALMISTAJAN ANTAMA EY-VAATIMUSTENMUKAISUUSVAKUUTUS – DÉCLARATION DE CONFORMITÉ CE ÉMISE PAR LE FABRICANT – EZ IZJAVA O SUKLADNOSTI KOJU DAJE PROIZVOĐAČ – DICHIARAZIONE DI CONFORMITÀ CE DEL PRODOTTO RILASCIATA DAL PRODUTTORE – EK GAMINTOJO ATITIKTIES DEKLARACIJA – EK ATBILSTĪBAS DEKLARĀCIJA, KURU IZDOD RAŽOTĀJS – EG- CONFORMITEITSVERKLARING, UITGEGEVEN DOOR DE FABRIKANT – EF-SAMSVARSERKLÆRING FRA PRODUSENTEN – DEKLARACJA ZGODNOŚCI Z PRZEPISAMI EC WYDANA PRZEZ PRODUCENTA – CERTIFICADO DE CONFORMIDADE DO MODELO EMITIDO PELO FABRICANTE – СОСТАВЛЕННОЕ ПРОИЗВОДИТЕЛЕМ ЗАЯВЛЕНИЕ О СООТВЕТСТВИИ СТАНДАРТАМ И НОРМАМ ЕС – ES-IZJAVA O SKLADNOSTI, KI JO JE IZDAL PROIZVAJALEC – ES VYHLÁSENIE O ZHODE, VYDANÉ VÝROBCOM – EG-DEKLARATIONEN OM OVERENSSTÄMMELSE UTFÄRDAD AV TILLVERKAREN – ÜRETİCİ TARAFINDAN DÜZENLENEN EC UYGUNLUK BEYANI

We the undersigned, AriensCo, certify that: My, nižepodepsani, AriensCo, prohlašujeme, že: Der Unterzeichnete, AriensCo, bescheinigt, dass: Undertegnede, AriensCo, attesterer, at: Nosotros, los abajo firmantes, AriensCo, certificamos que: Meie, allakirjutatud, ETTEVÕTE ARIENS, kinnitame, et: Allekirjottanut, AriensCo, vakuuttaa, että: Nous, soussignés AriensCo, certifions que: Mi, dolje potpisani, AriensCo, potvrđujemo da: La sottoscritta società AriensCo certifica che: Mes, žemiau pasirašiusieji, „ARIENS“ kompanija, patvirtiname, jog: Mēs, zemāk parakstījušies, AriensCo, apliecinām, ka: Wij, de ondergetekenden, AriensCo, verklaren dat: Undertegnede, AriensCo, bekrefter at: My, niżej podpisani, AriensCo, oświadczamy, że: Nós, abaixo assinados, certificamos em nome de AriensCo, que: Мы (фирма ARIENS), нижеподписавшиеся, настоящим заявляем, что: Spodaj podpisani AriensCo potrjujemo, da je: My, spoločnosť AriensCo vyhlasujeme, že: Undertecknad, AriensCo, intygar att: Biz altta imzası bulunan, AriensCo olarak tasdik ederiz ki:

Type: Typ: Type: Tipo: Tüüp: Tyypit: Type: Tipo: Type: Tip: Type: Tips: Type: Tipas: Tipo: Тип: Tip: Type: Type: Tip:	Riding Rotary Lawn Mower – Samojízdná Sekačka – Aufsitz-Sichelmäher – Havetraktor med roterende knive – Tractor cortacésped giratorio – Rotor-mururtraktor – Puutarhatraktori Pyörivällä Leikkuuyksiköllä – Tondeuse à gazon autoportée rotative – Samohodna rotaciona kosilica za travu – Trattorino con unità di taglio rotativa – Savaigė žoliapjovė – Braucošais rotējošais zāles pļāvējs – Rijdende roterende grasmaaier – Plentraktør med rotorklipper – Samobiežna rotacyjna kosiarzka trawnikowa – Tractor cortador de relva – езда Косилка роторная – Sedežna vrtiljiva kosilnica – Jazdecké rotačná kosačka na trávu – Sittrotorgräsklippare – Döner biçme makinesi sürme
---	---

Trade Name: Obchodní název: Handelsbezeichnung: Firmanavn: Nombre comercial: Kaubamärk: Kauppanimi: Appellation commerciale: Trgovacki naziv: Nome commerciale: Prekės pavadinimas: Komerčiālais nosaukums: Handelsnaam: Handelsnavn: Nazwa handlowa: Nome da Marca: Название фирмы: Trgovsko ime: Názov výrobku: Handelsbeteckning: Ticaret Unvan:	Ariens
---	--------

Model, Model Name, Serial Number: Model, název modelu, výrobní číslo: Modell, Modellname und Seriennummer: Model, Modelnavn, Seriennummer: Modelo, Nombre, N° de Serie: Model, Model, Seerianumber: Malli, mallin nimi, sarjanumero: Modèle, nom du modèle, numéro de série: Model, Naziv modela, Serijski broj: Modello, Nome modello, Numero di serie: Modelis, Modelio pavadinimas, Serijos numeris: Modelis, Modelja nosaukums, Sērijas numurs: Model, Model Naam, Volgnummer: Modell, modellnavn, serienummer: Model, nazwa modelu, numer seryjny: Modelo, Nome do Modelo, Número de Série: Модель, наименование модели, серийный номер: Model, Ime modela, Serjska številka: Model, názov modelu, výrobné číslo: Modell, modelnavn, serienummer: Model, Model Adi, Seri Numarası:	915340, IKON XD 42 CE, 000101+ 915341, IKON XD 52 CE, 000101+
---	--

Cutting Width: Pracovní záběr: Schnittbreite: Klippebredde: Anchura de corte: Löikelaius: Leikkuuleveys: Largeur de coupe: Širina reza: Plovinio plotis: Šerėanas platumas: Maaibreedte: Atbilst: Klippebredde: Szerokość cięcia: Largura de corte: Ширина скашивания: Širka košnje: Šírka kosenia: Klippbredd: Kesme Geniřliđi:	915340: 106.7 cm 915341: 132.1 cm
--	--------------------------------------

Conforms to: Odpovídá normě: mit den Anforderungen der folgenden Richtlinien übereinstimmt: Er i overensstemmelse med: Cuple con: Vastab: Täyttää seuraavat vaatimukset: Est conforme à: U sukladnosti s: E conforme a: Atitinka: Voldoet aan: Er i samsvar med: Jest zgodny z: De acordo com: Соответствует: v skladu z: Je v zhode s: Overensstammer med: Uygundur:

2006/42/EC, 2014/30/EU, 2011/65/EU - 2015/863/EU, 2000/14/EC, Annex VI - 2005/88/EC

EN ISO 5395-1: 2013 + A1: 2018, EN ISO 5395-3: 2013 + A1: 2017 + A2: 2018

EN ISO 14982: 2009, ISO 11094:1991, EN ISO 3744:1995, EN 50581: 2012

Notified Body – Pověřená osoba – Benachrichtigte Körperschaft – Bemyndiget organ – Organismo notificado – Teavitatud asutus – Entité notifiée – Organisme notifié – Obavljeno tijelo – Organismo notificado – Registruota instancija –Pietiektā iestāde – Aangemelde instantie – Teknisk kontrollorgan – Organ zaświadczący – Organismo Certificador – Уполномоченным органом – Priglašení organ – Notifikovaný Organ – Anmält organ – Onaylanmış Kuruluş		Notified Body 00905 Intertek Deutschland GmbH Stangenstr. 1 70771 Leinfelden-Echterdingen Germany	
Representative Measured Sound Power Level (L_{wa}) – Reprezentativní hodnota změřené hladiny akustického výkonu (L_{wa}) – Repräsentativer gemessener Geräuschpegel (L_{wa}) – Nätiik mõõdetud heliivõimsuse tase (L_{wa}) – Repräsentativt, målt støjefektniveau (L_{wa}) – Nivel de potencia acústica representativo medido (L_{wa}) – Tyypillinen mitattu äänitehotaso (L_{wa}) – Niveau de puissance acoustique représentatif mesuré (L_{wa}) – Reprezentativna izmjerena razina snage zvuka (L_{wa}) – Livello di potenza sonora rappresentativo rilevato (L_{wa}) – Reprezentatīvais izmērtais skaņas jaudas līmenis (L_{wa}) – Būdingas išmatuotas garso galios lygis (L_{wa}) – Repräsentatif gemeten geluidsniveau (L_{wa}) – Reprezentativt målt lydeffektivit (L_{wa}) – Zmierzony reprezentatywny poziom mocy akustycznej (L_{wa}) – Nivel de Potência de Som Medido Representativo (L_{wa}) – Реprеzentативный измеренный уровень звуковой мощности (L_{wa}) – Tipična izmjerena raven zvočne moči (L_{wa}) – Charakteristická zmeraná hladina akustického výkonu (L_{wa}) – Reprezentativ uppmätt ljudnivå (L_{wa}) – Örnek Ölçülmüş Ses Güç Seviyesi (L_{wa})		Guaranteed Sound Power Level (L_{wa}) – Zaručovaná hodnota hladiny akustického výkonu (L_{wa}) – Garantierter Geräuschpegel (L_{wa}) – Garanteret støjefektniveau (L_{wa}) – Nivel de potencia acústica garantizado (L_{wa}) – Tagatud mõõdetud heliivõimsuse tase (L_{wa}) – Taattu äänitehotaso (L_{wa}) – Niveau de puissance acous- tique garanti (L_{wa}) – Zajamčena razina snage zvuka (L_{wa}) – Livello di potenza sonora garantito (L_{wa}) – Garantuotas garso galios lygis (L_{wa}) – Garantētais skaņas jaudas līmenis (L_{wa}) – Gega- randeerd geluidsniveau (L_{wa}) – Garantert lydeffektivit (L_{wa}) – Gwarantowany reprezentatywny poziom mocy akustycznej (L_{wa}) – Nivel de Potência de Som Medido Garantido (L_{wa}) – Гарантированный уровень звуковой мощности (L_{wa}) – Zajam- čena raven zvočne moči (L_{wa}) – Zaručena hladina akustického výkonu (L_{wa}) – Garanterad uppmätt ljudnivå (L_{wa}) – Garanti Edilmiş Ses Güç Seviyesi (L_{wa})	
915340: 99 dB _A 915341: 104 dB _A		915340: 100 dB _A 915341: 105 dB _A	
Engine Power (Kw @ RPM): Výkon motoru při regulovaných otáčkách (Kw při ot./min): Motorleistung (kW bei U/Min): Motoreffekt (Kw @ RPM): Potencia del motor (Kw a RPM): Mootori võimsus (Kw @ RPM): Enimmäisteho (Kw @ RPM): Puissance moteur (Kw au régime max.): Snaga motora (kW pri o/min): Potenza max. del motore (Kw a giri/min.): Variklo galia (Kw @ RPM): Dzinēja jauda (Kw pie apgriezieniem minūtē): Motor Vermogen (Kw @ RPM): Motoreffekt (Kw @ RPM): Moc silnika (Kw przy obr./min.): Potência (Kw @ RPM): Мощность двигателя (кВт при об/мин): Moć motorja (kW pri vrt./min.): Výkon motora (Kw @ RPM) (Kw / ot./min.): Motoreffekt (Kw @ varvial): Motor Gücü (Kw @ RPM):		915340: 13.9 @ 2600 915341: 16.5 @ 3100	
Authorised Representative/Zplnomocnený zástupce/ Bevollmächtigter Vertreter/Autoriseret representant/ Representante autorizado/Valtuutettu edustaja/Représentant autorisé/Rappresentante autorizzato/Geautoriseerd vertegenwoordiger/Autorisered representant/Autoryzowany przedstawiciel/ Representante autorizado/Уполномоченный представитель/ Splnomocnený zástupca/Auktoriserad representant/Yetkili Temsilci		Authorized to Compile the Technical File / Oprávněný vytvořit technickou dokumentaci / Zur Anlage der technischen Akte ermächtigt / Autoriseret til at compilere den tekniske fil / Autorizado para compilar los archivos técnicos / Volitatud tehnilisi dokumente koostama / Valtuutettu laatimaan teknisen tiedoston / Autorisé à remplir la fiche technique / Ovlaštena osoba za pripremu tehničke arhive / Autorizzato alla compilazione del fascicolo tecnico / Igaliotas sudaryti techninį failą / Pilnvarots sastādīt tehnisko lietu / Geautoriseerd om het technische bestand samen te stellen / Autoriseret til å produsere den tekniske filen / Uprawniony do przygotowania dokumentacji technicznej / Autorizado a Compilar o Ficheiro Técnico / Уполномочен на составление технического файла / Pooblaščenec za pripravo tehnične dokumentacije / Oprávněný na zostavenie súboru technickej dokumentácie / Auktoriserad att kompilera den tekniska filen / Teknik Dosyayı Derlemeye Yetkili	
Knut Viebahn AriensCo GmbH Ellwanger Str. 15 D-74424, Bühlertann		11/23 Date – Datum – Datum – Dato – Fecha – Kuupäev – Päivämäärä – Date – Data – Datum – Data – Datums – Datum – Dato – Data – Data – – data – Datum – Datum – Datum – Tarih	
Chad Saubert Director Product Liability and Conformance AriensCo Brillion, WI 54110-1072 USA		CW C. S. S. S. Signature – Podpis – Unterschrift – Underskrift Firma – Allkiri – Allekirjoitus – Signature – Potpis – Firma – Parašas – Paraksts – Handtekening – Signatur – Podpis – Assinatura – Подпись – Podpis – Namteekning – Imza	

TABLE OF CONTENTS

WELCOME	2	Emergency Stopping	16
Register Your Product!	2	Before Operating Unit	16
SAFETY	3	Start the Engine	17
Practices & Laws	3	Operate Unit	17
EMISSION CONTROL SYSTEM	3	Stop the Engine	18
Required Operator Training	3	Move Unit Manually	18
Safety Alert Symbol	3	Transport Unit	18
Signal Words	3	MAINTENANCE	18
Safety Decals	4	Maintenance Schedule	18
Safety Rules	7	Service Parts	19
ASSEMBLY	12	Service Position	19
Required Tools	12	Check Safety Interlock System	19
Unpack Unit	12	Check Parking Brake	19
Secure Seat Cable	12	Check Engine Oil	19
Secure Operator Presence Cable	12	Check Tire Pressure	19
Connect Battery	12	Check Fasteners	20
Assemble Steering Levers	13	Check Mower Blades	20
Install Deck Lift Pedal	13	Check Battery	21
Prepare Unit for Operation	13	Check Mower Belts	22
CONTROLS AND FEATURES	14	ADJUSTMENTS	25
Ignition Key	15	Adjust Seat	25
Choke Control Knob	15	Adjust Steering Levers	25
Throttle Control Lever	15	Adjust Unit to Track Straight	26
Power-Take-Off (PTO) Knob	15	Adjust Parking Brake Lever	27
Hour Meter	15	Remove and Install Mower Deck	27
Height-of-Cut Dial	15	Adjust Mower Deck	29
Deck Lift Pedal	15	TROUBLESHOOTING	31
Seat Adjustment Lever	16	STORAGE	33
Parking Brake Lever	16	Short-Term Storage	33
Safety Interlock System	16	Long-Term Storage	33
Steering Levers	16	Start-of-Season Preparation	33
Transaxle Bypass Levers	16	ACCESSORIES	33
Anti-scalp Rollers	16	SPECIFICATIONS	34
OPERATION	16	WARRANTY	36

Congratulations on your purchase and welcome to the Ariens family! Every machine in the Ariens lineup is designed for long-lasting and unsurpassed performance. We are confident your machine will be part of your family for many years to come.

Have Questions or Need Assistance?

www.ariens.com

A parts manual for your unit is available for free download or purchase at www.ariens.com.

REGISTER YOUR PRODUCT!

It is extremely important to register your product at time of purchase. Product registration activates the warranty and establishes a communication link from AriensCo.

Locate the model and serial number decal on your unit and register those numbers online at www.ariens.com. See Figure 1 for decal location. Be aware that the original selling dealer may have already completed product registration on behalf of the original purchaser.

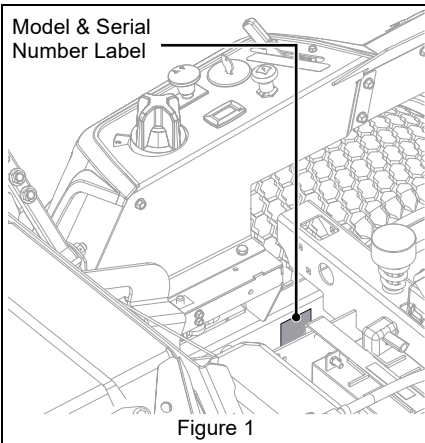

Record model number here.

Record serial number here.

MANUALS

Before operating or servicing the unit, carefully and completely read the manuals provided with the unit. They contain safety instructions and important information about unit controls.

The engine on this unit is covered by a separate manual. Refer to the engine manual for engine service recommendations. Contact the engine manufacturer for a replacement manual if necessary.

It is your responsibility to read and understand all safety precautions and instructions in the manuals. If you do not understand or have difficulty following the instructions, contact your Ariens dealer for assistance. To locate your nearest dealer, go to www.ariens.com.

DISCLAIMER

Ariens reserves the right to discontinue, make changes to, and add improvements upon its products at any time without public notice or obligation. The descriptions and specifications contained in this manual were in effect at printing. Equipment described in this manual may be optional. Some illustrations may not be applicable to your unit.

SAFETY

Read these safety rules and follow them closely. Failure to follow these rules could lead to loss of control of unit, severe personal injury or death to you or bystanders, or result in damage to property or the machine.

PRACTICES & LAWS

Practice usual and customary safe working precautions. Learn applicable rules and laws in your area. Always follow the practices set forth in this manual.

EMISSION CONTROL SYSTEM

This equipment and/or its engine may include exhaust and evaporative emissions control system components required to meet U.S. Environmental Protection Agency (EPA) and/or California Air Resources Board (CARB) regulations. Tampering with emission controls and components by unauthorized personnel may result in severe fines or penalties. Emission controls and components can only be adjusted by an Ariens dealer or an authorized engine manufacturer's service center. Contact your Ariens Equipment Retailer concerning emission controls and component questions.

REQUIRED OPERATOR TRAINING



Read and understand the Operator's Manual and decals on the unit. This information is for your safety and the proper use of your equipment.

Failure to follow these instructions and warnings may cause death or serious injury. If you have purchased this product from an Ariens dealer, the dealer can provide you with training.

Familiarize yourself and any other operators with all controls and the safe use of the features of this unit. If you loan, rent or sell this product to others, provide them with all manuals.

If you have any questions, please call our customer support line at 920-756-4688 or contact us at www.ariens.com. Do not use this equipment if, after reading the Operator's Manual and the on-board decals, you have any questions about the safe use of this product.



WARNING: AVOID INJURY. This cutting machine is capable of amputating hands and feet and throwing objects. Failure to observe the safety instructions in the manuals and on decals could result in serious injury or death.

SAFETY ALERT SYMBOL



This is the safety alert symbol. It means:

- **ATTENTION!**
- **YOUR SAFETY IS INVOLVED!**

When you see this symbol:

- **BECOME ALERT!**
- **OBEY THE MESSAGE!**

SIGNAL WORDS

The safety alert symbol above and signal words below are used on decals and in this manual. Read and understand all safety messages.

1. Danger



DANGER: Indicates an **IMMINENTLY HAZARDOUS SITUATION!** If not avoided, **WILL RESULT** in death or serious injury.

2. Warning



WARNING: Indicates a **POTENTIALLY HAZARDOUS SITUATION!** If not avoided, **COULD RESULT** in death or serious injury.

3. Caution



CAUTION: Indicates a **POTENTIALLY HAZARDOUS SITUATION!** If not avoided, **MAY RESULT** in minor or moderate injury. It may also be used to alert against unsafe practices.

4. Notice

NOTICE: Indicates information or procedures that are considered important but not hazard related. If not avoided property damage could result.

IMPORTANT: Indicates general reference information worthy of special attention.

See Figure 2 for safety decal locations.

The safety decals on your machine are visual reminders of the important safety information in this manual. All messages on your unit must be fully understood and carefully followed. Safety decals on the machine are explained below.

[illegible]

Safety Decal Descriptions

1. DANGER!



Discharge Hazard - NEVER operate unit without discharge chute in operating position. Thrown objects can cause injury or damage.



DO NOT operate mower unless all guards are in operating position or bagger is attached.

2. DANGER!



Discharge Hazard - NEVER direct discharge toward people, pets or property. Thrown objects can cause injury or damage.



Amputation Hazard - NEVER stick hands or feet under deck or shielded areas.



Shut off engine, remove key, and read manual before servicing or making adjustments to unit.



Keep children and others away from unit while unit is in operation.



Keep feet and hands away from all rotating or moving parts.



DO NOT step or stand in this area.

3. DANGER!



DANGER!



Read and understand the operator's manual before operating unit.

3. Amputation Hazard



To avoid amputation hazard DO NOT put hands near rotating blades.



To avoid amputation hazard DO NOT put hands near moving belts.



Keep hands away from all rotating or moving parts.



Keep all guards and shields in place.

3. Discharge Hazard



Discharge Hazard - NEVER direct discharge toward people, pets or property. Thrown objects can cause injury or damage.



DO NOT operate mower unless all guards are in operating position or bagger is attached.

3. Tipping Hazard



Avoid tipping hazard.



DO NOT operate on slopes over 15°.



DO NOT operate on slopes over 15°.

3. Service Hazard



Before servicing unit do the following:



Read owners manual before servicing or making adjustments to unit.



Set parking brake.

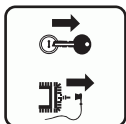

Remove key and disconnect spark plug before servicing or making adjustments to unit.

3. Bystander Hazard



DO NOT operate the unit in the presence of bystanders.



DO NOT carry passengers.



Look behind when operating the unit in reverse.

3. Loss of Traction Hazard



If loss of traction is experienced do the following:

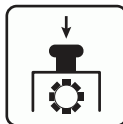

Disengage PTO.



Proceed off slope slowly.



DO NOT try to turn or speed up.

4. DANGER!



ALWAYS keep hands and feet away from discharge chute.

5. HOT PARTS!



DO NOT touch parts which are hot from operation. ALWAYS allow parts to cool.

6. ROTATING PARTS!



AVOID INJURY. Stay clear of rotating parts.

7. DANGER!



DANGER!



No smoking.

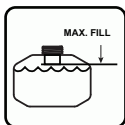

IMPORTANT: DO NOT overfill. Fill fuel tank to below bottom of filler neck.

WARNING: Overfilling may cause severe damage to evaporative system!

- NEVER fill fuel tank when engine is running, hot or unit is indoors. NEVER overfill fuel tank.
- Replace fuel cap securely and clean up spilled fuel.

SAFETY RULES

The following safety instructions are based on the B71.1 specifications of the American National Standards Institute and ISO 5395 in effect at the time of production.

Training

Read, understand, and follow all instructions on the machine and in the manual(s) before starting.

Be sure the area is clear of bystanders and pets before operating. Stop machine if anyone enters the area.

Improper use of power equipment can cause serious permanent injury or death to the operator or a bystander.

Understand:

- How to operate all controls
- The functions of all controls
- How to STOP in an emergency
- Braking and steering characteristics
- Turning radius and clearances

If the operator or the mechanic cannot read the manual, it is the owner's responsibility to explain it to them.

ALWAYS train any inexperienced operators and require them to read and understand all manuals and decals.

Only allow responsible adults, who are familiar with the instructions, to operate this machine.

Only the operator can prevent and is responsible for accidents or injuries occurring to themselves, other people or property.

Operator Age

DO NOT allow children under the age of 18 to operate any outdoor power equipment.

Local regulations may restrict the age of the operator.

Data indicates operators age 60 years and above are involved in a large percentage of riding mower-related injuries.

These operators should evaluate their ability to operate the riding mower safely enough to protect themselves and others from serious injury.

Children

Tragic accidents can occur if the operator is not alert to the presence of children. Children are often attracted to the machine and the mowing activity. NEVER assume that children will remain where you last saw them.

Be alert and turn machine off if a child enters the area.

Before and while backing, look behind and down for small children.

NEVER carry children, even with the blade(s) shut off. They may fall off and be seriously injured or interfere with safe machine operation. Children who have been given rides in the past may suddenly appear in the mowing area for another ride and be run over or backed over by the machine.

NEVER allow children to operate the machine.

Use extreme care when approaching blind corners, shrubs, trees or other objects that may block your view of a child.

Keep children out of the mowing area and in the watchful care of a responsible adult other than the operator.

Personal Protection	<p>This product is equipped with an internal combustion type engine. DO NOT use unit on or near any unimproved, forest-covered or brush-covered land unless exhaust system is equipped with a spark arrester meeting applicable local, state or federal laws. A spark arrester, if it is used, must be maintained in effective working order by operator.</p>
DO NOT wear loose clothing or jewelry and tie back hair that may get caught in rotating parts.	
Wear adequate outer garments.	
NEVER wear open sandals or canvas shoes during operation. Wear adequate safety gear, protective gloves and footwear.	
Wear proper footwear to improve footing on slippery surfaces.	
ALWAYS wear eye and ear protection when operating machine.	DO NOT operate machine while feeling tired, ill or under the influence of alcohol or other drugs.
Before Operating	DO NOT put hands or feet near rotating parts or under the machine. Keep clear of the discharge opening at all times.
Keep all nuts and bolts tight to be sure the equipment is in safe working condition.	DO NOT touch parts which are hot. Allow parts to cool.
Maintain the machine to be in compliance with the maintenance schedule.	DO NOT operate machine without the entire grass catcher, discharge guard or other safety devices in place and working.
Clean grass and debris from unit, especially from around muffler and engine, to help prevent fires.	ALWAYS keep hands and feet away from all pinch points.
Check parking brake operation frequently. Adjust and service as required.	Avoid slippery surfaces. ALWAYS be sure of your footing.
Inspect unit before each use for missing or damaged decals and shields, correctly operating safety interlock system, and deterioration of grass catchers. Replace or repair as needed.	NEVER carry passengers.
Ensure Safety Interlock System is functioning properly. DO NOT operate unit if safety interlock is damaged or disabled.	NEVER direct discharged material toward anyone. Avoid discharging material against a wall or obstruction. Material may ricochet back toward the operator. Stop the blade(s) when crossing gravel surfaces.
Start and operate unit only when seated in operator's position. Steering control levers must be in neutral, PTO disengaged and parking brake set when starting engine.	NEVER engage PTO when attachment, including mower blades, is not in use. ALWAYS turn off power to attachment when not in active use such as traveling or crossing driveways.
NEVER interfere with the intended function of a safety device or reduce the protection provided by a safety device. Check their proper operation regularly.	ALWAYS disengage PTO, stop unit and engine, remove key, engage parking brake and allow moving parts to stop before leaving operator's position.
Keep machine free of grass, leaves or other debris build-up. Clean up oil or fuel spillage and remove any fuel-soaked debris.	NEVER engage PTO while raising the attachment, including mower blades, or when attachment is in the raised position.
Operation	Keep safety devices or guards in place and functioning properly. NEVER modify or remove safety devices.
Be sure the area is clear of bystanders before operating. Stop machine if anyone enters the area.	DO NOT mow in reverse unless absolutely necessary. ALWAYS look down and behind before and while backing.
NEVER operate machine in a closed or poorly-ventilated area.	Stop engine before removing grass catcher or unclogging chute.
ALWAYS maintain unit in safe operating condition. Damaged or worn out muffler can cause fire or explosion.	Slow down before turning.
	If you strike a foreign object, stop and inspect the machine. Repair, if necessary, before restarting.

NEVER leave a running machine unattended. ALWAYS turn off blade(s), set parking brake, stop engine and remove key before dismounting.
Disengage blade(s) when not mowing. Shut off engine and wait for all parts to come to a complete stop before cleaning the machine, removing the grass catcher, or unclogging the discharge guard.
Know the weight of loads. Limit loads to those you can safely control and the unit can safely handle.

Operating Conditions

Lightning can cause severe injury or death. If lightning is seen or thunder is heard in the area, do not operate the machine, see shelter.
ALWAYS check overhead and side clearances carefully before operation.
Watch for traffic when operating near or crossing roadways.
Clear the area of objects such as rocks, wire, toys, etc., which could be thrown by the blades.
Check for weak spots on docks, ramps or floors. Avoid uneven work areas and rough terrain. Stay alert for hidden hazards or traffic.
Use care when approaching blind corners, shrubs, trees or other objects that may obscure vision.
Dust, smoke, fog, etc. can reduce vision and cause an accident.
Operate machine only in daylight or good artificial light.

Slope Operation

Slopes are a major factor related to loss of control and tip-over accidents, which can result in severe injury or death. Operation on all slopes requires extra caution. If you cannot back up the slope or if you feel uneasy on it, DO NOT mow it.
DO NOT operate on slopes of more than 15°.
Mow up and down slopes, not across.
ALWAYS keep the machine in gear when going down slopes. DO NOT shift to neutral and coast downhill.
Watch for holes, ruts, bumps, rocks, or other hidden objects. Uneven terrain could overturn the machine. Tall grass can hide obstacles.

DO NOT mow on moist or wet grass. Tires may lose traction causing a loss of control.
Use extra care while operating machine with grass catchers or other attachments; they can affect the stability of the machine. DO NOT use on steep slopes.
Keep all movements on the slope <i>slow</i> and <i>gradual</i> . DO NOT make sudden changes in speed or direction, which could cause the machine to roll over.
Avoid starting, stopping, or turning on a slope. If the tires lose traction, disengage the blade(s) and proceed slowly straight down the slope.
Operation on slopes may lead to loss of steering control. When operating on slopes be prepared to react to an emergency situation: <ul style="list-style-type: none"> • Return steering levers to neutral position. • Immediately set parking brake. • Turn off PTO and engine.
DO NOT try to stabilize the machine by putting your foot on the ground.
DO NOT park on slopes unless necessary. When parking on slope ALWAYS chock or block wheels. ALWAYS set parking brake.
Choose a low ground speed so you will not have to stop or shift while on a slope.
DO NOT mow near drop-offs, ditches, or embankments. The machine could suddenly roll over if a wheel goes over the edge or if the edge caves in.
DO NOT bypass transmission or allow transmission to free-wheel when on a slope.

Fuel

To avoid personal injury or property damage, use extreme care in handling gasoline. Gasoline is extremely flammable and the vapors are explosive.
Ethanol blends must not exceed E10. Higher ethanol content may cause your machine to run hotter and damage your engine.
Replace fuel cap securely and clean up spilled fuel before starting engine.
Extinguish all cigarettes, cigars, pipes and other sources of ignition.
Use only an approved gasoline container.
NEVER store the machine or fuel container where there is an open flame, spark or pilot light such as on a water or space heater or other appliances.

NEVER fill containers inside a vehicle or on a truck or trailer bed with a plastic liner. ALWAYS place containers on the ground away from your vehicle before filling.
NEVER fuel the machine indoors.
NEVER remove gas cap or add fuel with the engine running. Allow engine to cool before fueling.
Fuel is highly flammable and its vapors are explosive. Handle with care. Use only an approved gasoline container with an appropriately-sized dispensing spout. NO smoking, NO sparks, NO flames.
Remove gas-powered equipment from the trailer and refuel it on the ground. If this is not possible, then refuel such equipment with a portable container, rather than from a gasoline dispenser nozzle.
Keep the nozzle in contact with the rim of the fuel tank or container opening at all times until the fueling is complete. DO NOT use a nozzle lock-open device.
NEVER overfill fuel tank. Replace gas cap and tighten securely.
If fuel is spilled on clothing, change clothing immediately.

Towing

Follow the manufacturer's recommendations for weight limits for towed equipment and towing on slopes.
NEVER allow children or others in or on towed equipment.
Tow only with a machine that has a hitch designed for towing. DO NOT attach towed equipment except at the hitch point.
On slopes, the weight of the towed equipment may cause loss of traction and loss of control.
Travel slowly and allow extra distance to stop.

Accessories

Follow the manufacturer's recommendation for wheel weights or counterweights.
Check grass catcher components and the discharge guard frequently and replace with the manufacturer's recommended parts, when necessary.
Use only attachments recommended by AriensCo that are appropriate to your use and can be used safely in your application.

Batteries

Avoid electric shock. Objects contacting both battery terminals at the same time may result in injury and unit damage. DO NOT reverse battery connections.
Reverse connections may result in sparks which can cause serious injury. ALWAYS connect positive (+) lead of charger to positive (+) terminal, and negative (-) lead to negative (-) terminal.
ALWAYS disconnect negative (-) cable FIRST and positive (+) cable SECOND. ALWAYS connect positive (+) cable FIRST, and negative (-) cable SECOND.
Explosive gases from battery can cause death or serious injury. Poisonous battery fluid contains sulfuric acid and its contact with skin, eyes or clothing can cause severe chemical burns.
No flames, No sparks, No smoking near battery.
ALWAYS wear safety glasses and protective gear near battery. Use insulated tools.
ALWAYS keep batteries out of reach of children.
Battery posts, terminals and related accessories contain lead and lead compounds, chemicals known to the state of California to cause cancer and reproductive harm. Wash hands after handling.

Service

The use of non-genuine replacement parts or accessories could adversely affect machine operation and safety.
Do not change engine governor setting or overspeed the engine.
Maintain or replace safety and instruction labels as necessary.
Keep unit free of debris. Clean up oil or fuel spills.
ALWAYS block wheels and know all jack stands are strong and secure and will hold weight of unit during maintenance.
Release any pneumatic or hydraulic pressure from components slowly.
NEVER attempt to make any adjustments to unit while engine is running (except where specifically recommended). Stop engine, remove key and spark plug wire and wait for all moving parts to stop before servicing or cleaning.

Lower cutting deck unless a positive mechanical lock is used.
Allow engine to cool before servicing.
Moving parts can cut or amputate fingers or a hand. On multiblade mowers, rotation of one blade will cause all blades to rotate.
NEVER weld or straighten mower blades.
NEVER make adjustments or repairs with the engine running.
Mower blades are sharp. Wrap the blade or wear gloves, and use extra caution when servicing them.
ALWAYS keep body and hands away from pin holes or nozzles which eject hydraulic fluid under pressure.

Transporting Unit

Use extra care when loading or unloading the machine into a trailer or truck.
Secure unit chassis to transport vehicle. NEVER secure from rods or linkages that could be damaged.
DO NOT transport machine while engine is running.
ALWAYS turn off power to attachment and shut off fuel when transporting unit.

Storage

NEVER store unit with fuel in fuel tank inside a building where any ignition sources are present.
Keep machine free of grass, leaves or other debris build-up. Clean up oil or fuel spillage and remove any fuel-soaked debris. Allow machine to cool before storing.
For extended storage, close fuel shut off valve and clean unit thoroughly. See engine manual for proper storage.

ASSEMBLY

REQUIRED TOOLS

- Adjustable wrench
- Petroleum jelly or dielectric grease

UNPACK UNIT

1. Disengage transmission. See *Move Unit Manually* on page 18.
2. Move unit from container to a level surface.
3. Remove all other pieces from shipping container.
4. Cut all packaging cable ties on unit and discard.
5. Remove packaging material from unit and discard.

SECURE SEAT CABLE

1. Remove nut and one end of seat cable. Reinstall nut to secure remaining cable end to seat plate. See Figure 3.

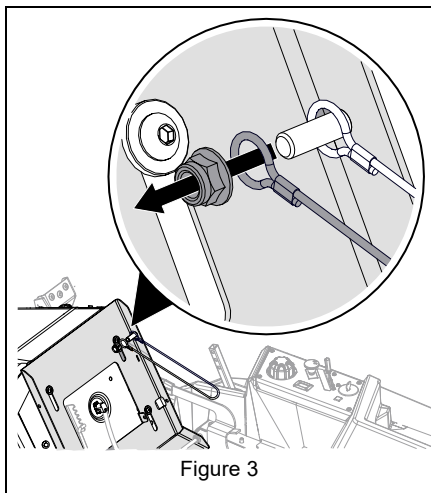

Figure 3

See Figure 4.

2. Remove nut from bolt on battery tray. Retain nut.
3. Tilt seat up slightly so cable end reaches bolt on battery tray.
4. Install cable end onto bolt on battery tray and secure with nut removed in step 2.

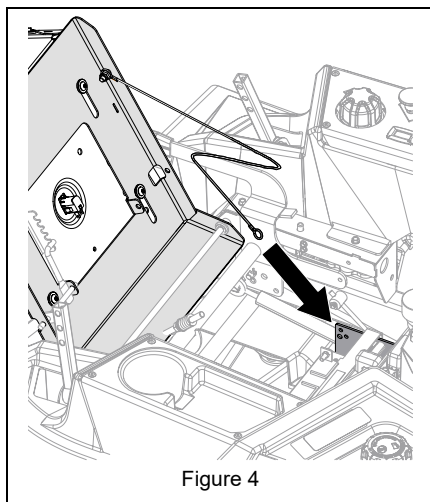

Figure 4

SECURE OPERATOR PRESENCE CABLE

See Figure 5.

1. Insert cable clip into top hole on battery tray.
2. Tip seat to upright position.

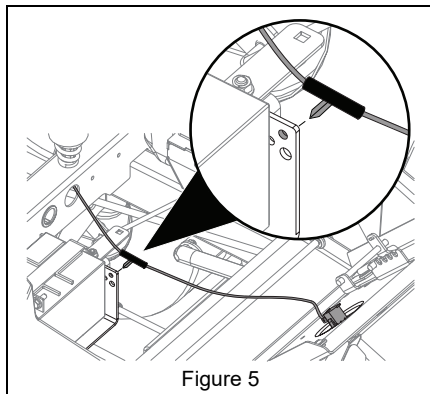

Figure 5

CONNECT BATTERY

See Figure 6.

1. Remove hardware from negative (-) battery cable, but DO NOT discard.
2. Secure negative (-) battery cable to negative (-) battery terminal with hardware removed in step 1.

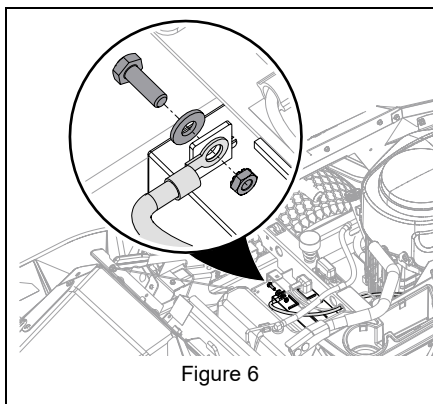

Figure 6

ASSEMBLE STEERING LEVERS

1. Remove hardware securing steering levers to lower control arms. See Figure 7.

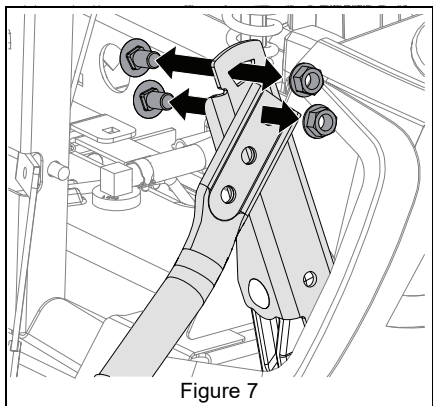

Figure 7

See Figure 8.

2. Rotate steering levers into operating position and align with desired height setting in lower control arms.
 - Use upper and middle holes for highest lever position.
 - Use middle and lower holes for lowest lever position.
3. Secure levers to lower control arms with hardware removed in step 1.
4. Align levers side to side. See *Adjust Steering Level Reach* on page 26.

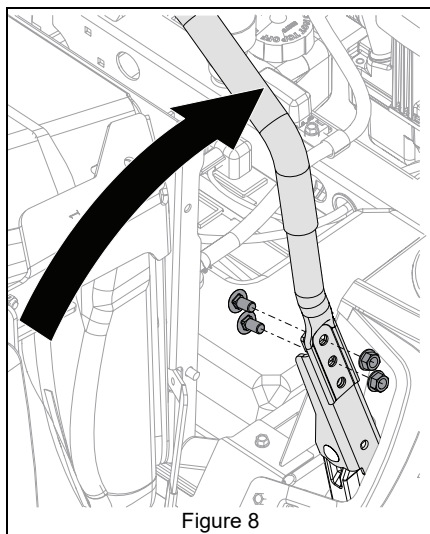

Figure 8

INSTALL DECK LIFT PEDAL

See Figure 9.

1. Remove hardware securing deck lift pedal to unit and remove pedal.
2. Rotate pedal as shown in Figure 9 and secure to unit with hardware removed in step 1.

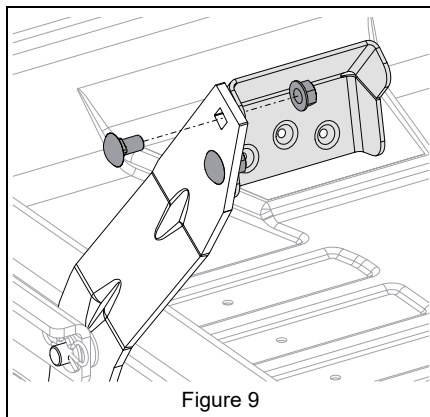

Figure 9

PREPARE UNIT FOR OPERATION

1. Adjust seat to a comfortable position. See *Adjust Seat* on page 25.

CONTROLS AND FEATURES

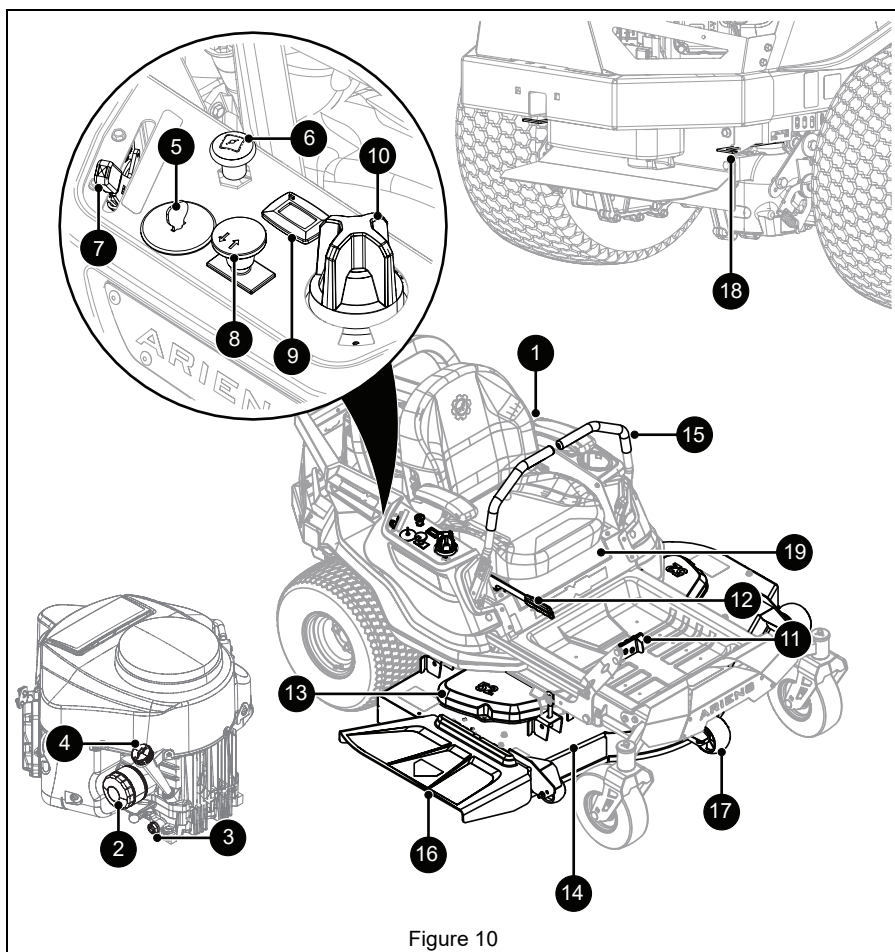

Figure 10

- | | |
|------------------------------|--------------------------------|
| 1. Fuel Tank and Cap | 11. Deck Lift Pedal |
| 2. Oil Filter | 12. Parking Brake Lever |
| 3. Oil Drain | 13. Belt Guard (3) |
| 4. Engine Oil Dipstick | 14. Mower Deck |
| 5. Ignition Key | 15. Steering Lever (2) |
| 6. Choke Control Knob | 16. Discharge Chute |
| 7. Throttle Control Lever | 17. Anti-Scalp Wheel |
| 8. Power Take-off (PTO) Knob | 18. Transaxle Bypass Lever (2) |
| 9. Hour Meter | 19. Battery (Under Seat) |
| 10. Height-of-Cut Dial | |



WARNING: AVOID INJURY.
Read and understand the entire *Safety* section before proceeding.

See Figure 10 for all controls and features locations.

IGNITION KEY

See Figure 11.

Controls power to the engine. The key cannot be removed when in run position.

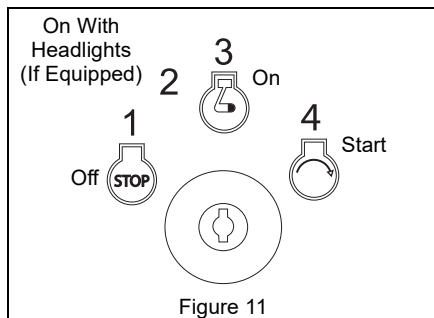

Figure 11

CHOKE CONTROL KNOB

See Figure 12.

Controls airflow to the engine.

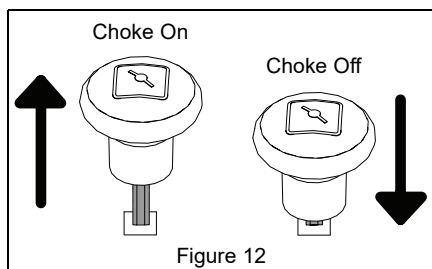

Figure 12

THROTTLE CONTROL LEVER

See Figure 13.

Controls engine speed.

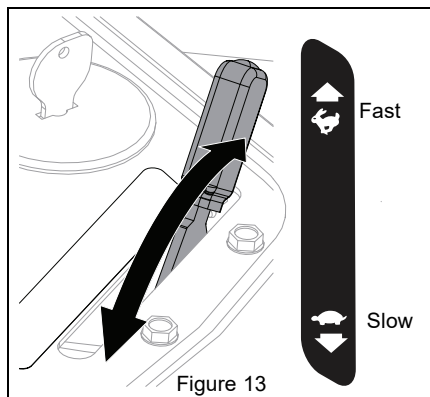

Figure 13

POWER-TAKE-OFF (PTO) KNOB

See Figure 14.

Controls power to mower blades. The engine will not start with the PTO knob in the on position.



WARNING: AVOID INJURY.
Blades will not *immediately* stop after pushing PTO knob down to off position.

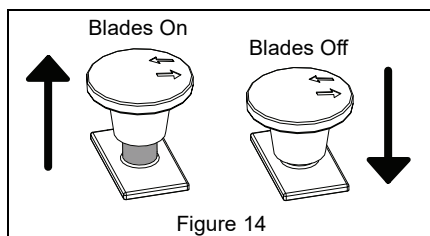

Figure 14

HOUR METER

Hour meter measures engine runtime and cannot be reset.

HEIGHT-OF-CUT DIAL

Sets the mower height of cut.

DECK LIFT PEDAL

Raises or lowers mower deck.

SEAT ADJUSTMENT LEVER

Unlocks seat to allow operator to move seat forward or backward and then lock in desired position.

PARKING BRAKE LEVER

See Figure 15.

Controls the parking brake. The engine will not start with brake in the off position.

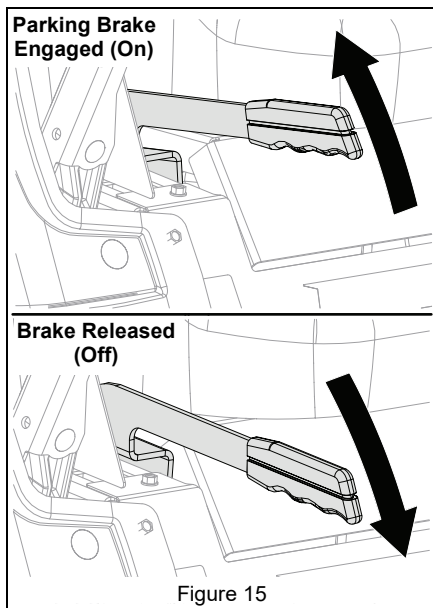

SAFETY INTERLOCK SYSTEM

Monitors the interaction of various unit features for operator safety.

STEERING LEVERS

Control the direction and speed of unit. To stop unit, return both steering levers to neutral.

TRANSAXLE BYPASS LEVERS

Control the transaxles so unit may be moved with the engine off.

ANTI-SCALP ROLLERS

Help prevent the deck from contacting the ground and scalping the lawn when passing over a high spot.

OPERATION



WARNING: AVOID INJURY.
Read and understand the *Safety* section before proceeding.

IMPORTANT: All references to left, right, front or rear are given from the perspective of operator in operator's position, facing the direction of forward travel.

EMERGENCY STOPPING

1. Move steering levers to neutral position.
2. Engage parking brake.
3. Push PTO knob down to off position.
4. Turn ignition key to off position and remove key from ignition.

BEFORE OPERATING UNIT

1. Check fuel level and add fuel if needed.

IMPORTANT: Use fresh unleaded fuel with an octane rating of at least 87. DO NOT use E85 blended fuels; the engine is not E20 / E30 / E85 compatible. The maximum recommended ethanol content is 10%. Ariens recommends using a quality fuel stabilizer in all fuel. See *Short-Term Storage* on page 33.

2. Check engine oil level and add oil if needed. Refer to engine manual.
3. Check condition of air cleaner. Refer to engine manual.
4. Check function of the Safety Interlock System by performing the tests in *Check Safety Interlock System* on page 19. Contact your Ariens dealer for repair if any of the tests fail.
5. Set cutting height. See Figure 16.
 - a. Depress and hold deck lift pedal in forward position.
 - b. Rotate height-of-cut dial to desired setting.
 - c. Slowly return deck lift pedal to resting position.

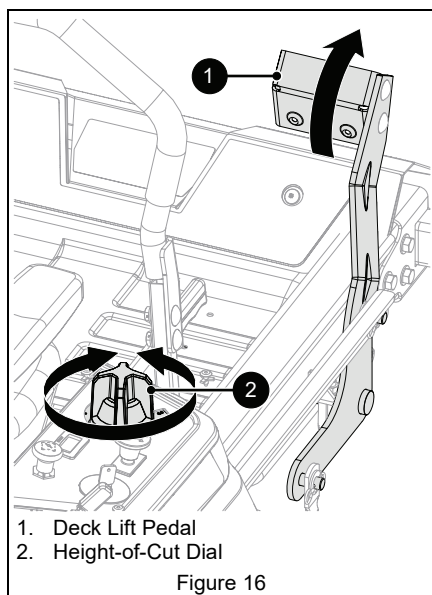

START THE ENGINE

1. Push PTO knob down to off position.
2. Move steering levers to neutral position.
3. Engage parking brake.
4. If engine is cold, pull choke knob up to on position. If engine is warm or hot, turn choke off.
5. Set throttle to slow speed.
6. Insert ignition key and turn to start position. Release key when engine starts.

IMPORTANT: Do not operate the starter for more than 10 seconds at a time. If the engine does not start, allow a 60-second cool down period between starting attempts.

7. If choke is on, wait a few seconds after engine starts and then push choke knob down to off position.

IMPORTANT: Make sure choke is completely off. Engine will not run smoothly using partial choke.

OPERATE UNIT

1. Release parking brake.
2. Set throttle control lever to fast position

IMPORTANT: Engaging the PTO knob with the throttle lever set lower than fast position can cause excessive belt wear. ALWAYS use fast position when engaging the PTO.

3. Pull PTO knob up to on position.

IMPORTANT: Never engage the PTO if the mower is plugged with grass or other material. This may cause damage to the electric clutch.



WARNING: AVOID INJURY.
Move the steering levers slowly and keep the throttle at slow speed until you learn how to operate the unit.

4. Move steering levers to begin mowing.

Direction of Travel	Lever Position
Forward	Push both levers forward from neutral position.
Reverse	Pull both levers backward from neutral position.
Right Turn	Push left lever farther forward than the right lever.
Left Turn	Push right lever farther forward than the left lever.
Stop	Return both levers to neutral position.

IMPORTANT: Aggressive turning can scuff or damage lawns. Always keep both wheels rotating when making sharp turns. DO NOT make turns with inside wheel completely stopped. For minimum turning radius, slowly reverse inside wheel while moving outside wheel slowly forward.

For Best Mowing Results

- Cut grass when it is dry.
- Keep mower blades sharp.
- Keep mower deck properly leveled.
- Do not set height of cut too low. For very tall grass, mow twice.
- Do not travel too fast.
- Mow with the engine set at full throttle.

- When mulching, only remove 1/3 of grass length per cutting. Do not cut more than 2.5 cm (1") at any one time.
- Discharge clippings into areas already cut.
- Vary cutting pattern with each mowing.
- Do not allow grass or debris to collect inside of mower deck. Clean after each use.

STOP THE ENGINE



WARNING: AVOID INJURY.
Wait for all moving parts to stop before leaving operator's position.

1. Move steering levers to neutral position.
2. Engage parking brake.
3. Push PTO knob down to off position.
4. Set throttle to slow speed.
5. Turn ignition key to off position and remove key from ignition.

MOVE UNIT MANUALLY

See Figure 17.

IMPORTANT: There is one transaxle bypass lever on each side of unit. Ensure that both levers are fully in front or rear position.

- To disengage the transaxles and move unit with the engine off, place both bypass levers in the rear position.
- To engage transaxles and operate unit normally, place both bypass levers in the front position.

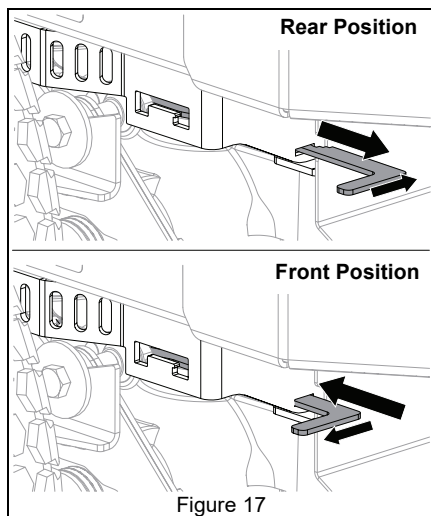

Figure 17

TRANSPORT UNIT

1. Stop engine, set parking brake and remove key from ignition.
2. Secure unit chassis to transport vehicle.

NOTICE: NEVER secure from rods or linkages that could be damaged.

MAINTENANCE



WARNING: AVOID INJURY.
Read and understand the *Safety* section before proceeding.

Your Ariens dealer can provide service and adjustments to keep your unit operating at peak efficiency.

Contact an authorized engine manufacturer's service center for engine service.

MAINTENANCE SCHEDULE

Service Performed	Each Use	Every 25 hrs.	Every 50 hrs.	Every 100 hrs.
Check Safety Interlock System	•			
Check Parking Brake	•			
Check Engine Oil *	•			
Change Engine Oil *+				
Check Tire Pressure	•			
Check Mower Blades	•			
Check Battery		•		
Clean Battery		•		
Check Carbon Canister Filter			•	
Check Air Filter *			•	
Check Fasteners			•	
Lubricate Unit			•	
Clean Engine Cooling System*				•
Check Belts				•

* Refer to engine manual for instructions

+ Use tubing included in literature pack to drain engine oil.

SERVICE PARTS

See your Ariens dealer to purchase service parts for your unit.

Description	Qty.	Part No.
Transaxle Drive Belt	1	07200718
Mower Belt – 42"	1	07200523
Mower Belt – 52"	1	07200023
Mower Blade – 42"	1	04769800
Mower Blade – 52"	1	04771200
Seat Switch	1	02754100
Fuel Filter (Model 915336)	1	21538400
Fuel Filter (Model 915335)	1	21548101
Oil Filter	1	21548100
Air Filter	1	21548000

SERVICE POSITION

See Figure 18.

Before starting any of the following maintenance procedures:

1. Park unit a flat, level surface.
2. Stop engine, remove key and wait for all moving parts to stop and for hot parts to cool.
3. Move steering levers to neutral position and rotate handles outward.
4. Engage parking brake.
5. Disconnect spark plug wires from engine.
6. Tip seat forward.

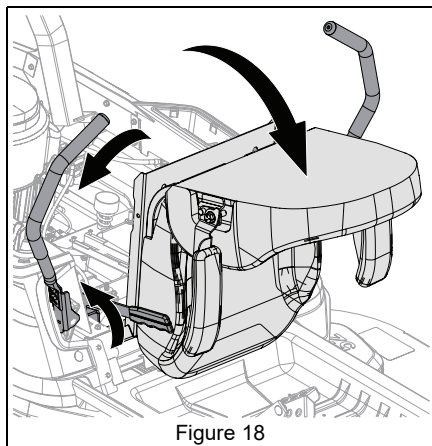

Figure 18

IMPORTANT: Reconnect spark plug wires after maintenance.

CHECK SAFETY INTERLOCK SYSTEM

Check function of the Safety Interlock System by performing the tests below. Contact your Ariens dealer for repair if any of the tests fail.

Test	Steering Levers	PTO	Parking Brake	Result
Starting Interlock				
1	Neutral	Off	On	Engine starts.
2	Forward, Neutral, Reverse	On	On or Off	Engine does not start.
3	Forward, Neutral, Reverse	On or Off	Off	Engine does not start.
Operating Interlock (Engine On)				
4 *	Forward, Neutral, Reverse	On	On or Off	Engine shuts off.
5 *	Forward, Neutral, Reverse	On or Off	Off	Engine shuts off.
* When operator lifts off seat.				

CHECK PARKING BRAKE

1. Place unit in service position. See *Service Position* on page 19.
2. Set both transaxle bypass levers in the rear position. See *Move Unit Manually* on page 18.
3. Push unit forward.
 - If unit does not move forward, no further action is needed.
 - If unit easily moves forward, adjust the brake lever. See *Adjust Parking Brake Lever* on page 27.

CHECK ENGINE OIL

NOTICE: Engine oil level must be maintained at correct level or engine damage may occur. Refer to engine manual.

CHECK TIRE PRESSURE

See *Specifications* on page 34 for recommended tire pressure.

**WARNING: AVOID INJURY.**

Explosive separation of tire and rim parts is possible.

- DO NOT inflate tires above the recommended pressure.
- DO NOT inflate tires with a compressor; use a hand pump.
- DO NOT stand in front of tire assembly when inflating. Use a clip-on chuck and extension hose long enough to allow you to stand to one side.
- DO NOT mount a tire without proper equipment and experience.

CHECK FASTENERS

Check for loose or missing hardware.

CHECK MOWER BLADES

Check blades for wear. Replace or sharpen as needed.



CAUTION: AVOID INJURY. Use sturdy gloves or padding to protect hands when working with mower blades.

Rotation of one blade rotates the other blades.

Remove Blades

See Figure 19.

1. Stop engine, remove key and wait for all moving parts to stop and for hot parts to cool.
2. Remove hardware securing blades to spindles and remove blades. Retain all hardware for reinstallation.

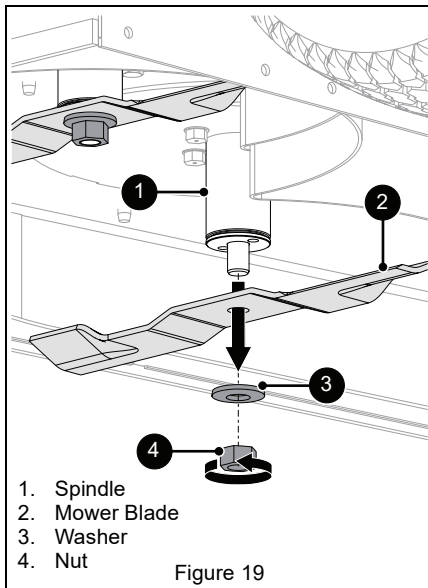
**Sharpen Blades**

CAUTION: DO NOT sharpen blades while attached to unit.

See Figure 20.

1. Remove blades from unit. Discard blades if:
 - More than 1.3 cm (1/2") of metal is removed.
 - Air lifts are eroded.
 - Blades are bent or broken.
2. File or grind an equal amount of material from each cutting edge of the blade until sharp. DO NOT change angle of cutting edge or round the corner of the blade.

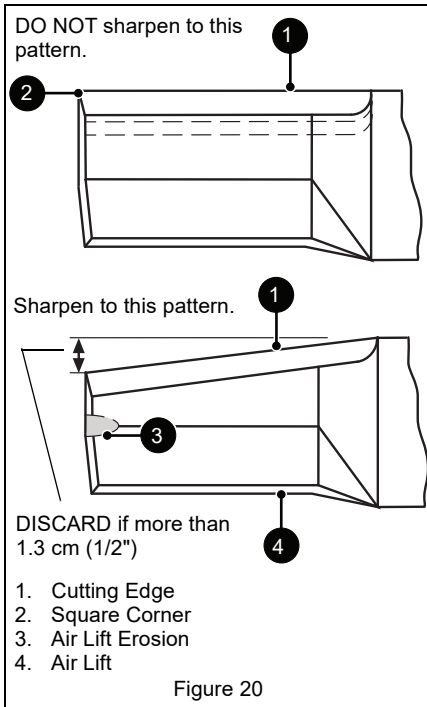

CAUTION: Unbalanced blades cause excessive vibration and eventual damage to unit. Balance blades before reinstalling on unit. NEVER weld or straighten blades.

3. Check blade balance by sliding blade on an unthreaded bolt. If blade does not remain horizontal, sharpen the heavy end until blade is balanced.

Install Blades

1. Reinstall blades, washers and nuts on spindles. See Figure 19.
2. Torque bolts to 136 N•m – 163 N•m (100 lb-ft – 120 lb-ft).

CHECK BATTERY



WARNING: Battery posts, terminals and related accessories contain lead and lead compounds, chemicals known to the State of California to cause cancer and reproductive harm. Wash hands after handling.

Remove Battery

1. Place unit in service position. See *Service Position* on page 19.
 2. Disconnect the negative cable and then the positive cable from the battery.
- See Figure 21.
3. Remove hardware retaining battery bracket and remove bracket. Retain all parts for reinstallation.
 4. Remove battery.

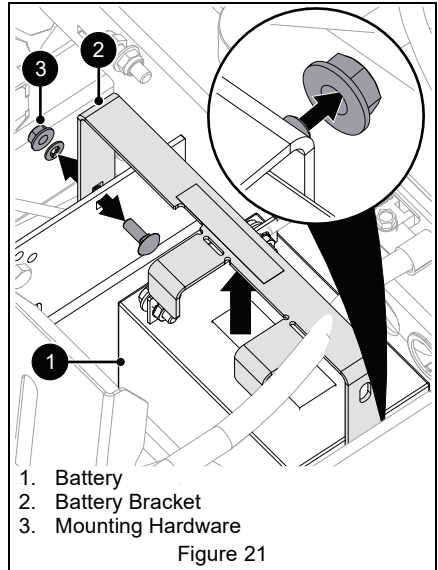

Install Battery

Install Factory Battery

See Figure 21.

1. Reinstall battery into unit.
2. Install battery bracket over battery and onto bolts in battery tray. Secure with original hardware.
3. Connect positive cable to positive battery terminal and then the negative cable to negative battery terminal.
4. Return seat to operating position.

Clean Battery

1. Remove battery from unit. See *Remove Battery* on page 21.
2. Clean terminals and battery cable ends with a wire brush.
3. Coat terminals with dielectric grease or petroleum jelly.
4. Reinstall battery. See *Install Battery* on page 21.

Charge Battery

Check battery with a voltmeter. If battery is less than 11 volts, charge battery.

NOTICE: DO NOT fast charge. Charging at a higher rate damages or destroys the battery. ONLY use an automatic charger designed for use with your battery.

IMPORTANT: Always follow information provided on battery by battery manufacturer. Contact battery manufacturer for detailed information about charging.

IMPORTANT: Ariens does not recommend jump starting your unit. Jump-starting can damage engine and system components. Refer to engine manual for detailed information.

1. Remove battery from unit. See *Remove Battery* on page 21.
2. Place battery on bench or other well-ventilated area.
3. Connect positive lead of charger to positive battery terminal.
4. Connect negative lead of charger to negative battery terminal.
5. Charge battery following battery manufacturer's instructions.
6. Reinstall battery. See *Install Battery* on page 21.

CHECK MOWER BELTS

Check belts for wear and replace as needed.

Remove Deck Drive Belt



CAUTION: Keep body parts away from idler when releasing idler spring tension.

1. Stop engine, remove key and wait for all moving parts to stop and for hot parts to cool.
 2. Lower deck to lowest cutting height.
- See Figure 22 and Figure 24.

3. Remove self-tapping screws from each belt cover and remove belt covers. Retain all parts for reinstallation.
4. Disconnect idler spring.

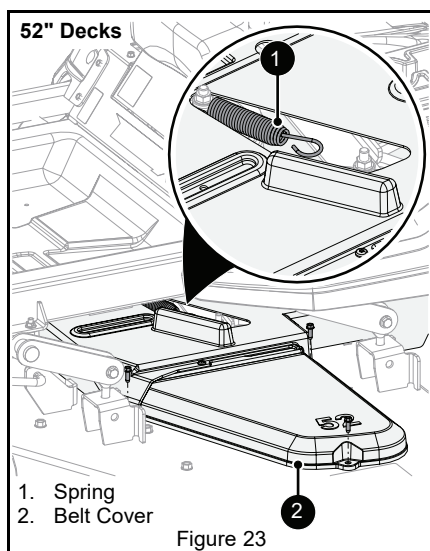
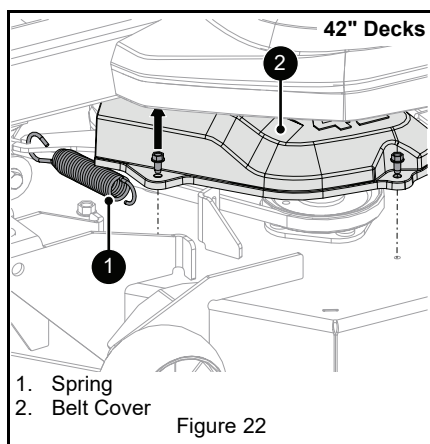

5. Remove hardware retaining idler arm and two belt fingers from mower deck and remove idler arm and belt fingers. Retain all parts for reinstallation. See Figure 24 and Figure 25.

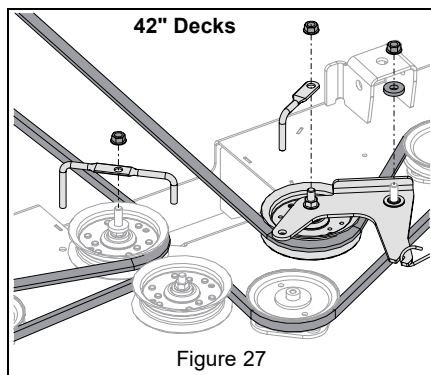
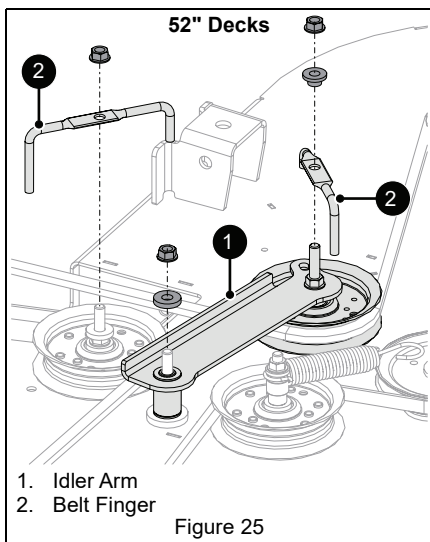
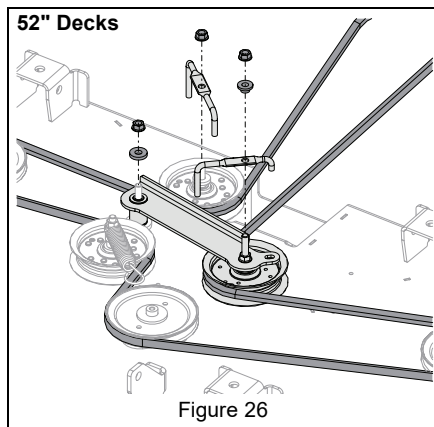
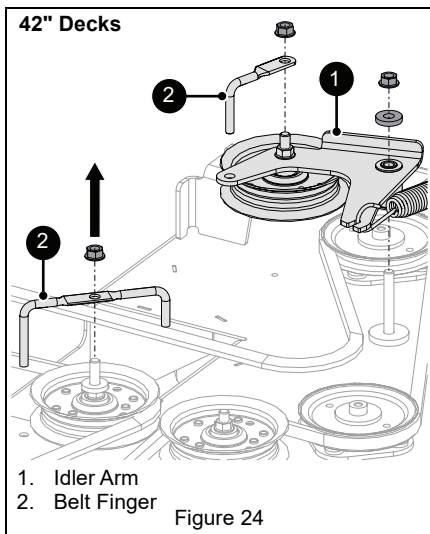

3. Connect idler spring.
See Figure 28 and Figure 29.

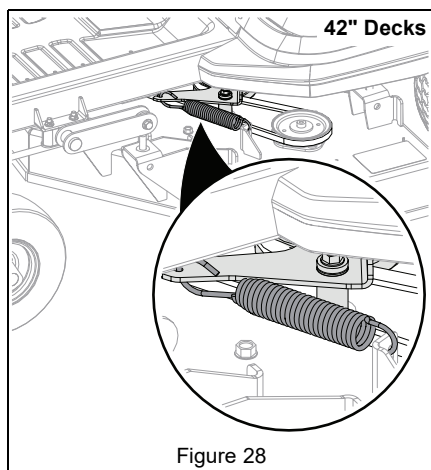

6. Remove deck drive belt.

Install Deck Drive Belt

See Figure 26 and Figure 27.

1. Install deck drive belt.

IMPORTANT: Belt will not have tension until routed around drive pulley and idler arm is reinstalled.

2. Reinstall idler arm and belt fingers.

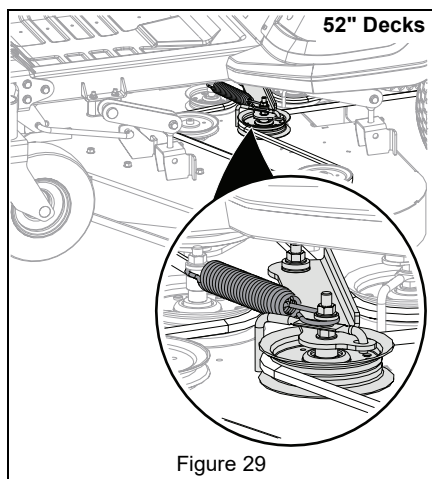

Figure 29

4. Reinstall belt covers and secure each with self-tapping screws removed earlier.

IMPORTANT: Make sure belt has tension and remains aligned after installation is complete.

Remove Ground Drive Belt

IMPORTANT: Retain all parts for reinstallation.

1. Place unit in service position. See *Service Position* on page 19.
2. Remove deck drive belt. See *Remove Deck Drive Belt* on page 22.
3. Position deck at lowest cutting height.
4. Loosen nut on eye bolt and disconnect idler arm spring. See Figure 30.

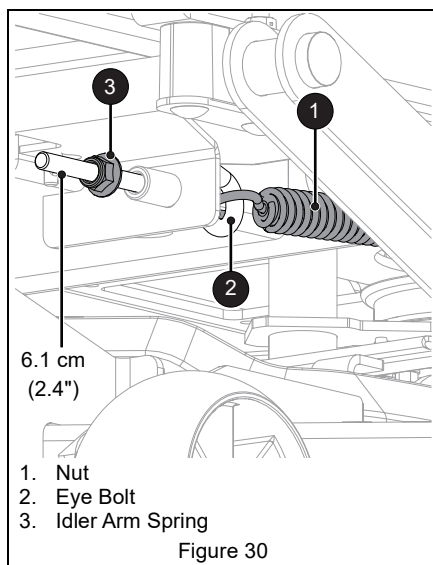

Figure 30

See Figure 31.

5. Remove the right-side self-tapping screw from heat shield and rotate shield out of the way.
6. Remove two self-tapping screws from clutch stop bracket and remove bracket.

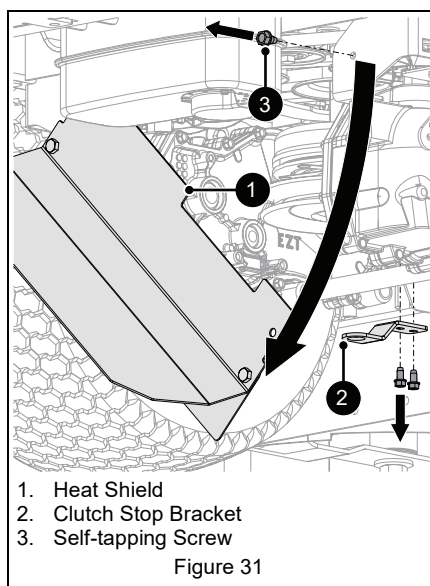

Figure 31

7. Disconnect clutch wire.
8. Remove ground drive belt.

NOTICE: Route the belt over the top of the pulleys for easiest removal.

Install Ground Drive Belt

1. Install ground drive belt. See Figure 32.

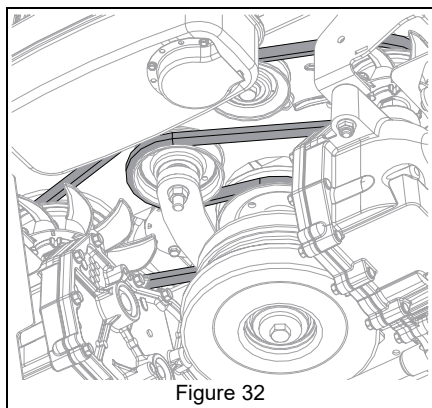

Figure 32

2. Reconnect clutch wire.
3. Reinstall clutch stop bracket and secure with two self-tapping screws removed earlier.
4. Rotate heat shield into position and secure to unit with self-tapping screw removed earlier.
5. Reconnect idler arm spring to eye bolt and secure bolt to unit with nut. Tighten until the nut is 6.1 cm (2.4") from the threaded end of the eye bolt. See Figure 30.
6. Reinstall deck drive belt. See *Install Deck Drive Belt* on page 23.

ADJUSTMENTS



WARNING: AVOID INJURY.
Read and understand the
Safety section before
proceeding.

ADJUST SEAT

See Figure 33.

1. Tip seat forward.
2. Loosen the two wing knobs located at the front of the seat plate.
3. Adjust seat to desired position.
4. Tighten wing knobs.

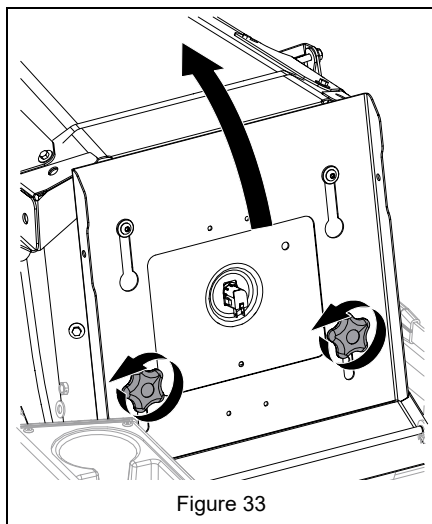

Figure 33

5. Return seat to operating position.

ADJUST STEERING LEVERS

Adjust Steering Lever Height

See Figure 34.

1. Remove hardware securing steering lever to upper control arm.
2. Place steering lever in desired adjusting hole.
 - Use upper and middle holes for highest lever position.
 - Use middle and lower holes for lowest lever position.
3. Reinstall hardware in upper control arm.
4. Align levers side to side. See *Adjust Steering Level Reach* on page 26.
5. Fully tighten hardware.

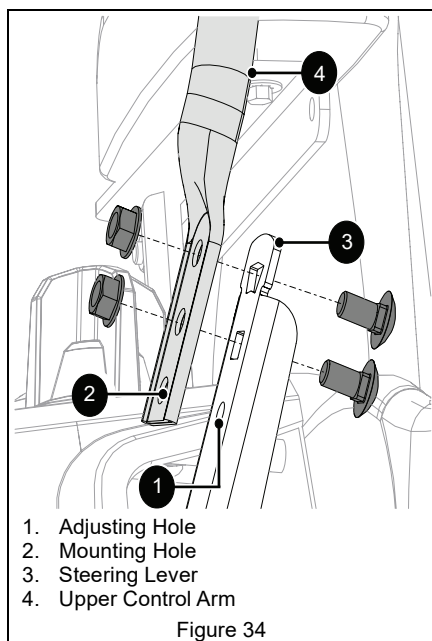

See Figure 35.

1. Loosen lock nut on height-adjustment bolt.
2. Turn bolt in or out until levers are at the same height.
3. Tighten lock nut.

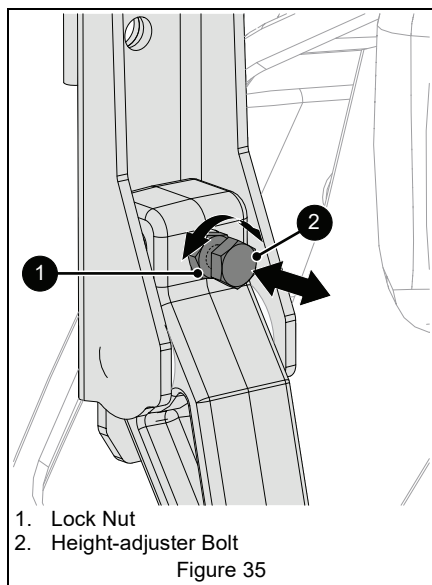

Adjust Steering Level Reach

See Figure 36.

1. Loosen hardware securing steering lever to upper control arm.
2. Pivot steering lever to desired position.
3. Ensure levers are aligned with each other.
4. Tighten hardware.

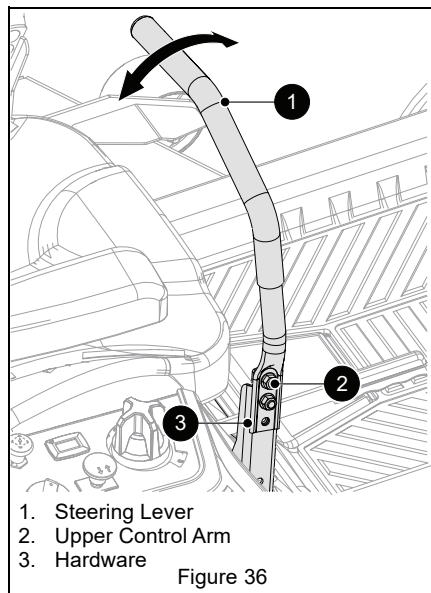

ADJUST UNIT TO TRACK STRAIGHT

Check Tire Pressure

1. Check pressure of both tires. See *Specifications* on page 34 for recommended tire pressure.
2. Recheck unit tracking. If unit still does not track straight, note which side the unit pulls toward and increase the tire pressure on that side.

IMPORTANT: DO NOT exceed maximum tire pressure listed on tire sidewall.

If increasing tire pressure on one side does not correct tracking problem, adjust the steering levers.

Adjust Steering Levers

See Figure 37.

If adjusting tire pressure did not correct tracking problem:

1. Loosen jam nut on adjustment bolt of steering lever that needs adjustment.
2. Adjust drive wheel speed.
 - Turn adjustment bolt counterclockwise to increase steering lever travel and drive wheel speed.
 - Turn adjustment bolt clockwise to decrease steering lever travel and drive wheel speed.
3. Tighten jam nut.

IMPORTANT: Adjustment bolt must contact steering lever. **DO NOT** turn adjustment bolt too far counterclockwise.

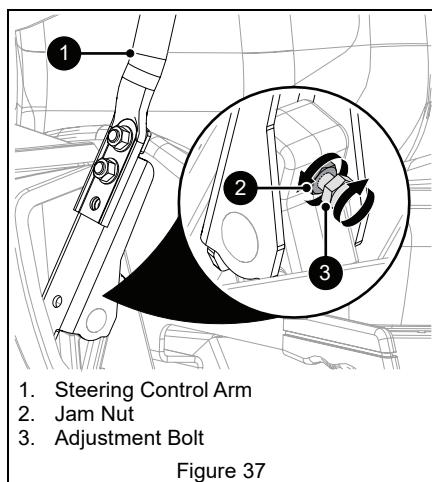

ADJUST PARKING BRAKE LEVER

1. Park unit on a flat, level surface and chock wheels so unit cannot roll.
 2. Position deck at lowest cutting height.
- See Figure 38.
3. Loosen upper jam nut and adjust lower nut up or down until brake lever functions correctly.
 4. Tighten upper jam nut against lower nut.
 5. Return seat to operating position.

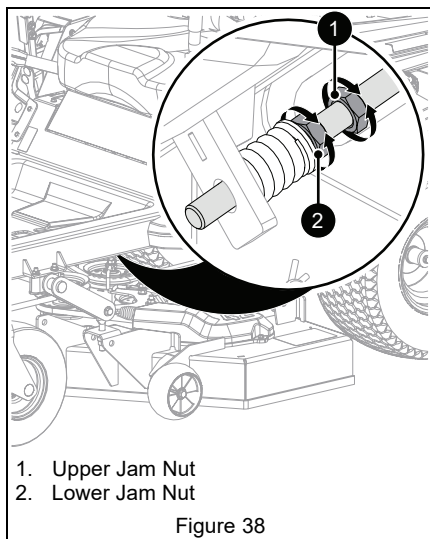

REMOVE AND INSTALL MOWER DECK

Remove Deck

1. Set deck to lowest cutting height.
 2. Position supports, such as wood blocks, under mower deck.
- See Figure 39 and Figure 40.
3. Remove three self-tapping screws from left belt cover and remove belt cover. Retain all parts for reinstallation.
 4. Disconnect idler spring.

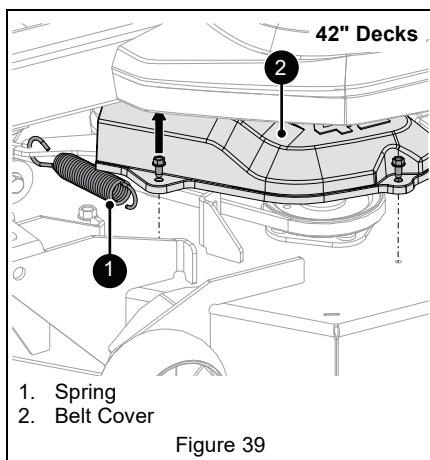

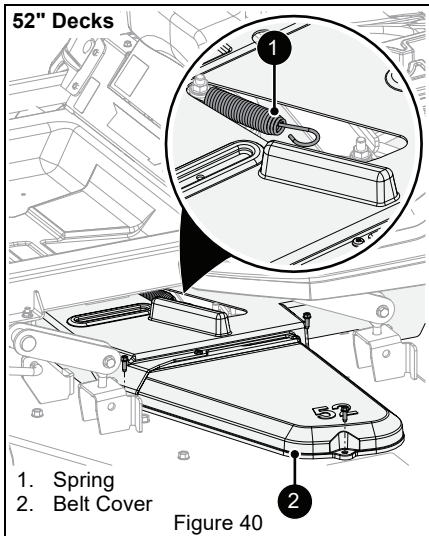

5. Remove deck drive belt from rear drive pulley. See Figure 41.

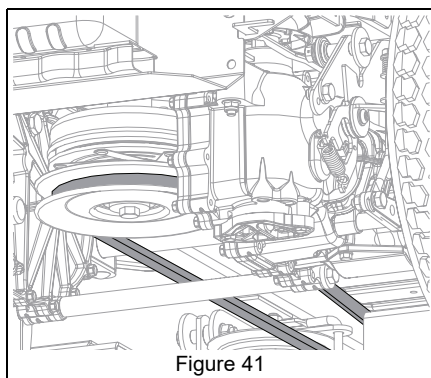

See Figure 42.

6. Remove one hairpin from drag link to disconnect drag link from mower deck bracket. Retain all parts for reinstallation.
7. Repeat step 6 on other side.

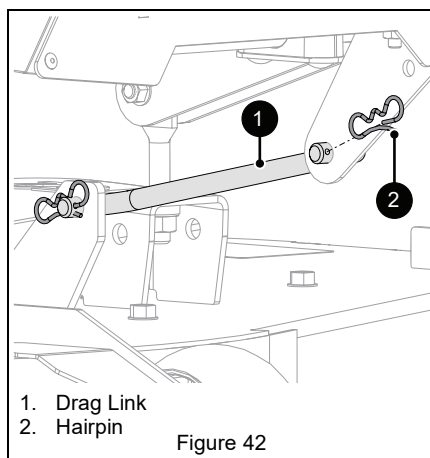

8. Remove one hair pin and one nylon flat washer from deck lift lever. Retain hardware for reinstallation. See Figure 43.

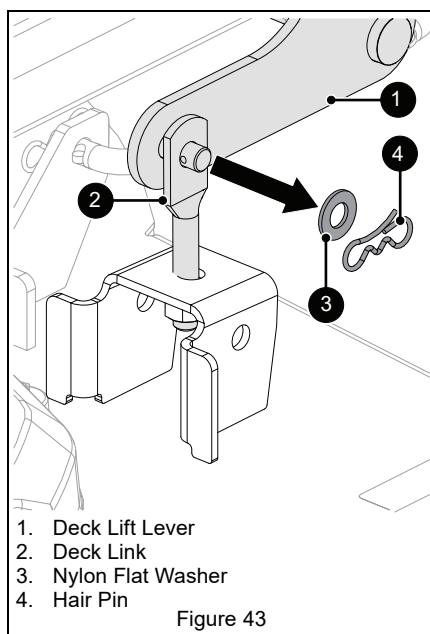

9. Repeat step 8 for the three remaining deck lift levers.
10. Move deck from under unit.

Install Deck

1. Position deck under unit.

See Figure 44.

2. Secure deck lift lever to deck link using original hardware.

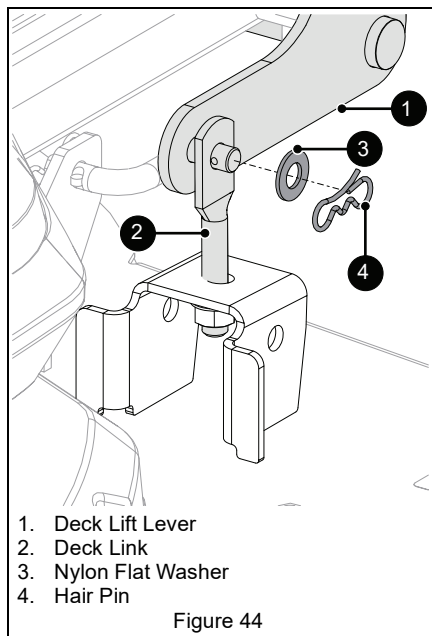

3. Repeat step 2 for the three remaining deck lift levers.
4. Reinstall drag link through mower deck bracket and secure with hairpin removed earlier. See Figure 44.
5. Repeat step 4 on other side.
6. Secure drive belt around drive pulley.
7. Connect idler spring.
8. Reinstall belt cover and secure with three self-tapping screws removed earlier.

ADJUST MOWER DECK



CAUTION: AVOID INJURY. Use sturdy gloves or padding to protect hands when working with mower blades.

Rotation of one blade rotates the other blades.

Level Mower Deck

IMPORTANT: Make sure unit is on a flat, level surface and that tires are inflated to the recommended pressures. See *Specifications* on page 34.

1. Set deck to highest cutting height.
2. Position mower blades so blade ends point left to right across the width of the deck.
3. On both sides of the unit, measure the distance to the ground at the cutting edge of the blade. See Figure 45.

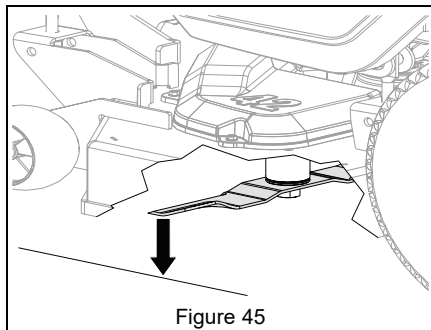

- If the measurements are ± 0.635 cm (1/4") of one another, no adjustment is needed.
- If adjustments are needed, adjust the center locking flange nut on the deck link. Tighten the nut to raise the deck; loosen the nut to lower the deck. See Figure 46.

IMPORTANT: It may be necessary to adjust the nut on more than one of the deck links.

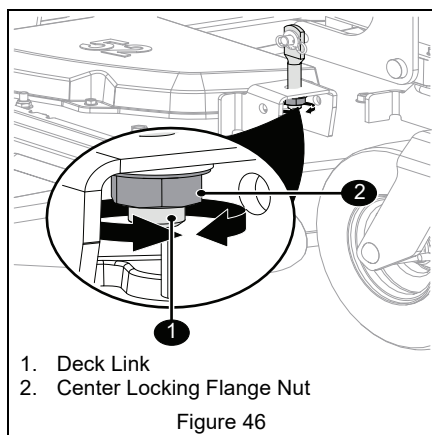

Set Blade Pitch

Pitch is the difference in blade height from front to back.

IMPORTANT: Level the mower deck before setting blade pitch.

1. Set deck to highest cutting height.
2. Position mower blades so blade ends point front to back.
3. On both sides of the unit, measure the distance to the ground at the front and rear tip of the blade. See Figure 47.

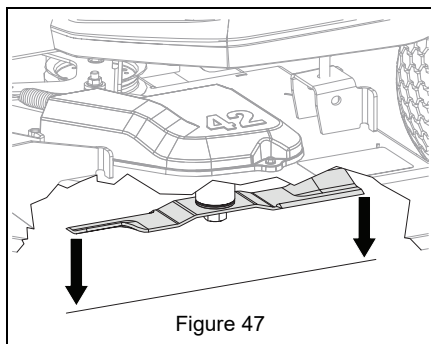

- If the front tip of the blade is ± 0.635 cm (1/4") lower than the rear, no adjustment is needed.
- If adjustments are needed, adjust the nylon locking flange nut on the deck link. Tighten the nut to raise the deck; loosen the nut to lower the deck. See Figure 46.

TROUBLESHOOTING

Problem	Probable Cause	Correction
Engine does not start.	Safety Interlock System is not engaged or is faulty.	Check Safety Interlock System. See <i>Check Safety Interlock System</i> on page 19.
	Fuel tank is empty.	Fill fuel tank. See <i>Before Operating Unit</i> on page 16.
	Fuel supply is contaminated.	Replace with clean fuel.
	Battery is discharged.	Charge battery. See <i>Charge Battery</i> on page 22.
	Connection between battery and battery cables is poor.	Tighten and/or clean battery and battery cables. See <i>Clean Battery</i> on page 22.
	Spark plug wire(s) are loose or spark plug(s) are faulty.	Connect spark plug wire(s) or replace spark plug(s). Refer to engine manual.
	Electrical system is faulty.	Contact your Ariens dealer.
	Engine is faulty.	Contact your Ariens dealer.
Engine runs rough.	Choke control knob is in on position.	Move knob to off position.
	Air filter cartridge is plugged.	Clean or replace air filter cartridge. Refer to engine manual.
	Engine is faulty.	Contact your Ariens dealer.
Engine overheats.	Engine oil level is low.	Add engine oil. Refer to engine manual.
	Cooling fins are plugged.	Clean engine. Refer to engine manual.
	Engine is faulty.	Contact your Ariens dealer.
Unit does not drive.	The transaxles are bypassed.	Engage levers. See <i>Move Unit Manually</i> on page 18.
	Ground drive belt is faulty.	Contact your Ariens dealer.
	Transaxles are faulty.	Contact your Ariens dealer.
PTO malfunctions.	Operator presence switch is not engaged.	Activate switch by sitting on operator seat.
	Operator presence switch is faulty.	Contact your Ariens dealer.
	Deck drive belt is faulty.	Replace deck drive belt. See <i>Remove Deck Drive Belt</i> on page 22.
	PTO switch, wiring, connectors or clutch are faulty.	Contact your Ariens dealer.
Unit moves with engine off and parking brake engaged.	Parking brake needs adjustment.	Adjust parking brake lever. See <i>Adjust Parking Brake Lever</i> on page 27.
	Parking brake is faulty.	Contact your Ariens dealer.
Unit does not track straight.	Tire pressure is incorrect.	Check tire pressure. See <i>Specifications</i> on page 34.
	Steering levers need adjustment.	See <i>Adjust Steering Levers</i> on page 25.
	Transaxles and/or linkages need adjustment.	Contact your Ariens dealer.
Unit creeps when steering levers are in neutral position.	Transmission and/or linkage need adjustment.	Contact your Ariens dealer.

TROUBLESHOOTING

Problem	Probable Cause	Correction
Poor cutting quality.	Mower blades not level or mower deck pitch is incorrect.	Level and adjust pitch of mower deck. See <i>Adjust Mower Deck</i> on page 29.
	Mower blades are dull or faulty.	Sharpen or replace mower blades. See <i>Sharpen Blades</i> on page 20.
	Mowing speed is too fast.	Drive slower when cutting grass.
	Belt tension or condition is poor.	Replace deck drive belt. See <i>Check Mower Belts</i> on page 22.
	Cutting height is too low.	Do not set height of cut too low. For very tall grass, mow twice.

STORAGE

SHORT-TERM STORAGE

IMPORTANT: NEVER wash unit with high-pressure water or store outdoors.

1. Allow unit to cool and clean with mild soap and water.
2. Tighten all hardware to correct specifications.
3. Inspect unit for visible signs of wear or damage. Repair as needed.
4. Prepare fuel system for storage.

NOTICE: Arians recommends using a quality fuel stabilizer in all fuel. Gasoline left in the fuel system without a stabilizer, even for short periods of time, deteriorates and leaves gummy deposits in the system that may damage the carburetor and fuel hoses, filter and tank. For the best effectiveness, add stabilizer to all fuel containers whenever purchasing fuel. Add the stabilizer to the container before adding fuel.

- a. Add fuel stabilizer (see *Service Parts* on page 19) or equivalent according to manufacturer's instructions to the fuel tank and any fuel containers with remaining fuel.
 - b. Run engine outdoors for at least 5 minutes to allow stabilizer to reach the carburetor.
5. Turn ignition key to off position and remove from ignition.
 6. Store unit in a cool, dry, protected area. DO NOT store unit outdoors.

LONG-TERM STORAGE

1. Perform short-term storage procedures.
2. Lubricate as directed in *Maintenance* on page 18.
3. Touch-up all scratched painted surfaces.
4. Remove and charge battery as directed in *Charge Battery* on page 22. Store battery in a cool, dry, protected area.
5. Store unit in a cool, dry, protected area. Do not store unit outdoors.

START-OF-SEASON PREPARATION

1. Before adding fuel for the first time after long-term storage, add fresh, stabilizer-treated fuel to fuel tank and any fuel containers with remaining fuel.
2. Charge and install the battery.

ACCESSORIES

See your Arians dealer for a complete list of compatible accessories and attachments for your unit.

Description	Part No.
Mulch Kit – 42"	71513900
Mulch Kit – 52"	71514000
Headlight Kit	71514100
Trailer Hitch Kit	71514900

SPECIFICATIONS

Model Number	915340	915341
Model	IKON XD 42	IKON XD 52
Engine	Kawasaki FR651V	Kawasaki FR691V
Nominal Power – kW	13.9	16.5
Engine Displacement – cm ³ (in ³)	726.0 (44.3)	
Maximum RPM	2600	3100
Oil Capacity	Refer to Engine Manual	
Drive		
Forward Maximum – km/h (mph)	11.3 (7.0)	
Reverse Maximum – km/h (mph)	4.8 (3.0)	
Turning Radius	Zero	
Brakes	Internal Transmission	
Electrical		
Starter	Electric	
Battery	12V Maintenance-Free 190CCA (U1 Replaceable)	
PTO (Power Take-off)	Electric	
Fuel		
Fuel Tank Capacity – Liter (gal)	10.5 (2.8)	
Size and Weight		
Length – cm (in)	196.9 (77.5)	
Width – cm (in)	137.7 (54.2)	161.0 (63.4)
Weight – kg (lbs)	258.5 (570.0)	279.0 (615.0)
Height – cm (in)	103.9 (40.9)	
Tires		
Front Tire Size – in	11 x 4-5	
Rear Tire Size – in	20 x 8-8	20 x 10-8
Recommended Front Tire Pressure – kPa (psi)	262 – 317 (38 – 46)	
Recommended Rear Tire Pressure – kPa (psi)	62 – 76 (9 – 11)	
Mower Deck		
Cutting Height – cm (in)	3.8 – 11.4 (1.5 – 4.5)	
Cutting Width – cm (in)	106.7 (42.0)	132.1 (52.0)
Mower Deck Lift	Foot Operated	
Transmission		
Type	Maintenance-Free Hydro-Gear® EZT Transaxles	

CE Sound and Vibration (Ref. EN ISO 5395-1: 2013 + A1:2017 + A2:2018)		
Oper. Ear Sound Pressure (Lpa) in dBA	87	91
Uncertainty in dBA	3.75	3.75
Measured Sound Power Level (Lwa) in dBA	99	104
Uncertainty in dBA	1.11	1.22
Vibration Measure (m/s^2) at Operator Hands	2.85	2.95
Guaranteed Sound Power Level (Lwa) in dBA	100	105
Uncertainty in (m/s^2)	1.43	1.48
Vibration Measure (m/s^2) at Operator Seat	0.31	0.26
Uncertainty in (m/s^2)	0.16	0.13



ARIENS®

Outdoor Power Equipment Limited Warranty

AriensCo warrants to the **original purchaser** that Ariens brand products purchased on or after 09/01/2022 will be free from defects in material and workmanship for the time period noted in the chart below. Equipment put to personal use around a single household or residence is considered "Residential Use." Equipment put to any business use (agricultural, commercial, or industrial) or used at multiple locations is considered "Commercial Use." If any product is rented or leased, then the duration of these warranties shall be 90 days after the date of purchase.

An authorized Ariens dealer will repair any defect in material or workmanship, and repair or replace any defective part, subject to the conditions, limitations and exclusions set forth herein. Such repair or replacement will be free of charge (labor and parts) to the original purchaser; except as noted below. Pick-up and delivery are at the owner's expense.

The warranty code is found on the model and serial number identification label on the unit.

Warranty Code	Product Group	Warranty Period
AA	Serialized Attachments	1 Year.
CH, CQ	ZENITH Mowers	4 Years or 750 Hours.*
HD	RAZOR Walk-Behind Mowers	3 Years Residential Use. 90 Days Commercial Use.
HE	EDGE Mowers	2 Years or 150 Hours.*
HF	IKON Mowers	3 Years or 300 Hours.*
HH	APEX Mowers	4 Years or 500 Hours.*
HI	RAZOR Walk-Behind Mowers	4 Years Residential Use. 90 Days Commercial Use.
PA	921-Series Brushes	3 Years Residential Use. 90 Days Commercial Use.
PB	926-Series Brushes	3 Years Residential Use. 1 Year Commercial Use.
SA	Professional Sno-Thro	3 Years Residential Use. 1 Year Commercial Use.
SB	Compact, Deluxe and Platinum Sno-Thro and Path-Pro	3 Years Residential Use. 90 Days Commercial Use.
SC	S18	2 Years Residential Use. 90 Days Commercial Use.
SD	Deluxe and Platinum EFI Sno-Thro	3 Years Residential Use. 90 Days Commercial Use.
SE	920-Series Classic Sno-Thro, Crossover	3 Years Residential Use. 90 Days Commercial Use.
SF	MAMMOTH Tractor	2 Years or 500 Hours.*

* Whichever comes first.

Special Extensions

The chart below details special **extensions** to warranty terms. Warranty terms are total time periods covered. If any product is rented or leased, there are no extensions to the 90-day warranty.

Warranty Code	Warranty Term Extension	Warranty Period
SA	Cast Iron Auger Gear Case	5 Years.
SB, SD	Cast Iron Auger Gear Case	5 Years Residential Use. 1 Year Commercial Use.



Exclusions and Limitations

The charts below detail special **exclusions and limitations** to this warranty.

Warranty Term Exclusions	Warranty Period
Air filters, auger paddles, brake arms, brake linings, brake shoes, brushes, cutters, fuel filters, halogen headlights, knives, halogen light bulbs, lubricants, mower blades, oil, oil filters, spark plugs, scraper blades, shear bolts and skid shoes.	Components are not covered under warranty.

Hydro-Gear Transaxle Limitation

See Hydro-Gear warranty. The warranty is administrated by AriensCo. Refer to www.ariens.com for warranty statement.

Warranty Term Limitations	Warranty Period
Cloth, Plastic and Rubber Components. Mufflers, Tires and Belts.	Components are covered for manufacturer's defect only, not wear.
Parker Actuators	1 Year.

Exclusions – Items Not Covered by This Warranty

- Parts that are not genuine Ariens service parts are not covered by this warranty and may void the warranty if the parts result in premature wear or damage to the product.
- Damages resulting from the installation or use of any part, accessory, or attachment which is not approved by AriensCo for use with product(s) identified herein are not covered by this warranty.
- Any misuse, alteration, improper assembly, improper adjustment, neglect, or accident which requires repair is not covered by this warranty.
- Repairs or adjustments required due to failure to use fresh fuel or failure to properly prepare the unit for periods of non-use.
- **Use of gasoline blends exceeding 10% ethanol voids any and all warranties.**
- **Any tampering with the hour meter voids any and all warranties.**
- Products are designed to the specifications in the area that the product was originally distributed. Different areas may have significantly different legal and design requirements. This warranty is limited to the requirements in the area in which the unit was originally distributed. AriensCo does not warrant this product to the requirements of any other area. Warranty service is limited to service within the area originally distributed.
- In countries other than the United States and Canada, contact the AriensCo dealer for warranty policies that govern within your country. Rights may vary from country to country and within any one country.

Evaporative Emissions Control Warranty Exception

As required by the California Air Resources Board (CARB) and the US Environmental Protection Agency (EPA) the evaporative emissions control system is warranted to the ultimate purchaser, and any subsequent owner, for two years.

The CARB and EPA evaporative emissions control system warranty is described in a separate evaporative emission control warranty statement.

Battery Warranty

Battery warranty is one year. Units used for rental or lease have no exceptions to the 90-day warranty. Total battery claim reimbursement will not exceed 45.00 USD.

Transmissions

The chart below details transmission warranty information. Transmission warranty terms may vary from the specific terms of this warranty. If inconsistent, the terms of the transmission warranty shall apply to the transmission and its component parts.

Transmission Manufacturer	Detail
Hydro-Gear Transaxle	See Hydro-Gear warranty. The warranty is administrated by AriensCo. Refer to www.ariens.com for warranty statement.
Parker Hannifin Drive & Valve Systems	Parker Transaxles, Pumps, Wheel Motors and Valves* are warranted for the length of equipment warranty period. Refer to Warranty Code chart above. Warranty is administered by AriensCo.

* Parker Actuators see Limitations chart above.

Engines

The chart below details engine warranty information. Engine warranty terms may vary from the specific terms of this warranty. If inconsistent, the terms of the engine warranty shall apply to the engine and its component parts.

Engine Manufacturer	Detail
Ariens AX	Ariens-branded engines are warranted by the manufacturer and the warranty is administrated by AriensCo. Refer to the engine manual or www.ariens.com for warranty statements.
Briggs & Stratton, Kawasaki, Kohler	Covered by the engine manufacturer's warranty. Refer to the engine manufacturer's warranty statements.

Parts and Accessories

Service replacement parts and non-serialized accessories are warranted for 90 days from date of purchase. Labor is not included.

Customer Responsibilities

Register the product immediately at the time of sale. If the dealer does not register the product, the customer must register the unit on-line at www.ariens.com.

To obtain warranty service, the **original purchaser** must:

- Ensure that the maintenance and adjustments explained in the Operator's Manual are routinely completed.
- Promptly notify AriensCo or an authorized Ariens service representative of the need for warranty service.
- Transport the product to and from the place of warranty service at owner's expense.
- Have the warranty service performed by an authorized Ariens service representative.

To find an authorized dealer use the dealer locator on our websites, or contact us by mail or phone.

Globally (Except Australia or New Zealand):	Australia:	New Zealand:
AriensCo 655 W. Ryan Street Brillion, WI 54110 Phone: (920) 756 - 4688 www.ariens.com	Roy Gripske & Sons Pty Ltd 11 Sodium Street Narangba Queensland 4504 Australia Phone: (61130) 036 3004 www.rgs.com.au	Masport Ltd 320 Ti Rakau Drive East Tamaki Auckland 2013 New Zealand Phone: 0800 627 7678 www.masport.co.nz

Disclaimer

AriensCo may from time to time change the design of its products. Nothing contained in this warranty shall be construed as obligating the AriensCo to incorporate such design changes into previously manufactured products, nor shall such changes be construed as an admission that previous designs were defective.

Limitation of Remedy and Damages

AriensCo liability under this warranty, and under any implied warranty that may exist, is limited to repair of any defect in workmanship, and repair or replacement of any defective part. AriensCo shall not be liable for incidental, special, or consequential damages (including lost profits). Some states do not allow the exclusion of incidental or consequential damages, so the above limitation or exclusion may not apply to you.

AriensCo shall not be held liable for damages, including premature wear and tear, or injuries caused by installation of unauthorized parts and accessories or for parts and accessories not installed by an authorized Ariens dealer.

Australian Consumer Law

The following applies solely to warranties subject to Subsection 102(1) of the Australian Consumer Law: Our goods come with guarantees that cannot be excluded by the Australian Consumer Law. You are entitled to a replacement or refund for a major failure and for compensation for any other reasonably foreseeable loss or damage. You are also entitled to have the goods repaired or replaced if the goods fail to be of acceptable quality and failure does not amount to a major failure.

Disclaimer of Further Warranty

AriensCo makes no warranty, express or implied, other than what is expressly made in this warranty. If the law of your state provides that an implied warranty of merchantability, or an implied warranty of fitness for particular purpose, or any other implied warranty, applies to AriensCo, then any such implied warranty is limited to the duration of this warranty. Some states do not allow limitations on how long an implied warranty lasts, so the above limitation may not apply to you.

This warranty gives you specific legal rights, and you may also have other rights which vary from region to region.



ARIENS®

655 West Ryan Street
Brillion, WI 54110

www.ariens.com

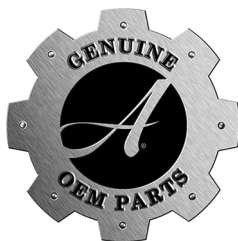

parts.ariens.com

ARIENS|CO

