

Instruction Sheet

Kit Number: 71800900, 71801000, 71801100, 71801700

IKON / ZT X / ZT XL BLOWER UPFIT KIT

	<p>WARNING: FAILURE TO FOLLOW INSTRUCTIONS could result in personal injury and/or damage to unit.</p> <p>Read, understand, and follow all safety practices in Operator's Manual before beginning.</p>
---	--

Package Contents

Check the contents of your kit for the parts listed below
Also see Figure 1.

Item	Description	Qty	AriensCo P/N
1	Blower Assembly (Service Assembly)	1	51802200
2	Blower Guard Mounting Bracket	1	09686751
3	3/8"-18 Clamping Knob	3	07534800
4	4.5" V-Pulley	1	07352700
5	6" V-Pulley	1	07347500
6	Bagger Sheave Adapter	1	30134400
7	Pulley Adapter	1	30134600
8	5/16"-18 x 3/4" Round Head Short Square Neck Bolt	1	06200309
9	5/16"-18 Center Locking Flange Nut	1	06500840
10	7" Bagger Hose Clamp	1	21576400
11	Blower Outlet Adapter	1	09678301
12	1/4"-20 x 3/4" Hex Bolt	2	05901716
13	1/4" x 1/16" Regular Lock Washer	2	06401009
14	5/16"-18 x 1 1/2" Round Head Square Neck Bolt	1	06200233
15	5/16"-18 Spin Lock Flange Nut	1	06500815
16	3/8" x 1 1/2" x 1/16" Flat Special Washer	1	06401028
17	1/2" x 1" x 1/16" Flat Steel Washer	2	06401112
18	Housing Side Guard	1	30178851
19	Housing Door Guard	1	30178951
20	Pop Rivet	9	06800107

Item	Description	Qty	AriensCo P/N
42" Blower Upfit Kit			
21	4L Raw Edge Laminated V-Belt	1	07211600
22	42" Blower Belt Cover	1	09686300
23	42" Blower Close-off Bracket	1	09686851
48" Blower Upfit Kit			
24	HA Wrapped V-Belt	1	07200905
25	48" Blower Belt Cover	1	09686400
26	48" Blower Close-off Bracket	1	09686951
52" Blower Upfit Kit			
27	HA Raw Edge Laminated V-Belt	1	07217700
28	52" Blower Belt Cover	1	09686500
29	52" Blower Close-off Bracket	1	09687051
60" Blower Upfit Kit			
30	4L Raw Edge V-Belt	1	07200042
31	60" Blower Belt Cover	1	09686600
32	60" Blower Close-off Bracket	1	09687151

42" Shown – Other Kits
Similar

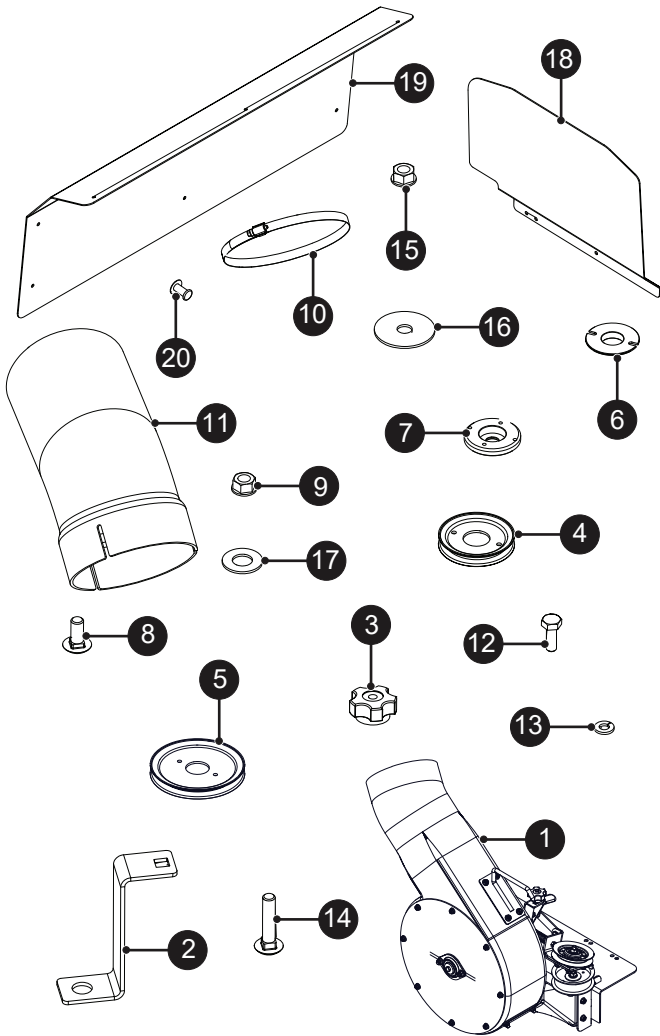
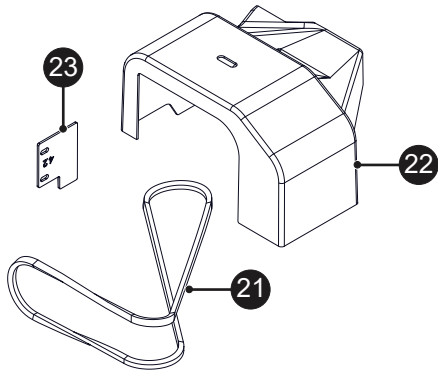

Figure 1

REMOVAL

NOTICE: 48" models shown for removal; other models similar.

1. Park unit on a flat, level surface and engage parking brake.
2. Stop engine, remove key and wait for all moving parts to stop and for hot parts to cool.
3. Rotate discharge chute up to gain access to mounting hardware. See Figure 2.

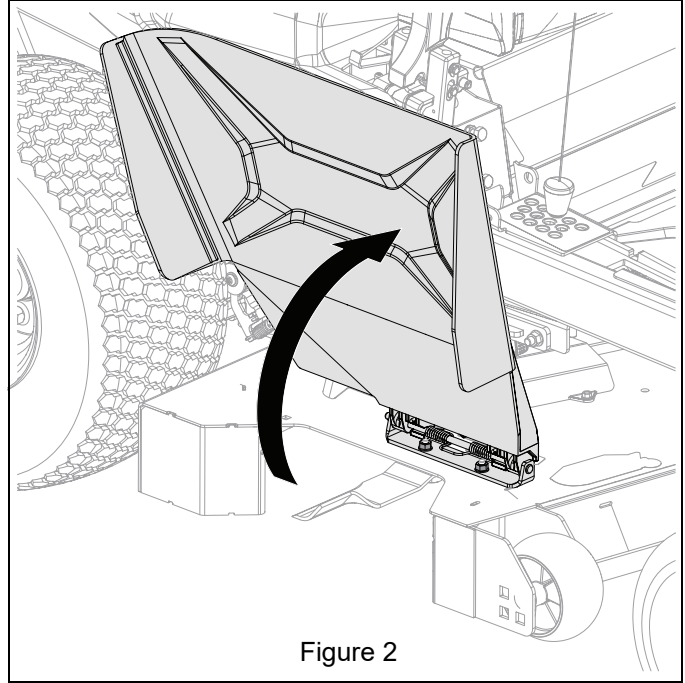

Figure 2

4. Remove hardware securing discharge chute assembly and remove discharge chute. Retain hardware for reinstallation and discharge chute for use without blower upfit kit. See Figure 3.

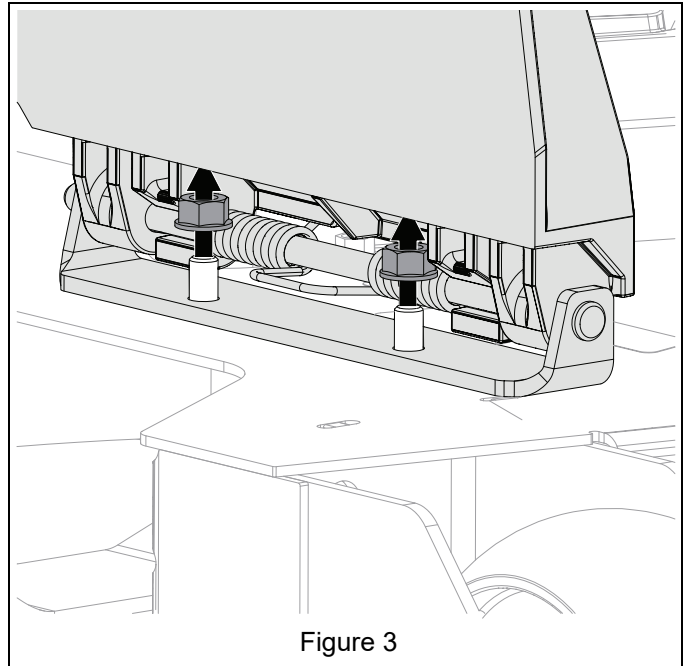
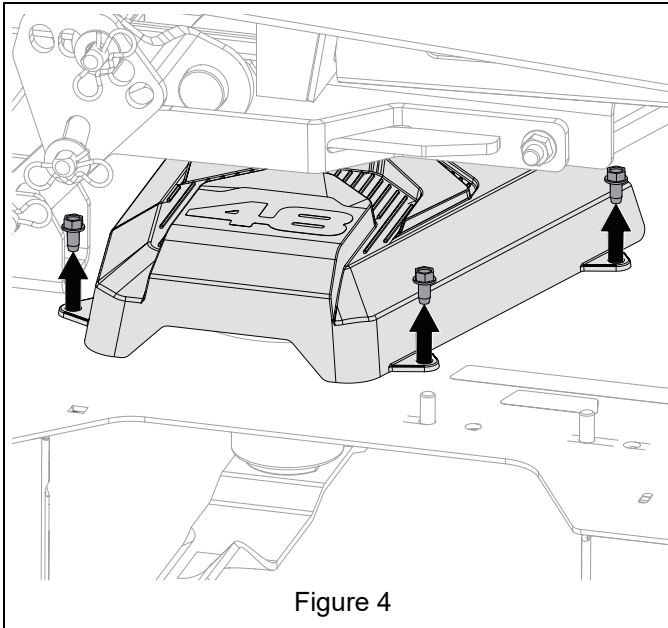
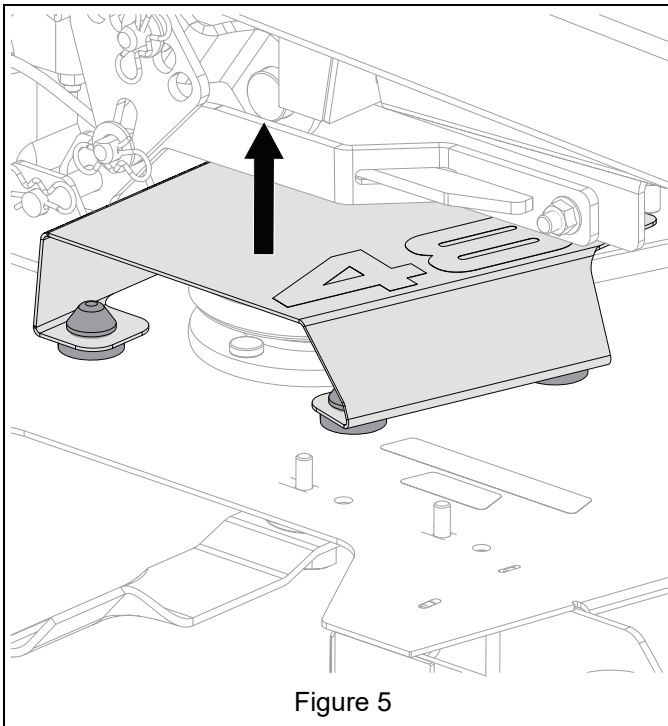

Figure 3

5. *IKON Models Only:* Remove and retain hardware securing belt cover to mower deck. Remove belt cover and retain all parts for use without blower upfit kit. See Figure 4.



6. *ZTX / XL Models Only:* Lift belt cover to remove from mower deck. Retain belt cover for use without blower upfit kit. See Figure 5.



7. Remove and retain one spacer and one hex nut from spindle pulley. Retain hex nut for reinstallation and spacer for use without blower upfit kit. See Figure 6.

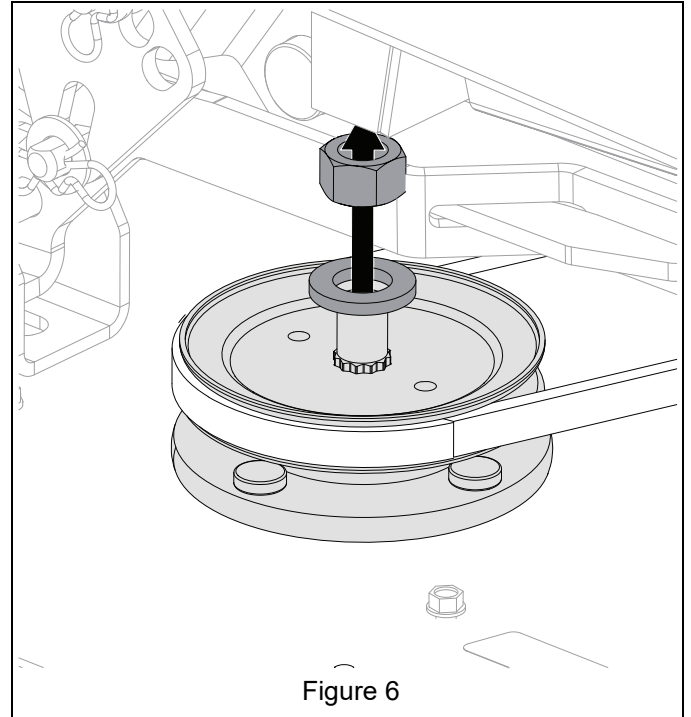

8. Remove and retain two top locking flange nuts, two flat steel washers, and two hex bolts from angle support bracket. See Figure 7.

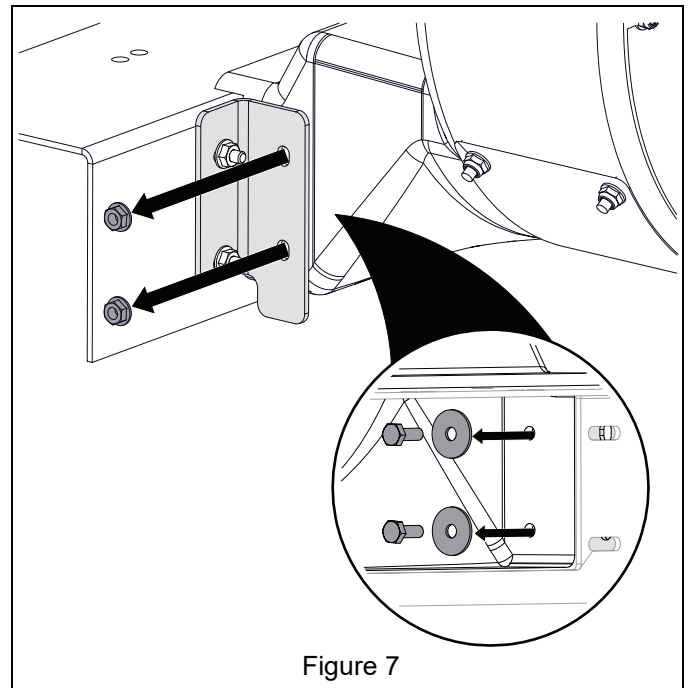

INSTALLATION

Install Close-off Bracket

See Figure 8.

1. Position close-off bracket (item 23, 26, 29, or 32) in front of blower housing.
2. Secure angle support and close-off brackets to blower using hardware removed earlier.

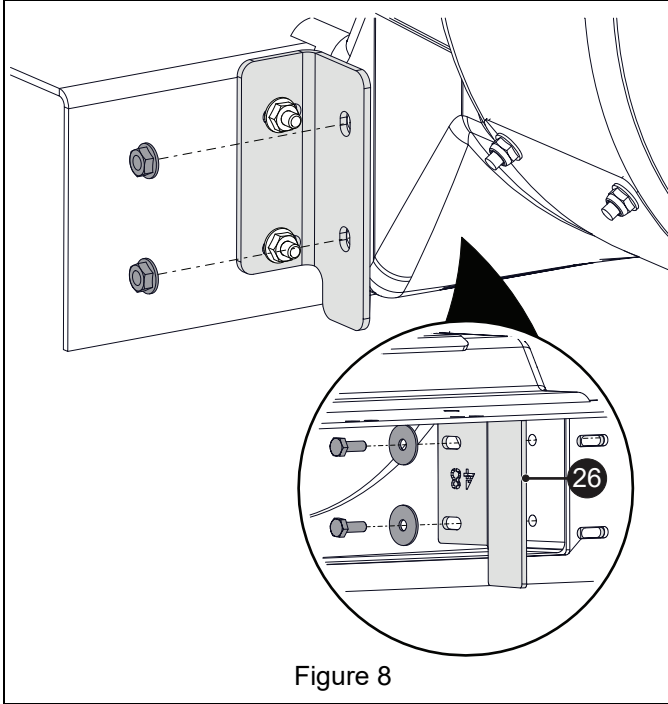

Install Drive Pulley

1. Position pulley adapter (item 7) onto spindle pulley and retain adapter with hex nut removed earlier. The inner cupped surface in the adapter faces down. Torque to 54.2 N•m – 59.7 N•m (40 lb-ft – 44 lb-ft). See Figure 9.

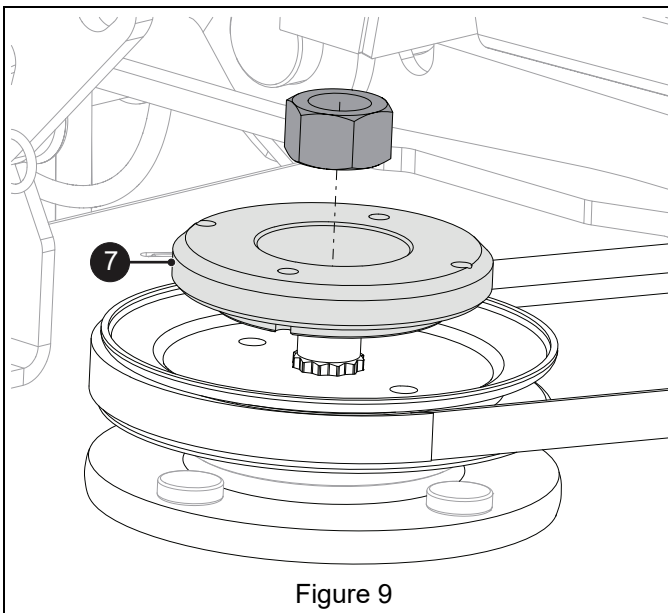

2. Align holes in V-pulley (item 4 or 5) and bagger sheave adapter (item 6) with holes in pulley adapter. The inner cupped surface in the adapter faces down. See Figures 10 and 11.

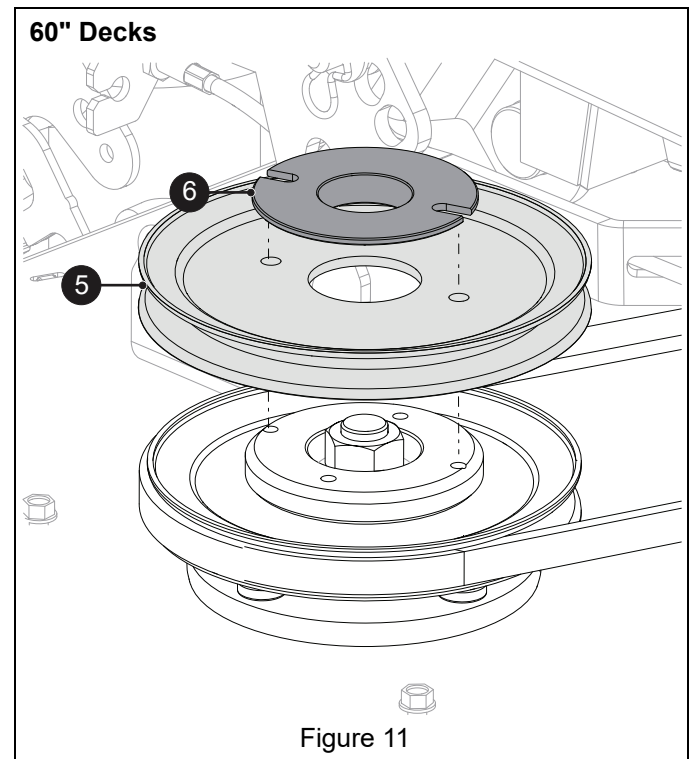
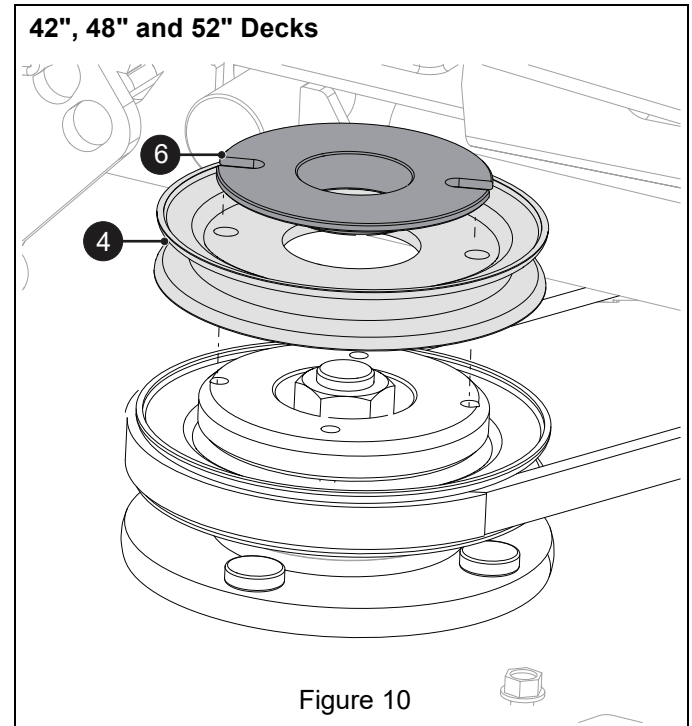

- Secure parts to spindle pulley with two 1/4" x 3/4" hex bolts (item 12) and two 1/4" x 1/16" lock washers (item 13). Torque to 9.5 N•m (7 lb-ft). See Figure 12.

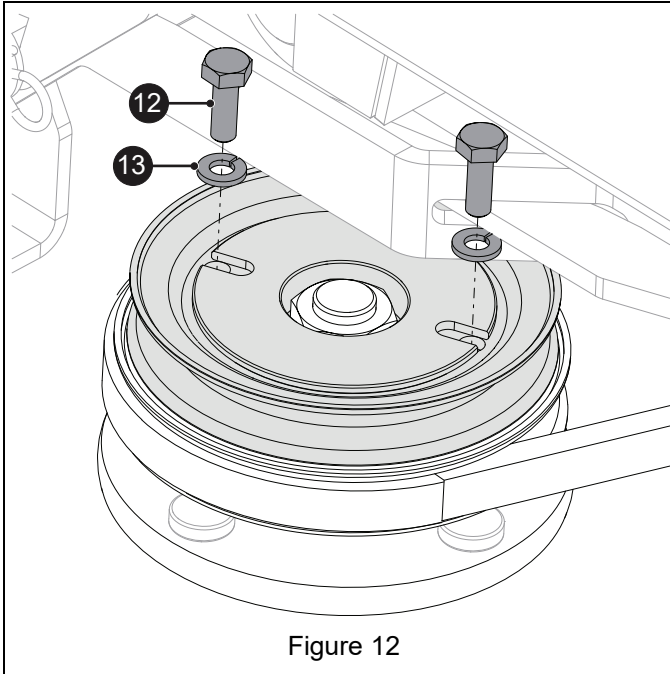

Figure 12

Install Blower Assembly

See Figure 13.

- Secure blower assembly to deck using two clamping knobs (item 3).

IMPORTANT: The mounting location varies depending on deck size. See Figure 13 for correct mounting position.

- 42", 48" and 52" Decks: Install mounting hardware through rear-most holes.
- 60" Decks: Install mounting hardware through forward-most holes.

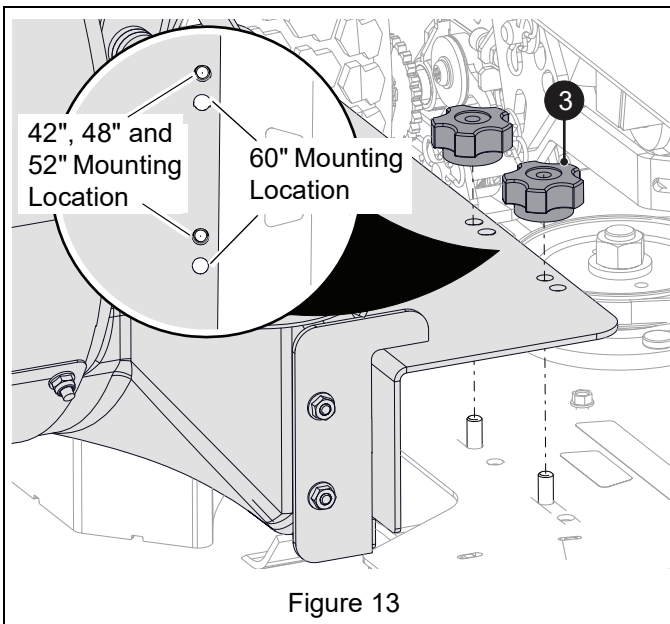

Figure 13

Install Belt Cover Support

- Install one 5/16" x 1 1/2" round head square neck bolt (item 14) through blower guard bracket (item 2) and secure with one 1/2" x 1" x 1/16" flat steel washer (item 17) and one 5/16" spin lock flange nut (item 15). See Figure 14.

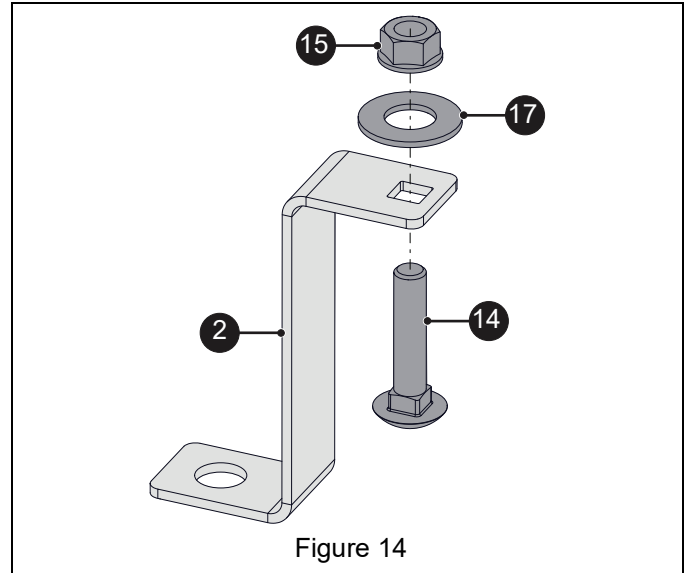

Figure 14

- Locate square hole near discharge opening. Attach belt cover bracket at angle shown using one 5/16" x 3/4" round head square neck bolt (item 8), one 1/2" x 1" x 1/16" flat steel washer (item 17) and one 5/16" center locking flange nut (item 9). DO NOT fully tighten hardware yet. See Figure 15.

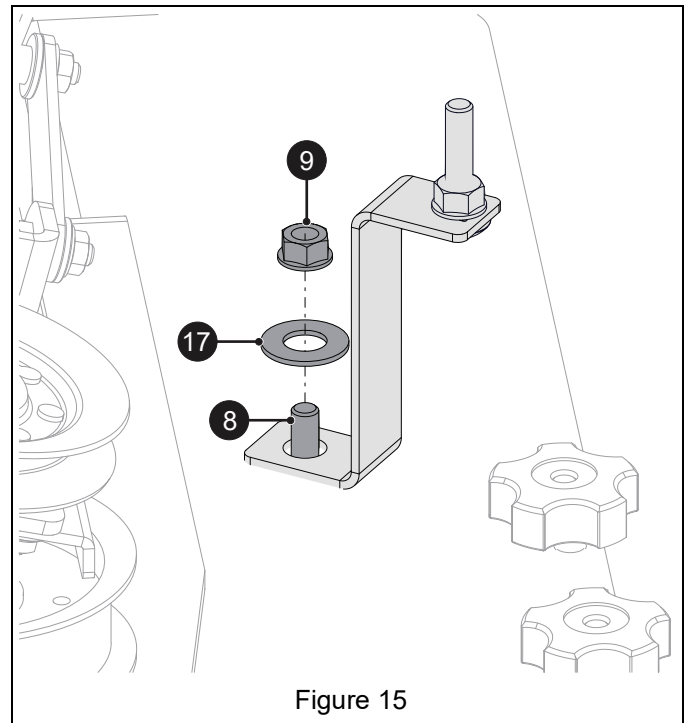
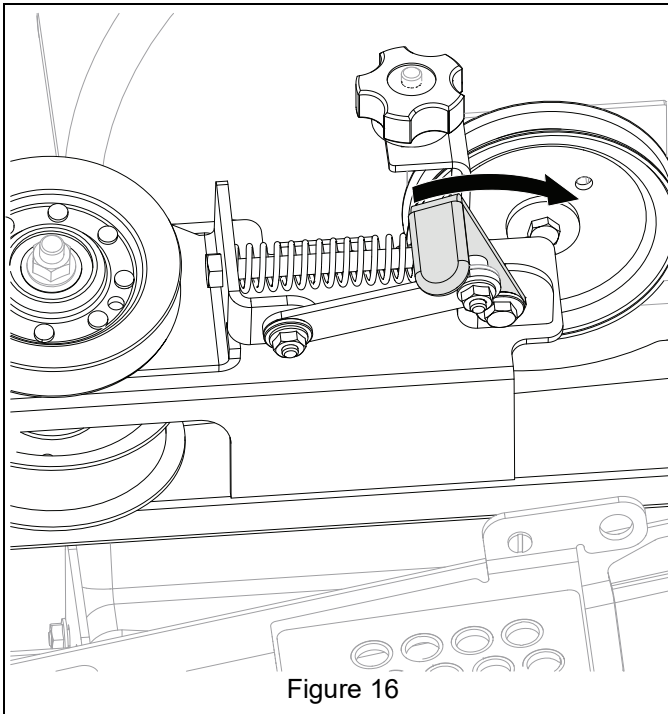

Figure 15

Install Drive Belt

1. Rotate idler assembly lever rearward and down until lever locks into position and fully retracts idler pulley. See Figure 16.



2. Determine the appropriate belt based on mower deck size. The part number is printed on the belt.

42" Decks	07211600
48" Decks	07200905
52" Decks	07217700
60" Decks	07200042

3. Route belt (item 21, 24, 27, or 30) over spindle sheave, idler pulleys and blower drive pulley. See Figure 17 for belt routing.

IMPORTANT: Ensure that belt is routed correctly or blower will not operate correctly.

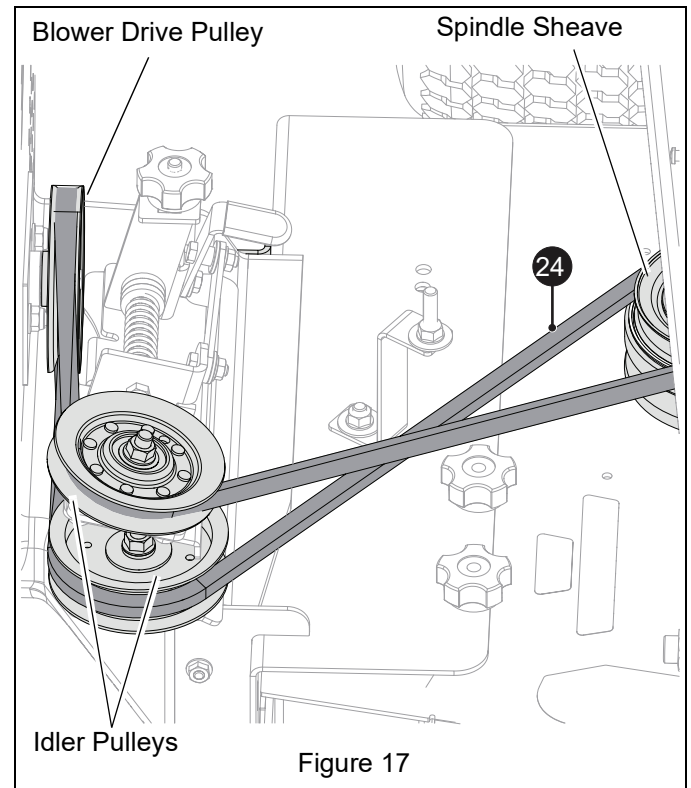

4. Rotate idler assembly lever up and forward to place tension on the belt. See Figure 18.

IMPORTANT: There must be tension on belt for blower to operate.

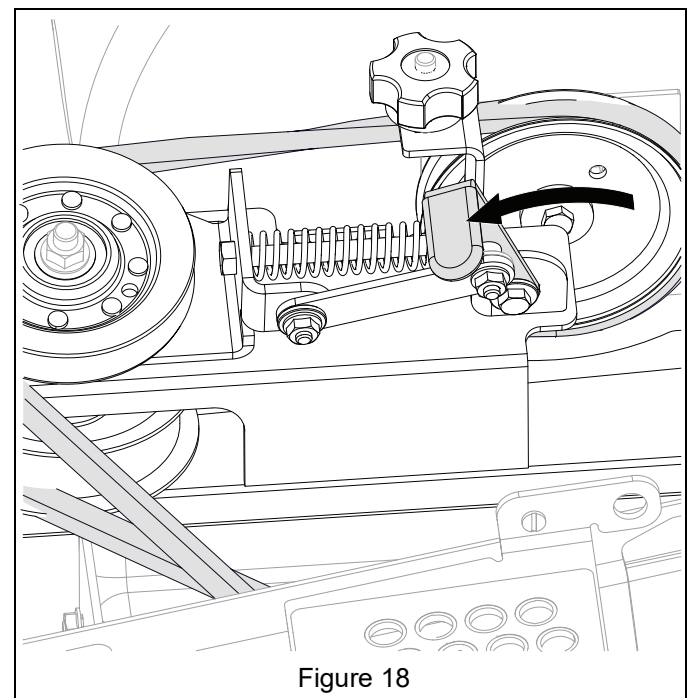

Install Belt Cover

1. Remove and retain clamping knob from idler bracket. DO NOT remove washer. See Figure 19.

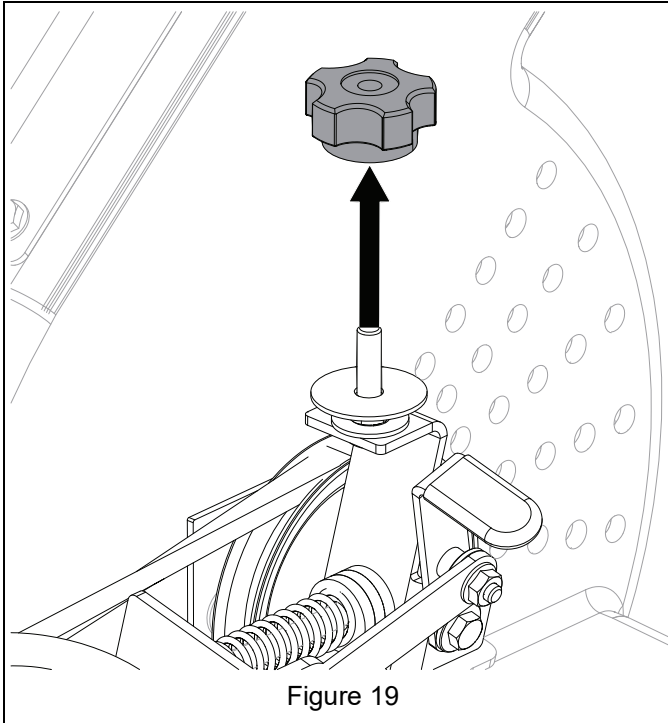

2. Position one 3/8" x 1 1/2" x 1/16" flat special washer (item 16) onto blower mounting bracket. See Figure 20.

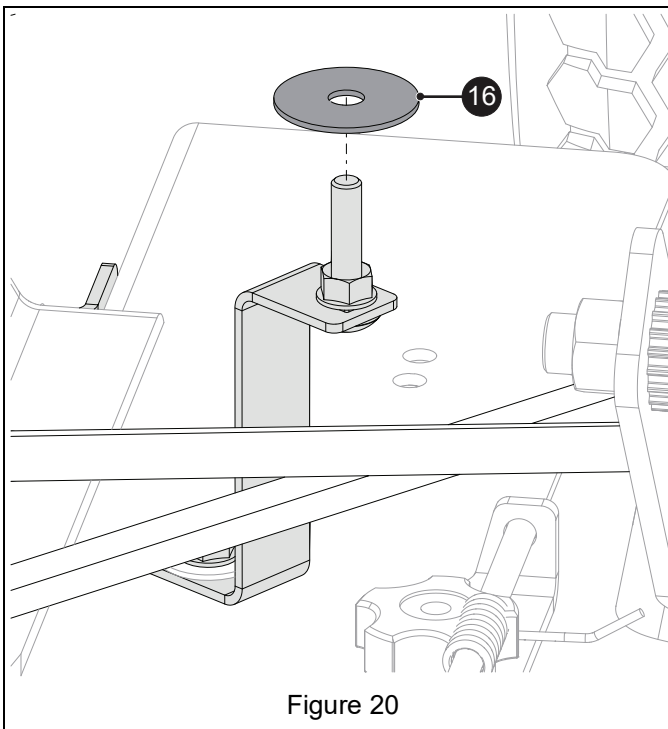

See Figure 21.

3. Position belt cover (item 22, 25, 28, or 31) over deck and idler assembly to ensure mounting bracket hardware aligns with holes in belt cover.
4. Remove belt cover, then adjust mounting brackets, if necessary.
5. Tighten mounting bracket hardware.

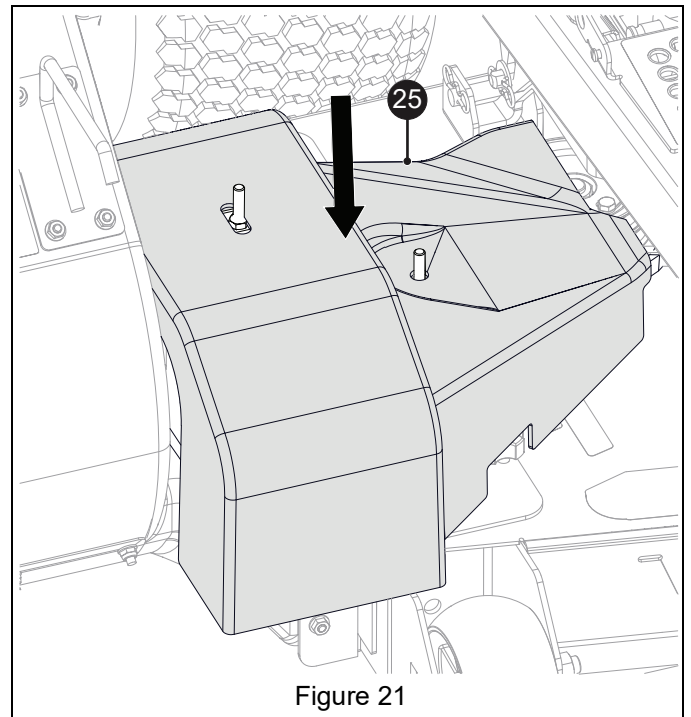

See Figure 22.

6. Position belt cover over idler assembly and reinstall clamping knob removed earlier.
7. Install other clamping knob (item 3) securing cover to blower mounting bracket.

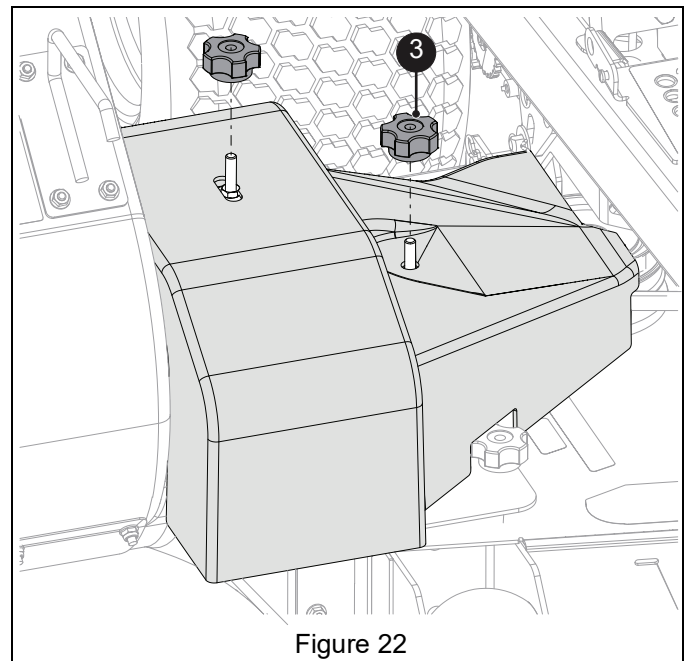

8. Attach bagger hose clamp (item 10) to slotted end of blower outlet adapter (item 11). See Figure 23.

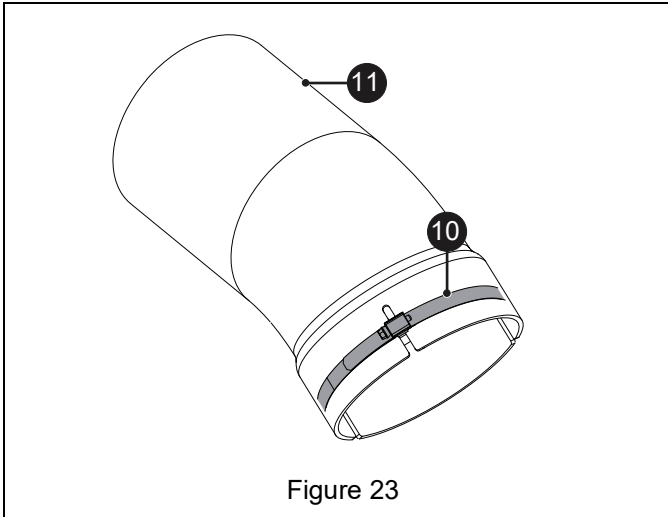

Figure 23

9. Attach blower adapter end to blower housing and secure by tightening hose clamp. See Figure 24.

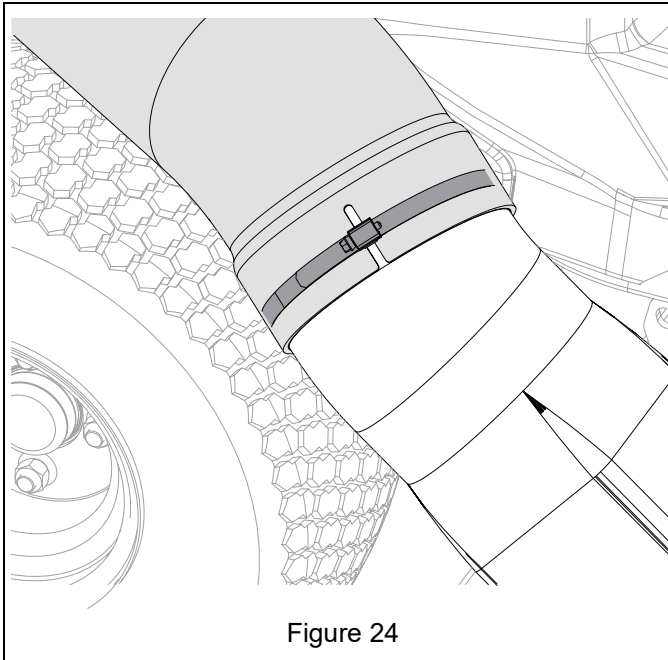

Figure 24

10. Rotate bagger hose counter-clockwise into rear intake until hose end is visible from inside bagger hood. See Figure 25.

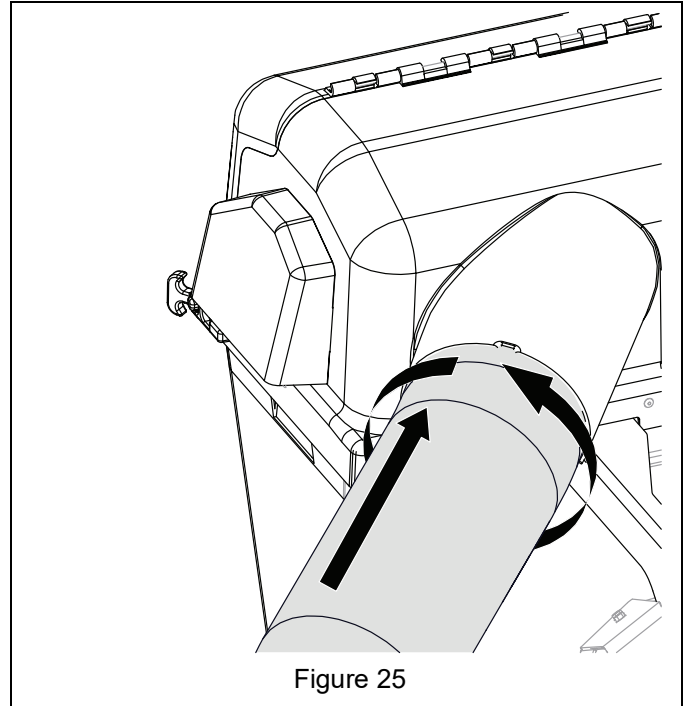

Figure 25

11. Install hose fully onto bagger outlet adapter. See Figure 26.

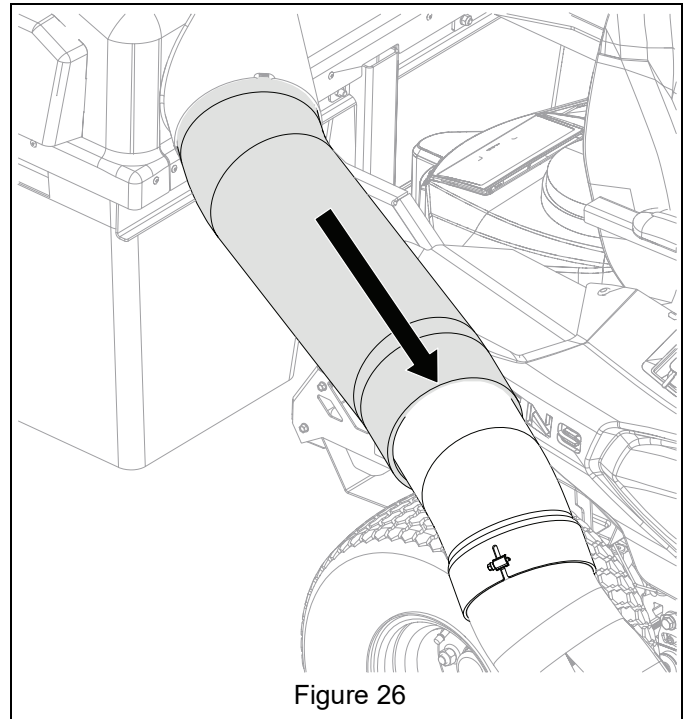
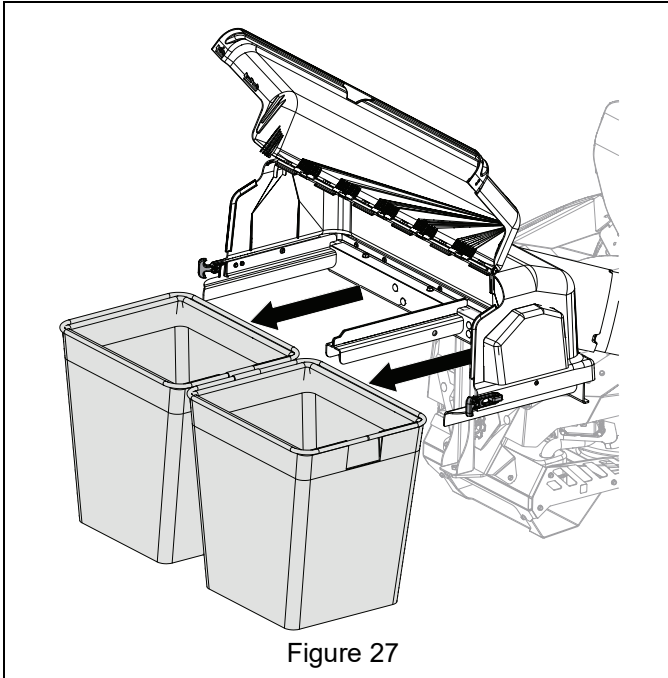
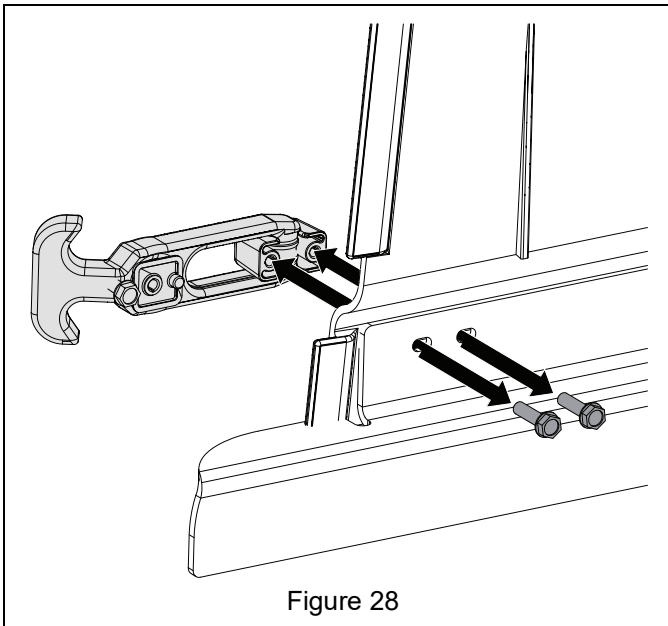

Figure 26

12. Disconnect rubber latches and open hood. If installed, remove mesh bags from hood assembly. See Figure 27.



13. Remove and retain machine screws securing left-side latch to bagger hood. See Figure 28.



See Figure 29.

14. Drill out rivet in bagger hood using a #11 (0.191") drill bit. Discard rivet and washer.

NOTICE: Be careful not to drill into base metal.

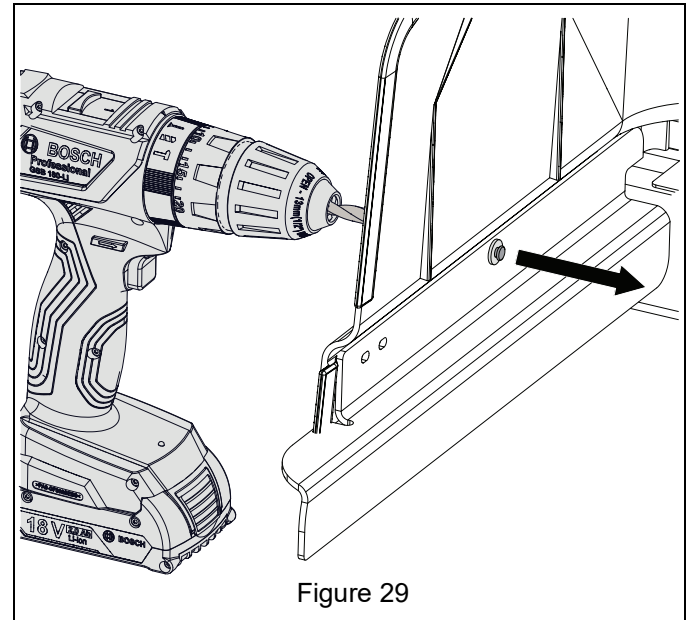

15. Align side guard (item 18) with holes in bagger frame. Install side guard and latch using hardware removed earlier. See Figure 30.

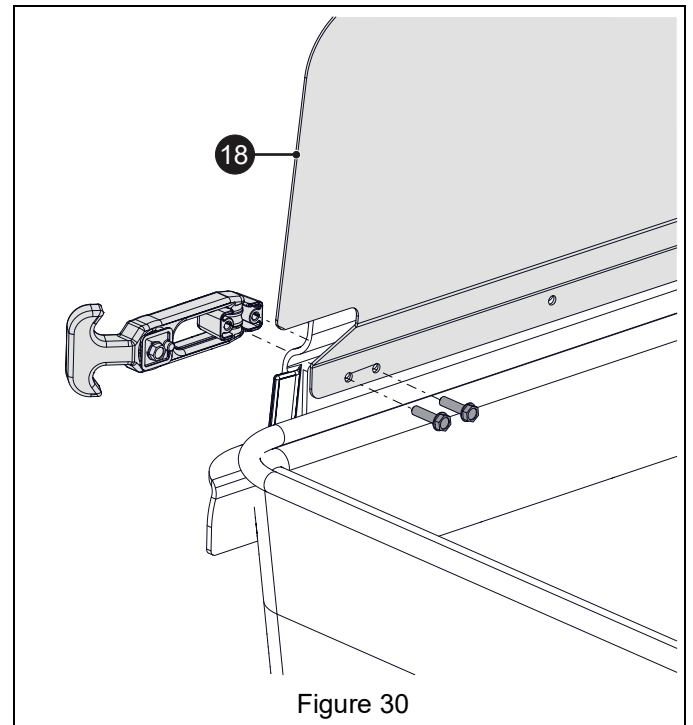

16. Using a pop-riev tool, install new rivet (item 20) into bagger frame. See Figure 31.

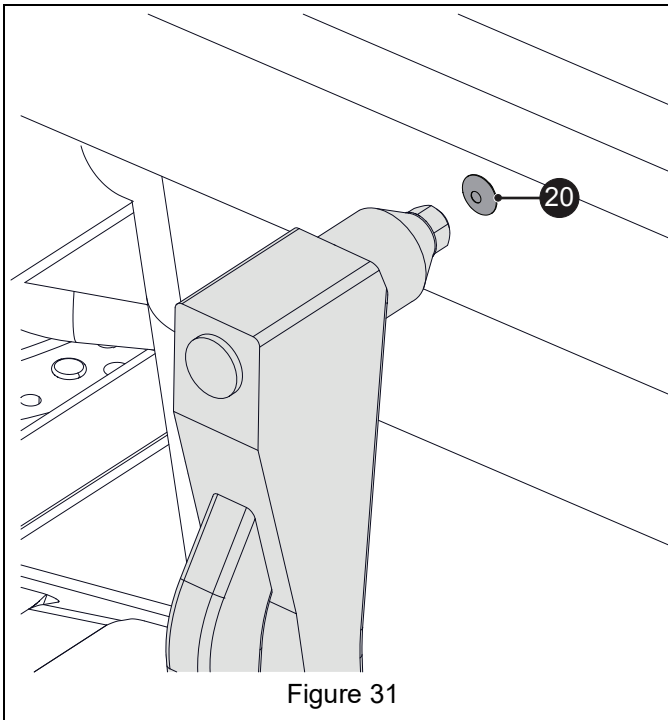

18. Position outer face of rear door on a flat, level surface. See Figure 33.

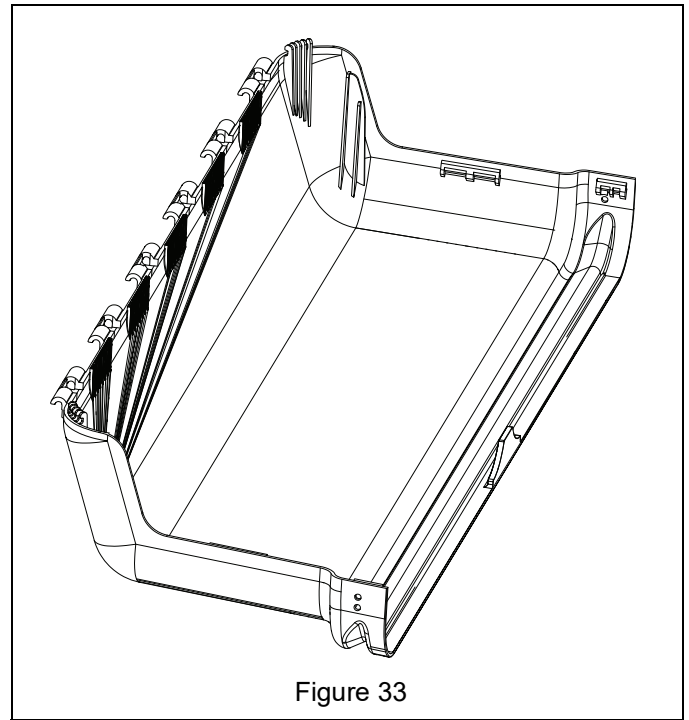

17. Using a screwdriver or similar tool, pry rod from rear door hinge. Remove and retain rod and rear door. See Figure 32.

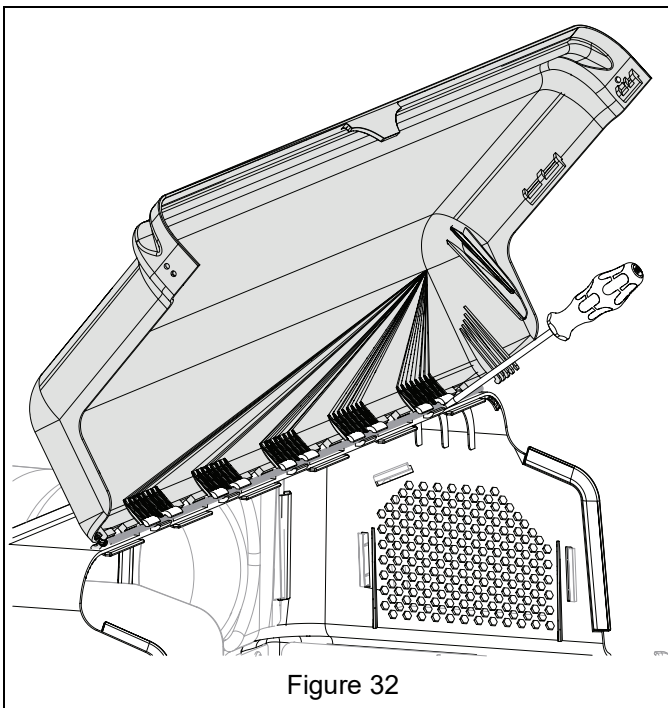

19. Position rear housing guard (item 19) approximately 1.3 cm (1/2") from outer left hinge. See Figure 34.

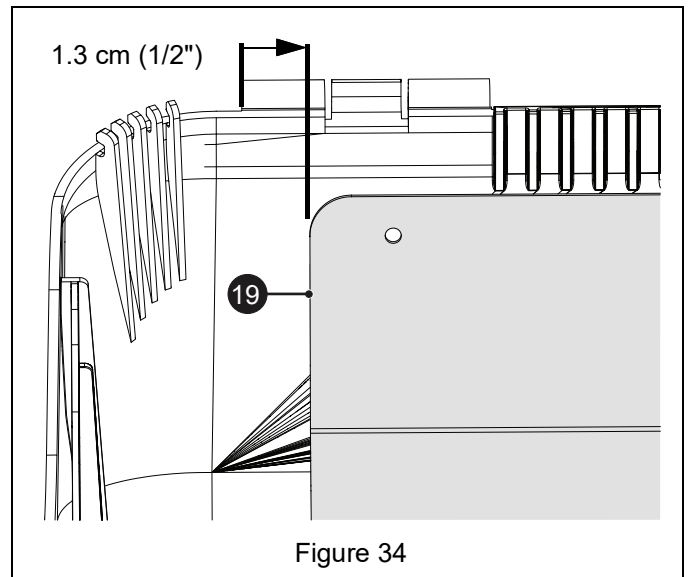

See Figure 35.

20. Using the #11 (0.191") drill bit and rear housing guard holes as a template, drill eight holes through rear door.

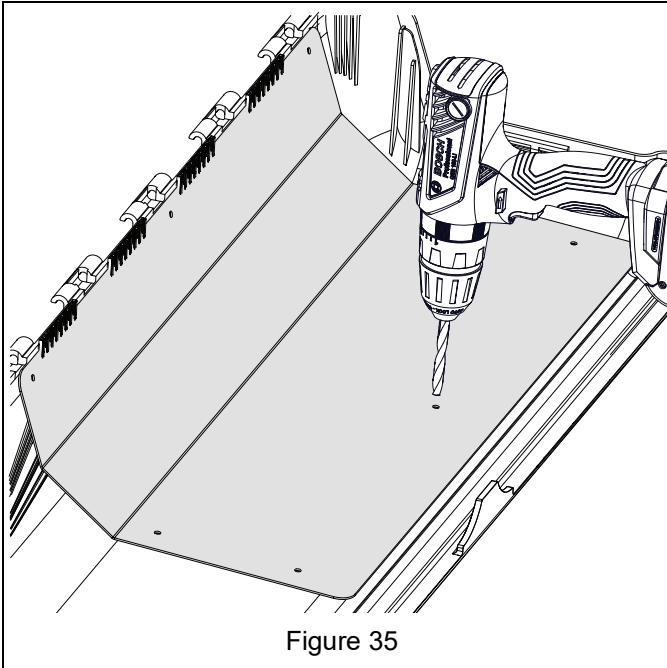

Figure 35

21. Secure rear housing guard to rear door with eight pop rivets (item 20). See Figure 36.

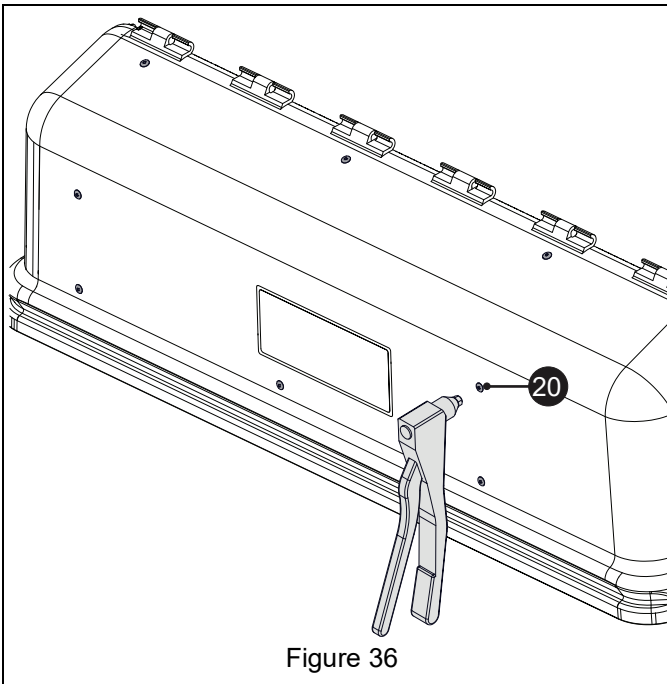

Figure 36

See Figure 37.

22. Reinstall hinge rod and reattach rear door.

23. Close hood and connect rubber latches.

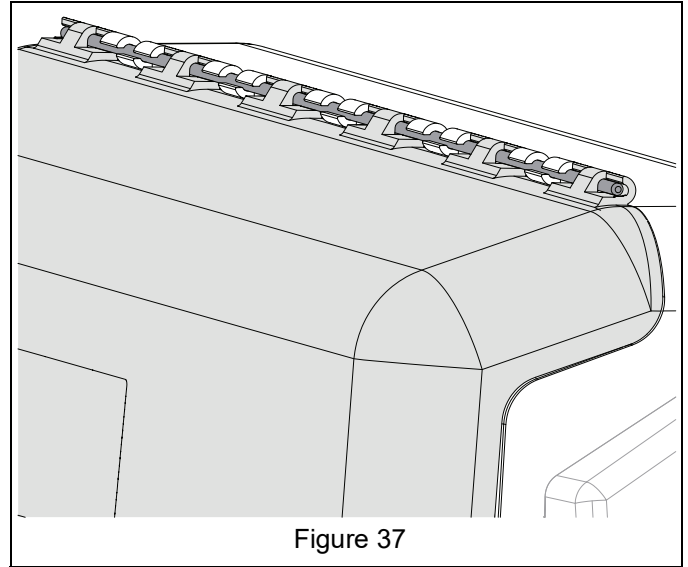

Figure 37