

# Instruction Sheet

## Kit Number: 71801900

### SUSPENSION SEAT KIT

**WARNING: FAILURE TO FOLLOW INSTRUCTIONS** could result in personal injury and/or damage to unit.  
Read, understand, and follow all safety practices in Operator's Manual before beginning.

### Package Contents

Check the contents of your kit for the parts listed below. Also see Figure 1.

Item	Description	Qty	AriensCo P/N
1	Seat Isolator Plate	1	09665451
2	Seat Isolator Mounting Bracket	1	09665351
3	Fail-Safe Compression Mount	3	07500520
4	3/8"-16 x 2" Round Head Short Square Neck Bolt	3	06200323
5	0.406" x 2" x 1/8" Flat Washer	3	06401221
6	3/8"-16 Locking Center Flange Nut	3	06500901
7	5/16"-18 x 5/8" Hex Bolt	6	05901832
8	5/16" Center Locking Flange Nut	6	06500840
9	5/16" Push Nut	1	06514900
10	5/16"-18 x 0.175" Lock Patch Shoulder Bolt	4	07001929

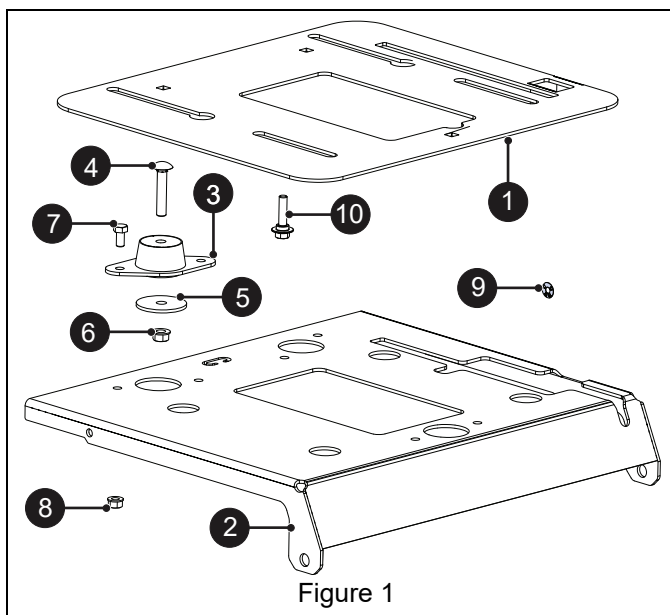

### REMOVAL

1. Stop engine, remove key and engage parking brake. Wait for moving parts to stop and for hot parts to cool.
2. Disconnect and isolate battery negative cable.
3. Tilt seat forward and disconnect seat switch.
4. While supporting seat, disconnect cable wire lanyard from seat plate. See Figure 12.
5. Return seat to operating position.
6. Remove and retain two shoulder bolts and two flange nuts retaining seat plate and carefully remove seat assembly. See Figure 2.

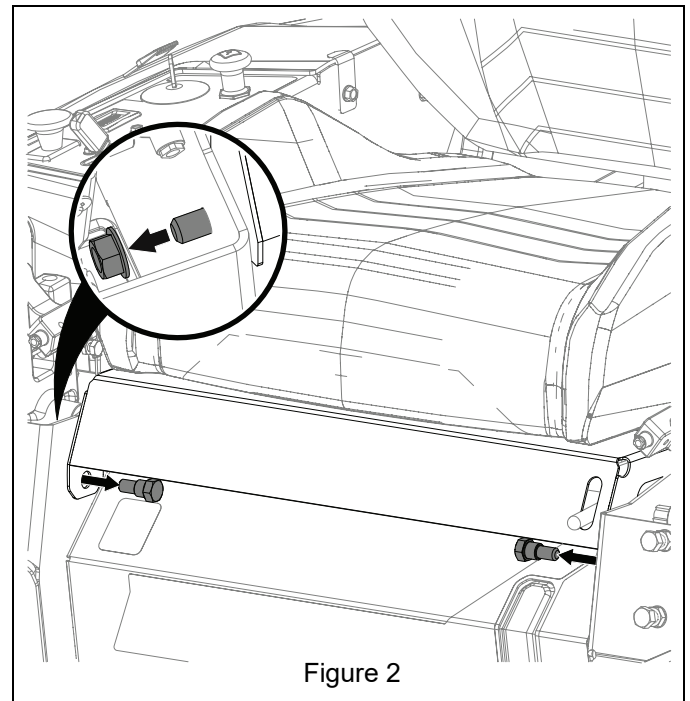

7. Place seat assembly seat side down on clean shop towels or cardboard to protect seat surfaces.
8. Remove and discard four 5/16" shoulder bolts retaining seatplate assembly to seat and remove and discard seatplate assembly. Remove and retain seat spacer and seat adjuster plate. See Figure 3.

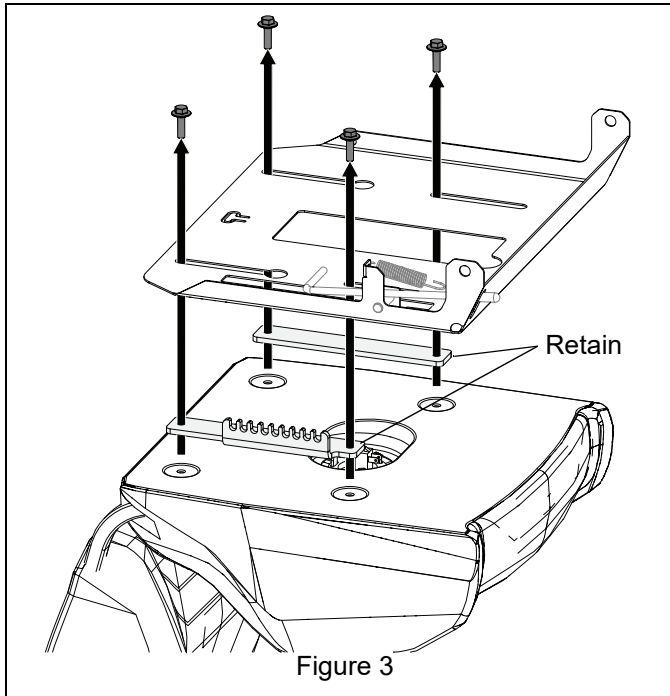

See Figure 4.

9. Carefully disconnect and remove and retain spring from adjuster lever assembly.
10. Remove and discard push nut retaining clevis pin.
11. Remove and retain clevis pin from adjuster lever and remove and retain adjuster lever.
12. Discard seat plate.

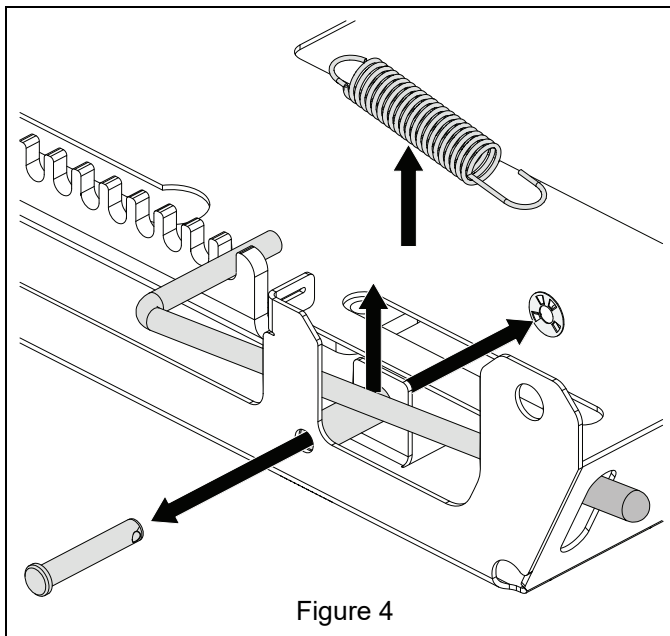

## INSTALLATION

1. Position adjuster assembly just removed in seat isolator plate (item 1). Install clevis pin and retain with one push nut (item 9). See Figure 5.

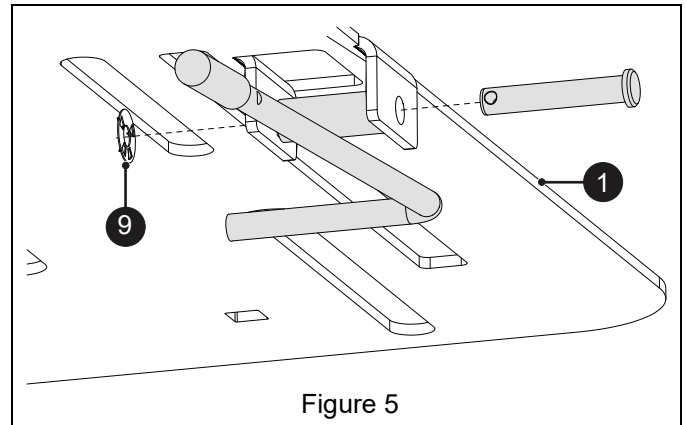

2. Install three 3/8" x 2" round head square neck bolts (item 4) into three square holes in seat isolator plate. Do not install remaining 3/8" hardware yet. See Figure 6.

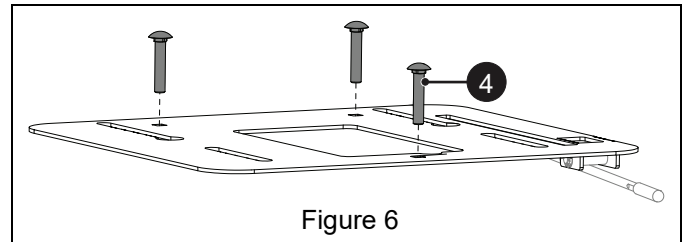

See Figure 7.

3. Position seat spacer and seat adjuster plate removed earlier on seat base.
4. Hold round head square neck bolts in position and mount seat isolator plate to seat with four 5/16" lock-patch shoulder bolts (item 10).

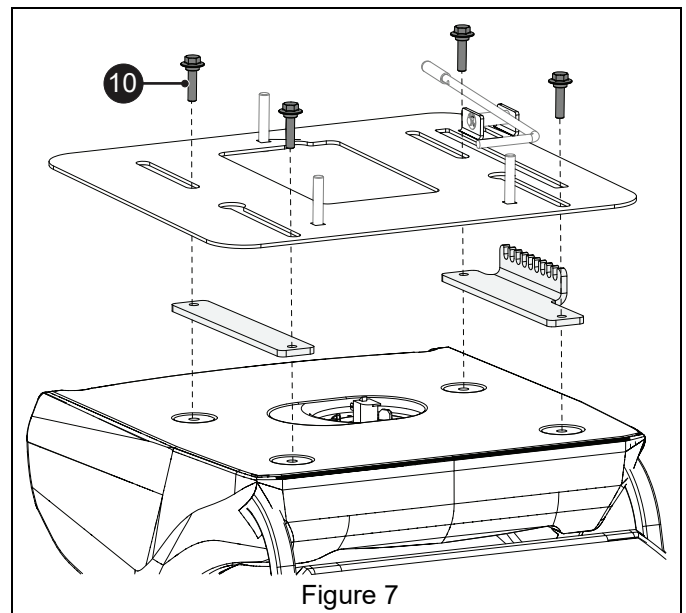

- Position three fail safe-compression mounts (item 3) on seat isolator mounting bracket (item 2) and secure with six 5/16" x 5/8" hex bolts (item 7) and six 5/16" center locking flange nuts (item 8). See Figure 8.

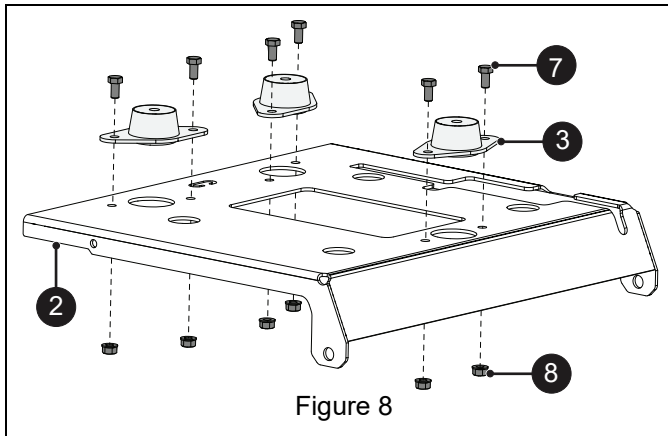

See Figure 9

- Position seat isolator plate assembly on three round head square neck bolts loosely installed earlier on seat mounting bracket assembly.
- Secure seat assembly to seat mounting bracket with three 2" flat washers (item 5) and three 3/8" center locking flange nuts (item 6).

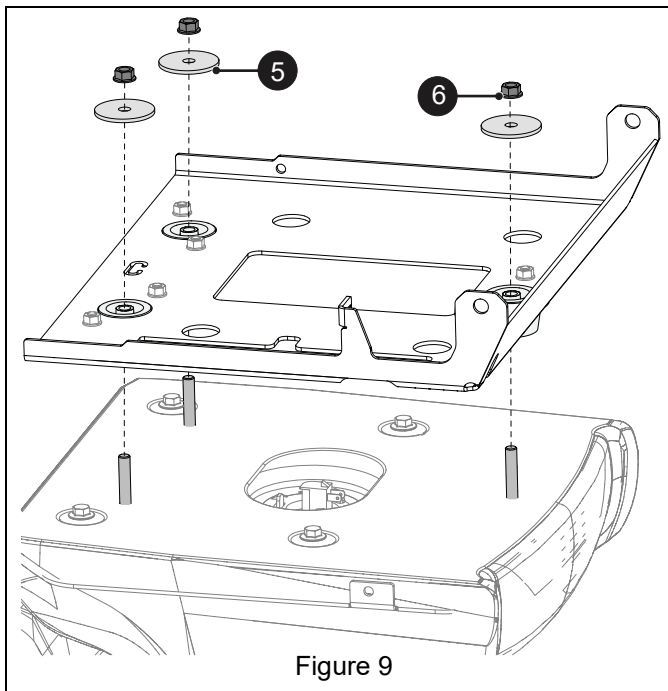

- Reinstall and connect extension spring to seat adjuster lever and isolator seat plate. See Figure 10.

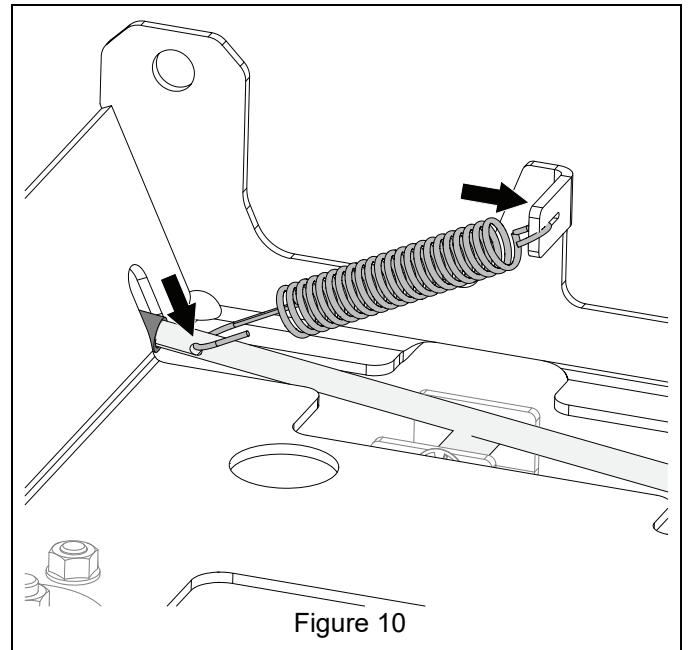

- Reinstall isolator seat assembly onto unit using two shoulder bolts and two flange nuts removed earlier. See Figure 11.

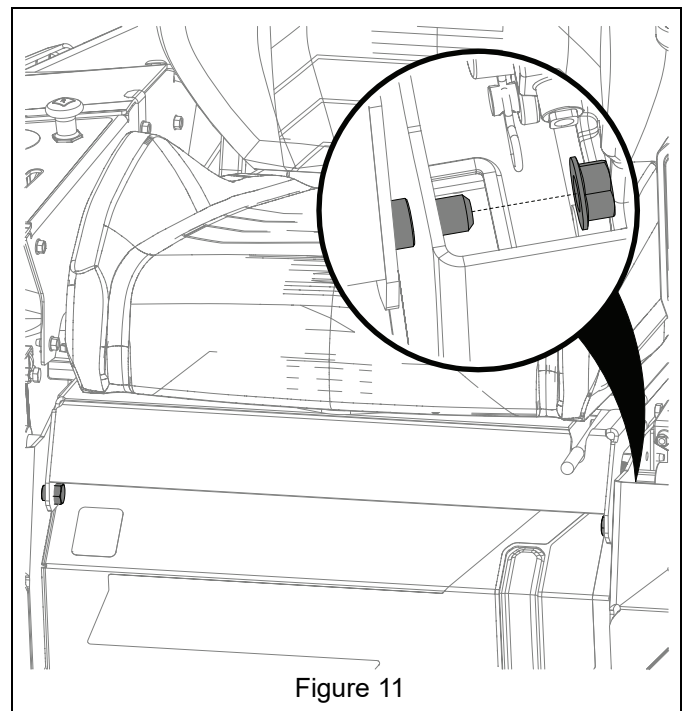

10. Tilt seat assembly forward and support.
11. Reconnect cable wire lanyard. See Figure 12.

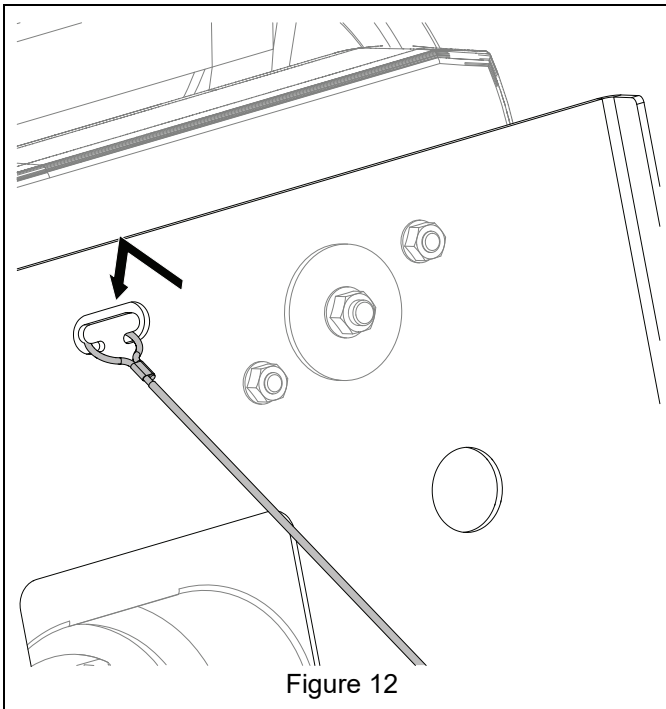

12. Reconnect seat switch.
13. Reconnect battery negative cable.