

# Log Splitter



Operator's Manual • Manuel du Utilisateur

## Models

917031 – 27-Ton Log Splitter  
(SN 000101 +)

917032 – 34-Ton Log Splitter  
(SN 000101 +)

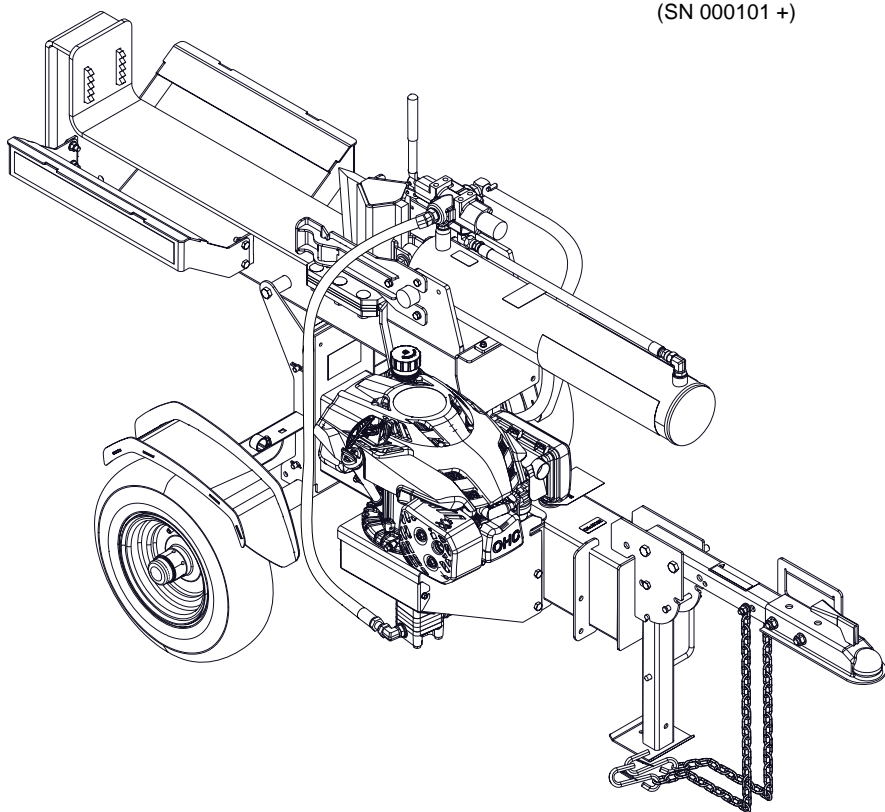

EN ENGLISH

FR FRANÇAIS

04991800 • 12/15

Printed in USA

# TABLE OF CONTENTS

---

<b>WELCOME</b> .....	<b>1</b>	<b>ACCESSORIES</b> .....	<b>20</b>
<b>SAFETY</b> .....	<b>2</b>	<b>TROUBLESHOOTING</b> .....	<b>21</b>
Practices & Laws .....	2	<b>SPECIFICATIONS</b> .....	<b>22</b>
Emission Control System .....	2	<b>WARRANTY</b> .....	<b>23</b>
Required Operator Training .....	2		
Safety Alert Symbol .....	2		
Signal Words .....	2		
Safety Decals .....	3		
Operator Zone .....	5		
Safety Rules .....	5		
<b>ASSEMBLY</b> .....	<b>8</b>		
<b>CONTROLS &amp; FEATURES</b> .....	<b>9</b>		
Engine Switch .....	10		
Choke Control Lever .....	10		
Throttle Control Lever .....	10		
Fuel Valve .....	10		
Recoil Starter Handle .....	11		
Control Lever .....	11		
Beam Lock .....	12		
Stripper Plates .....	12		
Front Jack Stand .....	12		
Rear Stabilizer .....	12		
<b>BEFORE OPERATION</b> .....	<b>13</b>		
Choose Work Site .....	13		
Position Rear Stabilizer .....	13		
Lower Jack Stand .....	13		
Position Beam .....	14		
Warm Up Unit .....	15		
<b>OPERATION</b> .....	<b>15</b>		
Start the Engine .....	15		
Split Logs .....	15		
Remove Logs From Wedge .....	16		
Stop the Engine .....	16		
Transport Unit .....	16		
For best Performance .....	17		
<b>MAINTENANCE</b> .....	<b>17</b>		
Maintenance Schedule .....	17		
Hydraulic Oil System .....	17		
Check Tire Pressure .....	19		
Lubricate Unit .....	19		
Lubricate Wheel Bearings .....	19		
Service Parts .....	19		
<b>STORAGE</b> .....	<b>20</b>		
Short-Term Storage .....	20		
Long Term Storage .....	20		
Start-of-Season Preparation .....	20		

---

# WELCOME

Congratulations on your purchase and welcome to the Ariens family! Every machine in the Ariens lineup is designed for long-lasting and unsurpassed performance. We are confident your machine will be part of your family for many years to come.

## Have Questions or Need Assistance?

[ariensstore.com](http://ariensstore.com) • [ariens.custhelp.com](http://ariens.custhelp.com)

A parts manual for your unit is available for free download or purchase at [ariens.com](http://ariens.com).

### PRODUCT REGISTRATION

You or the dealer you purchased the unit from must register the product at the time of purchase. Know the model and serial numbers of your unit and register online at [ariens.com](http://ariens.com) or return the registration card to Ariens Company. See Figure 1 for label location.

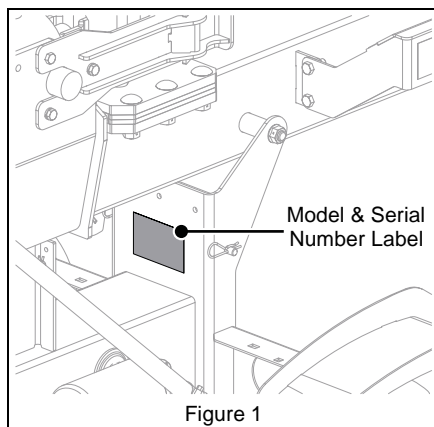

Record model number here.

Record serial number here.

### MANUALS

Before operating or servicing the unit, carefully and completely read the manuals provided with the unit. They contain safety instructions and important information about unit controls.

The engine on this unit is covered by a separate manual. Refer to the engine manual for engine service recommendations. Contact the engine manufacturer for a replacement manual if necessary.

Your dealer must review important information in this manual with you before or upon delivery of the unit. It is your responsibility to read and understand all safety precautions and instructions in the manuals. If you do not understand or have difficulty following the instructions, contact your Ariens dealer for assistance. To locate your nearest Ariens dealer, go to [ariensstore.com](http://ariensstore.com).

### DISCLAIMER

Ariens reserves the right to discontinue, make changes to, and add improvements upon its products at any time without public notice or obligation. The descriptions and specifications contained in this manual were in effect at printing. Equipment described in this manual may be optional. Some illustrations may not be applicable to your unit.

## SAFETY

Read these safety rules and follow them closely. Failure to follow these rules could lead to loss of control of unit, severe personal injury or death to you or bystanders, or result in damage to property or the unit.

### PRACTICES & LAWS

Practice usual and customary safe working precautions. Learn applicable rules and laws in your area. ALWAYS follow the practices set forth in this manual.

### EMISSION CONTROL SYSTEM

This equipment and/or its engine may include exhaust and evaporative emissions control system components required to meet U.S. Environmental Protection Agency (EPA) and/or California Air Resources Board (CARB) regulations. Tampering with emission controls and components by unauthorized personnel may result in severe fines or penalties. Emission controls and components can only be adjusted by an Ariens Company dealer or an authorized engine manufacturer's service center. Contact your Ariens Company Equipment Retailer concerning emission controls and component questions.

### REQUIRED OPERATOR TRAINING

The original purchaser of this unit was instructed by the seller on safe and proper operation. If unit is to be used by someone other than the original purchaser, loaned, rented, or sold, ALWAYS provide this manual and any needed safety training before operation.



**WARNING:** This splitting machine is capable of crushing or amputating body parts. Failure to observe the safety instructions in the manuals and on decals could result in serious injury or death.

Tragic accidents can occur if the operator is not alert to the presence of children. Never assume that children will remain where you last saw them.

Stop engine and allow moving parts to stop before leaving operator's position.

## SAFETY ALERT SYMBOL



This is the safety alert symbol. It means:

- **ATTENTION!**
- **YOUR SAFETY IS INVOLVED!**

When you see this symbol:

- **BECOME ALERT!**
- **OBEY THE MESSAGE!**

### SIGNAL WORDS

The safety alert symbol above and signal words below are used on decals and in this manual. Read and understand all safety messages.

#### 1. Danger



**DANGER:** Indicates an **IMMINENTLY HAZARDOUS SITUATION!** If not avoided, **WILL RESULT** in death or serious injury.

#### 2. Warning



**WARNING:** Indicates a **POTENTIALLY HAZARDOUS SITUATION!** If not avoided, **COULD RESULT** in death or serious injury.

#### 3. Caution



**CAUTION:** Indicates a **POTENTIALLY HAZARDOUS SITUATION!** If not avoided, **MAY RESULT** in minor or moderate injury. It may also be used to alert against unsafe practices.

#### 4. Notice

**NOTICE:** Indicates information or procedures that are considered important but not hazard related. If not followed, property damage could result.

#### 5. Important

**IMPORTANT:** Indicates general reference information worthy of special attention.

# SAFETY DECALS

The safety decals on your unit are visual reminders of the important safety information in this manual. All messages on your unit must be fully understood and carefully followed. Safety decals on the unit are explained below.

ALWAYS replace missing or damaged safety decals. Replacement decal information is in the parts manual for your unit. Decals can be ordered from your dealer.

See Figure 2 for safety decal locations.

## Safety Decal Locations

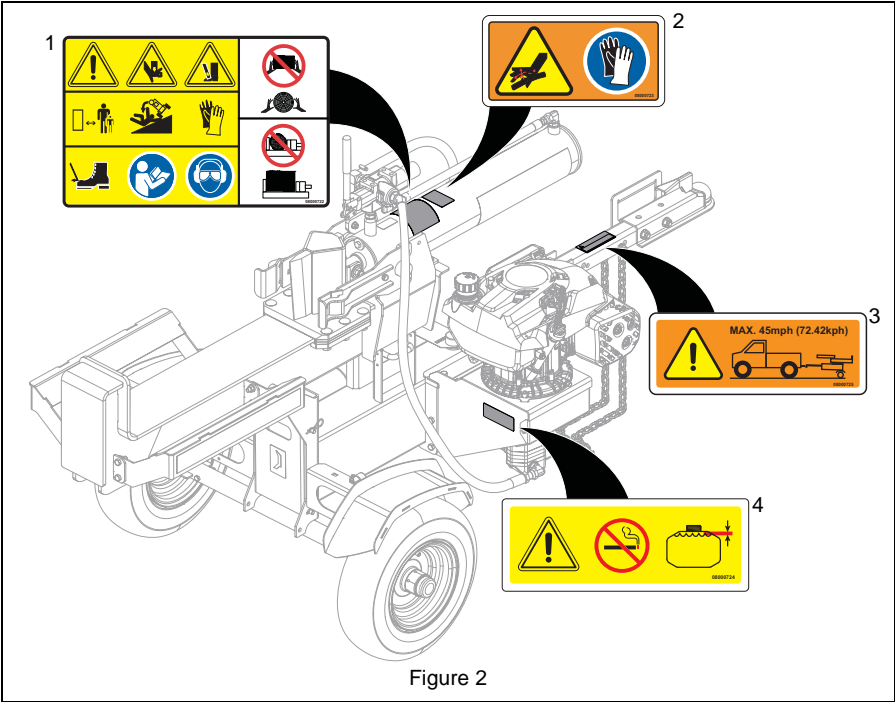

Figure 2

## Safety Decal Descriptions

### 1. DANGER!



**DANGER!**



Keep hands away from moving parts. Moving parts can crush or cut.

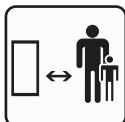

Keep children and others away from unit while operating.

Only one person should operate the log splitter and load the logs.



Operate the log splitter on level surfaces. Stay off slopes and slippery surfaces.



Always wear gloves and boots.



Read the operator's manual.



Always wear eye and hearing protection.



Never place hands or any part of the body between a log and any part of the log splitter.

Hold logs on sides when loading. Keep hands and feet away from cylinder, wedge, and partially split logs.



Do not split logs against the grain.

Split logs end to end in the direction of the grain only.

### 2. WARNING!



To prevent serious injury or death from escaping hydraulic fluid:

- ALWAYS keep body and hands away from pin holes or nozzles which eject hydraulic fluid under pressure.
- Escaping hydraulic fluid can puncture skin and cause blood poisoning.



### 3. WARNING!

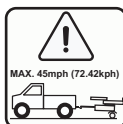

Maximum towing speed of 72.4 kph (45 mph).

### 4. CAUTION!



No smoking, No sparks, No flames.

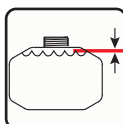

Never fill fuel tank when engine is running, hot or unit is indoors.

Never overfill fuel tank.

Replace fuel cap securely and clean up spilled fuel.

## OPERATOR ZONE

This unit is designed to be operated by one person located in the operator zone. See Figure 3.

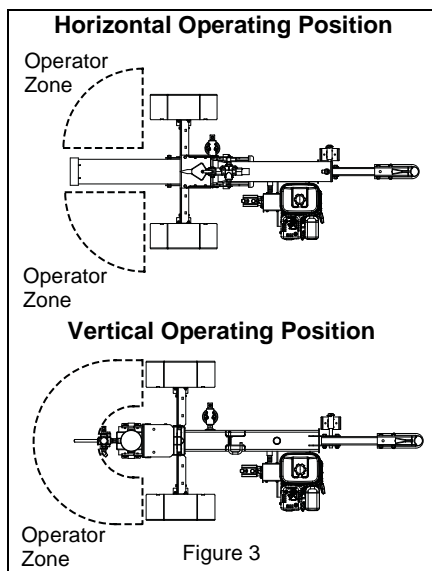

## SAFETY RULES

The following safety instructions are based on the B71.7 specifications of the American National Standards Institute in effect at the time of production.

Training
Only the user can prevent and is responsible for accidents or injuries occurring to themselves, other people or property.
Read the Operator's manual completely before attempting to use this log splitter.
Do not allow anyone to operate your log splitter who has not read the Operator's Manual or has not been instructed on the safe use of the splitter.
Never allow children or untrained adults to operate this machine.
Many accidents occur when more than one (1) person operates the log splitter. If a helper is assisting in loading logs to be split, never actuate controls until the helper is clear of the area.
Never allow anyone to ride on the machine.
Never transport cargo on the log splitter.

High fluid pressures are developed in hydraulic log splitters. Pressurized hydraulic fluid escaping through a pin hole opening can puncture skin and cause severe blood poisoning. Therefore, the following instructions should be heeded at all times.

- Do not operate the unit with frayed, kinked, cracked or damaged hoses, fittings, or tubing.
- Stop the engine and relieve hydraulic system pressure before changing or adjusting fittings, hoses, tubing, or other system components.
- Do not adjust the pressure settings of the pump or valve.
- Do not check for leaks with your hand. Leaks can be located by passing cardboard or wood over the suspected area. Look for discoloration. If injured by escaping fluid, see a doctor at once. Serious infection or reaction can develop if proper medical treatment is not administered immediately.

Keep the operator zone and adjacent area clear for safe, secure footing.

If your log splitter is equipped with an internal-combustion engine and intended for use near any unimproved forest, brush, or grass covered land, the engine exhaust should be equipped with a spark arrestor. Make sure you comply with applicable local, state, and federal codes. Take appropriate fire-fighting equipment with you.

Log splitters should be used only for splitting wood. Do not use for other purposes unless the manufacturer provides attachments and instructions.

If unit is to be used by someone other than original purchaser; loaned, rented or sold, ALWAYS provide this manual and any needed safety training before operation.

## Operation

Before starting this log splitter, review the "Rules for safe Operation." Failure to follow these rules may result in serious injury to the operator or bystanders.

Never leave the machine unattended with the power source operating.

Never operate the machine when under the influence of alcohol, drugs, or medication.

The machine owner should instruct all operators in safe log-splitter operation.

Always operate the log splitter with all safety equipment in place and all controls properly adjusted for safe operation.

Always operate the log splitter at manufacturer's recommended speed.

Always keep hands and feet clear of moving parts.
When loading a ram-type log splitter, place your hands on the sides of the log not at the ends. Never place your hands or any part of your body between a log and any part of the log splitter.
On ram-type log splitters, never attempt to split more than one (1) log at a time unless the ram has been full extended and a second log is needed to complete the separation of the first log.
On ram-type log splitters on which the logs are not cut square, the longest portion of the log should be rotated down and the most square end placed against the ram.
Use only your hand to operate the log splitter controls.
Do not refuel the engine until it has cooled for several minutes.
Before starting engine ensure that control lever is in neutral position.
Operate unit only when there is sufficient light to clearly see work area.
NEVER allow children to operate or play on or near unit.
Operate unit only when standing in operator zone. Unit stabilizers must be extended before starting unit.
Use wheel chocks to prevent movement of unit during operation.
ALWAYS keep hands away from all moving parts during operation. Moving parts can cut or crush body parts.
DO NOT operate in the rain or in wet or damp locations. Assure that operator zone is free of debris and provides good footing.
Know the weight of logs. Limit logs to those you can safely control and the unit can safely handle.
Logs should be cut with square ends before placing on splitter.
Position logs against end plate grips before operating hydraulic cylinder.
On logs that are not square place the longest portion of the log closest to the beam and the most square end against the splitter wedge.
Do not attempt to stabilize logs with legs or feet while operating. Moving parts can cut off or crush body parts.
Split logs end to end in the direction of the grain, not against the grain.

Keep fingers and hands away from cracks in logs while splitting. These can quickly close and pinch or crush body parts.

## Maintenance and Storage

Always shut off the power source while repairing or adjusting the splitter except as recommended by the manufacturer.
Clean debris and chaff from engine cylinder, cylinder head fins, blower housing rotating screen, and muffler areas. If the engine is equipped with a spark arrester muffler, clean and inspect it regularly (follow manufacturer's service instructions). Replace, if damaged.
Never store the equipment with fuel in the tank inside a building where fumes might reach an open flame or spark. Allow the engine to cool before storing in any enclosure.
Clear debris from movable parts, but only when the power source is shut off. DO NOT spray water to clean unit.
Check to be sure all nuts and bolts are tight to assure the equipment is in safe working condition.
For extended storage, shut off fuel and clean unit thoroughly. See engine manual for proper storage.
ALWAYS remove spark plug wire from spark plug before inspecting or working on this unit.
DO NOT touch unit parts which might be hot from operation. Allow parts to cool before attempting to maintain, adjust or service.
Stop and inspect equipment if there is an unusual vibration. Repair, if necessary, before restarting. Never make adjustments or repairs without first disconnecting the spark plug wire.
Keep all hardware properly tightened.
Maintain or replace safety and instruction labels, as necessary.
Check attachment components frequently. If worn or damaged, replace with manufacturer's recommended parts.
ALWAYS keep protective structures, guards, and panels in good repair, in place and securely fastened. NEVER modify or remove safety devices.



<p>Hydraulic fluid can result in severe burns. Fluid in hydraulic system can penetrate skin and result in serious injury or death.</p> <ul style="list-style-type: none"> <li>• Be sure to stop the engine and relieve hydraulic pressure before doing any work on hydraulic parts.</li> <li>• Keep body and hands away from pin holes or nozzles which expel hydraulic fluid when under pressure. Use paper or cardboard, not hands, to search for leaks.</li> <li>• Ensure all hydraulic fluid connections are tight and all hydraulic hoses and lines are in good condition before applying pressure to system.</li> <li>• FOREIGN FLUID INJECTED INTO BODY can result in gangrene. Fluid must be surgically removed within a few hours by a doctor familiar with this form of injury.</li> <li>• Do not adjust the pressure settings on the hydraulic pump or valve.</li> </ul> <p>ALWAYS maintain unit in safe operating condition. Damaged or worn out muffler can cause fire or explosion.</p>
---

## Personal Protection

Wear adequate safety shoes and protective gloves.

DO NOT wear loose clothing or jewelry and tie back hair that may get caught in moving parts.

Protect eyes, face and head from objects that may be thrown from unit. Wear appropriate hearing protection. Always wear safety goggles or safety glasses with side shields when operating.

## Before Operating

Inspect unit before each use for: missing or damaged decals and shields. Replace or repair as needed.

Read, understand, and follow all instructions in the manual and on the machine before starting.

Understand:

- How to operate all controls
- The functions of all controls
- How to STOP in an Emergency

Do not use log splitter for any purpose other than splitting logs.

Keep children, people, and pets away. Be alert and shut off unit if anyone enters work area. Keep children under watchful care of a responsible adult.

## Slope Operation

Operate the log splitter on level surfaces. Stay off slopes and slippery surfaces.

## Fuel

DO NOT run engine in an enclosed area. Always provide good ventilation. Fumes from engine exhaust can cause injury or death.

Fuel is highly flammable and its vapors are explosive. Handle with care. Use only an approved gasoline container with an appropriately sized dispensing spout.

No smoking, No sparks, No flames. ALWAYS allow engine to cool before servicing.

NEVER fill fuel tank when engine is running or hot from operation.

NEVER fill or drain fuel tank indoors.

Replace fuel cap securely and clean up spilled fuel.

Never fill fuel containers inside a vehicle or on a truck or trailer bed with a plastic liner. Always place containers on the ground away from your vehicle before filling.

Keep the nozzle in contact with the rim of the fuel tank or container opening at all times until fueling is complete. Do not use a nozzle lock-open device.

If fuel is spilled on clothing, change clothing immediately.

NEVER store fuel inside where there is an open flame, such as a water heater.

## Towing/Transporting

Do not move the unit up or down a hill by hand. Use a tow vehicle with suitable braking system.

Use extra care when towing unit. DO NOT exceed 72.4 kph (45 mph).

NEVER allow anyone to ride on the unit.

NEVER transport cargo on the log splitter.

Check local, state and federal laws before towing. Any modifications required to meet these laws are the responsibility of the purchaser.

ALWAYS stop engine, lock beam in horizontal position and close fuel shut-off valve when transporting unit.

Safety chains MUST be attached to vehicle when towing unit.

Disconnect unit from tow vehicle before using.

## Accessories

Use only Ariens Company-recommended attachments that are appropriate to your use and can be used safely in your application.

## ASSEMBLY



**WARNING:** AVOID INJURY.  
Read and understand the entire  
*Safety* section before proceeding.

### Check Tire Pressure



**WARNING:** Avoid injury!  
Explosive separation of tire and  
rim parts is possible when they  
are serviced incorrectly:

- Do not attempt to mount a tire without the proper equipment and experience to perform the job.
- Do not inflate the tires above the recommended pressure.
- Do not stand in front or over the tire assembly when inflating. Use a clip-on chuck and extension hose long enough to allow you to stand to one side.

See *Specifications* on page 22 for tire pressure.

### Fill Engine Fuel Tank

Fill fuel tank. DO NOT OVERFILL! See *Specifications* on page 22.

### Purge Hydraulic System and Add Hydraulic Oil

**IMPORTANT:** ADD OIL BEFORE OPERATING! Add hydraulic oil to operating level before first use. The system may take up to two gallons. See *Hydraulic Oil System* on page 17. Do not overfill.

Before first use or after hydraulic system maintenance:

1. Purge any air in the system by cycling the hydraulic cylinder. See *Purge Air From Hydraulic System* on page 18.
2. Add hydraulic oil as necessary to bring system to operating level.

**NOTICE:** Some hydraulic fluid may overflow from the cap/breather as the system warms up and the fluid expands. Do not operate the unit without the proper amount of oil in the reservoir.

### Check Function of All Controls

See *Operation* on page 15.

# CONTROLS & FEATURES

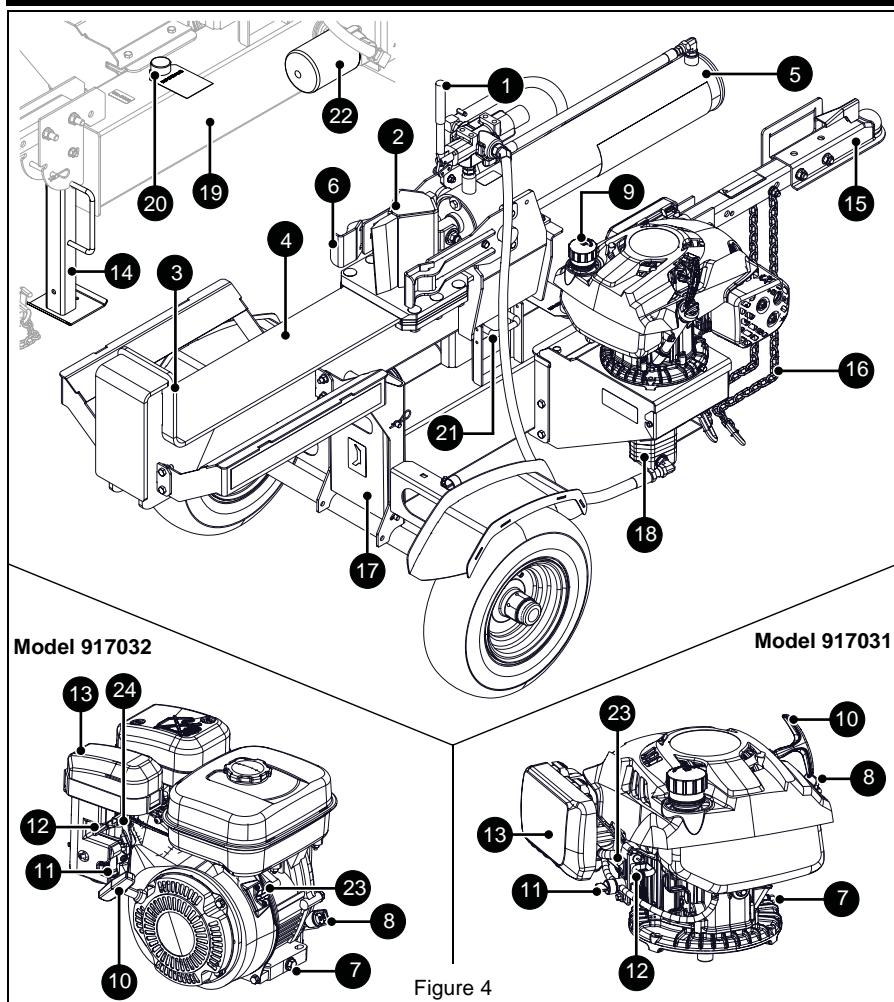

Figure 4

- |                         |   |
|-------------------------|---|
| 1. Control Lever        | 13. Air Filter                            |
| 2. Splitter Wedge       | 14. Front Jack Stand                      |
| 3. End Plate / Grip     | 15. Hitch Coupler – 5.1 cm (2.0") Ball    |
| 4. Beam                 | 16. Safety Chains (2)                     |
| 5. Hydraulic Cylinder   | 17. Rear Stabilizer                       |
| 6. Stripper Plate (2)   | 18. Hydraulic Pump                        |
| 7. Oil Drain Plug       | 19. Hydraulic Tank                        |
| 8. Oil Fill / Dipstick  | 20. Hydraulic Tank Dipstick / Breather    |
| 9. Fuel Tank / Filler   | 21. Beam Lock                             |
| 10. Recoil Starter      | 22. Hydraulic Oil Filter                  |
| 11. Fuel Valve          | 23. Engine Switch                         |
| 12. Choke Control Lever | 24. Throttle Control Lever (Model 917032) |



**WARNING: AVOID INJURY.**  
Read and understand the entire  
Safety section before proceeding.

See Figure 4 for all controls and features  
locations.

## ENGINE SWITCH

See Figure 5.

The engine switch has two positions:

1. OFF – Engine will not start or run.
2. ON – Engine will start and run.

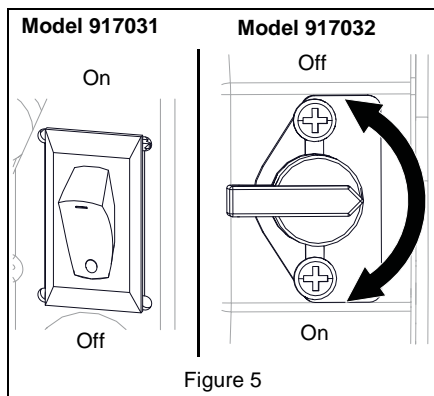

## THROTTLE CONTROL LEVER

### Model 917032

See Figure 7.

The throttle controls the engine speed. To increase or decrease the engine speed, adjust to:

1. Fast (normal or warm starts)
2. Part-Throttle
3. Slow (cold weather starts)

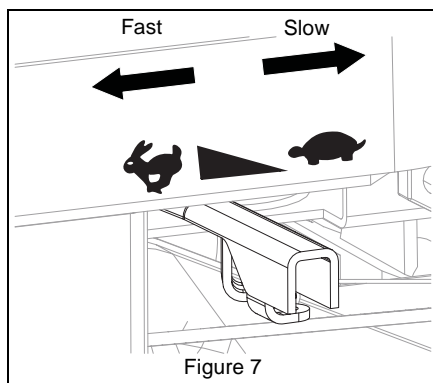

## FUEL VALVE

See Figure 8.

Controls fuel flow to the engine.

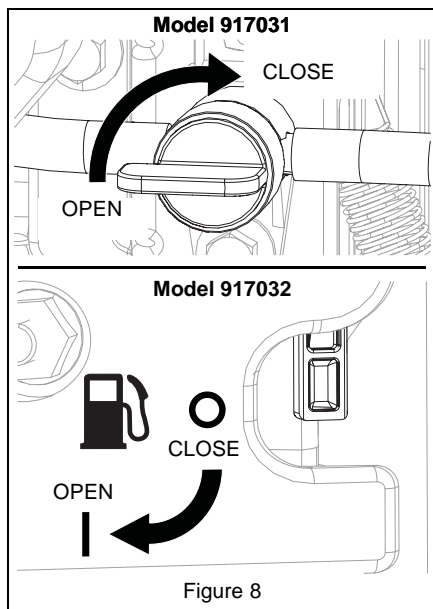

## CHOKE CONTROL LEVER

See Figure 6.

Controls air intake to the engine.

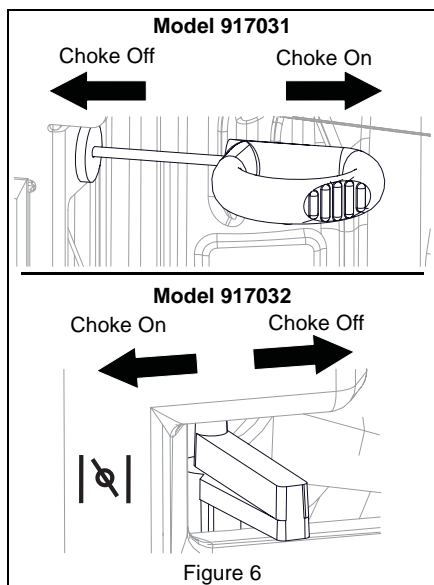

## RECOIL STARTER HANDLE

When pulled, handle will turn engine over.

**IMPORTANT:** DO NOT let handle snap back against starter.

## CONTROL LEVER

See Figure 9.

The control lever is used to move the splitting wedge in or out when operating in the horizontal position or up and down when operating in the vertical position.

### Out / Down

Move lever in this direction to extend cylinder toward end plate. Keep pressure on lever until log is split. Lever does not lock in this position. Release as soon as log is split or cylinder is fully extended.

### Neutral

In this position the cylinder does not move even though the engine is running.

### Return / Up

Move lever in this direction to retract cylinder. Push lever fully in this direction to lock in return mode. Lever will automatically return to neutral once cylinder fully retracts.

Horizontal Operating Position

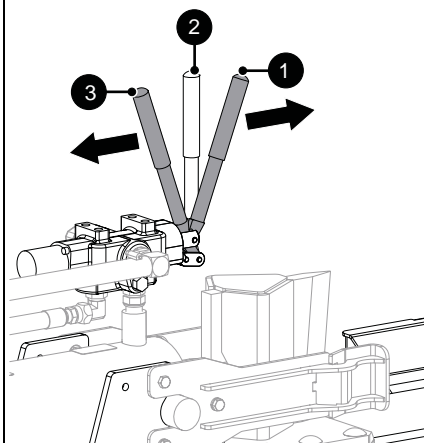

Vertical Operating Position

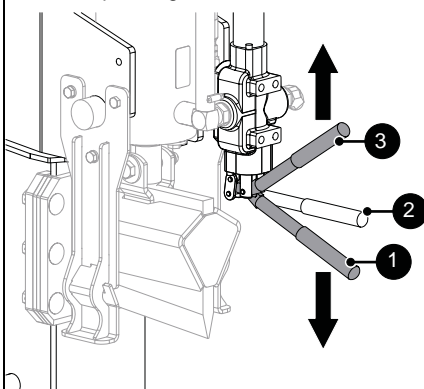

1. Out / Down
2. Neutral
3. Return / Up

Figure 9

## BEAM LOCK

See Figure 10.

Locks the beam in the horizontal operating position.

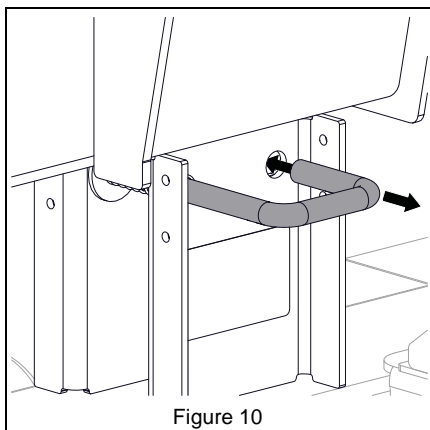

Figure 10

## STRIPPER PLATES

See Figure 11.

The stripper plates are designed to remove a log that has partially split but remains stuck on the wedge.

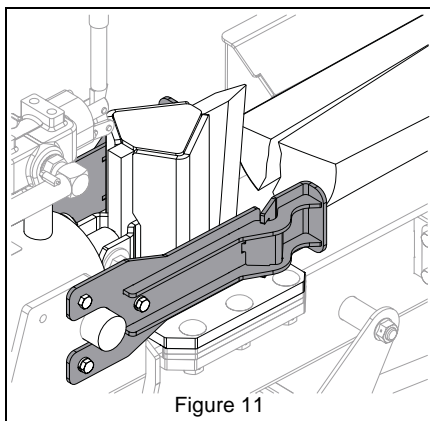

Figure 11

## FRONT JACK STAND

See Figure 12.

Front jack stand must be locked in the down position whenever the unit is in use and in the transport position when moving or towing the unit.

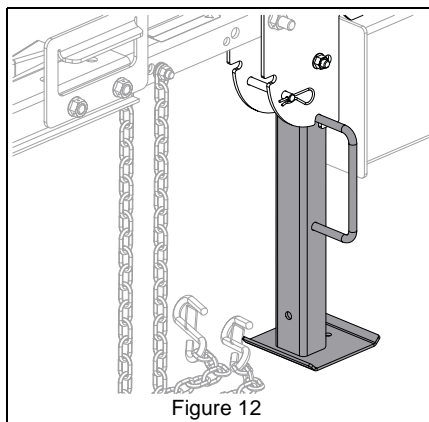

Figure 12

## REAR STABILIZER

See Figure 13.

Rear stabilizer must be positioned down and locked in place when operating in the horizontal position.

Rear stabilizer must be locked in the transport position before towing unit or before placing beam in vertical operating position.

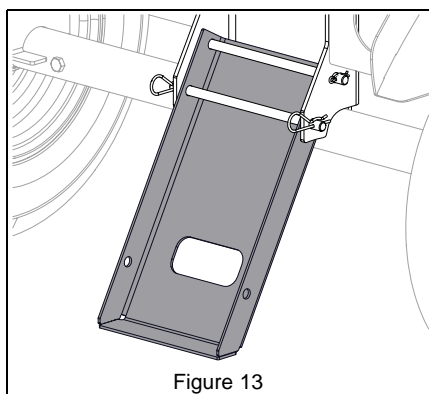

Figure 13

## BEFORE OPERATION

1. Check fuel level and add fuel if needed.

**IMPORTANT:** Use fresh unleaded fuel with an octane rating of at least 87. DO NOT use E85 blended fuels; the engine is not E20 / E30 / E85 compatible. The maximum recommended ethanol content is 10%.

2. Check engine oil level and add oil if needed. Refer to engine manual.
3. Check hydraulic oil level. See *Check Hydraulic Oil Level* on page 17.
4. Check condition of air cleaner. Refer to engine manual.
5. Check function of all controls.

## CHOOSE WORK SITE

1. Set up log splitter in an area that provides:
  - A dry level surface.
  - Good footing that is free of debris or other tripping hazards.
  - Sufficient clearance for engine exhaust to not blow directly on combustible material.
2. Disconnect the log splitter from the tow vehicle before operating. If splitting logs in the horizontal position, move rear stabilizer to work position. See *Position Beam* on page 14. Chock the wheels to prevent movement during operation.

## POSITION REAR STABILIZER

See Figure 14.

1. Remove hair pin from upper lock pin and slide lock pin out from brackets.
2. Rotate rear stabilizer up or down until holes in stabilizer align with holes in brackets.

**IMPORTANT:** Rear stabilizer must be locked in the transport position before towing unit or before placing beam in vertical operating position.

3. Insert lock pin all the way through brackets and stabilizer.
4. Reinstall hair pin.

Operating Position

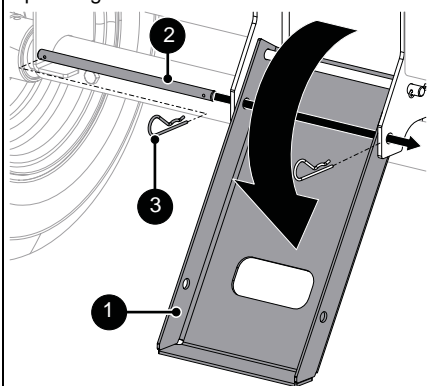

Transport Position

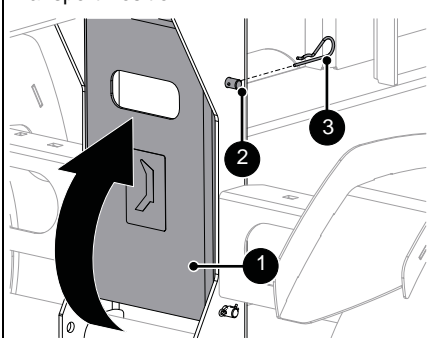

1. Rear Stabilizer
2. Lock Pin
3. Hairpin

Figure 14

## LOWER JACK STAND

See Figure 15.

1. Remove hair pin from clevis pin and remove clevis pin from tongue bracket.
2. Rotate jack stand down until the top of the handle aligns with the lower notch in tongue bracket.
3. Insert clevis pin into tongue bracket and insert hairpin.

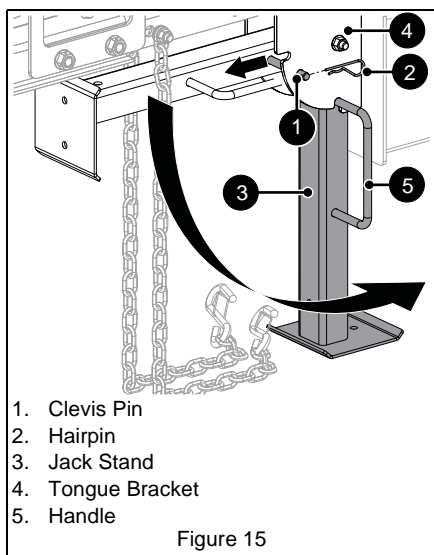

## POSITION BEAM

Determine if the size of the logs to be split can be safely and comfortably lifted up onto the beam in the horizontal position. If logs are too heavy for the operator, position the beam in the vertical position for splitting.

### Vertical Operating Position



**WARNING:** Beam assembly is heavy. Use care when moving between vertical and horizontal positions.

**IMPORTANT:** Rear stabilizer must be in the transport position before placing beam in vertical operating position. See *Position Beam* on page 14.

See Figure 16.

1. Pull beam lock out until the pin clears the mount.
2. Rotate beam lock slightly so pin does not return to hole in mount.

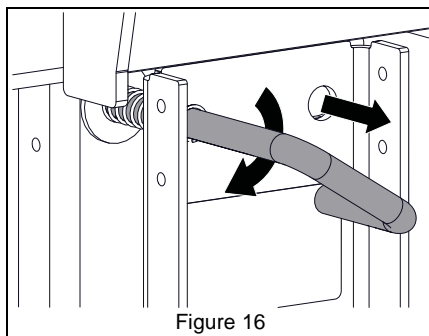

3. Lift beam until it rotates to vertical position. See Figure 17.

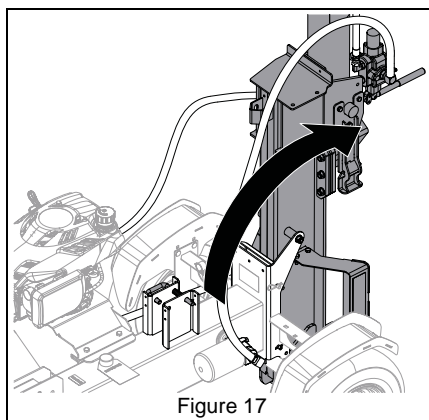

### Horizontal Operating Position

1. Carefully rotate beam down until seated on lock bracket.
2. Turn beam lock until pin lines up with hole in lock bracket and release.
3. Ensure that beam lock pin fully engages in bracket.
4. Rotate rear stabilizer to operating position. See Figure 18.



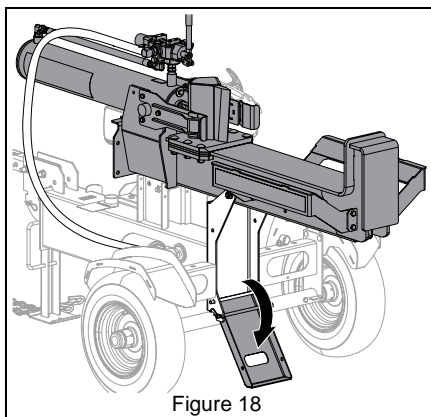

Figure 18

## WARM UP UNIT

When using the unit in temperatures of 20° C (68° F) or lower, the hydraulic system should be cycled before splitting logs. This allows the cool hydraulic oil in the cylinder to be circulated before placing a load on the hydraulic system.

1. Start the engine and allow it warm up. See *Start the Engine* on page 15.
2. Cycle the cylinder through three or four full extension / retraction cycles.

## OPERATION



**WARNING: AVOID INJURY.** Read and understand the entire *Safety* section before proceeding.

## START THE ENGINE

1. Make sure control lever is in neutral position.
2. *Model 917032 only:* Move throttle lever to slow position.
3. Move the engine switch to the ON position.
4. Open the fuel valve.
5. If engine is cold, move choke control lever to on position. **DO NOT** use choke on a warm engine.
6. Slowly pull the recoil starter until engine compression makes pulling difficult. Let the starter rewind a little, and then pull smoothly and quickly to start the engine.
7. Repeat step 6 as needed.
8. Gradually move choke control lever to the off position after engine starts.

9. *Model 917032 only:* Move throttle lever to the Fast position.

## SPLIT LOGS



**CAUTION:** During operation, engine and hydraulic system are hot. Always stop engine and allow unit to cool before changing beam positions.

**IMPORTANT:** *Model 917032 only:* Always split logs with engine set at Fast position.

1. Fully retract cylinder.
2. Place log on beam:
  - Split only from log ends, with the grain.
  - Position log against grips on end plate with the squarest end toward the splitter edge.
  - Position hands on sides of logs when placing logs on unit and not on the end. Never place hands or any part of the body between a log and any part of the log splitter.
  - Do not attempt to stabilize logs with legs or feet while operating.

See Figure 19.

3. Using only your hand, push the control lever toward the log.
4. Hold the lever in the out position until log is split.

**NOTICE:** Splitter wedge is designed to reach full extension and stop between 25 and 50 mm (1 and 2") before contacting end plate.

**IMPORTANT:** When cylinder is fully extended do not hold lever in out position. Pump damage will result.

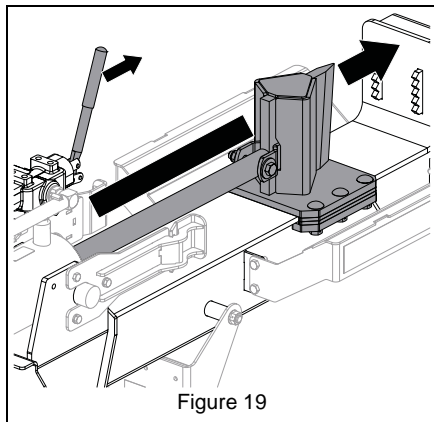

Figure 19



**WARNING:** Keep hands and fingers away from splitter wedge and stripper plates during cylinder retraction.

5. Allow split logs to drop to the ground. DO NOT try to catch split logs.
6. Move control lever away from the log until it locks into retract position. Lever will automatically return to neutral once cylinder is fully retracted.
7. Do not load another log or remove split pieces until the cylinder has completely stopped and the control lever is in the neutral position. Do not reach across the unit.

**IMPORTANT:** Split only one log at a time unless the cylinder has been fully extended and a second log is needed to complete the separation of the first log.

8. Move split logs as necessary to ensure that all tripping hazards have been eliminated from the operator zone.

## REMOVE LOGS FROM WEDGE



**CAUTION:** Do not use the unit if the stripper plates are bent or damaged. Bent or damaged stripper plates must be repaired or replaced before use.

1. Move the control lever to the Return / Up position.
2. Allow the cylinder to retract until the stuck log contacts the stripper plates.
3. Continue to retract the cylinder until the log is dislodged from the splitter wedge.
4. Once removed from the splitter wedge rotate log and split from a different location or split log from the other end.

## STOP THE ENGINE

1. Return cylinder to fully retracted position.
2. *Model 917032 only:* Move throttle control lever to slow position.
3. Stop engine and close fuel valve.

## TRANSPORT UNIT

**IMPORTANT:** Check local, state and federal laws before towing unit. Any modifications required to meet these laws are the responsibility of the purchaser.



**CAUTION:** Unit can cause serious injury if it rolls out of control or tips over. Chock wheels when unit is not attached to a tow vehicle.

**IMPORTANT:** Ensure that wheel bearings are well packed with grease and that tires are inflated properly before towing. To tow unit:

1. Place beam in horizontal position and engage beam locks. See *Position Beam* on page 14.
2. Close fuel valve.
3. Move rear stabilizer to transport position and lock in place. See *Position Beam* on page 14.
4. Attach log splitter hitch to tow vehicle with class 1 or higher receiver and 2" ball. Adjust hitch coupler to ensure lock lever fully locks onto ball with no excess movement. Install a locking pin or lock through the lock lever.



**CAUTION:** Jack stand must be locked in the transport position before towing the unit.

5. Move front jack stand to transport position and lock in place. See Figure 20.

**NOTICE:** Tow vehicles with low ball heights will require the jack stand to be stored before attaching the hitch coupler to the ball.

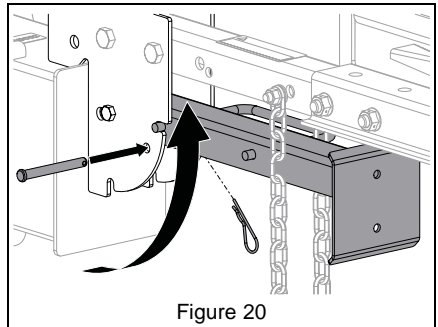

Figure 20

6. Cross unit safety chains under the coupler and attach to tow vehicle.



**CAUTION:** Avoid damage or injury! Use maximum caution when towing log splitter:

- DO NOT exceed 72.4 kph (45 mph).
- Obey all applicable local, state and federal laws regarding towing.
- DO NOT carry passengers, cargo or logs on the towed unit.
- Allow for the extra length of the unit when turning, parking, crossing intersections and in all driving situations.
- Ensure that stabilizers are locked in the transport position and that the beam is locked before moving unit.
- Drive slowly and take extra caution over rough terrain.

## FOR BEST PERFORMANCE

- Ensure that logs to be split are cut as square as possible.
- Split dry, cured logs. Wet or recently cut logs will be more difficult to split.
- Split logs with straight grain. Logs with knots or twisted or irregular grain patterns will be more difficult to split.
- Move split logs as needed to keep operator zone free of tripping hazards.
- When splitting logs that are not square place the longest portion of the log closest to the beam and the most square end against the splitter wedge.

## MAINTENANCE



**WARNING: AVOID INJURY.** Read and understand the entire *Safety* section before proceeding.

Proper maintenance can prolong the life of unit. The *Maintenance Schedule on Page 17* shows the recommended service schedule. Your Ariens dealer can provide service and adjustments to keep your unit operating at peak efficiency. Contact an authorized engine manufacturer's service center for engine service.

More frequent service may be required due to working conditions (heavy loads, high ambient temperatures, dusty conditions, or airborne debris).

See the maintenance instructions in the Engine Manual for additional information.

## MAINTENANCE SCHEDULE

Service Performed	Each Use	Every 25 hrs.	Every 50 hrs. / Annually	Every 100 hrs. / Annually
Check Hydraulic System	•			
Check Hydraulic Lines	•			
Follow Engine Maintenance Schedule*	•			
Check Engine Oil *	•			
Change Engine Oil *				
Check Tire Pressure	•			
Lubricate Unit			•	
Check Fasteners			•	
Check Wheel Bearings				•
Change Hydraulic Oil and Filter				•
* Refer to engine manual for instructions.				

## HYDRAULIC OIL SYSTEM

### Check Hydraulic System

1. Inspect hydraulic drive coupling for damage or deterioration. Replace as necessary.
2. Check for leaking, kinked or damaged lines. Replace as necessary.

### Check Hydraulic Oil Level

**IMPORTANT: ADD OIL BEFORE OPERATING!** Add hydraulic oil to operating level before use. Do not overfill.

To check the hydraulic oil level:

1. Park the unit on a level surface.
2. Start the unit and run it to operating temperature (about 10 minutes).
3. Cycle the hydraulic cylinder in and out two or three times.
4. Stop engine. See *Stop the Engine* on page 16.

5. Remove any dirt that may be around the cap / breather on the hydraulic reservoir.
6. Remove cap / breather and wipe oil level dipstick clean.
7. Replace cap/breather and fully tighten.
8. Remove cap/breather and check oil level on dipstick. Oil should be within the operating range. See Figure 21.

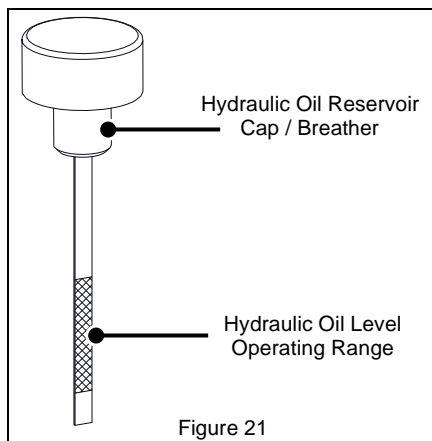

9. Add hydraulic oil as necessary. Do not overfill.

### Recommended Hydraulic Oil

Only use the following hydraulic oils:

- ISO32 hydraulic oil (Ariens part number 00069100).
- Dexron® III / Mercon® automatic transmission fluid.
- 10 weight AW hydraulic oil.
- Pro-Mix™ AW-32 Hydraulic Oil.

### Change Hydraulic Oil and Filter

**NOTICE:** Change the hydraulic oil and oil filter every season or 100 hours.

See Figure 22.

1. Clean area around hydraulic supply hose.
2. Place container under oil filter and hydraulic supply hose to catch oil.
3. Remove hose clamp and disconnect hose from hydraulic tank.

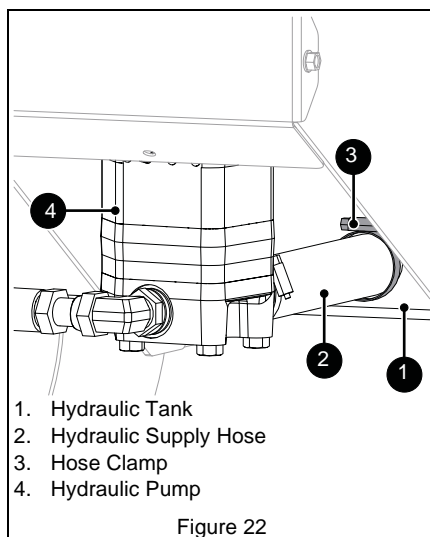

4. Remove oil filter. See Figure 23.

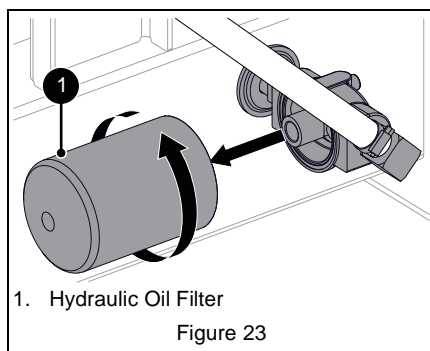

5. Allow tank to drain.
6. Reinstall hydraulic suction hose and tighten hose clamp.
7. Lubricate rubber gasket on new oil filter with clean hydraulic oil.
8. Spin new oil filter onto filter housing until it makes contact. Tighten oil filter another 1/2 turn.
9. Add new oil to the oil tank.
10. Check hydraulic oil level.
11. Properly dispose of waste oil.

### Purge Air From Hydraulic System

1. With the engine running, extend the hydraulic cylinder out fully and then retract fully.
2. Repeat 4 – 5 times. Erratic movement in the hydraulic cylinder indicates that there is air in the system.

3. Stop the engine and check the hydraulic oil level. Add if necessary.
4. Repeat extending and retracting of hydraulic cylinder unit motion is consistent and smooth in both directions.
5. Ensure that hydraulic oil is at proper level.

**IMPORTANT:** At this point a large amount of hydraulic oil has been drawn into the hydraulic cylinder and hoses. Be sure to refill the oil reservoir to prevent pump damage.

## CHECK TIRE PRESSURE

1. Check tire pressures and inflate to recommendation. See *Specifications* on page 22.



**WARNING: AVOID INJURY.** Explosive separation of tire and rim parts is possible.

- DO NOT inflate tires above maximum pressure listed on tire sidewalls.
- DO NOT inflate tires with a compressor; use a hand pump.
- DO NOT stand in front of tire assembly when inflating. Use a clip-on chuck and extension hose long enough to allow you to stand to one side.
- DO NOT mount a tire without proper equipment and experience.

## LUBRICATE UNIT

Use the following key for all lubrication procedures.

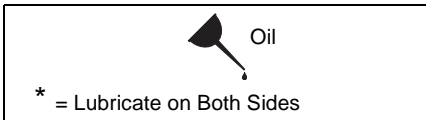

1. Apply oil to all pivot points and pin connections. See Figure 24.

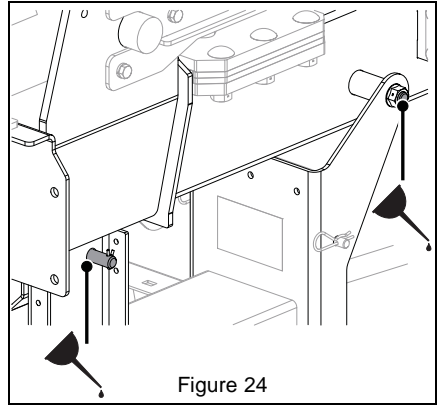

Figure 24

## LUBRICATE WHEEL BEARINGS

1. Remove bearing dust caps and inspect and repack wheel bearings with grease.
2. After packing bearings, seat bearings by tightening the spindle nut snug.
3. Loosen nut, spin wheel and retighten slightly until first slot in castle nut aligns with hole in hub.
4. Replace cotter pin and dust cap.

**NOTICE:** Wheel should spin freely with no wobble.

## SERVICE PARTS

See your Ariens dealer to purchase service parts for your unit.

Description	Qty.	Part No.
Drive Coupler Alignment Tool	1	04651900
Hydraulic Oil Filter	1	04975800
Air Filter (Model 917032)	1	20020002
Air Filter (Model 917031)	1	21100120
Spark Plug (Model 917032)	1	20020001
Spark Plug (Model 917031)	1	21100122
Hydraulic Oil – ISO 32	AR	00069100
Fuel Stabilizer – 4-Oz Bottle (Except Canada)	AR	04730400
Fuel Stabilizer – 4-Oz Bottle (Canada Only)	AR	04742500

## STORAGE



**WARNING: AVOID INJURY.** Read and understand the entire *Safety* section before proceeding.

### SHORT-TERM STORAGE

**IMPORTANT:** NEVER wash unit with high-pressure water or store outdoors.

1. Allow unit to cool and clean with mild soap and water.
2. Tighten all hardware to correct specifications.
3. Inspect unit for visible signs of wear or damage. Repair as needed.
4. Prepare fuel system for storage.

**NOTICE:** Ariens recommends using a quality fuel stabilizer in all fuel. Gasoline left in the fuel system without a stabilizer, even for short periods of time, deteriorates and leaves gummy deposits in the system that may damage the carburetor and fuel hoses, filter and tank. For the best effectiveness, add stabilizer to all fuel containers whenever purchasing fuel. Add the stabilizer to the container before adding fuel.

- a. Add Ariens fuel stabilizer. See *Service Parts* on page 19 or equivalent according to manufacturer's instructions to the fuel tank and any fuel containers with remaining fuel.
- b. Operate engine outdoors for at least 5 minutes to allow stabilizer to reach the carburetor.

### LONG TERM STORAGE

1. Perform short-term storage procedures.
2. Lubricate as directed in *Maintenance on Page 17*.
3. Touch-up all scratched painted surfaces.
4. Store unit in a cool, dry, protected area. DO NOT store unit outdoors.

### START-OF-SEASON PREPARATION

1. Before adding fuel for the first time after long-term storage, add fresh, stabilizer-treated fuel to fuel tank and any fuel containers with remaining fuel.

## ACCESSORIES

See your Ariens dealer for a complete list of compatible accessories and attachments for your unit.

Description	Part No.
Work Table Kit	71702900
Light Kit	71701300
License Plate Light Holder	71701400
Engine Cover Kit	71701500
Log Splitter Handle Kit	71701800
Jack Stand with Wheel Kit	71702200

## TROUBLESHOOTING

Problem	Probable Cause	Correction
<b>Engine will not start.</b>	Engine switch in Off position.	Move switch to On position. See <i>Engine Switch</i> on page 10.
	Fuel shut-off valve in Off position.	Move valve to On position. See <i>Fuel Valve</i> on page 10.
	Fuel tank empty.	Fill fuel tank with fuel. See <i>Before Operation</i> on page 13.
	Spark plug disconnected.	Connect spark plug.
	Faulty spark plug.	Replace spark plug.
	Choke lever in wrong position.	Adjust choke lever position. See <i>Choke Control Lever</i> on page 10.
	Faulty engine.	See your Ariens Dealer.
<b>Engine overheats.</b>	Debris accumulated on engine and cooling fins.	Clean debris from engine and cooling fins.
<b>Cylinder does not extend or retract when control lever is moved.</b>	Low hydraulic oil level.	Refill hydraulic oil to proper level. See <i>Check Hydraulic Oil Level</i> on page 17.
	Kinked or pinched hydraulic lines.	Repair or replace damaged hydraulic lines.
	Hydraulic drive coupling broken.	Replace hydraulic drive coupling. See <i>Maintenance</i> on page 17.
	Faulty hydraulic pump.	See your Ariens Dealer.
	Faulty control valve.	See your Ariens Dealer.
<b>Excessive vibration or noise from hydraulic drive coupling.</b>	Worn or damaged drive coupling.	Replace hydraulic drive coupling. See <i>Maintenance</i> on page 17.
<b>Erratic movement of cylinder.</b>	Air in hydraulic system.	Purge air from hydraulic system. See <i>Purge Air From Hydraulic System</i> on page 18.
<b>Control lever sticks.</b>	Debris in control lever linkage.	Clean and lubricate linkage.
	Dented rear cap on control lever valve assembly.	See your Ariens Dealer.

## SPECIFICATIONS

Model Number	917031	917032
Model	27-Ton Log Splitter	34-Ton Log Splitter
Engine		
Engine	Subaru	
Engine Model Number	EA190V – CARB	SP210 – CARB
Displacement – cm <sup>3</sup> (in <sup>3</sup> )	189 (11.53)	211 (12.87)
Maximum RPM – No Load.	3750 ± 150	
Oil Capacity – L (Pt.)	0.6 (1.3)	
Fuel Tank Capacity – L (Qt.)	1.14 (1.2)	3.6 (3.8)
Fuel Octane Rating	Refer to Engine Manual	
Hydraulic System Capacity – L (Gal.)	17 (4.5)	
Splitting Force – kg (Ton)	24,490 (27)	30,844 (34)
Cylinder Cycle Time – Seconds	17	18
Bed Capacity: Log Length – cm (in.)	63.5 (25)	
Size and Weight		
Length: Horizontal Position – cm (in.)	219 (86.25)	
Length: Vertical Position – cm (in.)	212.7 (83.75)	
Width – cm (in.)	97.2 (38.25)	
Height: Horizontal Position – cm (in.)	118.1 (46.50)	
Height: Vertical Position – cm (in.)	164.5 (64.75)	
Weight – kg (lbs.)	202.3 (446)	210.9 (465)
Tires		
Tire Size – in.	4.80-4.00 x 8	
Tire Pressure – kPa (psi)	137.9 (30)	
Maximum Towing Speed – kph (mph)	72.4 (45)	
Hitch Coupler – cm (in.)	5.1 (2.0)	





# Sno-Thro<sup>®</sup>, Sno-Tek<sup>®</sup> and Chore Performing Equipment Limited Warranty

Ariens Company (Ariens) warrants to the **original purchaser** that Ariens, Gravely, Parker, and Countax brand chore performing equipment (including Sno-Thro<sup>®</sup> and Sno-Tek<sup>®</sup> equipment) purchased on or after 1/1/2015 will be free from defects in material and workmanship for the time period noted in the chart below. Equipment put to personal use around a single household or residence is considered "Consumer Use"; equipment put to any business use (agricultural, commercial, or industrial) or used at multiple locations is considered "Commercial Use." If any product is rented or leased, then the duration of these warranties shall be 90 days after the date of purchase.

An authorized Ariens dealer (Ariens brand products), Gravely dealer (Gravely brand products), Parker dealer (Parker brand products), or Countax dealer (Countax brand products) will repair any defect in material or workmanship, and repair or replace any defective part, subject to the conditions, limitations and exclusions set forth herein. Such repair or replacement will be free of charge (labor and parts) to the original purchaser except as noted below.

Warranty Code	Product Group	Warranty Period Consumer Use	Warranty Period Commercial Use
PA	Log Splitters, Brushes, String Trimmers, Edgers	3 Years	90 Days
PB	Professional Powered Brushes	3 Years	1 Year
PC	Tillers	2 Years	90 Days
PD	Vacuums, Blowers, Sweepers, Truck Loaders, Lawn Rakes, Sprayers, Aerators, etc.	1 Year	1 Year
PE	Pressure Washer, Generators	3 Years	1 Year
SA	Professional Sno-Thro <sup>®</sup>	3 Years	1 Year
SB	Compact, Deluxe, Platinum, AMP <sup>™</sup> Sno-Thro <sup>®</sup> , Path-Pro <sup>®</sup>	3 Years	90 Days
SC	Sno-Tek <sup>®</sup>	2 Years	90 Days
UA	Utility Vehicles	1 Year	1 Year
N/A	Service (Replacement) Parts	90 Days (no labor)	90 Days (no labor)

## Special Extensions

The chart below details special extensions to this warranty:

Warranty Code	Warranty Exception	Warranty Period	Use	Detail
SA	Cast Iron Auger Gear Case	5 Years	All	5 Years for all users including Commercial
SB	Cast Iron Auger Gear Case	5 Years	Consumer	5 Years for Consumer use; 1 Year for Commercial Use
SB	Batteries for AMP <sup>™</sup> Sno-Thro <sup>®</sup>	2 Years	Consumer	100% first year; prorated second year.

## **Exceptions and Limitations**

The chart below details special exceptions to this warranty:

Warranty Code	Warranty Exception	Warranty Period	Use	Detail
All (Exc. SB)	Batteries	1 Year	All	Prorated
All	Belts, Muffler, Tires	None	Commercial	These components are not covered when used commercially.
All	Cloth, Plastic, and Rubber Components (Including Belts and Cables)	Maximum 2 Years	All	Warranty is limited to 2 years for consumer use. (1 year for warranty code "PD".) Except as noted above, these components are covered for defect, not for wear.
SA, SB, SC	Idlers	Maximum 2 Years	All	Warranty is limited on idlers to 2 years for consumer use.
All	Engines	See Engine Manufacturer's Warranty	All	Engines are covered by engine manufacturer's warranty. Refer to engine manufacturer's warranty statement.

## **Customer Responsibilities**

**Register the product immediately at the time of sale.** If the dealer does not register the product, the customer must complete the product registration card in the literature package and return it to Ariens Company, or register the unit online at [www.ariens.com](http://www.ariens.com), [www.gravely.com](http://www.gravely.com), [www.countax.com](http://www.countax.com) or [www.parkersweeper.com](http://www.parkersweeper.com).

To obtain warranty service, the **original purchaser** must:

- Perform the maintenance and adjustments explained in the Owner's Manual.
- Promptly notify Ariens or an authorized Ariens, Gravely, Parker or Countax service representative of the need for warranty service.
- Transport the product to and from the place of warranty service at owner's expense.
- Have the warranty service performed by an authorized Ariens, Gravely, Parker or Countax service representative.

## **To Find an Authorized Service Representative:**

<b>In the U.S. and Canada:</b>		
Use the dealer locator on our websites: <a href="http://www.ariens.com">www.ariens.com</a> • <a href="http://www.gravely.com">www.gravely.com</a>		
Or contact us by mail or by phone:		
<b>In the U.S., Canada, Mexico, Caribbean, Central and South America:</b>	<b>In Europe, Asia, Africa or the Middle East:</b>	<b>In Australia or New Zealand:</b>
Ariens Company 655 W. Ryan Street Brillion, WI 54110 Phone: (920) 756 - 4688 <a href="http://www.ariens.com">www.ariens.com</a>	Ariens Company Limited Great Haseley, Oxford OX44 7PF United Kingdom Phone: +44 800 597 7777 <a href="http://www.countax.co.uk">www.countax.co.uk</a>	Allpower Industries Pty Ltd 128 Bridge Rd Keysborough VIC 3173 Australia Phone: +61 1800 333 428 <a href="http://www.allpower.com.au">www.allpower.com.au</a>

## **Exclusions – Items Not Covered by This Warranty**

- Parts that are not genuine Ariens, Gravely, Parker or Countax service parts are not covered by this warranty and may void the warranty.
- Damages resulting from the installation or use of any part, accessory, or attachment which is not approved by the Ariens Company for use with product(s) identified herein are not covered by this warranty.
- The following maintenance, service and replacement items are not covered by this warranty unless they are noted in the Limitations section above: lubricants, spark plugs, oil, oil filters, air filters, fuel filters, brake linings, brake arms, brake shoes, skid shoes, scraper blades, shear bolts, mower blades, mower vanes, brushes, headlights, light bulbs, knives, cutters, and single-stage impellers.
- Any misuse, alteration, improper assembly, improper adjustment, neglect, or accident which requires repair is not covered by this warranty.
- **Use of gasoline blends exceeding 10% ethanol voids any and all warranties.**
- Products are designed to the specifications in the area that the product was originally distributed. Different areas may have significantly different legal and design requirements. This warranty is limited to the requirements in the area in which the unit was originally distributed. Ariens Company does not warrant this product to the requirements of any other area. Warranty service is limited to service within the area originally distributed.
- In countries other than the United States and Canada, contact the Ariens Company dealer for warranty policies that govern within your country. Rights may vary from country to country and within any one country.
- Normal Wear: This warranty does not cover repair when normal use has exhausted the useful life of a part such as a high pressure hose, spray wand, nozzles, trigger handle, supply hoses, quick couplers, gaskets, valves, pistons, pump valve assemblies, o-rings, water and oil seals.

## **Special Exclusions on Utility Vehicles**

The following uses void the warranty terms on Utility Vehicles (Warranty Code UA):

- Renting or leasing the utility vehicle.
- Using the utility vehicle to tow or carry loads in excess of the limits specified in the Owner/Operator Manual.
- Modifying the utility vehicle with parts and accessories that are not genuine or authorized Ariens or Gravely parts or accessories.
- Modifying the utility vehicle without express written authorization from Ariens Company.
- Operating the utility vehicle when it has not been completely and properly assembled and pre-delivered by an authorized Gravely dealer.

## **Disclaimer**

Ariens Company may from time to time change the design of its products. Nothing contained in this warranty shall be construed as obligating Ariens Company to incorporate such design changes into previously manufactured products, nor shall such changes be construed as an admission that previous designs were defective.

## **LIMITATION OF REMEDY AND DAMAGES**

Ariens Company's liability under this warranty, and under any implied warranty that may exist, is limited to repair of any defect in workmanship, and repair or replacement of any defective part. Ariens Company shall not be liable for incidental, special, or consequential damages (including lost profits). Some states do not allow the exclusion of incidental or consequential damages, so the above limitation or exclusion may not apply to you.

## **AUSTRALIAN CONSUMER LAW**

The following applies solely to warranties subject to Subsection 102(1) of the Australian Consumer Law: Our goods come with guarantees that cannot be excluded by the Australian Consumer Law. You are entitled to a replacement or refund for a major failure and for compensation for any other reasonably foreseeable loss or damage. You are also entitled to have the goods repaired or replaced if the goods fail to be of acceptable quality and failure does not amount to a major failure.

## **DISCLAIMER OF FURTHER WARRANTY**

Ariens Company makes no warranty, express or implied, other than what is expressly made in this warranty. If the law of your state provides that an implied warranty of merchantability, or an implied warranty of fitness for particular purpose, or any other implied warranty, applies to Ariens Company, then any such implied warranty is limited to the duration of this warranty. Some states do not allow limitations on how long an implied warranty lasts, so the above limitation may not apply to you.

*This warranty gives you specific legal rights, and you may also have other rights which vary from region to region.*



655 West Ryan Street  
Brillion, WI 54110

[ariensstore.com](http://ariensstore.com)  
[ariens.custhelp.com](http://ariens.custhelp.com)



## WARNING



The engine exhaust from this product contains chemicals known to the State of California to cause cancer, birth defects or other reproductive harm.

An *Ariens* Company Brand