

OWNERS MANUAL



924000 SERIES SNO-THROS

MODEL 924027 8 H.P. TRACTOR
SMALL WHEEL W/DIFFERENTIAL
SERIAL NUMBER 001001

MODEL 924036 5 H.P. 24"
SMALL WHEEL
SERIAL NUMBER 000101

MODEL 924038 7 H.P. 24"
SMALL WHEEL
SERIAL NUMBER 000101

MODEL 924039 8 H.P. 24"
SMALL WHEEL W/DIFFERENTIAL
SERIAL NUMBER 000101

MODEL 924040 8 H.P. 24"
LARGE WHEEL
SERIAL NUMBER 000101

MODEL 924042 8 H.P. 32"
LARGE WHEEL W/DIFFERENTIAL
SERIAL NUMBER 000101

MODEL 924044 10 H.P. 32"
LARGE WHEEL W/DIFFERENTIAL
SERIAL NUMBER 000101

ATTACHMENTS:

MODEL 824001 24" SNO-THRO
ATTACHMENT FOR SMALL WHEEL TRACTORS
SERIAL NUMBER 000101

MODEL 824002 24" SNO-THRO
ATTACHMENT FOR LARGE WHEEL TRACTORS
SERIAL NUMBER 000101

MODEL 824003 32" SNO-THRO
ATTACHMENT FOR LARGE WHEEL TRACTORS
SERIAL NUMBER 000101

▲ SAFETY MESSAGE ▲

The product for which you have requested information or replacement parts is not a current product. The replacement models incorporate product designs, safety features, safety instructions or warnings which represent the latest "State Of The Art" developments. For your safety and those around you please contact your nearest Ariens/Gravely Dealer for a demonstration of the current product safety provisions and features.

A MESSAGE TO THE ARIENS CUSTOMER...

Welcome to the world of Ariens equipment. We are pleased that you have selected Ariens and sincerely believe you have purchased the best equipment available. The care you give your new Ariens equipment will greatly determine the satisfaction and service life you will obtain from it. Use this manual and the engine manual supplied, as your guide. By observing the instructions and suggestions in these manuals, your Ariens equipment will serve you well for many years.

Your Ariens dealer will be happy to supply any service or advice which may be required to keep your Ariens equipment operating at peak efficiency. He stocks genuine Ariens parts and lubricants; manufactured with the same precision and skill as the original equipment. His factory trained staff is kept well informed on the best methods of servicing Ariens

equipment and is ready and able to serve you. If engine repairs or services are required, they can be obtained from an Ariens dealer or from an authorized engine manufacturer's service station.

Should service be required on equipment, be prepared to supply the serviceman with the Model Number and Serial Number of the equipment and the engine, as well as a full description of the trouble encountered.

Finally, your local Ariens dealer is in the best position to answer your questions and service equipment. If for some reason he is unable to satisfy your requirements, assistance is always available from the Consumer Services, Ariens Company, Brillion, Wisconsin 54110. Telephone: (414) 756-2141.

Ariens COMPANY BRILLION, WISCONSIN 54110

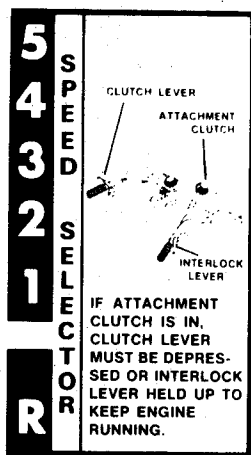

78331



78334



ARIENS COMPANY BRILLION, WISCONSIN U.S.A.

SCREENED ON PANEL



78324



78326

A HIGH SPEED IMPELLER ROTATES INSIDE THIS HOUSING TO THROW THE SNOW. NEVER REACH OR PUSH ANY OBJECT INTO THE DISCHARGE CHUTE WITH THE IMPELLER ROTATING!

SAFETY INSTRUCTIONS

AVOID POTENTIAL HAZARDS

1. READ OWNERS MANUAL FOR OPERATING AND SAFETY INSTRUCTIONS.
2. OBSERVE ALL LABELS AND INSTRUCTIONS. DO NOT DEFEAT INTERLOCK SYSTEM. IT IS FOR YOUR PROTECTION.
3. STOP ENGINE AND WAIT FOR ALL MOVEMENT TO STOP BEFORE UNBLOCKING OR SERVICING MACHINE.
4. NEVER ALLOW CHILDREN TO OPERATE THE EQUIPMENT. NEVER ALLOW ADULTS TO OPERATE THE EQUIPMENT WITHOUT PROPER INSTRUCTION.
5. KEEP THE AREA OF OPERATION CLEAR OF ALL PERSONS, ESPECIALLY CHILDREN.
6. NEVER DIRECT DISCHARGE AT BYSTANDERS OR ALLOW ANYONE IN FRONT OF UNIT.
7. KEEP MACHINE PROPERLY MAINTAINED AND SERVICED WITH ALL SHIELDS, GUARDS, AND PROTECTIVE DEVICES IN PLACE.

78416

KEEP HANDS, FEET AND ALL FOREIGN OBJECTS OUT OF THE COLLECTOR (RAKES). REPLACE SHEAR BOLTS WITH ARIENS SHEAR BOLTS ONLY!

COLLECTOR

ORDER ALL DECALS BY ARIENS PART NUMBER SHOWN

COMPLIANCE WITH CANADIAN RADIO INTERFERENCE REGULATIONS CERTIFIED
REPLACE SPARK PLUG WITH RESISTOR SPARK PLUG ONLY!
CERTIFIÉ CONFORME AU RÈGLEMENT CANADIEN SUR LE BROUILLAGE RADIOÉLECTRIQUE
REMPLACER LA ROUGIE PAR UNE ROUGIE À RÉSISTANCE SEULEMENT!

78400

INSTRUCTIONS FOR SAFE OPERATION



IMPORTANT

Safe Operation Practices for Snow Throwers

Training

1. Read the owner's manual carefully. Be thoroughly familiar with the controls and the proper use of the equipment. Know how to stop the unit and disengage the controls quickly.
2. Never allow children to operate the equipment. Never allow adults to operate the equipment without proper instruction.
3. Keep the area of operation clear of all persons, particularly small children, and pets.
4. Exercise caution to avoid slipping or falling, especially when operating in reverse.

Preparation

1. Thoroughly inspect the area where the equipment is to be used and remove all doormats, sleds, boards, wires, and other foreign objects.
2. Disengage all clutches and shift into neutral before starting the engine (motor).
3. Do not operate the equipment without wearing adequate winter outer garments. Wear footwear which will improve footing on slippery surfaces.

4. Handle fuel with care; it is highly flammable.
 - a. Use an approved fuel container.
 - b. Never add fuel to a running engine or hot engine.
 - c. Fill fuel tank outdoors with extreme care. Never fill fuel tank indoors.
 - d. Replace gasoline cap securely and wipe up spilled fuel.
5. Use a grounded three-wire plug-in for all units with electric drive motors or electric starting motors.
6. Adjust the collector housing height to clear gravel or crushed rock surface.
7. Never attempt to make any adjustments while the engine is running (except where specifically recommended by manufacturer).
8. Let engine and machine adjust to outdoor temperatures before starting to clear snow.

Operation

1. Do not put hands or feet near or under rotating parts. Keep clear of the discharge opening at all times.
2. Exercise extreme caution when operating on or crossing gravel drives, walks, or roads. Stay alert for hidden hazards or traffic. Do not carry passengers.
3. After striking a foreign object, stop the engine, remove the wire from the spark plug, thoroughly inspect the snow thrower for any damage, and repair the damage before re-starting and operating the snow thrower.

ORDER FROM TECUMSEH

ENGINE PRIMER

PUSH TO PRIME

8 & 10 H.P.

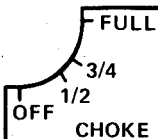
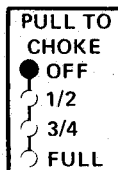

8 & 10 H.P.
ORDER FROM TECUMSEH

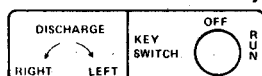

SCREENED
ON PANEL



78038 (ON LEFT
WHEEL HUB OF
MODELS 924027,
924039, 924042
& 924044)

5 H.P. ENGINE DECAL 78193
7 H.P. ENGINE DECAL 78192
8 H.P. ENGINE DECAL 78191
10 H.P. ENGINE DECAL 78424

ATTENTION

WHEN USING SUMMER ATTACHMENTS
REMOVE HEATER BOX AND INSTALL
AIR CLEANER

78189
(ON HEATER BOX)

WARNING

ROTATING PARTS
STOP ENGINE AND REMOVE SPARK
PLUG IGNITION WIRE BEFORE
REMOVING OBSTRUCTIONS

78323

120 VOLT A.C.
ELECTRIC STARTER
PUSH TO START

78357

(120V AC STARTER KIT ONLY)

Ariens

78174 ON MODELS 924036, 38, 39 & 40
78244 ON MODELS 924042 & 924044



78345

WARNING

ROTATING PARTS
KEEP CLEAR OF COLLECTOR
RAKES WHILE ENGINE
IS RUNNING

78327

OPERATING INSTRUCTIONS
REFER TO OWNERS MANUAL

TO START TURN KEY SWITCH ON AND PULL STARTER FROM RIGHT SIDE OF MACHINE
TO STOP TURN KEY SWITCH TO OFF AND REMOVE KEY

SCREENED ON PANEL

ORDER ALL DECALS BY ARIENS PART NUMBERS SHOWN

BE AWARE OF SAFETY DECALS

- If the unit should start to vibrate abnormally, stop the engine and check immediately for the cause. Vibration is generally a warning of trouble.
- Stop the engine whenever you leave the operating position, before unclogging the collector/impeller housing or discharge guide, and when making any repairs, adjustments, or inspections.
- When clearing, repairing, or inspecting, make certain the collector/impeller and all moving parts have stopped. Disconnect the spark plug wire.
- Do not run the engine indoors, except when starting the engine and for transporting the snow thrower in or out of the building. Open the outside doors; exhaust fumes are dangerous.
- Do not clear snow across the face of slopes. Exercise extreme caution when changing direction on slopes. Do not attempt to clear steep slopes.
- Never operate the snow thrower without proper guards, plates, or other safety protective devices in place.
- Never operate the snow thrower near glass enclosures, automobiles, window wells, drop-offs, etc, without proper adjustment of the snow discharge angle. Keep children and pets away.
- Do not overload the machine capacity by attempting to clear snow at too fast a rate.

- Never operate the machine at high transport speeds on slippery surfaces. Use care when backing.
- Never direct discharge at bystanders or allow anyone in front of the unit.
- Disengage power to the collector/impeller when snow thrower is transported or not in use.
- Use only attachments and accessories approved by the manufacturer of snow thrower (such as wheel weights, counterweights, cabs, etc).
- Never operate the snow thrower without good visibility or light. Always be sure of your footing, and keep a firm hold on the handles. Walk; never run.

Maintenance and Storage

- Check shear bolts, engine mounting bolts, etc, at frequent intervals for proper tightness to be sure the equipment is in safe working condition.
- Never store the machine with fuel in the fuel tank inside a building where open flame or sparks are present. Allow the engine to cool before storing in any enclosure.
- Always refer to owner's manual instructions for important details if the snow thrower is to be stored for an extended period.
- Run the machine a few minutes after throwing snow to prevent freeze-up of the collector/impeller.

CONTROLS

- 1 **SPEED SELECTOR:** Sets speed of tractor. Change speed or shift to reverse.

THROTTLE: Controls engine speed. On 5 and 7 HP Models move throttle control to "FAST" position after engine has stopped to minimize throttle damage due to freezing. On 8 and 10 HP Models move throttle to "SLOW" position after engine has stopped to minimize throttle damage due to freezing.

- 2 **TRACTOR CLUTCH LEVER:** Activates tractor drive. Depress to move tractor, release to disengage drive and stop machine.

- 3 **HAND CRANK:** Turns discharge chute 230° so snow can be thrown away from area being cleared.

- 4 **ATTACHMENT CLUTCH:** Activates auger and impeller.

- 5 **CHOKE:** Move choke to choke position to start engine. Models 924036 and 924038 have choke on top of heater box. Models 924039, 924040, 924042 and 924044 have choke at rear of heater box.

- 6 **PRIMER BUTTON:** Injects gas directly into carburetor. (1) Move choke lever to full (2) Push primer bulb (3) Pull starter rope three times. If engine fails to start, repeat step 2. Used on 8 & 10 HP only.

- 7 **INTERLOCK LEVER:** To minimize the chances for injury while the rakes and blower are operating (Attachment Clutch (5) engaged) either the interlock lever (8) or the tractor clutch lever (3) must be depressed or the engine will stop.

- 8 **KEY SWITCH:** Prevents unauthorized use. Turn on to run, turn off to stop.

- 9 **STARTER BUTTON:** The starter button (10) is found on all units equipped with electric starters. Plug the 120 volt cord into the starter block; plug the opposite end into a convenient 120 volt outlet. Push the starter button to start the engine.

OPERATION

BEFORE STARTING:

Fill engine crankcase (16) with Ariens Sno-Thro oil 5W-20 when using Sno-Thro.

Fill fuel tank (17) with fresh, clean, regular gasoline.

Do not mix oil with gasoline.

Make visual check with regards to safety precautions, obstructions, lubrication and maintenance.

NOTE:

This Sno-Thro is equipped with an interlock system for the protection of the operator. Any time the rakes and impeller fan are operating (anytime the Attachment Clutch is engaged) either the Interlock Lever on the right handlebar or the



CAUTION:

A high speed impeller rotates inside this housing to throw the snow. **NEVER** reach or push any object into the discharge chute with the impeller rotating!

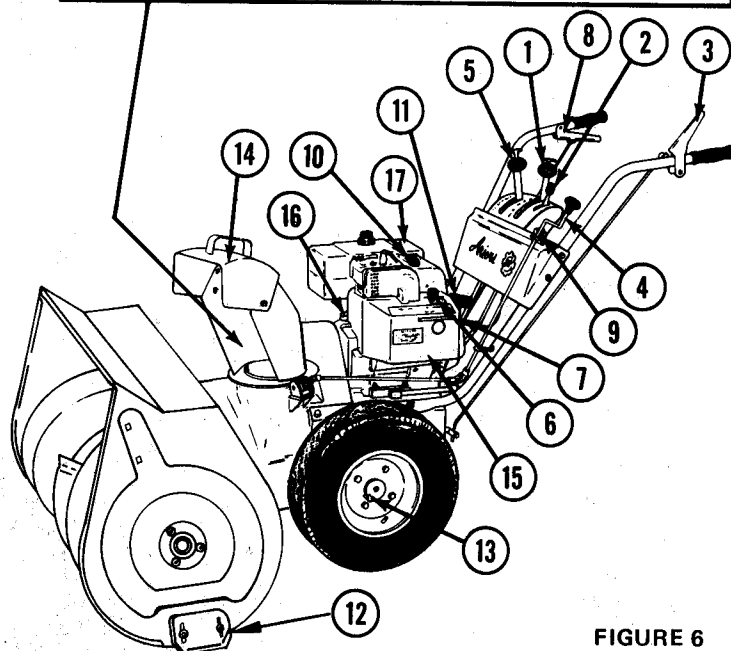

FIGURE 6

tractor clutch lever on the left handlebar must be depressed or the engine will stop. THE OPERATOR MUST REMAIN BEHIND THE HANDLEBARS, HOLDING ONE OR THE OTHER OF THESE LEVERS WHILE THE ATTACHMENT CLUTCH IS ENGAGED.

DIFFERENTIAL LOCK: MODELS 924027, 924039, 924042 & 924044

The differential lock (13) is located in the left wheel hub. When preparing to blow snow, turn the differential lock till it snaps IN. In this position the differential is locked and both wheels turn together. Power is applied equally to both. To use the differential, pull back on the knob and turn it to the OUT position. This unlocks the differential for easy turning with mower, vacuum or broom attachments.

CAUTION:

If tractor is to be used with lawn attachments, be sure heater box (15) is removed and air cleaner installed. Follow detailed instructions packed with attachment.

TO START: Controls are identified in Figure 6.

NOTE:

Check for frozen throttle control and for frozen impeller fan before starting engine. These problems arise in wet, slushy snow. If the impeller is frozen, it is best freed by thawing in a heated garage or other building. A frozen throttle control may be freed by starting the engine and letting it run long enough to heat up the carburetor and loosen the cable. The best solution for both problems is preventing freezing. Allow the engine to run for a short time before shutting down to throw the remaining slush and water out of the blower housing and thus prevent freezing of the impeller fan. On 5 and 7 HP Models move throttle control to "FAST" position after engine has stopped to minimize throttle damage due to freezing. On 8 and 10 HP Models move throttle to "SLOW" position after engine has stopped to minimize throttle damage due to freezing.

Turn key (9) to "run" position.

Move attachment clutch (5) to OUT position.

Move choke lever (6) to CHOKE position.

Move throttle (2) to FAST position.

Push primer bulb (7) 2 times (on the 8 & 10 hp only.)

Pull recoil starter (11) to start engine. If the machine is equipped with an electric starter attach the starter cable to the starter switch, plug the cable into any convenient 120 volt electrical outlet - and depress the starter button to crank and start the engine. Follow the starter manufacturers instructions supplied with the starter.

Move choke (6) to no choke gradually as engine warms up.

TO TRANSPORT:

Move attachment clutch (5) to OUT position.

Move speed selector (1) to desired speed.

Press down on handle bars to raise front of Sno-Thro slightly off the ground.

Depress tractor clutch lever (3) to transport unit.

TO OPERATE:

Move deflector (14) to desired height.

Turn hand crank (4) to direct discharge chute.

Squeeze Interlock Lever (8).

Move attachment clutch (5) to IN position.

Move speed selector (1) to desired speed.

Move throttle (2) to desired speed.

Depress the tractor clutch lever (3) to move tractor.

Speed of the machine is controlled by the throttle and speed selector.

TO STOP:

Release tractor clutch lever (3) Allow the Sno-Thro to run for a short time to throw out slush and water and prevent freezing the impeller fan.

Disengage attachment clutch (5)

Turn key (9) to "off" position to stop.

5 and 7 HP Models: Move throttle to "FAST" position after engine has stopped.

8 and 10 HP Models: Move throttle to "SLOW" position after engine has stopped.

MAINTENANCE

Ariens Company recommends that you have adjustments made by your local Ariens dealer. He has the tools and know-how to properly perform these maintenance adjustments which may be required to keep the Sno-Thro operating at peak efficiency. The Sno-Thro is equipped with the finest quality engine obtainable. However, should servicing be required, it can be obtained from an Ariens dealer or an authorized engine manufacturer's service station. Should you decide to make adjustments on your Sno-Thro yourself, Ariens recommends that you call your dealer for the answers to any questions that might arise in performing this work.

SHEAR BOLT REPLACEMENT

Occasionally a small object may enter the collector and jam the rakes. When this occurs, the shear bolts securing the rakes to the shaft will break and allow the rake to turn freely on the shaft preventing damage to the gear drive. When this happens, turn off the engine, remove wire from spark plug, remove the broken shear bolt and replace with a new ARIENS shear bolt. Use of any other type of shear bolt may result in severe damage to the machine. USE ONLY ARIENS SHEAR BOLTS FOR REPLACEMENT.

RUNNERS AND SCRAPER BLADE

The runners (12) on each side of the blower housing, and the scraper blade, along the back of the blower housing, are all adjustable to suit conditions. Raising or lowering the runners controls the distance the scraper blade is held above the surface being cleared. Runners are adjusted by loosening the two nuts securing each runner. Move the runner to the desired position and retighten the nuts. Be sure to adjust both runners to the same height to keep blower housing level. Uneven runners make the machine difficult to steer and will result in an uneven clearing job.

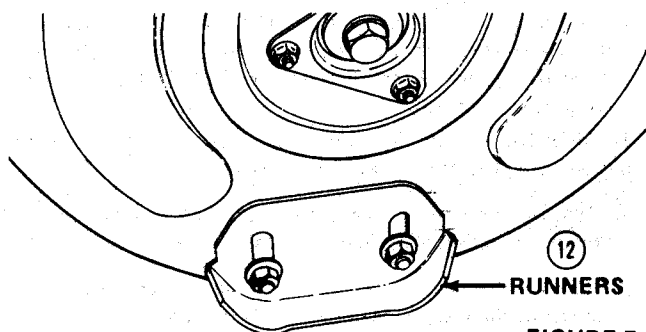

FIGURE 7

Adjustment of the runners is critical to good cleaning. If the machine is to be used on a gravel surface lower the runners so the blower will not pick up gravel then after the remaining snow is packed down, the runners may be raised for close scraping. On smooth concrete or blacktopped surfaces, the runners may be raised so the scraper blade rests on the surface and scrapes clean.

The scraper is adjustable so it may be lowered to compensate for wear. If the blade is allowed to wear down too far the blower housing may be damaged.

DRIVE DISC ADJUSTMENT

A drive disc adjustment is provided to compensate for wear on the friction wheel. If slippage occurs when the tractor clutch is engaged, tighten the drive disc adjustment. This adjustment is accessible without removing the bottom cover. See Figure 8.

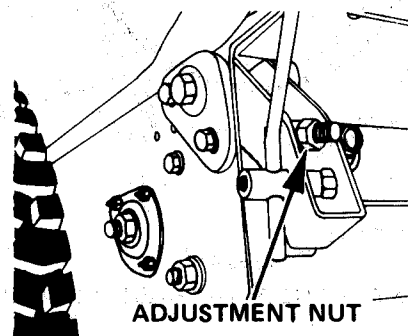

FIGURE 8

Adjust as follows: Place speed selector (1) between first and reverse. Tip machine forward on blower housing and brace securely. Tighten the adjustment nut while turning the wheels until the wheels begin to bind. Back off 3 turns. Wheels should then turn easily.

CHUTE CRANK ADJUSTMENT

In the event the chute crank fails to rotate freely, loosen the nut securing the worm clevis to the bracket. This hole in the bracket is slotted to permit adjustment. Position the worm so there is a little clearance between worm and the gear teeth on the blower. Tighten the nut. Rotate the discharge chute through its full travel to see that it turns easily. Re-adjust if required. Lubricate as described under LUBRICATION for smooth operation.

BELT REPLACEMENT



CAUTION

Since replacing the belts will involve turning the engine over with the starter, and the engine might accidentally start, resulting in injury, the spark plug wire **MUST** be disconnected during this procedure.

The drive belt and the attachment drive belt are both accessible by removing the blower housing as follows:

1. Remove the hair pin cotter in the chute crank assembly, Figure 5. Separate the chute crank.
2. Remove the two flanged whizlock screws securing the belt guard to the tractor. Remove the belt guard.

NOTE: Tipping the tractor back on the handlebars when separating the units may result in bending the bottom cover. To avoid this situation, either tip the unit up on the blower housing and remove the bottom cover before separating the units; or support the handlebars so the tractor does not tip all the way over; then lift off the blower housing.

3. Remove the cap screws on each side that secures the blower housing to the frame. As the blower housing and tractor are tipped apart, roll the belt off the engine sheave between the sheave and belt finger. This can be easily done by pulling the recoil starter rope to rotate the engine sheave. With the belt disconnected, the blower housing may then be lifted from the frame.

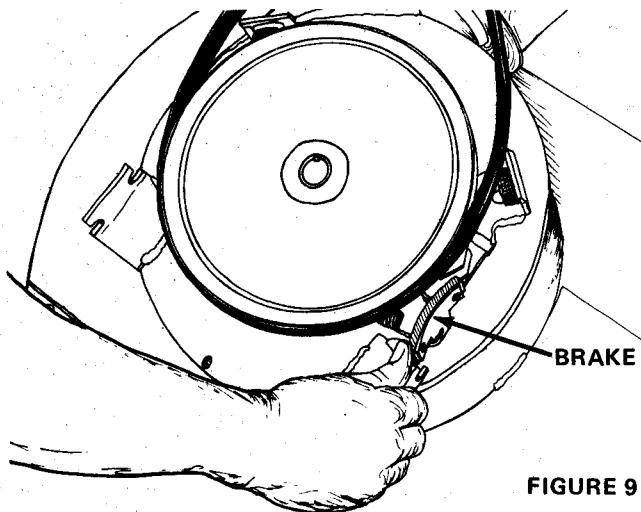

FIGURE 9

REPLACEMENT OF THE ATTACHMENT DRIVE BELT

The sno-thro attachment drive belt is on the sheave on the blower housing. To replace this belt, hold the impeller brake away from the belt and slip the belt from the sheave. See Figure 9.

Replace the belt by slipping it into position on the sheave; positioning the brake shoe on the belt.

REPLACEMENT OF TRACTOR DRIVE BELT

SEE FIGURE 10.

The drive belt is held in place on the sheaves by an idler pulley. To free the belts, the idler can be pulled from the belts and the belts removed from the sheaves. Activate clutch to gain clearance. It may be necessary to pull back blower idler arm clevis pin for additional clearance.

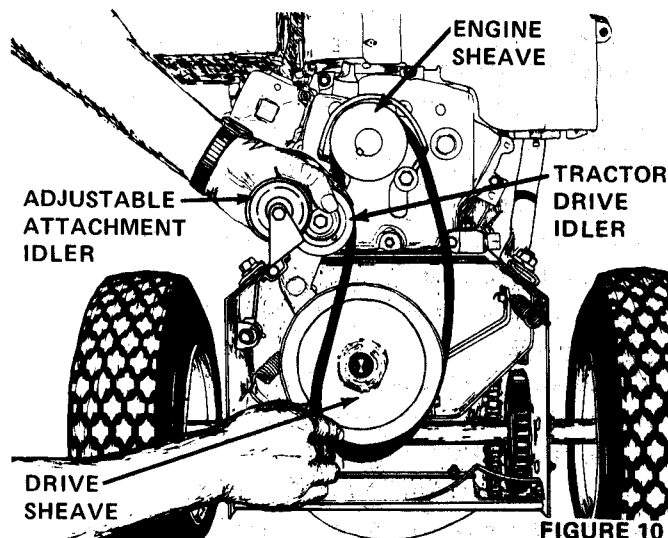

FIGURE 10

To replace the belts, position on the engine sheave first, then on the drive sheave. Position the idler carefully on the belt.

With the belt in position and the idler in place, check the belt alignment. The engine sheave and the tractor sheave must align with one another **WITH THE TRACTOR CLUTCH ENGAGED**. If the sheaves are not properly aligned, loosen the setscrews on the engine sheave and align the sheaves. Re-tighten the setscrews. Recheck the belt alignment **WITH THE CLUTCH ENGAGED**.

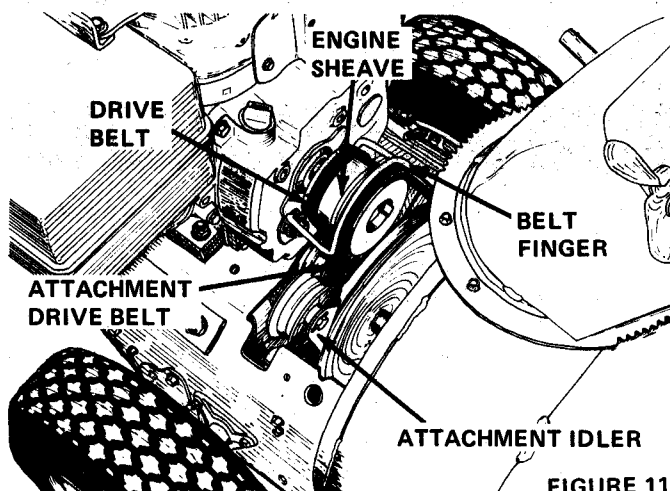

FIGURE 11

REPLACEMENT OF BLOWER HOUSING SEE FIGURE 11.

Position the blower housing on the rod in the tractor frame and secure as follows:

1. Tip the blower and tractor together. Hold the attachment drive belt up as the units are tipped together. Secure with two cap screws into the frame. As the cap screws are tightened, hold up on the handlebars to be sure the two units are secured together.

2. Roll the attachment belt on to the engine sheave. Pull the recoil starter rope to turn the engine sheave and roll the belt into place under the belt finger.
3. Check the belt finger spacing. There should be 1/8 inch clearance all around the belt finger and belt with the attachment clutch engaged. Readjust the belt finger if required.
4. Check the sheave alignment with the attachment belt in place. Readjust the position of the blower sheave as required to align the sheaves. Be sure the brake pad aligns with the blower sheave.
5. The idler on the attachment belt is adjustable. If the belt slips, adjust the idler in the slot in the idler arm to apply more tension to the belt. Belt should declutch when attachment clutch is disengaged.
6. Replace the belt guard and chute crank assemblies. Re-adjust the chute crank as described in the paragraph above. Replace the spark plug wire.

DRIVE CHAIN ADJUSTMENT MODELS 924040, 924042 and 924044.

If sno-thro is difficult to push because of tight or interfering drive chains, proceed as follows:

1. Stand unit up on end and remove bottom cover.
2. Chain tension is adjusted by loosening the two nuts on the 24364 Reduction Shaft. Adjust reduction sprocket up or down in slot to obtain proper tension (chain should be snug). Retighten both nuts. Torque to 170-180 inch lbs.
3. Chain interference with the 3085 Bearing Flange on 24045 Hex Shaft occurs if there is no 64058 Washer between the 10276 Sprocket and 54080 Bearing. Install washer.

LUBRICATION

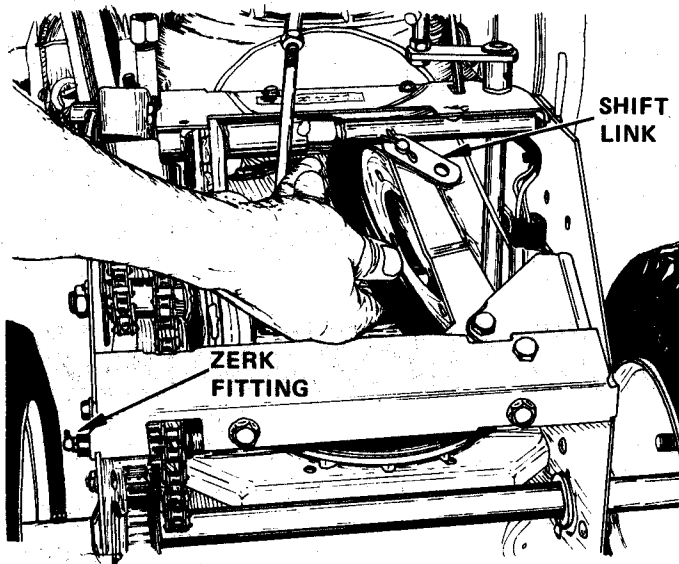

FIGURE 12

REPLACEMENT OF FRICTION WHEEL

1. Tip the machine up on the blower housing and brace securely. Remove two cap screws and loosen the other two, securing the bottom cover and remove the cover.
2. Place the speed selector in FIRST position. Depress the traction clutch lever to hold the friction wheel while the five bolts securing the friction wheel to the hub are loosened. Remove the five bolts, shift to THIRD position and disconnect the shift link. See Figure 12.
3. Position a new friction wheel on the hub and replace the five bolts. Tighten these bolts to 8-10 foot pounds with a torque wrench. Replace the shift links.
4. Replace the bottom cover. Readjust the drive disc as described in the DRIVE DISC ADJUSTMENT on page 5.

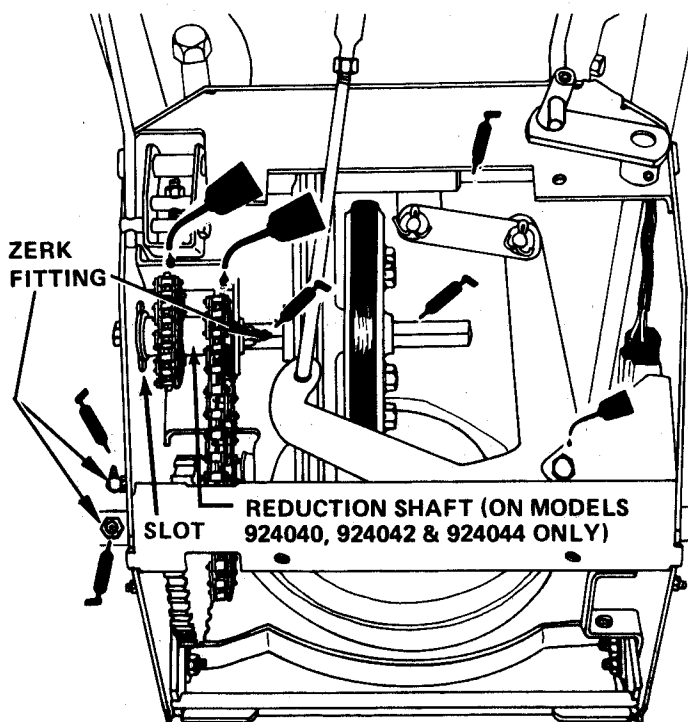

FIGURE 13

ENGINE

Fill crankcase (16) with Ariens Sno-Thro oil 5W-20 when using Sno-Thro at temperatures below 40 degrees F.

Use Ariens Gard-N-Yard oil MS classification SAE-30 when using lawn attachments at temperatures above 40 degrees F.

Fill fuel tank (17) with fresh, clean, regular gasoline.

NOTE:

For detailed instructions on engine refer to manufacturer's booklet packed with the machine.

TRACTOR DRIVE

At start of season, grease gears, pinion sprocket, hex and axle shaft as indicated in Figure 13. Use Ariens Moly Lithium grease.

Put two or three drops of light oil on speed selector and other linkage points. **CAUTION:** Do not allow grease or oil to come in contact with friction wheel, drive disc or belts.

SNO-THRO UNIT

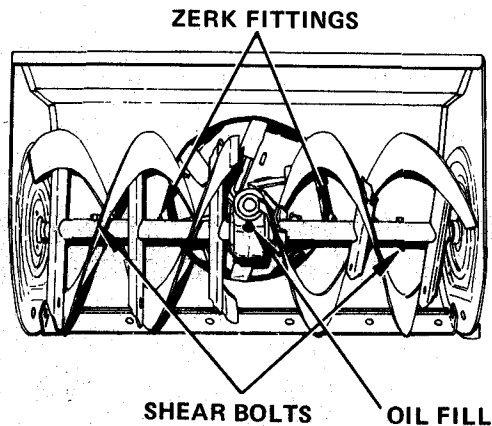
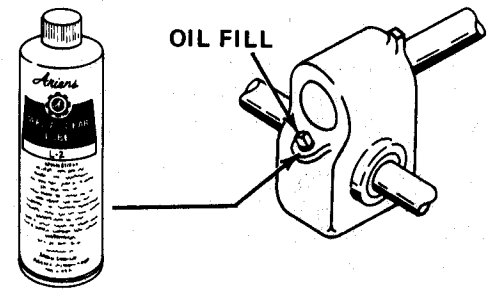

FIGURE 14

NOTE

When replacing a worn or broken shear bolt, use ARIENS shear bolts only.

Grease rake shaft periodically or each time a shear bolt is replaced. At the end of the season, remove shear bolts, use a grease gun on zerk fittings to grease rake shaft, turn rakes on shaft several times and replace shear bolts. See Figure 14. Use Ariens Moly Lithium grease.



MODEL 924042 and 924044 GEARCASE

FIGURE 15

MODEL 924042 & 924044 GEARCASE

Check oil level periodically. Oil level must be up to oil fill hole. Change oil every 25 hours or once each season which ever comes first. Fill with Ariens Special L-2 Gear Lubricant. Approximately 8 oz.

MODELS 924036, 924038, 924039 and 924040 GEARCASE

The blower gear case is lubricated with Ariens Liquid Grease (Part No. 000070). This grease will not flow at lower temperatures. It is therefore difficult to check the lubricant level. Best method for checking is to place the unit in a warm location overnight. This allows the grease to flow to level. Check the lubrication by removing the filler plug on the side of the gear case just above the left auger shaft. Lubrication should be even with the hole with the machine sitting level. It may be necessary to insert a wire into the hole to check level. The unit will not be damaged by over lubricating.

STORAGE

ENGINE: Follow detail instructions in the engine manual.
SNO-THRO: Lubricate, clean and repaint as necessary.
Cover and store in dry place.

24" SNO-THRO PARTS LIST FOR MODELS 924036, 924038, 924039 & 924040
SOUFFLEURS SNO-THRO DE 24" MODELES 924036, 924038, 924039 & 924040

NOTE: USE ARIENS NO. 70 LIQUID GREASE
 LUBE (APPROX. 2 OZ.) IN ROTOR GEAR CASE.

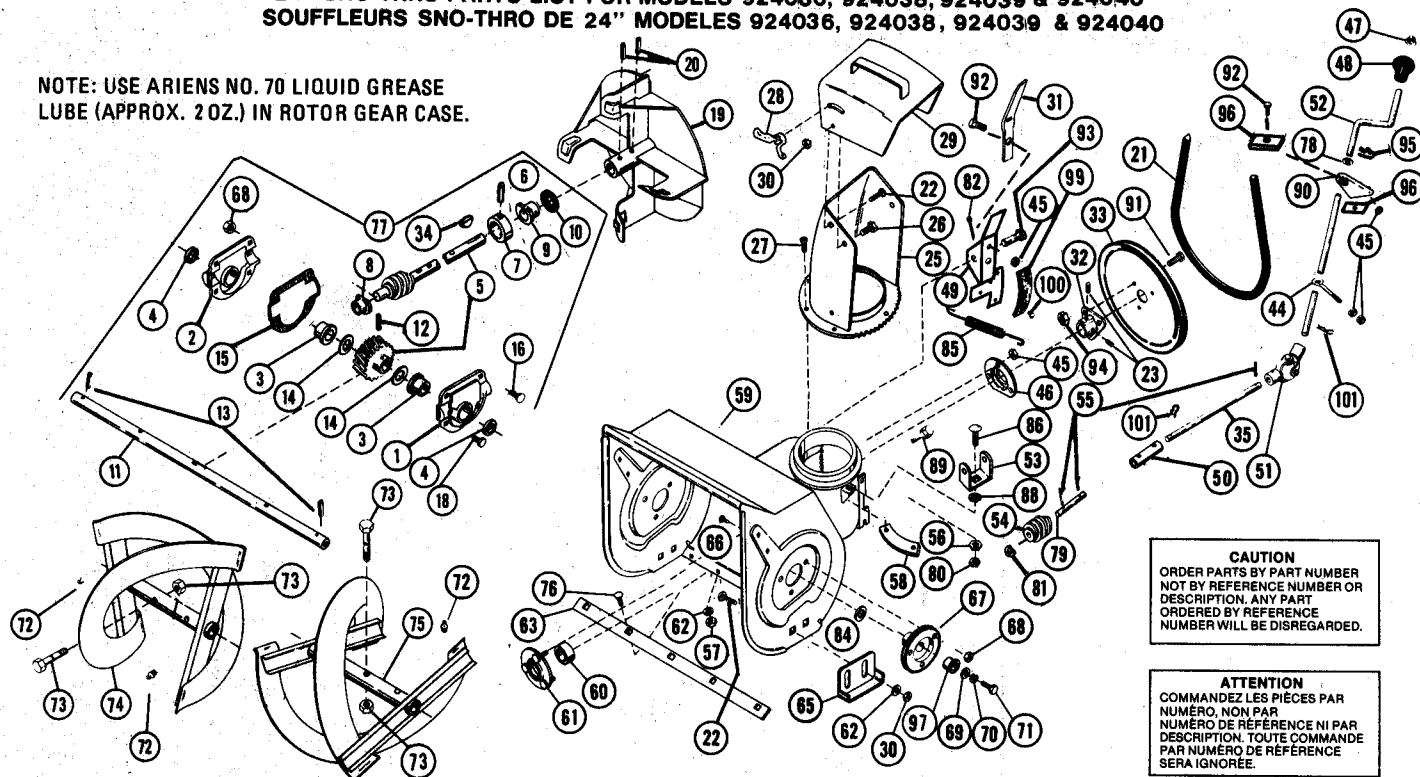

CAUTION
 ORDER PARTS BY PART NUMBER
 NOT BY REFERENCE NUMBER OR
 DESCRIPTION. ANY PART
 ORDERED BY REFERENCE
 NUMBER WILL BE DISREGARDED.

ATTENTION
 COMMANDEZ LES PIÉCES PAR
 NUMÉRO, NON PAR
 NUMÉRO DE RÉFÉRENCE NI PAR
 DESCRIPTION. TOUTE COMMANDE
 PAR NUMÉRO DE RÉFÉRENCE
 SERA IGNORÉE.

| NoDE REF. | No DE PIECE D'INV PART STOCK NO. NO. CODE | DESCRIPTION | QUANTITÉ NO. REQ'D | | | |
|--------------|--|---------------------------------|-----------------------|--------|--------|--------|
| | | | 924036 | 924038 | 924039 | 924040 |
| 1 | 024379 | GEAR CASE, L.H. Half | 1 | 1 | 1 | 1 |
| 2 | 024380 | GEAR CASE, R.H. Half | 1 | 1 | 1 | 1 |
| 3 | 055122 | FLANGE BUSHING | 2 | 2 | 2 | 2 |
| 4 | 056061 | SEAL | 2 | 2 | 2 | 2 |
| 5 | 524026 | WORM SHAFT & GEAR | 1 | 1 | 1 | 1 |
| 6 | 058045 | SHEAR PROOF PIN | 1 | 1 | 1 | 1 |
| 7 | 032103 | THRUST COLLAR | 1 | 1 | 1 | 1 |
| 8 | 055111 | FLANGED BUSHING | 1 | 1 | 1 | 1 |
| 9 | 055112 | FLANGED BUSHING | 1 | 1 | 1 | 1 |
| 10 | 056047 | "O" RING | 1 | 1 | 1 | 1 |
| 11 | 024383 | RAKE SHAFT | 1 | 1 | 1 | 1 |
| 12 | 058041 | DRIVE PIN | 1 | 1 | 1 | 1 |
| 13 | 058030 | ROLL PIN, 3/16 x 1-1/2 | 2 | 2 | 2 | 2 |
| 14 | 064166 | WASHER, 1.007 x 1.542 x .062 | 2 | 2 | 2 | 2 |
| 15 | 032038 | GASKET | 1 | 1 | 1 | 1 |
| 16 | 062054 | CARRIAGE BOLT | 4 | 4 | 4 | 4 |
| 17 | 064046 | WASHER, 1.505 O.D. x 1.005 I.D. | 2 | 2 | 2 | 2 |
| 18 | 070010 | FLANGE WHIZLOCK SCREW | 1 | 1 | 1 | 1 |
| 19 | 024237 | FAN | 1 | 1 | 1 | 1 |
| 20 | 058037 | ROLL PIN, 1/4 x 1-3/4 | 2 | 2 | 2 | 2 |
| 21 | 072108 | VEE BELT | 1 | 1 | 1 | 1 |
| 22 | 072086 | VEE BELT | 1 | 1 | 1 | 1 |
| 23 | 062010 | CARRIAGE BOLT, 3/8-16 x 3/4 | 5 | 5 | 5 | 5 |
| 24 | 060011 | SETSCREW | 2 | 2 | 2 | 2 |
| 25 | 024349 | DISCHARGE CHUTE | 1 | 1 | 1 | 1 |
| 26 | 059023 | CAP SCREW, 3/8-16 x 3/4 | 2 | 2 | 2 | 2 |
| 27 | 074054 | TAPTITE | 6 | 6 | 6 | 6 |
| 28 | 010193 | WING NUT | 1 | 1 | 1 | 1 |
| 29 | 510012 | DEFLECTOR CHUTE | 1 | 1 | 1 | 1 |
| 30 | 065039 | LOCKNUT | 6 | 6 | 6 | 6 |
| 31 | 024405 | BRAKE ARM EXT. | 1 | 1 | 1 | 1 |
| 32 | 024389 | PULLEY HUB | 1 | 1 | 1 | 1 |
| 33 | 073070 | SHEAVE | 1 | 1 | 1 | 1 |
| 34 | 066001 | KEY, Woodruff 3/16 x 7/8 | 1 | 1 | 1 | 1 |
| 35 | 024346 | ROD | 1 | 1 | 1 | 1 |
| 44 | 024401 | EYE BOLT | 1 | 1 | 1 | 1 |
| 45 | 065040 | LOCKNUT | 6 | 6 | 6 | 7 |
| 46 | 010142 | BEARING FLANGE | 1 | 1 | 1 | 1 |
| 47 | 010198 | CAP | 1 | 1 | 1 | 1 |
| 48 | 075083 | GRIP | 1 | 1 | 1 | 1 |
| 49 | 624035 | BRAKE ARM ASSEMBLY | 1 | 1 | 1 | 1 |
| 50 | 024271 | SLEEVE CONNECTOR | 1 | 1 | 1 | 1 |
| 51 | 624065 | UNIVERSAL JOINT ASSEMBLY | 1 | 1 | 1 | 1 |
| 52 | 024340 | CHUTE CRANK | 1 | 1 | 1 | 1 |
| 53 | 022123 | WORM CLEVIS | 1 | 1 | 1 | 1 |
| 54 | 022110 | WORM GEAR | 1 | 1 | 1 | 1 |
| 55 | 058034 | ROLL PIN, 1/8 x 3/4 | 3 | 3 | 3 | 3 |
| 56 | 063023 | LOCKWASHER | 1 | 1 | 1 | 1 |
| 57 | 065042 | LOCKNUT | 5 | 5 | 5 | 5 |
| 58 | 010438 | CHUTE CLAMP | 3 | 3 | 3 | 3 |
| 59 | 524027 | BLOWER HOUSING | 1 | 1 | 1 | 1 |
| 59 | 524028 | BLOWER HOUSING | 1 | 1 | 1 | 1 |
| 60 | 054063 | RADIAL BEARING | 1 | 1 | 1 | 1 |
| 61 | 003017 | BEARING FLANGE | 1 | 1 | 1 | 1 |
| 62 | 064002 | WASHER, 5/16 x 7/8 x .083 | 9 | 9 | 9 | 9 |
| 63 | 010164 | SCRAPER BLADE | 1 | 1 | 1 | 1 |
| 65 | 010165 | RUNNER | 2 | 2 | 2 | 2 |
| 66 | 070058 | RIBBED NECK BOLT | 6 | 6 | 6 | 6 |
| 67 | 024374 | BEARING SUPPORT | 2 | 2 | 2 | 2 |
| 68 | 065056 | FLANGE WHIZLOCK NUT | 10 | 10 | 10 | 10 |
| 69 | 064047 | WASHER, .506/.516 x 1.441 x 1/8 | 2 | 2 | 2 | 2 |
| 70 | 063006 | LOCKWASHER | 2 | 2 | 2 | 2 |
| 71 | 059024 | CAP SCREW, 1/2 - 13 x 1 | 2 | 2 | 2 | 2 |
| 72 | 022093 | SPIN DRIVE ZERK FITTING | 4 | 4 | 4 | 4 |
| 73 | 510015 | SHEAR BOLT W/NUT | 2 | 2 | 2 | 2 |
| 74 | 024384 | RIGHT RAKE | 1 | 1 | 1 | 1 |
| 75 | 024385 | LEFT RAKE | 1 | 1 | 1 | 1 |
| 76 | 062026 | CARRIAGE BOLT | 5 | 5 | 5 | 5 |
| 77 | 524030 | GEAR CASE ASSEMBLY | 1 | 1 | 1 | 1 |
| 78 | 064043 | WASHER | 1 | 1 | 1 | 1 |
| 79 | 010494 | WORM SHAFT | 1 | 1 | 1 | 1 |
| 80 | 065015 | NUT | 1 | 1 | 1 | 1 |
| 81 | 010260 | WAVE WASHER | 1 | 1 | 1 | 1 |
| 82 | 067019 | HAIR PIN | 1 | 1 | 1 | 1 |
| 84 | 064046 | WASHER, 1.505 O.D. x 1.005 I.D. | 2 | 2 | 2 | 2 |
| 85 | 083164 | SPRING | 1 | 1 | 1 | 1 |
| 86 | 062011 | CARRIAGE BOLT, 5/16-18 x 3/4 | 1 | 1 | 1 | 1 |
| 88 | 063032 | LOCKWASHER | 1 | 1 | 1 | 1 |
| 89 | 070031 | FLANGE WHIZLOCK SCREW | 2 | 2 | 2 | 2 |
| 90 | 024341 | ROD HANGER | 1 | 1 | 1 | 1 |
| 91 | 070053 | RIBBED NECK BOLT | 3 | 3 | 3 | 3 |
| 92 | 059028 | CAP SCREW, 1/4-20 x 1/2 | 1 | 1 | 1 | 2 |
| 93 | 024345 | CLEVIS PIN | 1 | 1 | 1 | 1 |
| 94 | 065078 | FLANGED WHIZLOCK NUT | 3 | 3 | 3 | 3 |
| 95 | 067020 | HAIR PIN | 1 | 1 | 1 | 1 |
| 96 | 024408 | WASHER | 2 | 2 | 2 | 2 |
| 97 | 055035 | BUSHING | 2 | 2 | 2 | 2 |
| 99 | 022178 | LINING | 1 | 1 | 1 | 1 |
| 100 | 068062 | RIVET | 2 | 2 | 2 | 2 |
| 101 | 067010 | HAIR PIN | 1 | 1 | 1 | 1 |

SUGGESTED PARTS STOCKING CODE
 F - FAST S - SLOW
 M - MEDIUM O - CUSTOMER ORDER ONLY

CODE SUGGÉRÉ D'INVENTAIRE DES PIÉCES
 F - FAST (rapide) S - SLOW (lent)
 M - MEDIUM (moyen) O - Commande du client seulement

**TRACTOR PARTS FOR MODELS }
PIÈCES DU TRACTEUR DES MODÈLES }**

**924027, 924036, 924038, 924039,
924040, 924042 & 924044**

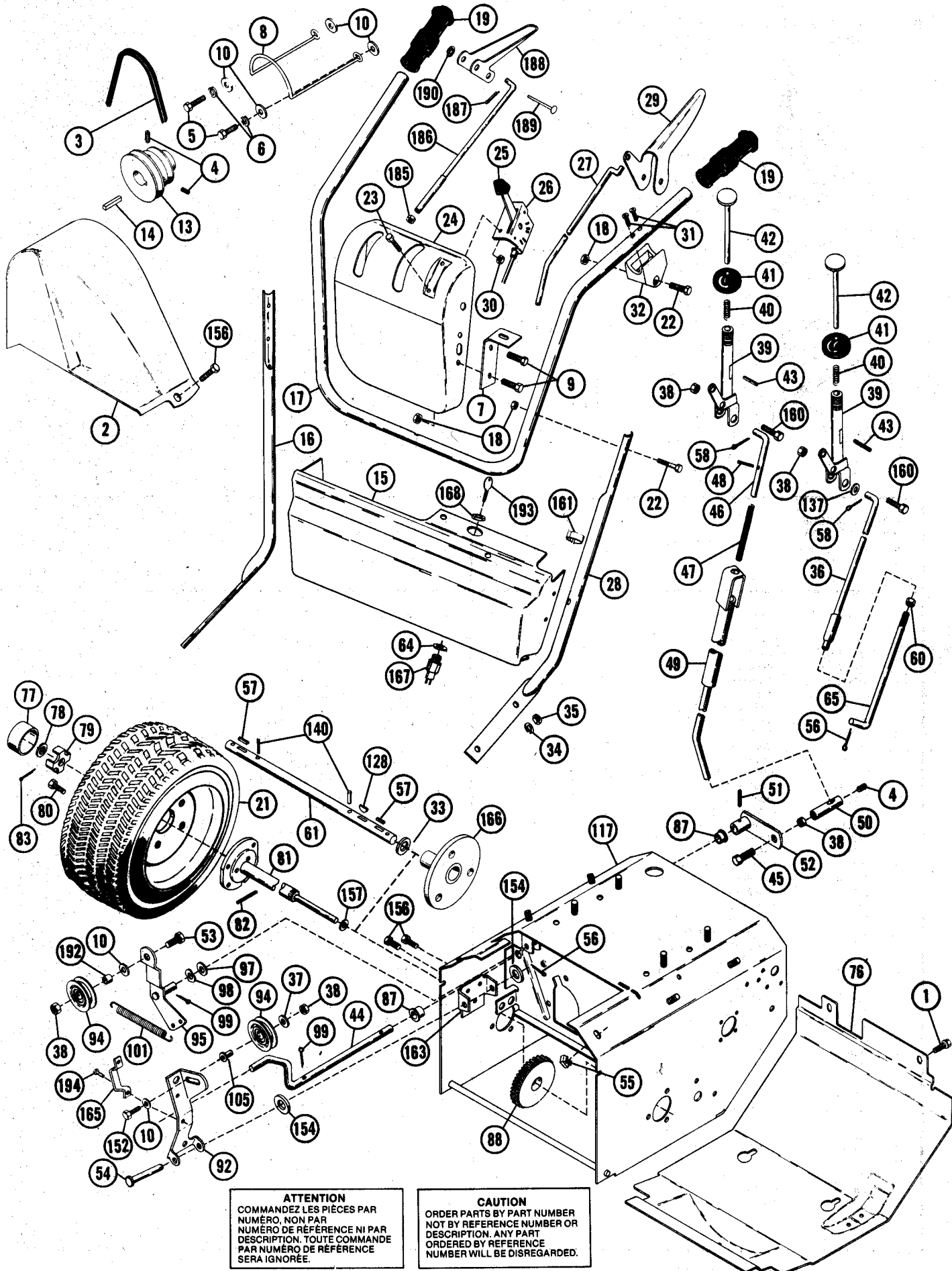

ATTENTION
COMMANDEZ LES PIÈCES PAR
NUMÉRO, NON PAR
NUMÉRO DE RÉFÉRENCE NI PAR
DESCRIPTION. TOUTE COMMANDE
PAR NUMÉRO DE RÉFÉRENCE
SERA IGNORÉE.

CAUTION
ORDER PARTS BY PART NUMBER
NOT BY REFERENCE NUMBER OR
DESCRIPTION. ANY PART
ORDERED BY REFERENCE
NUMBER WILL BE DISREGARDED.

TRACTOR PARTS FOR MODELS 924027, 924036, 924038, 924039, 924040, 924042 & 924044

PIECES DU TRACTEUR DES MODELES 924027, 924036, 924038, 924039, 924040, 924042 & 924044

| No DE NO DE CODE REF. PIÉCE D'INV | | | | | | | QUANTITE NO. REQ'D | | | | | | | No DE NO DE CODE REF. PIÉCE D'INV. | | | | | | | QUANTITÉ NO. REQ'D | | | | | | |
|--------------------------------------|--------|--------|--------|--------|--------|--------|-----------------------------------|---|---|---|---|---|--|---------------------------------------|--------|--------|--------|--------|--------|--------|----------------------------------|---|---|---|---|---|--|
| REF. PART STOCK NO. NO. CODE | | | | | | | DESCRIPTION | | | | | | | REF. PART STOCK NO. NO. CODE | | | | | | | DESCRIPTION | | | | | | |
| 924036 | 924038 | 924039 | 924027 | 924040 | 924042 | 924044 | | | | | | | | 924036 | 924038 | 924039 | 924027 | 924040 | 924042 | 924044 | | | | | | | |
| 1 | 070009 | | | | | | FLANGE WHIZLOCK SCREW | 4 | 4 | 4 | 4 | 4 | | 50 | 022135 | | | | | | ROD ADAPTER | 1 | 1 | 1 | 1 | 1 | |
| 2 | 024406 | | | | | | BELT COVER | 1 | 1 | 1 | 1 | 1 | | 51 | 058033 | | | | | | ROLL PIN | 1 | 1 | 1 | 1 | 1 | |
| 3 | 072098 | | | | | | V BELT | 1 | 1 | | | | | 52 | 024157 | | | | | | LEVER | 1 | 1 | 1 | 1 | 1 | |
| 3 | 072066 | | | | | | V BELT | | | 1 | 1 | 1 | | 53 | 059003 | | | | | | CAP SCREW, 5/16-18 x 1 | 1 | 1 | 1 | 1 | 1 | |
| 4 | 060012 | | | | | | SETSCREW | 3 | 3 | 3 | 3 | 3 | | 54 | 024354 | | | | | | CLEVIS PIN | 1 | 1 | 1 | 1 | 1 | |
| 5 | 059053 | | | | | | CAP SCREW, 5/16-24 x 3/4 | 2 | 2 | 2 | 2 | 2 | | 55 | 070026 | | | | | | NUT RETAINER | 2 | 2 | 2 | 2 | 2 | |
| 6 | 063003 | | | | | | LOCKWASHER | 2 | 2 | 2 | 2 | 2 | | 56 | 067001 | | | | | | COTTER PIN | 2 | 2 | 2 | 2 | 2 | |
| 7 | 024025 | | | | | | BRACE | 1 | 1 | 1 | 1 | 1 | | 57 | 066011 | | | | | | KEY, Feather 3/16 x 3/16 x 1-1/4 | 2 | | 2 | | | |
| 8 | 024253 | | | | | | BELT FINGER | 1 | 1 | 1 | 1 | 1 | | 58 | 067024 | | | | | | COTTER PIN, 1/8 x 3/4 | 2 | 2 | 2 | 2 | 2 | |
| 9 | 059080 | | | | | | CAP SCREW, 1/4-20 x 5/8 | 3 | 3 | 3 | 3 | 3 | | 60 | 065031 | | | | | | NUT | 1 | 1 | 1 | 1 | 1 | |
| 10 | 064002 | | | | | | WASHER, 5/16 x 7/8 x .083 | 6 | 6 | 6 | 6 | 6 | | 61 | 024397 | | | | | | AXLE SHAFT | | | 1 | | | |
| 13 | 024021 | | | | | | ENGINE SHEAVE | 1 | 1 | | | | | 61 | 024322 | | | | | | AXLE SHAFT | 1 | | | | | |
| 13 | 024357 | | | | | | ENGINE SHEAVE | | | 1 | 1 | 1 | | 64 | 063019 | | | | | | LOCKWASHER | 1 | 1 | 1 | 1 | 1 | |
| 14 | 066018 | | | | | | KEY, Straight 1/4 x 1/4 x 1-3/4 | 1 | 1 | 1 | 1 | 1 | | 65 | 024247 | | | | | | LOWER ROD CLUTCH | 1 | 1 | 1 | 1 | 1 | |
| 15 | 024402 | | | | | | HANDLEBAR PANEL | 1 | 1 | 1 | 1 | 1 | | 76 | 024404 | | | | | | BOTTOM COVER | 1 | 1 | 1 | 1 | 1 | |
| 16 | 024267 | | | | | | R. H. LOWER HANDLEBAR | 1 | 1 | 1 | 1 | 1 | | 77 | 003377 | | | | | | HUB CAP | 2 | 1 | 2 | 1 | 1 | |
| 17 | 524019 | | | | | | UPPER HANDLEBAR | 1 | 1 | | | | | 78 | 010366 | | | | | | PUSHNUT | | 1 | | 1 | 1 | |
| 17 | 524025 | | | | | | UPPER HANDLEBAR | | | 1 | 1 | 1 | | 79 | 003376 | | | | | | SPINDLE CUP | 2 | 1 | 2 | 1 | 1 | |
| 18 | 065040 | | | | | | LOCKNUT | 9 | 9 | 9 | 9 | 9 | | 80 | 070032 | | | | | | WHEEL BOLT | 6 | 6 | 8 | 8 | 8 | |
| 19 | 075006 | | | | | | GRIP | 2 | 2 | 2 | 2 | 2 | | 81 | 010370 | | | | | | R.H. AXLE | 1 | | | | | |
| | | | | | | | | | | | | | | 81 | 024371 | | | | | | R.H. AXLE | | | 1 | 1 | | |
| 21 | 610960 | | | | | | TIRE & WHEEL ASSEMBLY | 2 | 2 | | | | | 82 | 058003 | | | | | | ROLL PIN, 3/16 x 1-1/4 | | 1 | | | | |
| | | | | | | | Consists of | | | | | | | 82 | 058030 | | | | | | ROLL PIN, 3/16 x 1-1/2 | | | 1 | 1 | | |
| | | | | | | | 71046 Tire | 2 | 2 | | | | | 83 | 067014 | | | | | | COTTER PIN | 2 | | 2 | | | |
| | | | | | | | 71050 Tube | 2 | 2 | | | | | 87 | 055037 | | | | | | FLANGED BUSHING | 2 | 2 | 2 | 2 | 2 | |
| | | | | | | | 71052 Rim | 2 | 2 | | | | | 88 | 612999 | | | | | | DIFFERENTIAL ASSEMBLY | | 1 | | | | |
| 21 | 603002 | | | | | | WHEEL ASSEMBLY | | | 2 | 2 | | | 88 | 624073 | | | | | | DIFFERENTIAL ASSEMBLY | | | 1 | 1 | | |
| | | | | | | | 071082 Tire | | | 2 | 2 | | | 88 | 010211 | | | | | | SPUR GEAR | 1 | | | | | |
| | | | | | | | 071076 Rim | | | 2 | 2 | | | 88 | 024396 | | | | | | SPUR GEAR | | | 1 | | | |
| | | | | | | | 71037 Tube Available | | | 2 | 2 | | | 92 | 024348 | | | | | | IDLER ARM | 1 | 1 | 1 | 1 | 1 | |
| 21 | 603948 | | | | | | TERRA TIRE & WHEEL ASSEMBLY | | | | | 2 | | 94 | 012132 | | | | | | IDLER | 2 | 2 | 2 | 2 | 2 | |
| | | | | | | | 071021 Turf Saver Tire | | | | | 2 | | 95 | 024222 | | | | | | IDLER ARM | 1 | 1 | 1 | 1 | 1 | |
| | | | | | | | 071077 Rim | | | | | 2 | | 97 | 064052 | | | | | | WASHER, 380/385 x 13/16 x 24 | 1 | 1 | 1 | 1 | 1 | |
| | | | | | | | 71087 Tube Available | | | | | 2 | | 98 | 010260 | | | | | | WAVE WASHER | 1 | 1 | 1 | 1 | 1 | |
| 22 | 059050 | | | | | | CAP SCREW, 1/4-20 x 1-1/2 | 6 | 6 | 6 | 6 | 6 | | 99 | 067004 | | | | | | COTTER PIN | 2 | 2 | 2 | 2 | 2 | |
| 23 | 061012 | | | | | | MACHINE SCREW | 2 | 2 | 2 | 2 | 2 | | 101 | 083094 | | | | | | SPRING | 1 | 1 | 1 | 1 | 1 | |
| 24 | 524020 | | | | | | PANEL DASH | 1 | 1 | 1 | 1 | 1 | | 105 | 012131 | | | | | | BEARING SPACER | 1 | 1 | 1 | 1 | 1 | |
| 25 | 075019 | | | | | | KNOB | 1 | 1 | 1 | 1 | 1 | | 117 | 024274 | | | | | | FRAME | 1 | | | | | |
| 26 | 069105 | | | | | | THROTTLE CONTROL | 1 | | | | | | 117 | 024362 | | | | | | FRAME | | 1 | 1 | 1 | 1 | |
| 26 | 069080 | | | | | | THROTTLE CONTROL | | 1 | 1 | 1 | 1 | | 128 | 066012 | | | | | | KEY, Woodruff, 1/4 x 3/4 | 1 | | | | | |
| 27 | 024244 | | | | | | CLUTCH ROD | 1 | 1 | | | | | 128 | 066008 | | | | | | KEY, Woodruff, SAE A 1/4 x 7/8 | | | 1 | | | |
| 27 | 024265 | | | | | | CLUTCH ROD | | | 1 | 1 | 1 | | 137 | 064093 | | | | | | WASHER, .380/.385 x 3/16 x .062 | 1 | 1 | 1 | 1 | 1 | |
| 28 | 024342 | | | | | | L. H. LOWER HANDLEBAR | 1 | 1 | 1 | 1 | 1 | | 140 | 058016 | | | | | | ROLL PIN, 3/16 x 1 | 2 | | | | | |
| 29 | 522018 | | | | | | CLUTCH HANDLE | 1 | 1 | 1 | 1 | 1 | | 140 | 058003 | | | | | | ROLL PIN, 3/16 x 1-1/4 | | | 1 | | | |
| 30 | 065051 | | | | | | KEPS NUT | 2 | 2 | 2 | 2 | 2 | | 152 | 059069 | | | | | | CAP SCREW, 5/16 - 18 x 1-1/4 | 1 | 1 | 1 | 1 | 1 | |
| 31 | 074039 | | | | | | TAPPING SCREW | 2 | 2 | 2 | 2 | 2 | | 154 | 064078 | | | | | | WASHER, .381/.389 x 626 x 21 | 2 | 2 | 2 | 2 | 2 | |
| 32 | 022129 | | | | | | HANDLE PIVOT | 1 | 1 | 1 | 1 | 1 | | 156 | 070015 | | | | | | FLANGE WHIZLOCK SCREW | 5 | 5 | 5 | 5 | 5 | |
| 33 | 064033 | | | | | | WASHER, .7501, 760 x 1.375 x .125 | 1 | | | | | | 157 | 064036 | | | | | | WASHER, .875/.885 x 1.385 x .062 | | 1 | 1 | | | |
| 33 | 064036 | | | | | | WASHER, .815/.885 x 1.380 x .062 | | 1 | | | | | 157 | 064170 | | | | | | WASHER, .875/.885 x 1.385 x .062 | | | | 2 | 2 | |
| 34 | 063004 | | | | | | LOCKWASHER | 4 | 4 | 4 | 4 | 4 | | 160 | 059057 | | | | | | CAP SCREW, 5/16-18 x 2 | 2 | 2 | 2 | 2 | 2 | |
| 35 | 065018 | | | | | | NUT | 4 | 4 | 4 | 4 | 4 | | 161 | 069012 | | | | | | CLAMP | 1 | 1 | 1 | 1 | 1 | |
| 36 | 024245 | | | | | | SHIFT ROD UPPER | 1 | 1 | 1 | 1 | 1 | | 163 | 024347 | | | | | | BRACKET | 1 | 1 | 1 | 1 | 1 | |
| 37 | 064007 | | | | | | WASHER, 1/4 x 47/64 x .065 | 1 | 1 | 1 | 1 | 1 | | 165 | 024353 | | | | | | RETURN CLIP | 1 | 1 | 1 | 1 | 1 | |
| 38 | 065042 | | | | | | LOCKNUT | 5 | 5 | 5 | 5 | 5 | | 166 | 024323 | | | | | | WHEEL HUB | 2 | | | | | |
| 39 | 024240 | | | | | | CONTROL HANDLE | 2 | 2 | 2 | 2 | 2 | | 166 | 024398 | | | | | | WHEEL HUB | | | 2 | | | |
| 40 | 083015 | | | | | | SPRING | 2 | 2 | 2 | 2 | 2 | | 167 | 011134 | | | | | | KEY SWITCH | 1 | 1 | 1 | 1 | 1 | |
| 41 | 010248 | | | | | | SHIFT BALL | 2 | 2 | 2 | 2 | 2 | | 168 | 065075 | | | | | | NUT | 1 | 1 | 1 | 1 | 1 | |
| 42 | 024241 | | | | | | SHIFT RELEASE HANDLE | 2 | 2 | 2 | 2 | 2 | | 185 | 065032 | | | | | | NUT | 1 | 1 | 1 | 1 | 1 | |
| 43 | 058056 | | | | | | ROLL PIN, 3/16 x 1-3/4 | 2 | 2 | 2 | 2 | 2 | | 186 | 024221 | | | | | | UPPER ROD INTERLOCK | 1 | 1 | 1 | 1 | 1 | |
| 44 | 024083 | | | | | | ACTIVATING SHAFT | 1 | 1 | 1 | 1 | 1 | | 187 | 067003 | | | | | | COTTER PIN, 1/16 x 1/2 | 1 | 1 | 1 | 1 | 1 | |
| 45 | 059022 | | | | | | CAP SCREW, 5/16 - 18 x 3/4 | 1 | 1 | 1 | 1 | 1 | | 188 | 022147 | | | | | | HANDLE INTERLOCK | 1 | 1 | 1 | 1 | 1 | |
| 46 | 024096 | | | | | | CLUTCH ROD | 1 | 1 | 1 | 1 | 1 | | 189 | 022148 | | | | | | PIN PIVOT | 1 | 1 | 1 | 1 | 1 | |
| 47 | 083095 | | | | | | COMPRESSOR SPRING | 1 | 1 | 1 | 1 | 1 | | 190 | 022153 | | | | | | PUSH NUT | 1 | 1 | 1 | 1 | 1 | |
| 48 | 058034 | | | | | | ROLL PIN, 1/8 x 3/4 | 1 | 1 | 1 | 1 | 1 | | 192 | 011031 | | | | | | SPACER | 1 | 1 | 1 | 1 | 1 | |
| 49 | 024243 | | | | | | ATTACHMENT CLUTCH ROD | 1 | 1 | 1 | 1 | 1 | | 193 | 013157 | | | | | | KEY SET | 1 | 1 | 1 | 1 | 1 | |
| | | | | | | | NOTE: FOR DECALS SEE PAGES 2 & 3 | | | | | | | 194 | 074054 | | | | | | TAPTITE | 2 | 2 | 2 | 2 | 2 | |
| | | | | | | | NOTE: DECALQUES (voir p. 2 & 3) | | | | | | | | | | | | | | | | | | | | |

SUGGESTED PARTS STOCKING CODE

F - FAST S - SLOW
M - MEDIUM O - CUSTOMER ORDER ONLY

TRACTOR PARTS FOR MODELS PIÈCES DU TRACTEUR DES MODÈLES

924027, 924036, 924038, 924039,
924040, 924042 & 924044

INTERLOCK SWITCH
COMMUTATEUR
D'ENGRENAGE

RED ROUGE

TO KEY SWITCH
VERS
COMMUTATEUR
DE CLE

BLACK
NOIR

RED TO
GROUND ON
ENGINE
MOUNTING BOLT
ROUGE
POUR RELIER
A L'ECROU
DE MONTAGE SUR
MOTEUR

WHITE
TO ENGINE
MAGNETO
BLANC
VERS MAGNETO
DU MOTEUR

(ON HEATER
BOX)

WIRING DIAGRAM

DIAGRAMME DU FILAGE ÉLECTRIQUE

MODULE

RED

OPEN

YELLOW

MODULE T
WITH CONNECTOR
MODULE T
AVEC JONCTION

WHITE

OPEN
WIRE HARNESS

WHITE
BLANC

ENGINE SPECIFICATIONS

5 HP. TECUMSEH H50-854221C
7 HP. TECUMSEH H70-130210D
8 HP. TECUMSEH HM80-155128E
10 HP. TECUMSEH HM100-159024C

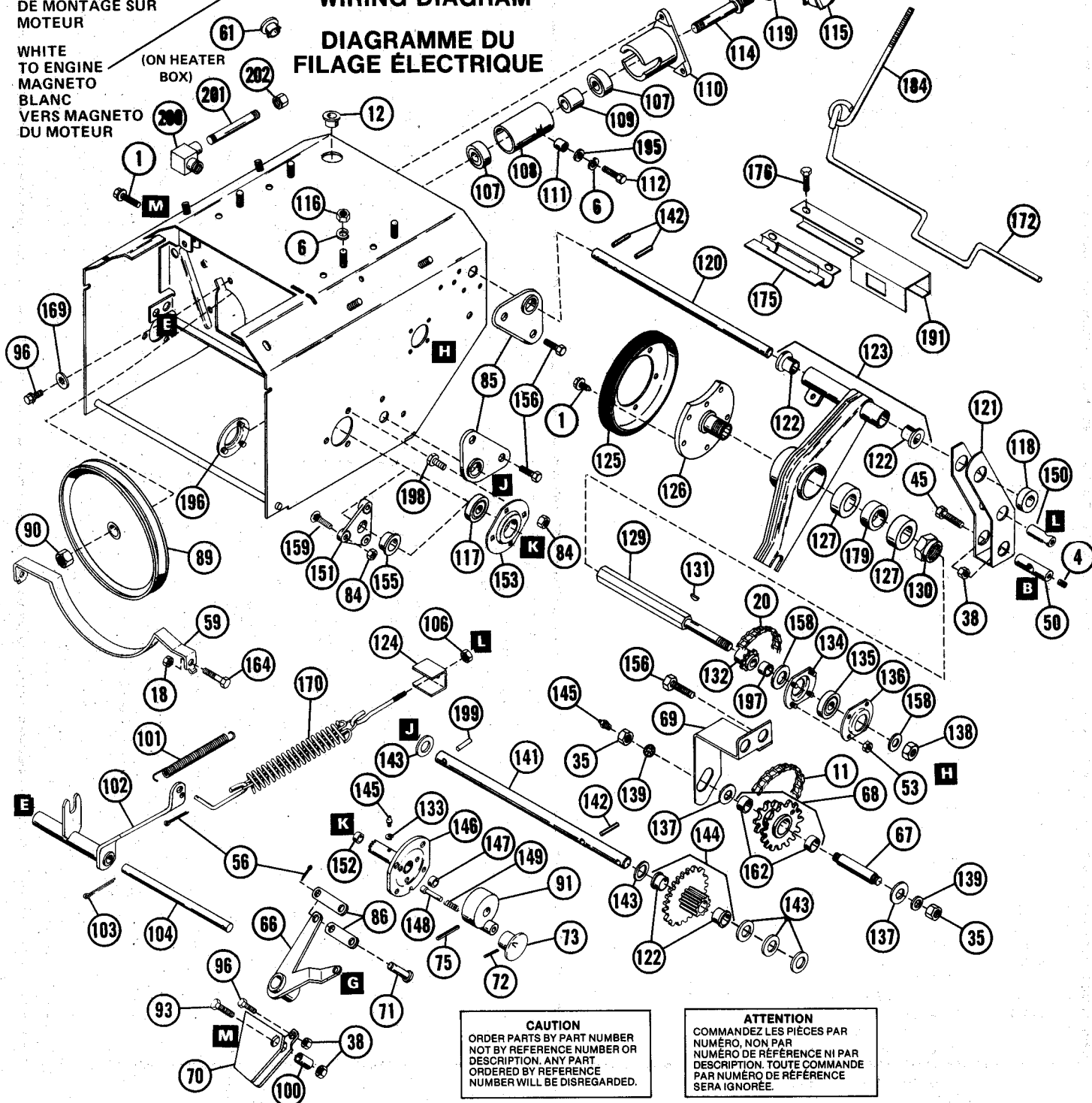

CAUTION
ORDER PARTS BY PART NUMBER
NOT BY REFERENCE NUMBER OR
DESCRIPTION. ANY PART
ORDERED BY REFERENCE
NUMBER WILL BE DISREGARDED.

ATTENTION
COMMANDEZ LES PIÈCES PAR
NUMÉRO, NON PAR
NUMÉRO DE RÉFÉRENCE NI PAR
DESCRIPTION. TOUTE COMMANDE
PAR NUMÉRO DE RÉFÉRENCE
SERA IGNORÉE.

TRACTOR PARTS FOR MODELS 924027, 924036, 924038, 924039, 924040, 924042 & 924044

PIECES DU TRACTEUR DES MODELES 924027, 924036, 924038, 924039, 924040, 924042 & 924044

| NoDE NO DE CODE REF. PIECE D'INV | | | | QUANTITÉ NO. REQ'D | | | | | | NoDE No DE CODE REF. PIECE D'INV. | | | | QUANTITÉ NO. REQ'D | | | | | | | |
|-------------------------------------|--------|-------|--------------------------|--------------------|--------|--------|--------|--------|--------|--------------------------------------|---------------------------------|--------|-------|---------------------------------|--------|--------|--------|--------|--------|--------|--------|
| REF. | PART | STOCK | DESCRIPTION | 924036 | 924038 | 924027 | 924039 | 924040 | 924042 | 924044 | REF. | PART | STOCK | DESCRIPTION | 924036 | 924038 | 924027 | 924039 | 924040 | 924042 | 924044 |
| NO. | NO. | CODE | | | | | | | | | NO. | NO. | CODE | | | | | | | | |
| 1 | 070009 | | FLANGE WHIZLOCK SCREW | 8 | 8 | 8 | 8 | | | | 129 | 024338 | | HEX SHAFT | 1 | 1 | | | | | |
| 4 | 060012 | | SETSCREW | 1 | 1 | 1 | 1 | | | | 129 | 024045 | | HEX SHAFT | | | | | 1 | 1 | |
| 6 | 063003 | | LOCKWASHER | 5 | 5 | 5 | 5 | | | | 130 | 065086 | | LOCK NUT | 1 | 1 | 1 | 1 | 1 | 1 | |
| 11 | 024074 | | PINION CHAIN | | | | | 1 | 1 | | 131 | 066015 | | KEY, Woodruff 1/8 x 5/8 | 1 | 1 | 1 | 1 | 1 | 1 | |
| 12 | 075050 | | SNAP BUSHING | 1 | 1 | 1 | 1 | | | | 132 | 010276 | | 9 TOOTH SPROCKET | 1 | 1 | 1 | 1 | 1 | 1 | |
| 18 | 065040 | | LOCKNUT | 2 | 2 | 2 | 2 | | | | 133 | 063025 | | LOCKWASHER | | | | 1 | | | |
| 20 | 024073 | | IDLER CHAIN | | | | | 1 | 1 | | 134 | 003085 | | BEARING FLANGE | 1 | 1 | 1 | 1 | 1 | 1 | |
| 20 | 012078 | | IDLER CHAIN | 1 | 1 | | | | | | 135 | 054080 | | RADIAL BEARING | 1 | 1 | 1 | 1 | 1 | 1 | |
| 35 | 065018 | | NUT | | | | | 2 | 2 | | 136 | 024141 | | BEARING FLANGE | 1 | 1 | 1 | 1 | 1 | 1 | |
| 38 | 065042 | | LOCKNUT | 3 | 3 | 3 | 3 | | | | 137 | 064093 | | WASHER, .380/.385 x 3/16 x .062 | | | | 2 | 2 | | |
| 45 | 059022 | | CAP SCREW, 5/16-18 x 3/4 | 1 | 1 | 1 | 1 | | | | 138 | 065054 | | LOCKNUT | 1 | 1 | 1 | 1 | 1 | 1 | |
| 50 | 022135 | | ROD ADAPTER | 1 | 1 | 1 | 1 | | | | 139 | 063014 | | LOCKWASHER | | | | 2 | 2 | | |
| 53 | 065094 | | LOCKNUT | 4 | 4 | 4 | 4 | | | | 141 | 024367 | | PINION SHAFT | 1 | 1 | 1 | 1 | 1 | 1 | |
| 56 | 067001 | | COTTER PIN | 2 | 2 | 2 | 2 | | | | 142 | 058029 | | ROLL PIN | 2 | 2 | 2 | 2 | 2 | 2 | |
| 59 | 024253 | | BELT FINGER | 1 | 1 | | | | | | 143 | 064039 | | WASHER, .625/.635 x .005 x .062 | 5 | 5 | 5 | 5 | 5 | 5 | |
| 61 | 075040 | | BUTTON PLUG | 1 | 1 | 1 | 1 | | | | 144 | 010207 | | PINION & SPROCKET | 1 | 1 | | | | | |
| 62 | 024278 | | WIRE GROUND | 1 | 1 | 1 | 1 | | | | 144 | 024368 | | PINION & SPROCKET | | | | 1 | 1 | | |
| 63 | 022161 | | SHORTING WIRE | 1 | 1 | 1 | 1 | | | | 145 | 022093 | | SPIN DRIVE ZERK FITTING | | | 1 | 1 | 2 | | |
| 66 | 024232 | | LEVER SHIFT ARM | 1 | 1 | 1 | 1 | | | | 146 | 610938 | | L. H. AXLE ASSEMBLY | 1 | | | | | | |
| 67 | 024364 | | REDUCTION SHAFT | | | | | 1 | 1 | | 146 | 624074 | | L.H. AXLE | | | | | | | 1 |
| 68 | 624072 | | REDUCTION SPROCKET | | | | | 1 | 1 | | 147 | 055029 | | SLEEVE BUSHING | | | 1 | | | | 1 |
| 69 | 024366 | | SHAFT SUPPORT | | | | | 1 | 1 | | 148 | 010374 | | PIN | | | 1 | | | | 1 |
| 69 | 024339 | | SHAFT SUPPORT | 1 | 1 | | | | | | 149 | 083007 | | SPRING | | | 1 | | | | 1 |
| 70 | 024231 | | BRACKET SHIFT LEVER | 1 | 1 | 1 | 1 | | | | 150 | 024227 | | ADAPTER | 1 | 1 | 1 | 1 | 1 | 1 | |
| 71 | 012151 | | CLEVIS PIN | 2 | 2 | 2 | 2 | | | | 151 | 012023 | | BEARING SUPPORT | 2 | | | 2 | | | |
| 72 | 058032 | | ROLL PIN, 3/32 x 1 | | | 1 | 1 | | | | 152 | 055057 | | BUSHING | | | | | | | 1 |
| 73 | 010375 | | KNOB | | | 1 | 1 | | | | 152 | 055029 | | BUSHING | | | 1 | | | | |
| 75 | 058042 | | GROOVE PIN | | | 1 | 1 | | | | 153 | 010142 | | BEARING FLANGE | | | 2 | | | | |
| 84 | 065056 | | LOCKNUT | 6 | 6 | 6 | 6 | | | | 153 | 024363 | | BEARING FLANGE | | | | | | | 2 |
| 85 | 024077 | | SHAFT SUPPORT | 4 | 4 | 4 | 4 | | | | 155 | 055039 | | FLANGED BUSHING | 2 | | | | | | |
| 86 | 024233 | | SHIFT LINK | 2 | 2 | 2 | 2 | | | | 155 | 055030 | | FLANGED BUSHING | | | | | 2 | | |
| 89 | 073049 | | SHEAVE | 1 | 1 | 1 | 1 | | | | 156 | 070015 | | FLANGE WHIZLOCK SCREW | 11 | 11 | 11 | 11 | 11 | 11 | |
| 90 | 065077 | | LOCKNUT, Nylon | 1 | 1 | 1 | 1 | | | | 158 | 064058 | | WASHER, .500/.505 x 1 x .062 | 2 | 2 | 2 | 2 | 2 | 2 | |
| 91 | 010372 | | LOCKNUT, Hub | | | 1 | 1 | | | | 159 | 070011 | | RIBBED NECK BOLT | 6 | 6 | 6 | 6 | 6 | 6 | |
| 93 | 059136 | | CAP SCREW, 5/16-18 x 3 | 1 | 1 | 1 | 1 | | | | 162 | 055040 | | BUSHING | | | | | 2 | 2 | |
| 96 | 059039 | | CAP SCREW, 5/16-18 x 1/2 | 4 | 4 | 4 | 4 | | | | 164 | 059028 | | CAP SCREW, 1/4-20 x 1/2 | 2 | 2 | 2 | 2 | 2 | 2 | |
| 100 | 024115 | | SPACER | 1 | 1 | 1 | 1 | | | | 169 | 063018 | | LOCKWASHER | 3 | 3 | 3 | 3 | 3 | 3 | |
| 101 | 083094 | | SPRING | 1 | 1 | 1 | 1 | | | | 170 | 624027 | | SPRING ASSEMBLY | 1 | 1 | 1 | 1 | 1 | 1 | |
| 102 | 024272 | | CLUTCH FORK | 1 | 1 | 1 | 1 | | | | 172 | 024251 | | SWITCH ACTUATOR | 1 | 1 | 1 | 1 | 1 | 1 | |
| 103 | 067002 | | COTTER PIN, 3/32 x 1 | 2 | 2 | 2 | 2 | | | | 173 | 075045 | | SWITCH BOOT | 1 | 1 | 1 | 1 | 1 | 1 | |
| 104 | 024069 | | FORK PIVOT ROD | 1 | 1 | 1 | 1 | | | | 174 | 025172 | | SWITCH | 1 | 1 | 1 | 1 | 1 | 1 | |
| 106 | 065062 | | LOCKNUT, Nylon | 1 | 1 | 1 | 1 | | | | 175 | 024220 | | ROD RETAINER | 1 | 1 | 1 | 1 | 1 | 1 | |
| 107 | 054039 | | BALL BEARING | 2 | 2 | 2 | 2 | | | | 176 | 074054 | | TAPTITE | 2 | 2 | 2 | 2 | 2 | 2 | |
| 108 | 022002 | | SPINDLE HOUSING | 1 | 1 | 1 | 1 | | | | 177 | 022167 | | WIRING HARNESS | 1 | 1 | 1 | 1 | 1 | 1 | |
| 109 | 024155 | | BEARING SPACER | 1 | 1 | 1 | 1 | | | | 178 | 069066 | | CLIP | 1 | 1 | 1 | 1 | 1 | 1 | |
| 110 | 022003 | | DRIVE SPINDLE HOUSING | 1 | 1 | 1 | 1 | | | | 179 | 024330 | | SPACER | 1 | 1 | 1 | 1 | 1 | 1 | |
| 111 | 003034 | | ROLLER | 1 | 1 | 1 | 1 | | | | 180 | 524010 | | MODULE T | 1 | 1 | 1 | 1 | 1 | 1 | |
| 112 | 059003 | | CAP SCREW, 5/16-18 x 1 | 1 | 1 | 1 | 1 | | | | 181 | 024203 | | CONNECTOR | 1 | 1 | 1 | 1 | 1 | 1 | |
| 113 | 066006 | | KEY, Woodruff 1/8 x 1/2 | 1 | 1 | 1 | 1 | | | | 182 | 059097 | | CAP SCREW, 10-24 x 3/8 | 2 | 2 | 2 | 2 | 2 | 2 | |
| 114 | 024076 | | SPINDLE | 1 | 1 | 1 | 1 | | | | 183 | 065051 | | KEPS NUT | 2 | 2 | 2 | 2 | 2 | 2 | |
| 115 | 010546 | | DRIVE PLATE | 1 | 1 | 1 | 1 | | | | 184 | 024219 | | LOWER ROD INTERLOCK | 1 | 1 | | | | | |
| 116 | 065015 | | NUT | 4 | 4 | 4 | 4 | | | | 184 | 022152 | | LOWER ROD INTERLOCK | | | | | 1 | 1 | |
| 117 | 054136 | | BEARING | | | | | | 2 | | 191 | 024246 | | SWITCH RETANER | 1 | 1 | 1 | 1 | 1 | 1 | |
| 117 | 054093 | | BEARING | | | 2 | | | | | 195 | 064123 | | WASHER, 5/16 x 11/16 x .065 | 1 | 1 | 1 | 1 | 1 | 1 | |
| 118 | 024086 | | SPACER | 1 | 1 | 1 | 1 | | | | 196 | 003017 | | BEARING FLANGE | | | 2 | | | | |
| 119 | 024071 | | DRIVE DISC SPACER | 1 | 1 | 1 | 1 | | | | 197 | 025089 | | SPACER | 1 | 1 | 1 | 1 | 1 | 1 | |
| 120 | 024081 | | CARRIER SHAFT | 1 | 1 | 1 | 1 | | | | 198 | 070058 | | RIBBED NECK BOLT | | | | | | | 8 |
| 121 | 024228 | | CLUTCH ENGAGEMENT YOKE | 1 | 1 | 1 | 1 | | | | 199 | 058009 | | ROLL PIN | 1 | 1 | 1 | 1 | 1 | 1 | |
| 122 | 055026 | | FLANGED BUSHING | 2 | 2 | 2 | 2 | | | | 200 | 010485 | | STREET ELBOW | 1 | 1 | 1 | | | | |
| 123 | 524011 | | CARRIER | 1 | 1 | 1 | 1 | | | | 201 | 012222 | | NIPPLE | 1 | 1 | 1 | | | | |
| 124 | 010542 | | ADAPTER SPACER | 1 | 1 | 1 | 1 | | | | 202 | 025208 | | CAP | 1 | 1 | 1 | | | | |
| 126 | 024075 | | FRICTION DISC HUB | 1 | 1 | 1 | 1 | | | | NOTE: DECALS SEE PAGES 2 & 3 | | | | | | | | | | |
| 127 | 054093 | | RADIAL BEARING | 2 | 2 | 2 | 2 | | | | NOTE: DECALQUES (voir p. 2 & 3) | | | | | | | | | | |

SUGGESTED PARTS STOCKING CODE

F - FAST
M - MEDIUM
S - SLOW
O - CUSTOMER ORDER ONLY

CODE SUGGÈRE D'INVENTAIRE DES PIÈCES

F - FAST (rapide)
M - MEDIUM (moyen)
S - SLOW (lent)
O - Commande du client seulement

32" SNO-THRO PARTS LIST FOR MODELS 924042 & 924044
SOUFLEURS SNO-THRO DE 32" MODELES 924042 & 924044

NOTE: UTILISEZ L'HUILE SPÉCIALE
 L-2 ARIENS POUR LUBRIFICATION
 DE LA TRANSMISSION (approx. 5 ounces)
 DANS LE ROTOR DU CARTER

NOTE: USE ARIENS SPECIAL L-2 GEAR LUBE
 (APPROX. 5 OZ.) IN ROTOR GEAR CASE

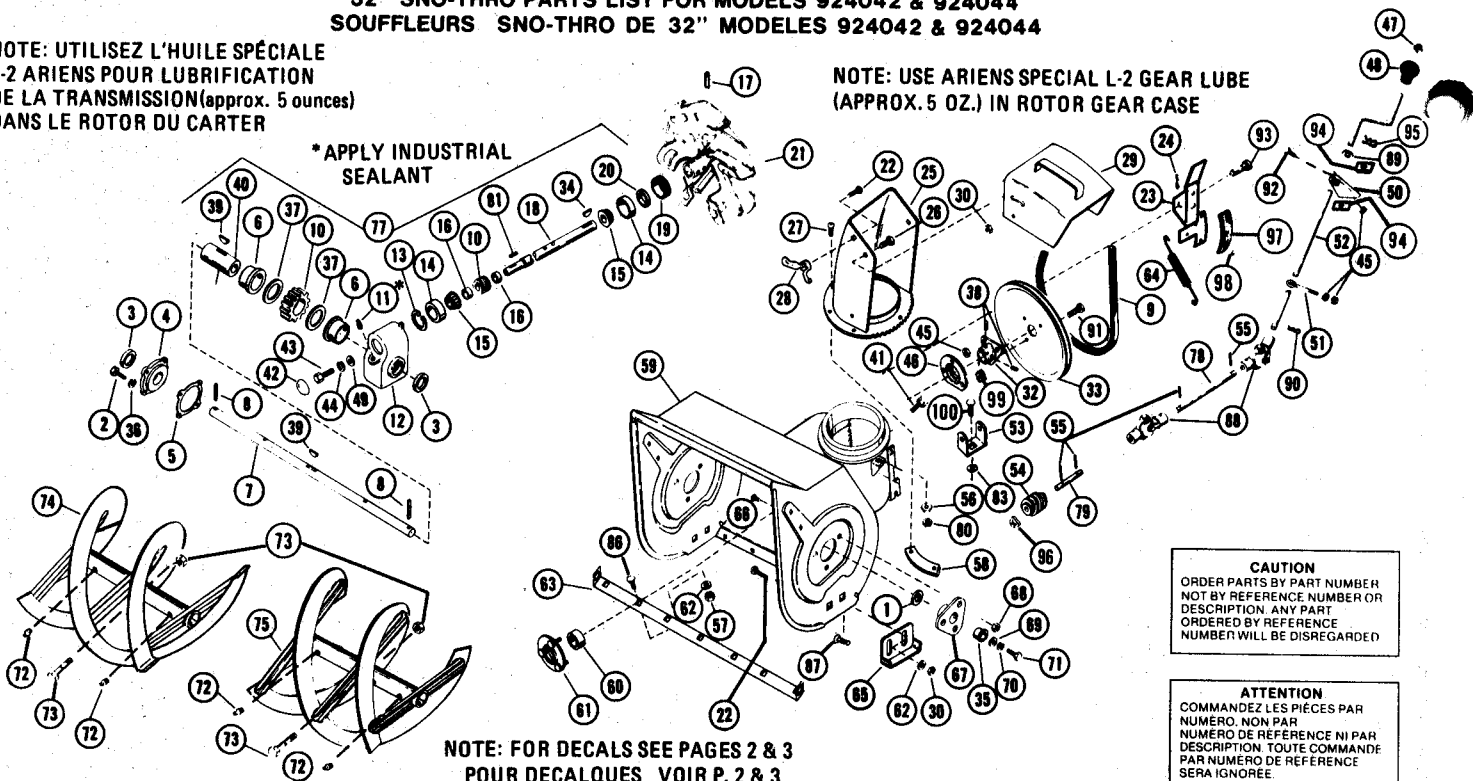

| No DE REF. REF. NO. | NO DE PIÈCE PART NO. | CODE D'INV. STOCK CODE | DESCRIPTION | QUANTITÉ NO. REQ'D | No DE REF. REF. NO. | NO DE PIÈCE PART NO. | CODE D'INV. STOCK CODE | DESCRIPTION | QUANTITÉ NO. REQ'D |
|---------------------------|----------------------------|---------------------------------|--------------------------------|-----------------------|---------------------------|----------------------------|---------------------------------|----------------------------------|-----------------------|
| 1 | 064046 | | WASHER, 1.000/1.010x.505x1/16 | 2 | 49 | 064082 | | WASHER | 1 |
| 2 | 059001 | | CAPSCREW, 1/4-20x1/4 | 4 | 50 | 024341 | | ROD HANGER | 1 |
| 3 | 056070 | | SEAL | 2 | 51 | 024401 | | EYEBOLT | 1 |
| 4 | 024013 | | GEAR CASE COVER | 1 | 52 | 024340 | | CHUTE CRANK | 1 |
| 5 | 002008 | | GASKET | 1 | 53 | 022123 | | WORM CLEVIS | 1 |
| 6 | 055059 | | BUSHING | 2 | 54 | 022110 | | WORM GEAR | 1 |
| 7 | 024065 | | RAKE SHAFT | 1 | 55 | 058034 | | ROLL PIN, 1/8 x 3/4 | 4 |
| 8 | 058030 | | ROLL PIN, 3/16x1 1/2 | 2 | 56 | 063023 | | LOCKWASHER | 1 |
| 9 | 072108 | | V BELT | 1 | 57 | 065042 | | LOCKNUT | 6 |
| 10 | 524009 | | WORM & | 1 | 58 | 010438 | | CHUTE CLAMP | 4 |
| 11 | 001138 | | PIPE PLUG | 1 | 59 | 524029 | | BLOWER HOUSING | 1 |
| 12 | 024002 | | GEAR CASE | 1 | 60 | 054052 | | BALL BEARING | 1 |
| 13 | 057032 | | SNAP RING | 1 | 61 | 031859 | | BEARING FLANGE | 1 |
| 14 | 054044 | | BEARING CUP | 2 | 62 | 064002 | | WASHER, 5/16 x 7/8 x .083 | 10 |
| 15 | 054045 | | BEARING CONE | 2 | 63 | 024373 | | SCRAPER BLADE | 1 |
| 16 | 002005 | | BEARING SPACER | 2 | 64 | 083164 | | SPRING | 1 |
| 17 | 058015 | | ROLL PIN, 5/16x1 1/4 | 2 | 65 | 029225 | | SKID SHOE | 2 |
| 18 | 024375 | | WORM SHAFT | 1 | 66 | 070011 | | RIBBED NECK BOLT | 6 |
| 19 | 024015 | | ADJUSTMENT PLUG | 1 | 67 | 010184 | | BEARING SUPPORT | 1 |
| 20 | 056061 | | SEAL | 1 | 68 | 065056 | | FLANGE WHIZLOCK NUT | 6 |
| 21 | 024376 | | FAN | 1 | 69 | 064047 | | WASHER, 5/6 x 5/16 x 1.441 x 1/8 | 2 |
| 22 | 062010 | | CARRIAGE BOLT, 3/8-16 x 3/4 | 3 | 70 | 063006 | | LOCKWASHER | 2 |
| 23 | 624035 | | BRAKE ARM ASSEMBLY | 1 | 71 | 059024 | | CAPSCREW, 1/4-13x1 | 2 |
| 24 | 067019 | | HAIR PIN | 1 | 72 | 022093 | | SPIN DRIVE ZERK FITTING | 4 |
| 25 | 024403 | | DISCHARGE CHUTE | 1 | 73 | 510015 | | SHEAR BOLT W/ NUT | 2 |
| 26 | 059023 | | CAP SCREW, 3/8-16 x 3/4 | 2 | 74 | 024262 | | RIGHT RAKE | 1 |
| 27 | 074054 | | TAPTITE | 8 | 75 | 024261 | | LEFT RAKE | 1 |
| 28 | 010183 | | WING NUT | 1 | 77 | 524005 | | GEAR CASE ASSEMBLY | 1 |
| 29 | 510012 | | DEFLECTOR CHUTE | 1 | 78 | 024346 | | ROD | 1 |
| 30 | 065039 | | LOCKNUT | 6 | 79 | 010494 | | WORM SHAFT | 1 |
| 32 | 024389 | | PULLEY HUB | 1 | 80 | 065015 | | NUT | 1 |
| 33 | 073070 | | SHEAVE | 1 | 81 | 066013 | | KEY, straight 3/16x3/16x1 | 1 |
| 34 | 066001 | | KEY, Woodruff, 3/16 x 7/8 | 1 | 83 | 063032 | | LOCKWASHER | 1 |
| 35 | 055035 | | FLANGED BUSHING | 2 | 86 | 062026 | | CARRIAGE BOLT | 6 |
| 36 | 063017 | | LOCKWASHER | 4 | 87 | 062013 | | CARRIAGE BOLT, 3/8-16 x 1 | 2 |
| 37 | 064087 | | WASHER, 1.623/1.627x2.500x.012 | 2 | 88 | 624065 | | UNIVERSAL JOINT ASSEMBLY | 1 |
| 38 | 060011 | | SETSCREW | 2 | 89 | 064043 | | WASHER, 3/8 x 13/16 x .065 | 2 |
| 39 | 066008 | | KEY, woodruff No. 6 | 2 | 90 | 067010 | | HAIR PIN, 3/32 x 1-27/64 | 1 |
| 40 | 024064 | | GEAR CASE SHAFT | 1 | 91 | 070053 | | RIBBED NECK BOLT | 3 |
| 41 | 070031 | | FLANGE WHIZLOCK SCREW | 2 | 92 | 059028 | | CAP SCREW, 1/4-20 x 1/2 | 1 |
| 42 | 004037 | | DUST CAP | 1 | 93 | 024345 | | CLEVIS PIN | 1 |
| 43 | 059022 | | CAP SCREW, 5/16-18 x 3/4 | 1 | 94 | 024408 | | WASHER | 2 |
| 44 | 063003 | | LOCKWASHER | 1 | 95 | 067020 | | HAIR PIN | 1 |
| 45 | 065040 | | LOCKNUT | 6 | 96 | 010260 | | WAVE WASHER | 1 |
| 46 | 031860 | | BEARING FLANGE | 1 | 97 | 022178 | | LINING | 1 |
| 47 | 010198 | | CAP | 1 | 98 | 068062 | | RIVET | 2 |
| 48 | 075083 | | KNOB | 1 | 99 | 065078 | | WHIZLOCK NUT | 3 |
| | | | | | 100 | 062011 | | CARRIAGE BOLT | 1 |
| | | | | | 101 | 067010 | | HAIR PIN | 2 |

SUGGESTED PARTS STOCKING CODE
 F - FAST S - SLOW
 M - MEDIUM O - CUSTOMER ORDER ONLY

CODE SUGGÉRÉ D'INVENTAIRE DES PIÈCES
 F - FAST (rapide) S - SLOW (lent)
 M - MEDIUM (moyen) O - Commande du client seulement

DEALER SET UP AND PRE-SERVICE

GENERAL

All hardware and parts required for pre-service procedures are shipped in the parts bag or in place on the machine. The tractor and handlebars are assembled. On 24" Models 924036, 924038, 924039 and 924040 the control handles must be bolted in place. On all models the control rods must be connected as described below and the snow head must be attached to the tractor. All adjustments have been made at the factory. Be sure to check adjustments as the pre-service procedures are followed.

2. ATTACHMENT CLUTCH

On 32" Models 924042 and 924044: The attachment clutch handle has been shipped fastened in position on the dash panel with rods attached. Attach the lower end of the attachment rod to the lever with the cap screw already in place on the lever. Just tighten the cap screw in the rod adapter to install. The rod has been assembled to proper length at the factory.

On 24" Models 924026, 924038, 924039 and 924040: The attachment handle has been shipped loose in the dash panel. To install, place the handle in the OUT position. Line up the holes in the handle and panel, secure the handle in the panel with the 5/16-18 x 2" pivot bolt (59057) and the 5/16-18 locknut (65042). Do not overtighten.

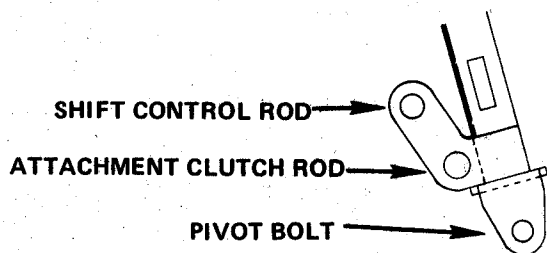

FIGURE 1

3. SHIFT CONTROL

On 32" Models 924042 and 924044: The shift control and shift rod are installed and require no adjustment.

On 24" Models 924036, 924038, 924039 and 924040: The shift handle has been shipped loose in the dash panel with shift rod installed. To install, position the shift handle in the panel so the holes line up and secure with a 5/16-18 x 2" pivot bolt (59057) and a 5/16-18 locknut. Do not overtighten.

4. TRACTOR CLUTCH – ALL MODELS

- The clutch handle is already positioned on the handlebar and the tractor clutch rod is in place in the handle. Check to be sure the clutch handle is free to fall down on the grip.
- Insert the lower end of the tractor clutch rod into the rod adapter.
- Position the clutch handle so that it is all the way up. See Figure 3. Tighten the tractor clutch rod in the rod adapter with the setscrew.

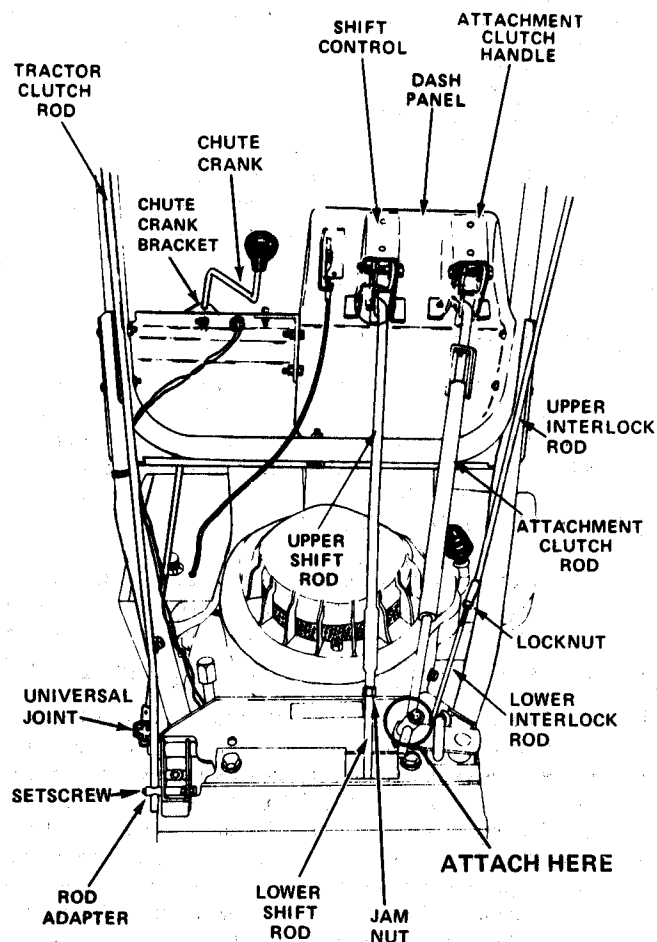

FIGURE 2

5. ATTACHING THE SNOW HEAD – ALL MODELS

- Remove the belt guard from the front of the tractor. The belt is shipped in place on the snow head sheave.
- Position the snow head on the front of the tractor. Notches on the bottom of the snow head fit on rod across the bottom of the tractor.
- With the belt in place on the snow head sheave, tip the snow head up into position in the tractor frame. Secure with a 3/8-16 x 3/4" flanged whizlock screw (70031) on each side of the frame.

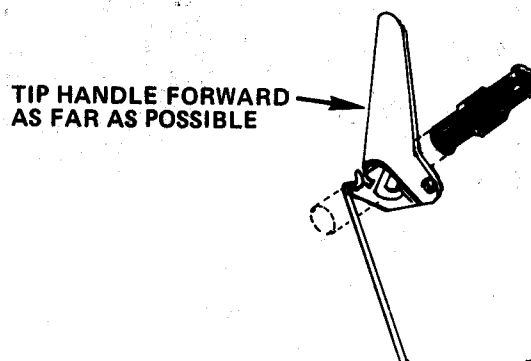

FIGURE 3

- d. Install the drive belt on the engine sheave. Belt finger must clear belt by 1/8" all around the sheave. Adjust if required.
- e. Engage and disengage attachment clutch and see that idler tightens belt and clears belt properly. If necessary adjust the idler by loosening the center bolt and moving it in the slotted hole in the idler bracket.
- f. Replace the belt cover.

6. DISCHARGE CHUTE

The discharge chute is shipped with the mounting clips attached to the chute. Remove the clips and hardware. Position the discharge chute on the blower housing. Secure with the clips and hardware. Be sure the chute rotates freely.

7. DEFLECTOR

The deflector is installed on the discharge chute but must be raised into operating position. Remove the carriage bolt and wing nut. Rotate the deflector up into operating position. Reinstall the carriage bolt and wing nut.

8. CHUTE CONTROL CRANK

The Chute Control Crank is shipped in place in the brackets, but must be raised into operating position. Pull out the Hairpin in the chute crank just below the chute crank bracket on the handlebar panel. Pull the crank up into position and replace the hairpin on top of the washer ABOVE the bracket. On 24" Models 924036, 924038, 924039 and 924040 the intermediate shaft must be positioned into the sleeve on the worm and secured with a hairpin. On 32" Models 924042 and 924044 the intermediate shaft is in place and the chute crank must be connected at the universal joint. Secure with a hairpin. On all models, after completing the chute crank connection, check the alignment of worm and chute by rotating the discharge chute through its full travel. Chute should rotate easily, if not, reposition worm as required.

9. RUNNERS — ON MODELS 924042 and 924044 ONLY

Install runners on each side of the blower housing. Use longer carriage bolts (62013) in the rear holes; shorter carriage bolts (62010) in the front holes. Use a washer (64002) and locknut (65039) on each bolt, outside the housing. Adjust the runners to equal height on each side. See paragraph on page 5 for proper adjustment.

10. ENGINE

Before starting the engine, fill the crankcase with Ariens Sno-Thro oil 5W-20 for snow blower operation below 40 degrees F. Use Ariens Gard-N-Yard oil 10W-30 for operation at temperatures above 40 degrees F.

11. BLOWER GEAR CASE

On 32" Models 924042, 924044 and 824003: Check the oil level in the snow rotor gear case. Oil level must be even with the oil filler hole. Fill with Ariens Special L-2 Gear Lubricant. Replace the filler plug.

On 24" Models 924036, 924038, 924039, 924040, 824001 and 824002: The blower gear case is factory lubricated and should require no lubrication by the dealer. Full instructions for checking are given in the LUBRICATION section of the manual.

12. INTERLOCK LEVER

To minimize the chances for injury while the auger and blower are operating (Attachment clutch — engaged) either the Interlock Lever — or the tractor clutch — must be depressed or the engine will stop. Engine should run with Interlock lever depressed; stop with lever released. Loosen locknut and adjust length of Interlock rod if required. Retighten locknut.

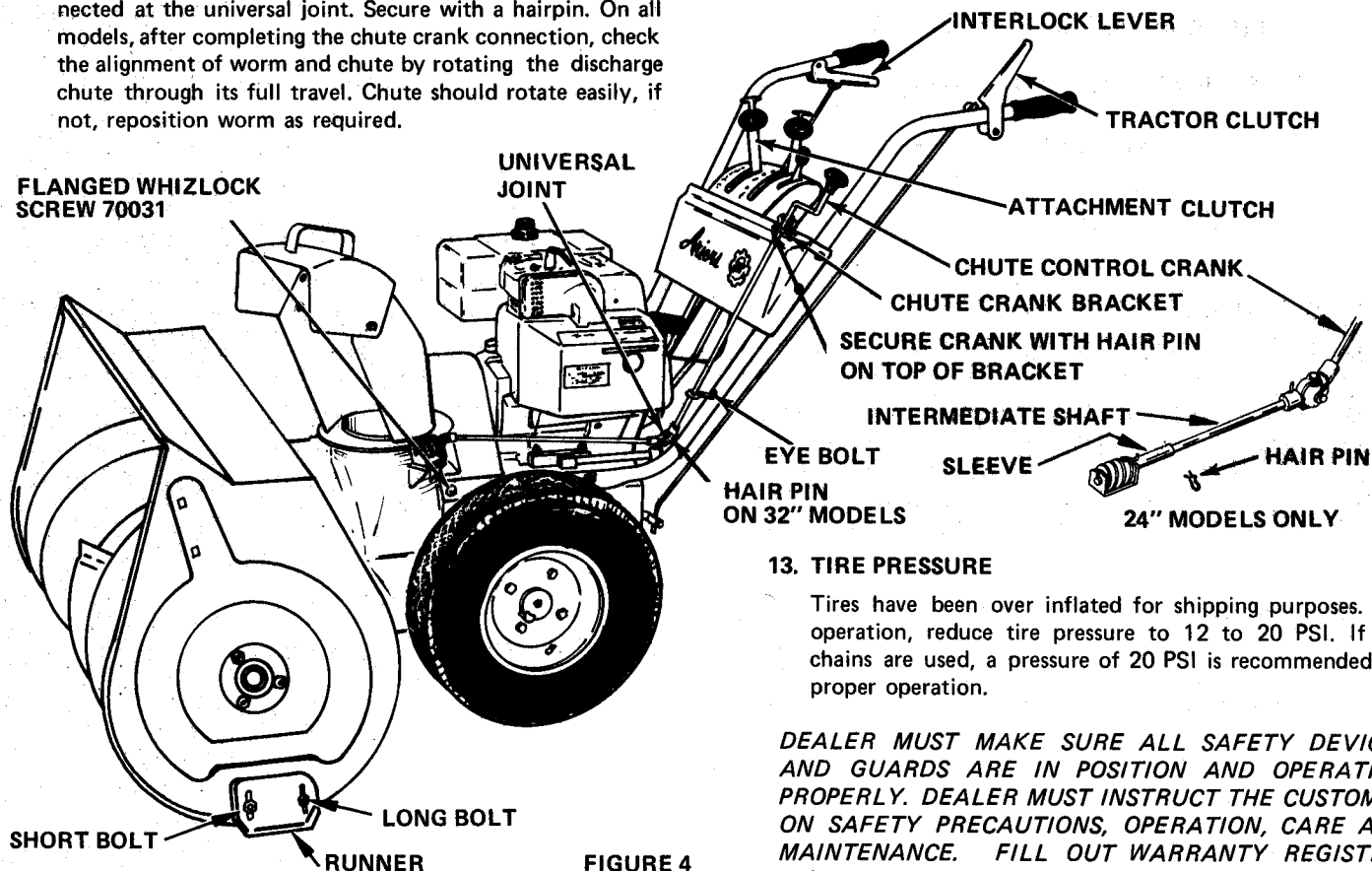

13. TIRE PRESSURE

Tires have been over inflated for shipping purposes. For operation, reduce tire pressure to 12 to 20 PSI. If tire chains are used, a pressure of 20 PSI is recommended for proper operation.

DEALER MUST MAKE SURE ALL SAFETY DEVICES AND GUARDS ARE IN POSITION AND OPERATING PROPERLY. DEALER MUST INSTRUCT THE CUSTOMER ON SAFETY PRECAUTIONS, OPERATION, CARE AND MAINTENANCE. FILL OUT WARRANTY REGISTRATION AND MAIL TO ARIENS COMPANY.

FIGURE 4