

OWNERS MANUAL

Ariens 6HP/8HP Deluxe Sno-Thro

SERIAL NUMBER

MODEL 924022 - 000101

(6 H.P. - 24")

MODEL 924023 - 000101

(6 H.P. Tractor)

MODEL 924024 - 000101

(8 H.P. - 32")

MODEL 924025 - 000101

(8 H.P. Tractor)

MODEL 924026 - 000101

(8 H.P. - 24")

MODEL 924027 - 000101

(8 H.P. Tractor)

MODEL 924028 - 000101

(24" Sno-Thro Kit)

MODEL 924029 - 000101

(32" Sno-Thro Kit)

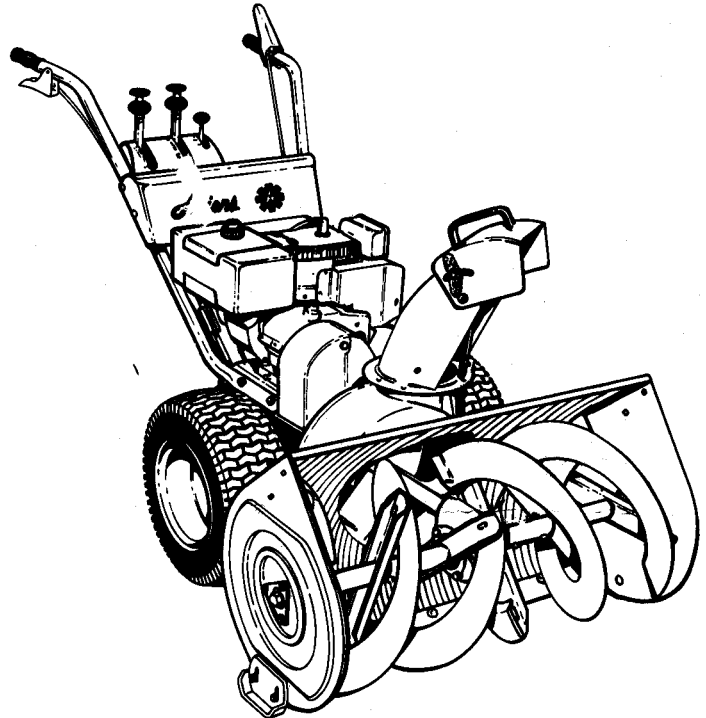

OWNER'S MANUAL - 24282

PRICE \$.50

▲ SAFETY MESSAGE ▲

The product for which you have requested information or replacement parts is not a current product. The replacement models incorporate product designs, safety features, safety instructions or warnings which represent the latest "State Of The Art" developments. For your safety and those around you please contact your nearest Ariens/Gravely Dealer for a demonstration of the current product safety provisions and features.

ARIENS COMPANY



BRILLION, WIS. 54110

DEALER SET UP AND PRE-SERVICE

All hardware and parts required for pre-service procedures are shipped in place on the machine. The tractor and handlebars are assembled. On Model 924024 - the 8 HP 32" machine, the control handles must be bolted in place. On all models the control rods must be connected as described below and the snow head must be attached to the tractor. All adjustments have been made at the factory. Be sure to check adjustments as the pre-service procedures are followed.

2. ATTACHMENT CLUTCH

ON MODEL 924024 - 8 HP 32":

- The attachment clutch handle has been shipped loose in the panel. Place the handle in the "OUT" position, line up holes and secure the handle in the panel with the 5/16-18 x 2" pivot bolt (59057) and 5/16-18 locknut (65042).

ON ALL MODELS:

- Shift the attachment clutch handle to the "IN" position. Place a .380 washer (64093) on the end of attachment clutch rod and insert the rod into the LOWER hole in the handle. Secure with a cotter pin 1/8 x 1/2" (67018). See figure 1.

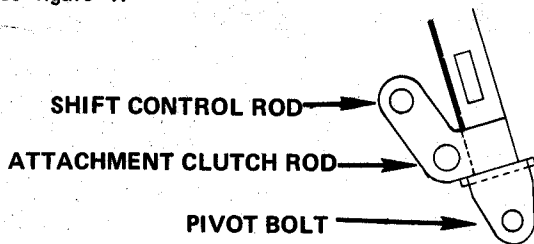

FIGURE 1

3. SHIFT CONTROL

ON MODEL 924024 - 8 HP 32":

- The shift handle has been shipped loose in the panel. Position the shift handle in the panel so that the holes line up and secure the handle in the panel with the 5/16-18 x 2" pivot bolt (59057) and 5/16-18 locknut (65042).

ON ALL MODELS:

- Place shift handle in 5th speed position. Push down on shift rod. The end of the shift rod should align with the UPPER hole in the handle if the rod adjustment is correct. See figure 1. If the rod does not align with the hole, adjust the length by screwing the rod up or down until the end of the shift rod lines up with the upper hole in the control handle, then tighten the shift rod jam nut.
- Place a .380" washer (64093) on the end of the shift rod, insert the rod into the UPPER hole in the handle, and secure with a cotter pin 1/8 x 1/2" (67018).

4. TRACTOR CLUTCH - ALL MODELS

- The clutch handle is already positioned on the handlebar and the clutch rod is in place in the handle. Check to be sure the clutch handle is free to fall down on the grip.
- Insert the lower end of the clutch rod into the rod adapter.
- Position the clutch handle so that it is all the way up. See figure 3.) Tighten the clutch rod in the rod adapter with the setscrew.

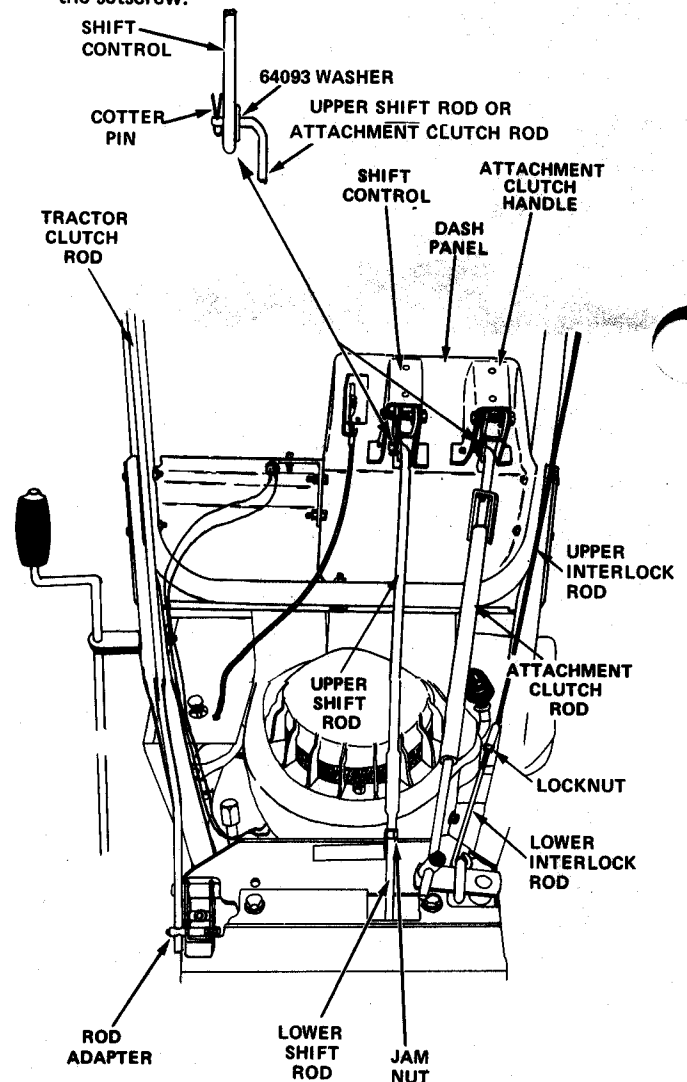
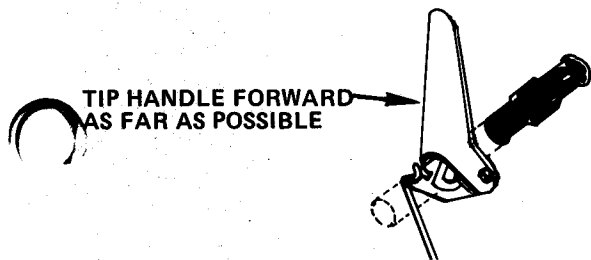

FIGURE 2



5. ATTACHING THE SNOW HEAD – ALL MODELS

- a. Remove the belt guard from the front of the tractor. The belt is shipped in place on the snow head sheave.
- b. Position the snow head on the front of the tractor. Notches on the bottom of the snow head fit on rod across the bottom of the tractor.
- c. With the belt in place on the snow head sheave, tip the snow head up into position in the tractor frame. Position belt on snow-thro sheave and secure with a 3/8-16 x 3/4" flanged whizlock screw (70031) on each side of the frame.
- d. Install the drive belt on the engine sheave. Belt finger must clear belt by 1/8" all around the sheave. Adjust if required.
- e. Engage and disengage attachment clutch and see that idler tightens belt and clears belt properly. If necessary adjust the idler by loosening the center bolt and moving it in the slotted hole in the idler bracket.
- f. Replace belt cover.

6. CHUTE CONTROL CRANK – ALL MODELS

- a. The chute control crank is shipped installed on the handlebars. Insert the end of the crank into the joint on the snow head. Secure with a hair pin cotter. Check alignment of worm and chute by rotating discharge chute through its full travel. Chute should rotate easily, if not, reposition worm as required.

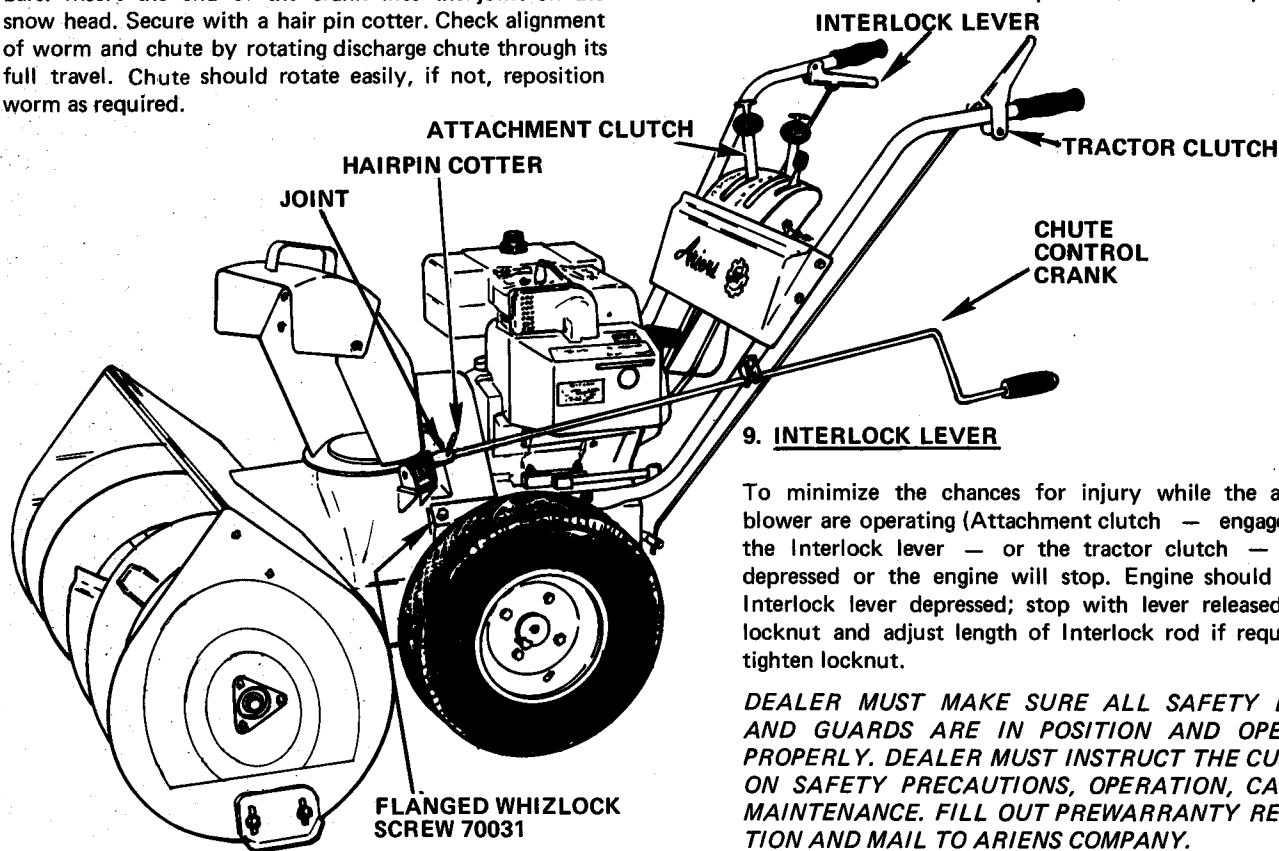
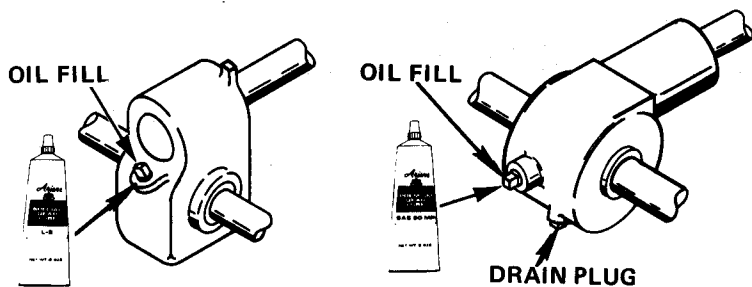

FIGURE 5



MODEL 924024 and 924029 GEARCASE

MODEL 924022, 924026 and 924028 GEARCASE

FIGURE 4

7. ENGINE

Before starting the engine, fill the crankcase with Ariens Sno-Thro oil 5W-20 for snow blower operation below 40 degrees F. Use Ariens Gard-N-Yard oil 10W-30 for operation at temperatures above 40 degrees F.

8. BLOWER GEAR CASE

MODELS 924024, 924029 – 8 HP 32"

Check the oil level in the snow rotor gear case. Oil level must be even with the oil filler hole. Fill with Ariens Special L-2 Gear Lubricant. Replace the filler plug.

MODELS 924022, 924026 & 924028 – 6 & 8 HP/24"

Check the oil level in the snow rotor gear case. Tip the machine back on the handlebars. Remove the filler and drain plugs. Fill with Ariens Gear Oil (SAE MP90) through the filler hole until it runs out the drain. Replace drain and filler plugs.

9. INTERLOCK LEVER

To minimize the chances for injury while the auger and blower are operating (Attachment clutch – engaged) either the Interlock lever – or the tractor clutch – must be depressed or the engine will stop. Engine should run with Interlock lever depressed; stop with lever released. Loosen locknut and adjust length of Interlock rod if required. Retighten locknut.

DEALER MUST MAKE SURE ALL SAFETY DEVICES AND GUARDS ARE IN POSITION AND OPERATING PROPERLY. DEALER MUST INSTRUCT THE CUSTOMER ON SAFETY PRECAUTIONS, OPERATION, CARE AND MAINTENANCE. FILL OUT PREWARRANTY REGISTRATION AND MAIL TO ARIENS COMPANY.

SAFETY FIRST



Know your controls and how to stop quickly. Do not operate without proper instructions. Read the owner's manual.

Handle gasoline with care. It is highly flammable. Never add gasoline to a running or hot engine. Wipe up spilled gasoline. Do not run or fill engine indoors. Exhaust fumes are dangerous. Keep safety devices in place. Keep all nuts, bolts and screws tight.



Inspect work area and clear of objects which might be picked up and thrown.

Keep children and pets a safe distance away. Never direct discharge at bystanders nor allow anyone in front of machine.



Disengage clutch and stop engine before cleaning discharge chute, removing obstacles, making adjustments and when leaving operating position. Never use hands to clear snow from rakes or discharge chute.

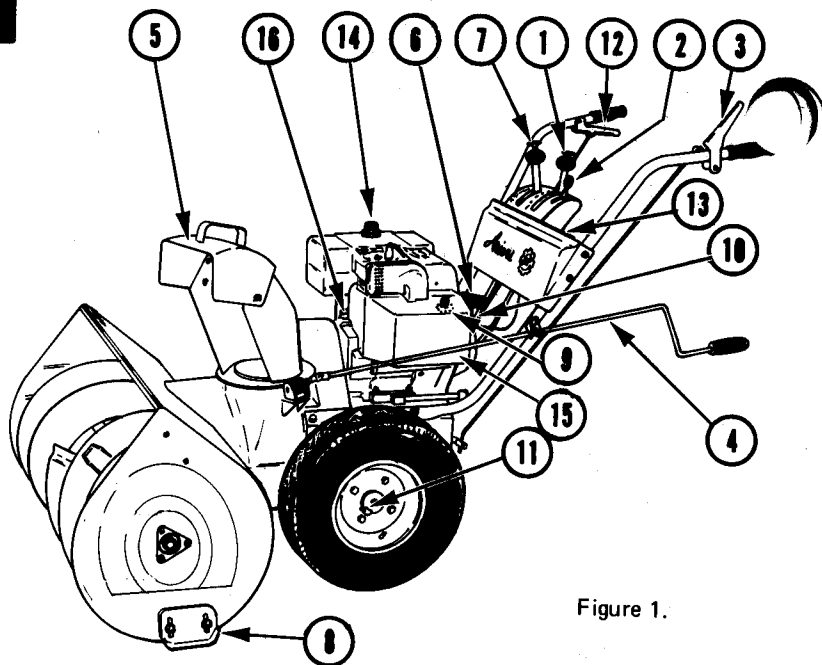

Figure 1.

CONTROLS

- 1 **SPEED SELECTOR:** Sets speed of tractor. Change speed or shift to reverse, without depressing clutch handle.
- 2 **THROTTLE:** Controls engine speed. Move throttle to park position after engine has stopped.
- 3 **TRACTOR CLUTCH:** Activates tractor drive. Depress to move tractor, release to stop.
- 4 **HAND CRANK:** Turns discharge chute 230° so snow can be thrown away from area being cleared.
- 5 **DEFLECTOR:** Controls the height the snow can be thrown.
- 6 **RECOIL STARTER:** Pull to start engine.
- 7 **ATTACHMENT CLUTCH:** Activates auger and impeller.
- 8 **RUNNERS:** Controls the distance the scraper blade is held above the surface being cleared.
- 9 **CHOKE:** Move choke to choke position to start engine. Models 924022 and 924023 have choke on top of heater box. Models 924024, 924025, 924026 and 924027 have choke at rear of heater box.
- 10 **PRIMER BUTTON:** Injects gas directly into carburetor. (1) Move choke lever to full (2) Push primer bulb five times (3) Pull starter rope three times. If engine fails to start, repeat step 2. Used on 8 H.P. only.

- 11 **DIFFERENTIAL LOCK:** In position, both wheels pull for snow removal. Out position, engages differential for easy turning with lawn attachments.
- 12 **INTERLOCK LEVER:** To minimize the chances for injury while the auger and blower are operating (Attachment Clutch 7 engaged) either the interlock lever 12 or the tractor clutch 3 must be depressed or the engine will stop.
- 13 **KEY SWITCH:** Prevents unauthorized use. Turn on to run, turn off to stop.

OPERATION

BEFORE STARTING:

Fill crankcase 16 with Ariens Sno-Thro oil 5W-20 when using Sno-Thro.

Fill fuel tank 14 with fresh, clean, regular gasoline. Do not mix oil with gasoline.

Make visual check with regards to safety precautions, obstructions, lubrication and maintenance.

CAUTION:

If tractor is to be used with lawn attachments, be sure heater box 15 is removed and air cleaner installed. Follow detailed instructions packed with attachment.

TO START:

Turn key 13 to "run" position.

Move attachment clutch 7 to OUT position.

Move speed selector 1 to NEUTRAL.

Move choke lever 9 to CHOKE position.

Move throttle 2 to FAST position.

Push primer bulb 10 5 times (on the 8 hp only.)

Pull recoil starter 6 to start engine.

Move choke 9 to no choke gradually as engine warms up.

TO TRANSPORT:

- Move attachment clutch (7) to OUT position.
- Move speed selector (1) to desired speed.
- Press down on handle bars to raise front of Sno-Thro slightly off the ground.
- Depress tractor clutch (3) to transport unit.

TO OPERATE:

- Move deflector (5) to desired height.
- Turn hand crank (4) to direct discharge chute.
- Squeeze Interlock Lever (12).
- Move attachment clutch (7) to IN position.
- Move speed selector (1) to desired speed.
- Move throttle (2) to desired speed.
- Depress tractor clutch (3) to move tractor.
- Speed of the machine is controlled by the throttle and speed selector.

TO STOP:

- Release tractor clutch (3).
- Disengage attachment clutch (7).
- Move speed selector (1) to NEUTRAL.
- Turn key (13) to "off" position to stop.
- Move throttle to park after engine has stopped.

MAINTENANCE

RUNNERS

An adjustable runner is provided on each side of the blower housing. Raising or lowering these runners controls the distance the scraper blade is held above the surface being cleared. Runner adjustment is accomplished by loosening the two nuts on each runner. Move to the desired position and retighten the nuts.

In wet snow which packs easily, it may be necessary to remove the runners or turn them upside down so the scraper blade will scrape clean.

DRIVE DISC ADJUSTMENT

A drive disc adjustment is provided to compensate for wear on the friction wheel. If slippage occurs when the tractor clutch is engaged, tighten the drive disc adjustment. See figure 7.

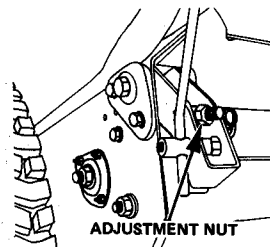

FIGURE 7

Position speed selector (1) between first and reverse. Tip machine forward onto blower housing. Tighten the adjustment nut while turning wheels by hand until the wheels just begin to bind. Now back off the adjustment nut three turns so the wheels turn freely.

STORAGE

ENGINE: Follow detail instructions in the engine manual.
SNO-THRO: Lubricate, clean and repaint as necessary.
Cover and store in dry place.

LUBRICATION

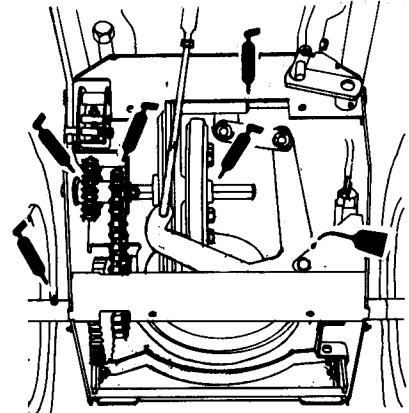

FIGURE 8

ENGINE

Fill crankcase (16) with Ariens Sno-Thro oil 5W-20 when using Sno-Thro.

Use Ariens Gard-N-Yard oil MS classification SAE-30 when using lawn attachments.

Fill fuel tank (14) with fresh, clean, regular gasoline.

NOTE: For detailed instructions on engine refer to manufacturer's booklet packed with the machine.

TRACTOR DRIVE

At start of season, grease gears, hex and axle shaft as indicated in figure 8. Use Ariens Moly Lithium grease.

Put two or three drops of light oil on speed selector and other linkage points. CAUTION: ⚠ Do not allow grease or oil to come in contact with friction wheel, drive disc or belts.

SNO-THRO UNIT

Grease rake shaft periodically or each time a shear bolt is replaced. At the end of the season, remove shear bolts, grease rake shaft, turn rakes on shaft several times and replace shear bolts. Use Ariens Moly Lithium grease.

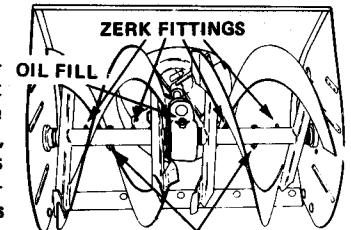

FIGURE 9

MODEL 924024, 924029 GEARCASE

Check oil level periodically. Oil level must be up to oil fill hole. Change oil every 25 hours or once each season which ever comes first. Fill with Ariens Special L-2 Gear Lubricant. Approx. 8 oz.

MODELS 924022, 924026 and 924028 GEARCASE

Check oil level periodically. Oil level must be up to oil fill hole. Change oil every 25 hours or once each season which ever comes first. Fill gear case by tipping Sno-Thro back on handlebars. Remove the fill and drain plugs. Fill with Ariens Premium Gear Lube (SAE-90-MP) through the fill hole until it runs out the drain hole. Replace drain and fill plugs.

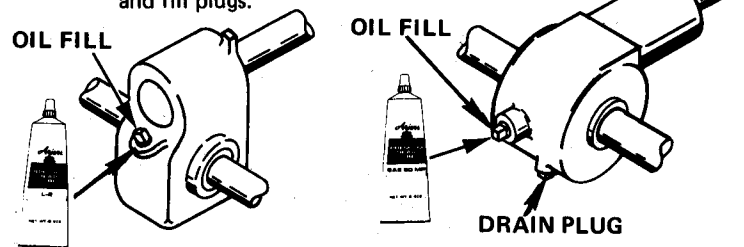
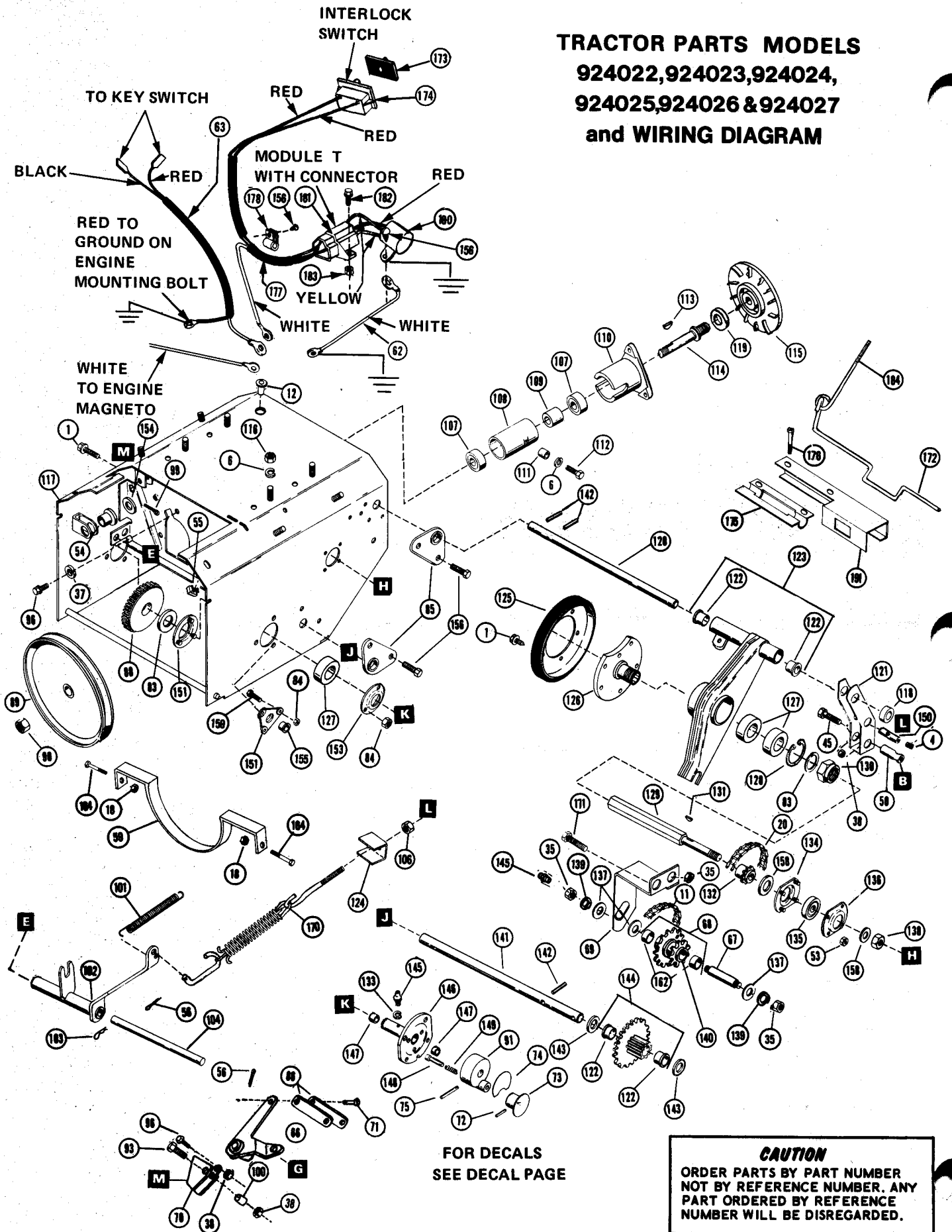

FIGURE 10

**TRACTOR PARTS MODELS
924022, 924023, 924024,
924025, 924026 & 924027
and WIRING DIAGRAM**



CAUTION
ORDER PARTS BY PART NUMBER
NOT BY REFERENCE NUMBER. ANY
PART ORDERED BY REFERENCE
NUMBER WILL BE DISREGARDED.

TRACTOR PARTS
MODELS 924022,924023,924024,
924025,924026 & 924027

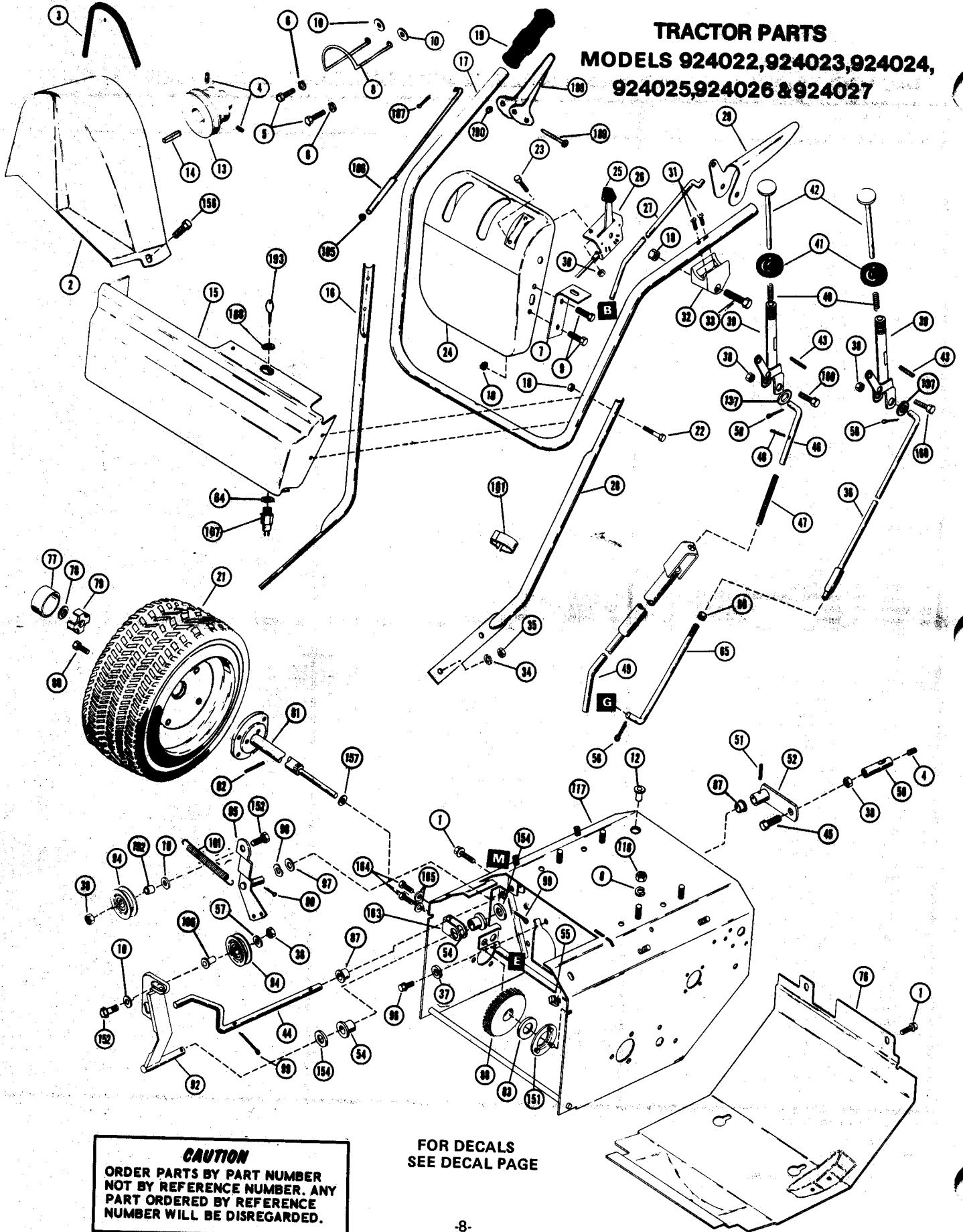

CAUTION
 ORDER PARTS BY PART NUMBER
 NOT BY REFERENCE NUMBER. ANY
 PART ORDERED BY REFERENCE
 NUMBER WILL BE DISREGARDED.

FOR DECALS
 SEE DECAL PAGE

NOTE: USE ARIENS NO. 90 PREMIUM GEAR LUBE (APPROX. 5 OZ.) IN ROTOR GEAR CASE.

FOR DECALS
SEE DECAL
PAGE

**24" SNO-THRO
MODELS
924022, 924026
& 924028**

CAUTION
ORDER PARTS BY PART NUMBER
NOT BY REFERENCE NUMBER. ANY
PART ORDERED BY REFERENCE
NUMBER WILL BE DISREGARDED.

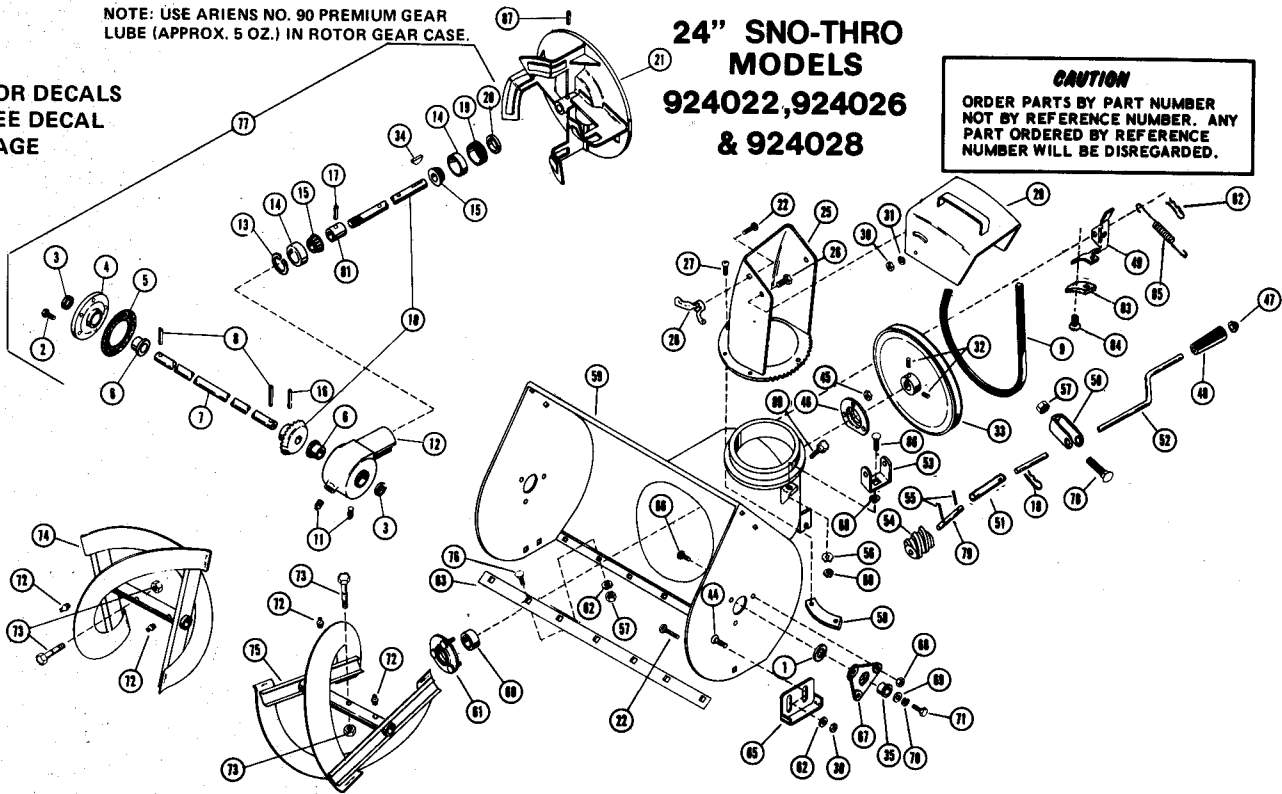

REF. NO.	PART NO.	STOCK CODE	DESCRIPTION	NO. REQ'D.	REF. NO.	PART NO.	STOCK CODE	DESCRIPTION	NO. REQ'D.
1	64046	M	Washer 1.505 O.D. x 1.005 I.D.	2	52	24097	S	Chute Control Crank	1
2	70012	M	Flange Whizlock Screw	5	53	22123	S	Worm Clevis	1
3	56061	M	Seal	2	54	22110	S	Worm Gear	1
4	10181	S	Case Cover	1	55	58034	F	Roll Pin 1/8 x 3/4	2
5	10108	M	Gasket	1	56	63023	M	Lockwasher	1
6	55035	M	Bushing	2	57	65042	F	Locknut	6
7	10299	S	Rake Shaft	1	58	10438	S	Chute Clamp	3
8	58030	M	Roll Pin 3/16 x 1-1/2	2	59	524021	O	Blower Housing (24")	1
9	72083	F	V Belt	1	60	54063	M	Ball Bearing	1
10	524015	S	Worm Gear and Shaft	1	61	3017	M	Bearing Flange	1
11	1138	S	Pipe Plug	2	62	64002	F	Washer 5/16	9
12	10180	S	Gear Case	1	63	10164	F	Scraper Blade	1
13	57032	M	Snap Ring	1	65	10165	F	Runner	2
14	54044	M	Bearing Cup	2	66	70011	M	Ribbed Neck Bolt 1/4 x 5/8	6
15	54045	M	Bearing Cone	2	67	10184	M	Bearing Support	2
16	58022	M	Roll Pin	2	68	65056	F	Whizlock Nut 1/4-20	6
17	58007	F	Roll Pin 1/4 x 1-1/4	1	69	64047	F	Washer 1.441 O.D. x .5111	2
18	67029	S	Hair Cotter	1	70	63006	F	Lockwasher 1/2	2
19	10371	S	Adjustment Plug	1	71	59024	M	Cap Screw 1/2-13 x 1 Hex. Hd.	2
20	56062	F	Seal	1	72	22093	F	Zerk Fitting	4
21	24237	M	Fan	1	73	510015	F	Shear Bolt	2
22	62010	M	Carriage Bolt 3/8-16 x 3/4	5	74	510007	O	R.H. Rake	1
25	24276	S	Discharge Chute	1	75	510008	O	L.H. Rake	1
26	59023	F	Cap Screw 3/8-16 Hex. Hd.	2	76	62026	M	Carriage Bolt 5/16-18 x 1/2	5
27	74026	F	Taptite No. 10-24 x 3/8	6	77	524005	S	Gear Case Assembly	1
28	10193	M	Wing Nut	1	78	68022	M	Carriage Bolt 5/16-18 - 1-3/8	1
29	510012	M	Deflector, W/Decal	1	79	10494	S	Worm Shaft	1
30	65039	F	Locknut 3/8-16	6	80	65015	F	Nut 5/16-18	1
31	63004	F	Lockwasher 3/8	2	81	10107	M	Bearing Spacer	1
32	60012	F	Setscrew 5/16-18 x 3/8	2	82	67004	F	Hairpin	1
33	73042	S	Sheave	1	83	22178	M	Lining	1
34	66001	M	Key, Woodruff No. 11	1	84	68062	M	Rivet	2
35	55035	M	Bushing	2	85	83164	M	Spring	1
44	62013	M	Carriage Bolt	4	86	62011	F	Carriage Bolt 5/16-18 x 3/4	1
45	65040	F	Locknut 1/4-20	3	87	58037	M	Roll Pin 1/4 x 1-3/4	2
46	10142	M	Bearing Flange	1	88	63032	M	Lockwasher	1
47	10198	S	Cap	1	89	70031	M	Flange Whizlock Screw	2
48	75039	S	Grip	1					
49	624035	S	Brake, w/lining	1					
50	22065	S	Chute Control Bracket	1					
51	24271	M	Sleeve	1					

SUGGESTED PARTS STOCKING CODE

F - Fast S - Slow
M - Medium O - Customer Order Only

32" SNO-THRO MODELS 924024 & 924029

NOTE: USE ARIENS SPECIAL L-2 GEAR LUBE
(APPROX. 6 OZ.) IN ROTOR GEAR CASE.

FOR DECALS
SEE DECAL
PAGE

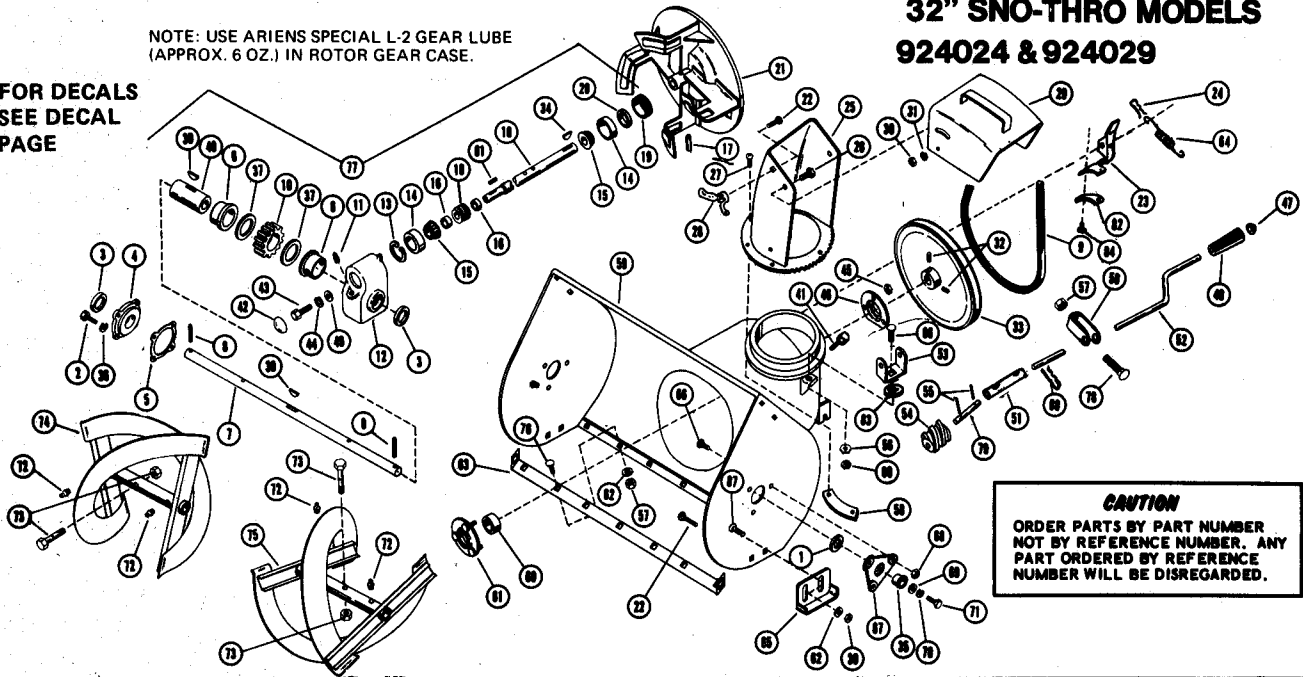

CAUTION

ORDER PARTS BY PART NUMBER
NOT BY REFERENCE NUMBER. ANY
PART ORDERED BY REFERENCE
NUMBER WILL BE DISREGARDED.

REF. NO.	PART NO.	Description	QTY.	REF. NO.	PART NO.	Description	QTY.
1	64046	M Washer 1.505 O.D. x 1.005 I.D.	2	47	10198	S Cap	1
2	59001	M Cap Screw 1/4-20 x 3/4 Hex. Hd. Plated	4	48	75039	S Grip	1
3	56070	M Seal	2	49	64082	M Washer	1
4	24013	S Case Cover	1	50	22065	S Chute Control Bracket	1
5	2008	M Gasket	1	51	24271	M Connector Sleeve	1
6	55059	M Bushing	2	52	24097	S Chute Control Crank	1
7	24066	S Rake Shaft	1	53	22123	S Worm Clevis	1
8	58030	M Roll Pin 3/16 x 1-1/2	2	54	22110	S Worm Gear	1
9	72072	F V Belt	1	55	58034	F Roll Pin 1/8 x 3/4	2
10	524009	S Worm Gear & Worm	1	56	63023	M Lockwasher	1
11	1138	S Pipe Plug	1	57	65042	F Locknut	8
12	24002	S Gear Case	1	58	10438	S Chute Clamp	3
13	57032	M Snap Ring	1	59	524022	O Blower Housing (32")	1
14	54044	M Bearing Cup	2	60	54063	M Ball Bearing	1
15	54045	M Bearing Cone	2	61	3017	M Bearing Flange	1
16	2005	M Spacer	2	62	64002	F Washer 5/16	11
17	58015	F Roll Pin 5/16 x 1-3/4	2	63	24256	F Scraper Blade	1
18	24062	S Worm Shaft	1	64	83164	M Spring	1
19	24015	S Adjustment Plug	1	65	10165	F Runner	2
20	56061	F Seal	1	66	70011	M Ribbed Neck Bolt 1/4-20 x 5/8	6
21	24185	M Fan	1	67	10184	M Bearing Support	2
22	62010	M Carriage Bolt 3/8-16 x 3/4	3	68	65056	F Whizlock Nut 1/4-20	6
23	624035	S Brake, W/lining	1	69	64047	F Washer 1.441 O.D. x .511	2
24	67004	M Hairpin	1	70	63006	F Lockwasher 1/2	2
25	24276	S Discharge Chute	1	71	59024	M Cap Screw 1/2-13 x 1 Hex. Hd.	2
26	59023	F Cap Screw 3/8-16 x 3/4 Hex. Hd.	2	72	22093	F Zerk Fitting	4
27	74026	F Taptite No. 10-24 x 3/8	6	73	510015	F Shear Bolt	2
28	10193	M Wing Nut	1	74	524013	O R.H. Rake	1
29	510012	M Deflector w/decals	1	75	524014	O L.H. Rake	1
30	65039	F Locknut 3/8-16	6	76	62026	M Carriage Bolt 5/16-18 x 1/2	7
31	63004	F Lockwasher 3/8	2	77	524005	S Gear Case Assembly	1
32	60012	F Setscrew 5/16-18 x 3/8	2	78	62022	M Carriage Bolt 5/16-18 x 1-3/8	1
33	73042	S Sheave	1	79	10494	S Worm Shaft	1
34	66001	M Key, Woodruff No. 11	1	80	65015	F Nut 5/16-18	1
35	55035	M Bushing	2	81	66013	M Key	1
36	63017	M Lockwasher 1/4 Plated	4	82	22178	M Linino	1
37	64087	F Washer	2	83	63032	M Lockwasher	1
39	66008	M Key, Woodruff No. 6	2	84	68062	M Rivet	2
40	24064	S Gear Case Shaft	1	86	62011	M Carriage Bolt 5/16-18 x 3/4	1
41	70031	M Flange Whizlock Screw 3/8-16 x 1/2	2	87	62013	M Carriage Bolt	2
42	4037	S Cap	1	88	67029	F Hair Pin	1
43	59022	F Cap Screw 5/16-18 x 3/4 Hex. Hd. Plated	1				
44	63003	F Lockwasher 5/16 Plated	1				
45	65040	F Locknut 1/4-20	3				
46	10142	M Bearing Flange	1				

SUGGESTED PARTS STOCKING CODE

F - Fast S - Slow
M - Medium O - Customer Order Only

OPERATING INSTRUCTIONS
 1. MOVE ATTACHMENT CLUTCH TO OUT.
 2. TURN KEY SWITCH TO RUN.
 3. MOVE THROTTLE TO FAST.

4. MOVE CHOKE TO FULL POSITION.
 5. PULL STARTER FROM RIGHT SIDE OF MACHINE.
 6. AS ENGINE WARMS UP, RETURN CHOKE TO OFF POSITION.
 7. TO STOP ENGINE TURN KEY SWITCH TO OFF.

**RELEASE CLUTCH
 HANDLE BEFORE
 SHIFTING**

8 H.P.

ENGINE PRIMER BUTTON
 1. MOVE CHOKE LEVER TO FULL.
 2. PUSH PRIMER BULB FIVE TIMES.
 NOTE: DO NOT PRIME A WARM ENGINE.
 3. PULL STARTER ROPE THREE TIMES, IF ENGINE FAILS TO START, REPEAT STEP 2.

Ariens

ARIENS COMPANY BRILLION, WISCONSIN U.S.A.

THESE DECALS AVAILABLE ONLY THROUGH TECUMSEH

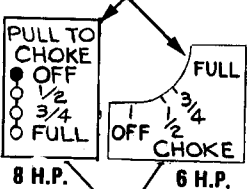

ATTENTION
 WHEN USING SUMMER ATTACHMENTS REMOVE HEATER BOX AND INSTALL AIR CLEANER. ENGINE DAMAGE MAY RESULT IF ABOVE INSTRUCTIONS ARE NOT FOLLOWED.

ATTACHMENT CLUTCH MUST BE OUT WHEN STARTING ENGINE OR LEAVING HANDLE AREA. COMPRESS EITHER HANDLE LEVER TO KEEP ENGINE RUNNING IF ATTACHMENT CLUTCH IS IN.

IN ATTACHMENT OUT



8 H.P. Engine Decal 78191
 6 H.P. Engine Decal 78225

WARNING
 MUFFLER & ADJACENT AREAS MAY EXCEED 150° F.

WARNING
 STOP ENGINE AND REMOVE SPARK PLUG IGNITION WIRE BEFORE REMOVING OBSTRUCTIONS.

CLUTCH LEVER
 DEPRESS FOR WHEEL DRIVE

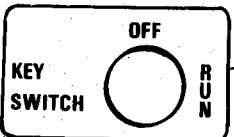

PARK +FAST
 SLOW

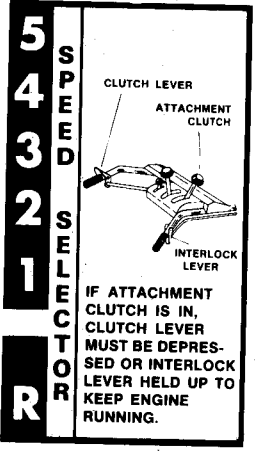
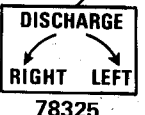

HOLD UP LOCKER LEVER

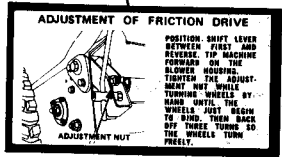

WARNING
 KEEP CLEAR OF COLLECTOR WHILE ENGINE IS RUNNING

ORDER ALL DECALS BY ARIENS PART NUMBERS SHOWN.