

Instruction Sheet

Kit Number: 72600900

DIFFERENTIAL AXLE RETROFIT KIT

For Models: 926004, 005, 006, 008, 010, 012, 013, 014, 015, 016, 300, 301, 306, 307, 308, 500, 501, 502, 503



WARNING: FAILURE TO FOLLOW INSTRUCTIONS could result in personal injury and/or damage to unit.

Read, understand, and follow all safety practices in Owner/Operator Manual before beginning.

Package Contents

Check contents of your kit for the parts listed (Figure 1):

Item	Qty	Description	Ariens P/N
1	1	Short Axle With Bushings	52604100
2	1	Long Axle – Pro Auto Differential	00660900
3	1	Differential Assembly	00866000
4	2	Flat Steel Washer 1.06 x 2.0 x .134	06443000
5	1	Pinion Shaft with Grease Fitting	52605900
6	1	Sleeve Bushing .635 x .880 x .305	05500035
7	1	Roundhead Squareneck Bolt 1/4-20 x 1.25	06220100
8	1	Hex Nut, Locking Center 1/4-20	06529700

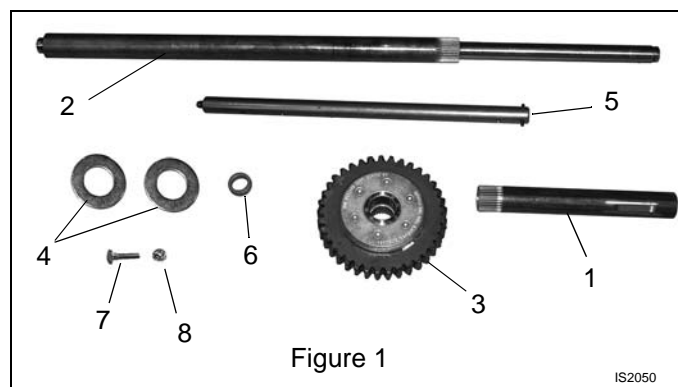

TOOLS REQUIRED

- 7/16 and 3/8" Socket and/or Box Wrenches
- Phillips Screwdriver
- 1/8" Punch
- Hammer
- Grease Gun

DISASSEMBLY



WARNING: NEVER attempt to make any adjustments to unit while engine is running. STOP engine, wait for all moving parts to stop, and disconnect spark plug wire before servicing.

1. Place unit on a flat level surface. Tip unit forward onto front of auger housing for service. Ensure unit is secure and will not tip over. Strap and clamp onto bench if needed.



WARNING: Before tipping unit up onto housing, remove fuel so no spills will occur and remove battery (if equipped). Ensure unit is secure and will not tip over during procedure.

2. Remove wheel attaching snap clips and remove wheels from both sides.
3. Remove key from axle on each side. Save for reinstallation.
4. Remove bottom cover by removing six bolts.
5. Remove remote trigger handle from the handlebar. Install roundhead squareneck bolt (item 7) and hex nut (item 8) in hole where hardware was removed. See Figure 2.

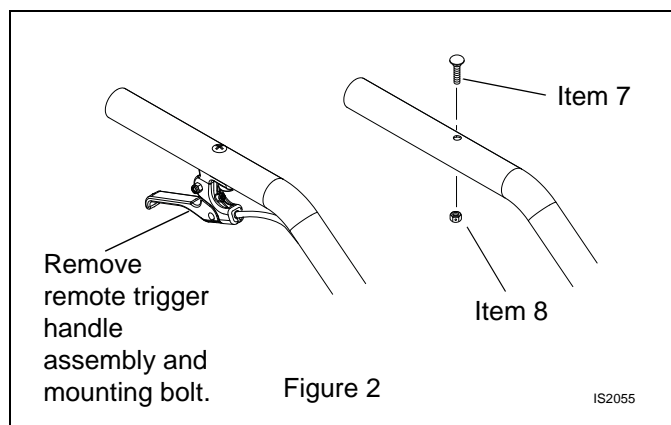

6. Remove left and right axles from the unit. See Figure 3.
7. Remove plastic washer, differential, differential tube and differential cam disks.
8. Disconnect and remove the trigger differential cable from the frame.

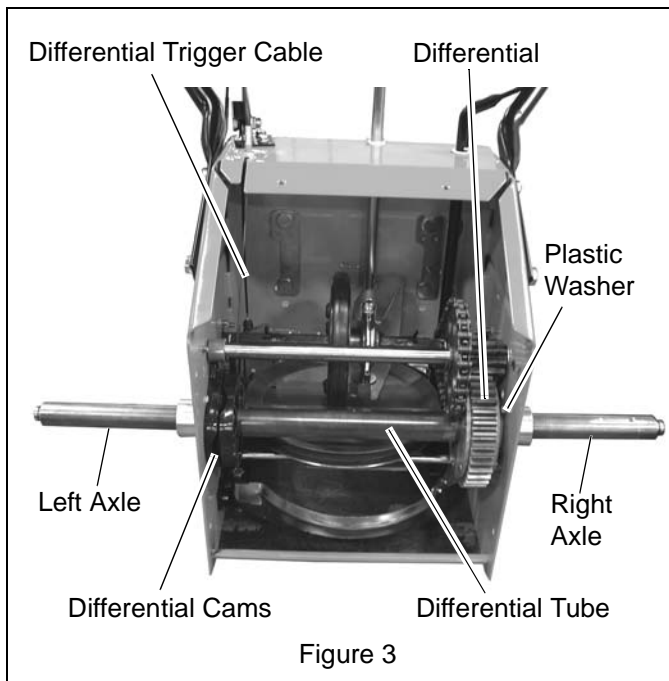

9. Remove spring clips from pinion shaft. Retain clips for reassembly. See Figure 4.

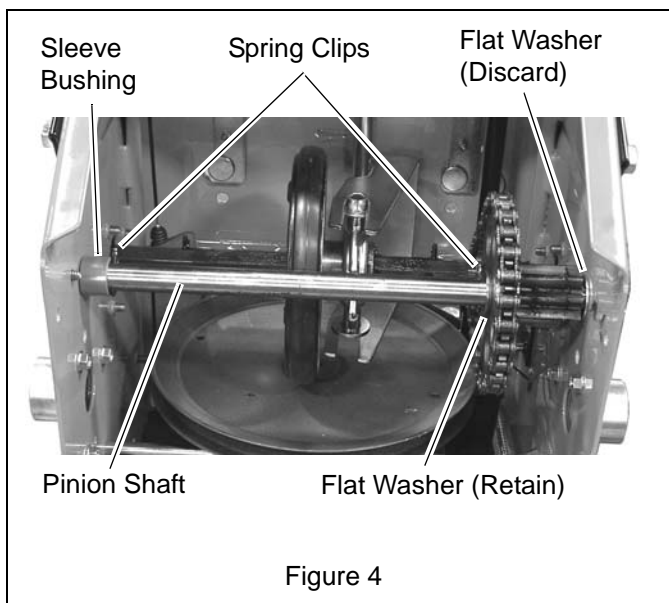

10. Slide the pinion shaft to the left and out of the frame. Retain the sleeve bushing and one flat washer.
11. Remove the washer from between the pinion gear and the frame and discard. Allow the pinion gear and chain to hang in position. Do not remove. See Figure 5.

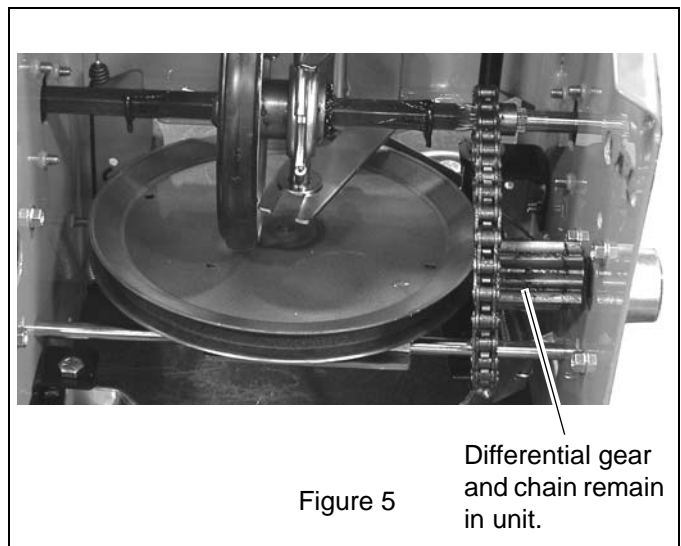

12. Remove the roll pin from the old pinion shaft and retain. Note the location of the pin for reinstallation. Be sure not to damage the roll pin during removal.

ASSEMBLY

1. Install the roll pin removed from the pinion shaft into the new pinion shaft (item 5). Ensure that the pin is installed in the same hole location as when removed.
2. Insert new pinion shaft (item 5) into the unit from the left side while installing the sleeve bushing, flat washer and pinion gear retained from disassembly. Install the new sleeve bushing (item 6) onto the pinion shaft between the pinion gear and the frame and insert the pinion shaft into the right side frame. See Figure 6.
3. Install spring clips removed earlier.

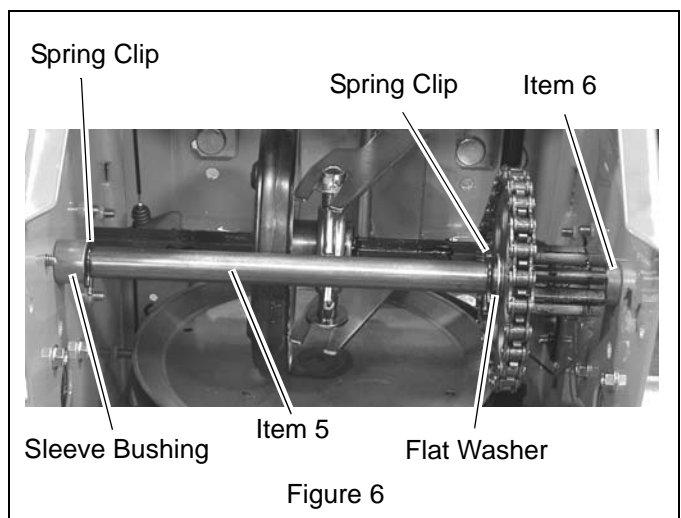

4. On the right side of the unit, install the short axle shaft (item 1), two washers (item 4) and new differential (item 3). The parts will stay in position. See Figure 7.

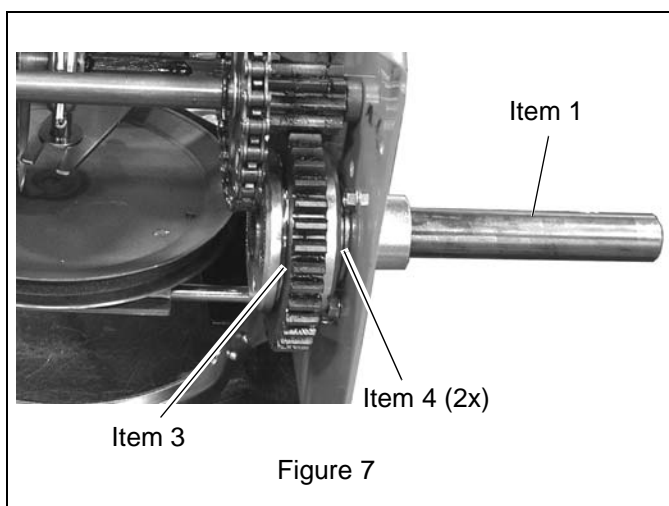

5. From the left side install the long axle (item 2) so that it fully engages the differential gear. See Figure 8.

6. Using grease gun, lubricate pinion shaft through zerk fitting on end of shaft.

NOTE: Use Lithium NLGI # 2 EP grease.

IMPORTANT: Failure to lubricate pinion shaft will lead to premature failure.

7. If necessary, apply grease to the pinion and differential gears and oil the roller chain.

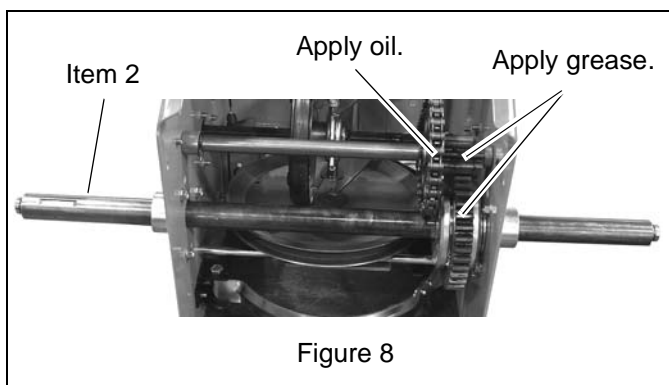

8. Install bottom cover.

9. Install keys into axle on each side. Slide the left and right wheel assemblies onto the axle and secure with snap clips.

NOTE: Apply anti-seize compound to the axles before installing wheels.

10. Return unit to operating position and verify installation. Unit will turn left and right with minimal effort.